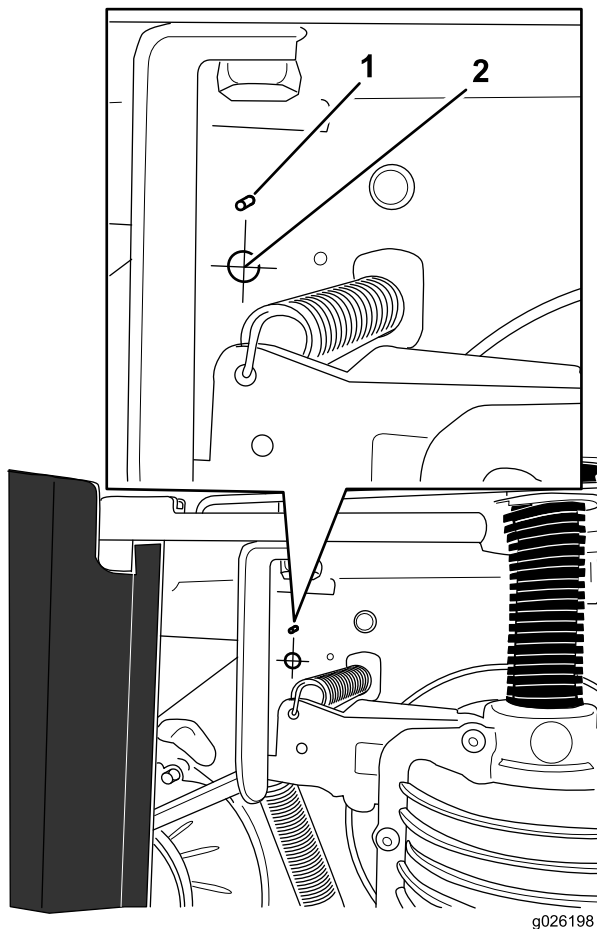

TORO®**Traction Cable Kit****2013 30in TurfMaster Walk-Behind Lawn Mower****Model No. 131-0866****Installation Instructions****⚠ WARNING****CALIFORNIA
Proposition 65 Warning**

This product contains a chemical or chemicals known to the State of California to cause cancer, birth defects, or reproductive harm.

1. Remove the old self-propel cable and discard it.
2. Tip the machine onto its right side (air filter up).
3. Locate the bottom end of the rear rivet that holds the model and serial number plate onto the housing (Figure 1).

**Figure 1**

1. Rear rivet end
2. Drill a 16 mm (5/8 inch) diameter hole here.

4. Mark a spot 25 mm (1 inch) directly below the rivet end (Figure 1).
5. Drill and deburr a 16 mm (5/8 inch) diameter hole in the mower housing from below at the spot that you marked in step 4.

Note: The oil filter is located directly above the spot where you are drilling. Mark the drill bit with tape 6 mm (1/4 inch) below the tip of the drill bit to indicate at what depth you are to stop drilling.

6. Insert the new cable from the top (spring end first) through the drilled hole.
7. Attach the cable spring end onto the transmission activation lever as shown in Figure 2.

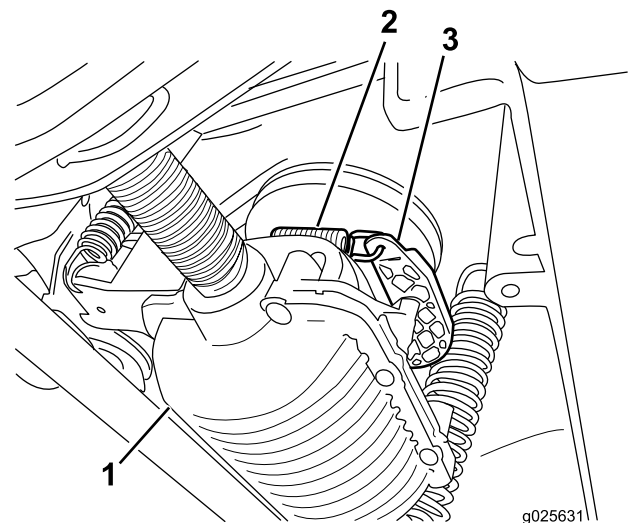
**Figure 2**

1. Transmission gear case
2. Cable spring end
3. Transmission activation lever

8. Insert the cable anchor into the hole in the bracket on the transmission gear case as shown in Figure 3.



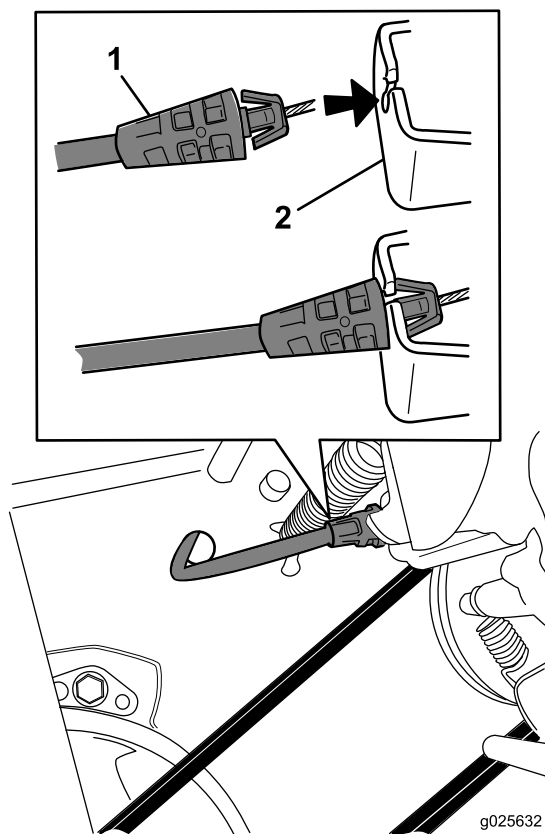

Figure 3

1. Cable anchor 2. Transmission case

9. Route the cable upward along the left side of the handle as shown in Figure 4.

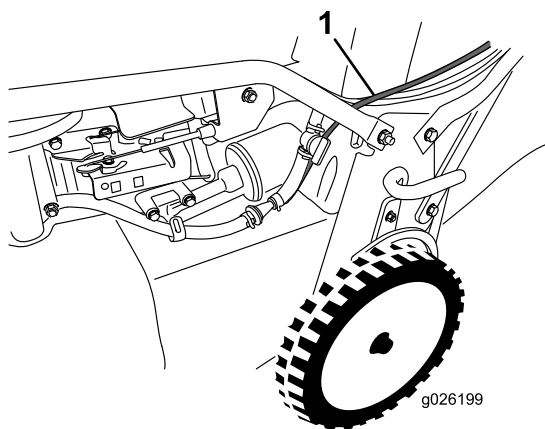

Figure 4

1. Cable

10. Secure the upper end of the cable to the traction lever.
11. Adjust the self-propel cable; refer to Adjusting the Self-propel Cable in the *Operator's Manual*.