

TORO®

1/3 Area Flatbed Kit

Workman® Heavy-Duty Utility Vehicle

Model No. 07341—Serial No. 40001 and Up

Installation Instructions

⚠ WARNING

CALIFORNIA Proposition 65 Warning

This product contains a chemical or chemicals known to the State of California to cause cancer, birth defects, or reproductive harm.

Note: A radiator cover is not required when using a 1/3 bed unless materials being carried could spill onto the radiator.

1. Place the bed on the vehicle and align the mounting holes with the inserts in the frame channels.

Note: Position the bed so that the slot cover is towards the rear of the vehicle.

2. Secure the bed to the frame using 4 flange-head bolts.

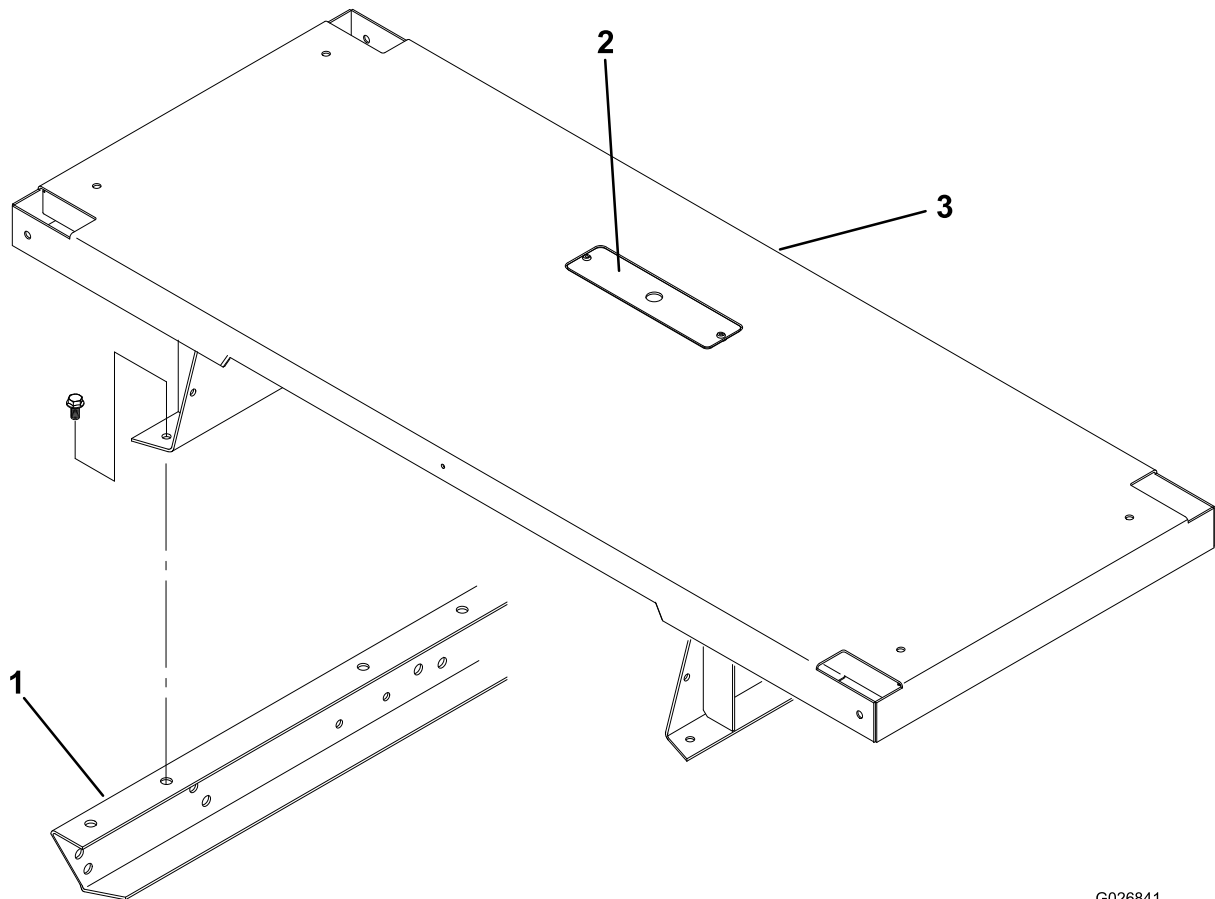

Figure 1

G026841

1. Vehicle frame
2. Slot cover

3. Flatbed

