

42in or 48in Mulch Kit

Dedicated-Bagging Riding Mower

Model No. 130-8460

Model No. 130-8463

Installation Instructions

⚠ WARNING

CALIFORNIA Proposition 65 Warning

This product contains a chemical or chemicals known to the State of California to cause cancer, birth defects, or reproductive harm.

Installation

Loose Parts

Use the chart below to verify that all parts have been shipped.

Description	Qty.	Use
Mulch plug	4	Install the mulch kit.
Blad driver	2	
Shear bolt	4	
Curved washer	3	
Bolt (5/16 x 1 inch)	2	
Lock nut (1/4 inch)	4	
Right-hand 48 inch blade	1	
Left-hand 48 inch blade	1	
Right-hand 42 inch blade	1	
Left-hand 42 inch blade	1	

Note: Determine the left and right sides of the machine from the normal operating position.

Installing the Mulch Kit

Note: Wear thick work gloves or other adequate hand protection when installing the blades.

1. Disengage the blade-control switch (PTO), move the motion-control levers to the neutral-locked position, and set the parking brake.
2. Stop the engine, remove the key, and wait for all moving parts to stop before leaving the operating position.
3. Raise the mower deck up and latch it into place with the deck-lift hook.
4. While wearing thick work gloves or other adequate hand protection, remove the standard cutting blades. Save the blade bolts and washers.

Note: When removing the blades, make note how they are installed and on what side the red blade is installed.

5. Remove the cutoff baffles on each side of the mower deck discharge opening and retain for future use (Figure 1).

Note: The cutoff baffles have a bolt installed under the mower deck and a nut on top for the baffle's threaded stud.



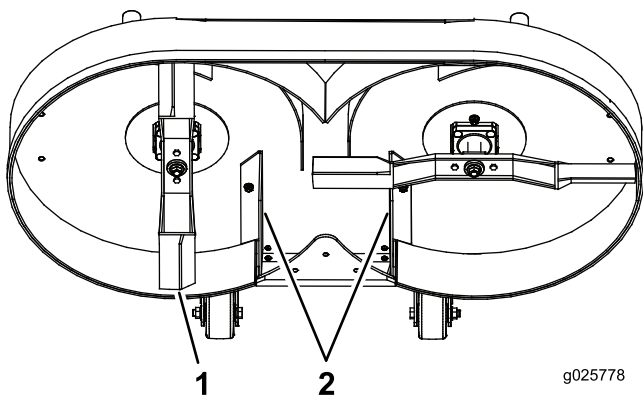

Figure 1

1. Standard blade 2. Cutoff baffles

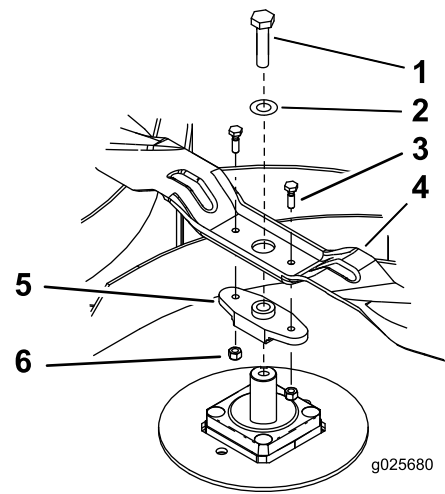

Figure 3

1. Blade bolt 4. Blade
2. Washer 5. Blade driver
3. Shear bolt 6. Lock nut (1/4 inch)

6. Install the mulch plug into the discharge opening with 3 bolts (3/8 x 1 inch) and 3 curved washers (Figure 2).
7. Torque the bolts between 19.8 to 25.4 N-m (175 to 225 in-lb).

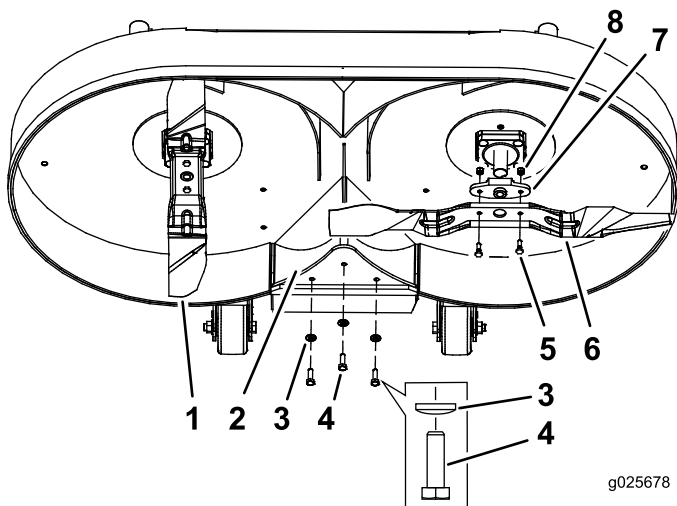

Figure 2

1. Right-hand mulch blade (Red) 5. Shear bolt
2. Mulch plug 6. Left-hand mulch blade (Black)
3. Curved washer 7. Blade driver
4. Bolt (3/8 x 1 inch) 8. Lock nut (1/4 inch)

8. Install the right-hand mulch blade to the blade driver with 2 shear bolts and 2 lock nuts (1/4 inch) (Figure 3).
9. Install the left-hand mulch blade to the blade driver with 2 shear bolts and 2 lock nuts (1/4 inch) (Figure 3).
10. Torque the shear bolts between 922 and 1130 N-cm (80 and 100 in-lb).

11. Install the blades with the drivers to the gearbox shafts with the previously removed blade bolts and washers (Figure 3).

Note: The red blade is installed on the right-hand gearbox shaft (Figure 2).

12. Torque the blade bolts to 115-149 N-m (85-110 ft-lb).