



# Hand Throttle Kit

2004 and Later Heavy-Duty Workman® Vehicles

Model No. 07420

## Installation Instructions

# Safety

### ▲ WARNING

#### CALIFORNIA Proposition 65 Warning

This product contains a chemical or chemicals known to the State of California to cause cancer, birth defects, or reproductive harm.

## Safety and Instructional Decals



Safety decals and instructions are easily visible to the operator and are located near any area of potential danger. Replace any decal that is damaged or lost.

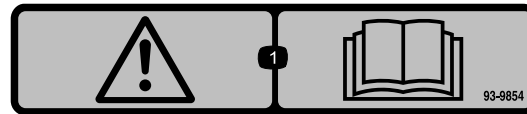

93-9854

1. Warning—read the *Operator's Manual*.



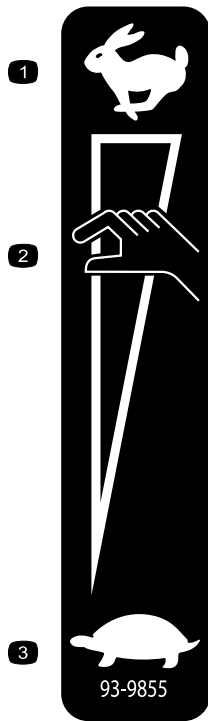

93-9855

- 1. Fast
- 2. Hand-throttle position
- 3. Slow

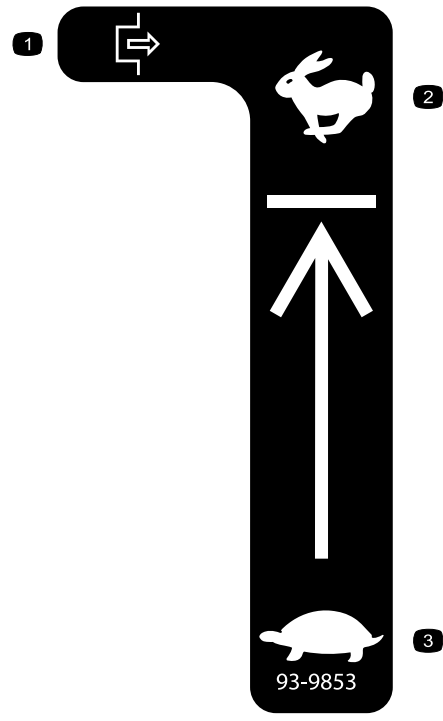

93-9853

- 1. Disengage
- 2. Fast
- 3. Slow

# Installation

## Loose Parts

Use the chart below to verify that all parts have been shipped.

Description	Qty.	Use
Shoulder bolt (1/4 x 3/4 inch)	2	Install the throttle levers.
Locknut (1/4 inch)	2	
Throttle-rod assembly	1	
Hand-throttle assembly	1	Install the hand throttle.
Cotter pin	1	Connect to the foot throttle.
Plastic fitting	1	
Clevis pin	1	

# Installing the Throttle Levers

1. Stop the engine, set the parking brake, and remove the key from ignition switch.
2. Mount the slotted throttle rod ends to the throttle levers with 2 shoulder bolts (1/4 x 3/4 inch) and locknuts as shown in (Figure 1).

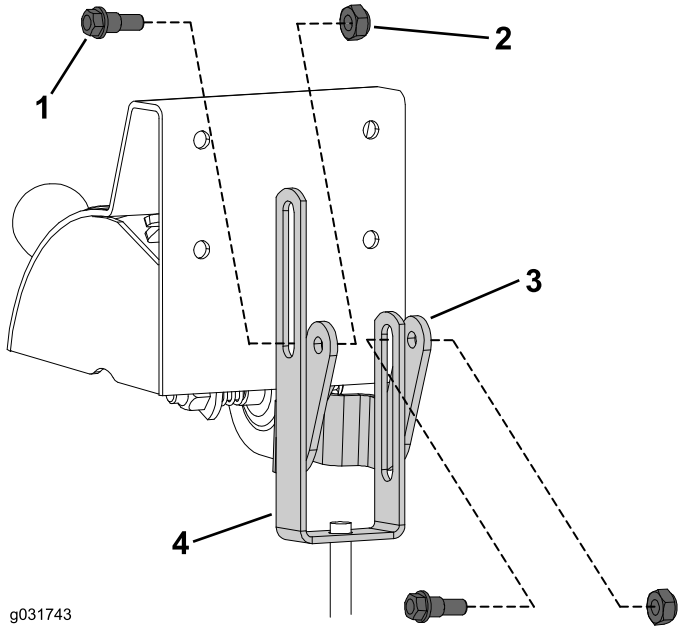

Figure 1

- |                                   |                          |
|-----------------------------------|--------------------------|
| 1. Shoulder bolt (1/4 x 3/4 inch) | 3. Throttle-rod assembly |
| 2. Locknut (1/4 inch)             | 4. Throttle rod          |

**Note:** Ensure that the rod ends are mounted to the sides of levers and that the bolt shoulders are positioned in the rod-end slots (Figure 1).

# Installing the Hand Throttle to the Dashboard

1. Remove the 3 bolts and nuts securing the dash panel to the front frame (Figure 2).

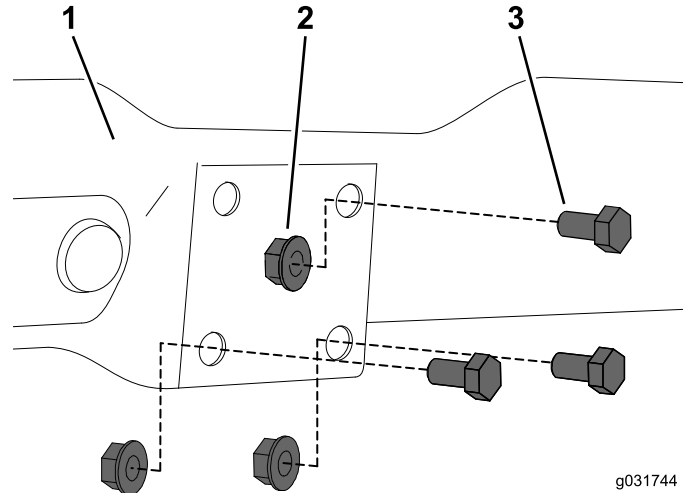

Figure 2

- |              |         |
|--------------|---------|
| 1. Dashboard | 3. Bolt |
| 2. Nut       |         |

**Note:** Retain the nuts and discard the bolts.

2. Use the 3 bolts (5/16 x 1 inch) that are included in the kit and the locknuts that you removed in the previous step to secure the hand throttle assembly to the dashboard in the hole locations shown in Figure 3.

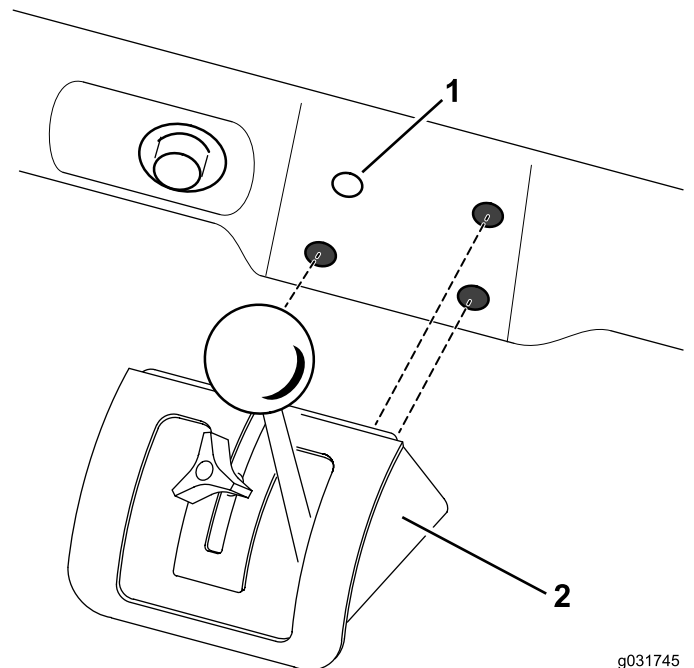

Figure 3

- |                |                           |
|----------------|---------------------------|
| 1. Unused hole | 2. Hand-throttle assembly |
|----------------|---------------------------|

# Connecting to the Foot Throttle

1. Move the speed-control lever to the hand-throttle side (left slot) and push the lever all the way upward (full speed)
2. Hold the accelerator all the way to the floor.
3. Align the clevis hole in the plastic fitting with the hole in the accelerator arm (Figure 4).

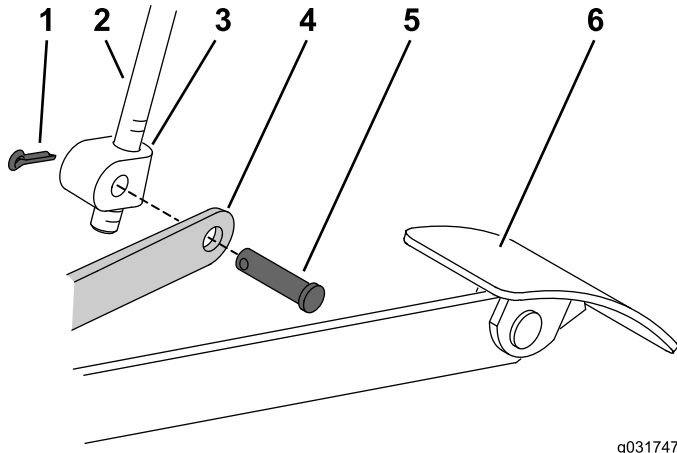

Figure 4

g031747

- |                    |                      |
|--------------------|----------------------|
| 1. Cotter pin      | 4. Accelerator arm   |
| 2. Throttle rod    | 5. Clevis pin        |
| 3. Plastic fitting | 6. Accelerator pedal |

4. Secure the fitting to the accelerator arm with a clevis pin and a cotter pin.
5. Release the accelerator pedal and move the speed control lever to the “speed limiter” side (right slot) and fully upward to the OFF position.

**Note:** Adjust the tension nut for the hand throttle if the accelerator pedal does not stay in position.

6. Start the engine and check the operation of hand throttle to ensure that you obtain the minimum and maximum settings. Make adjustments if required.

# Operation

## ⚠ DANGER

Using the hand throttle to control the ground speed may cause you to lose control of the vehicle, resulting in injury or death to you or bystanders.

Do not use the hand throttle to control the ground speed of the vehicle.

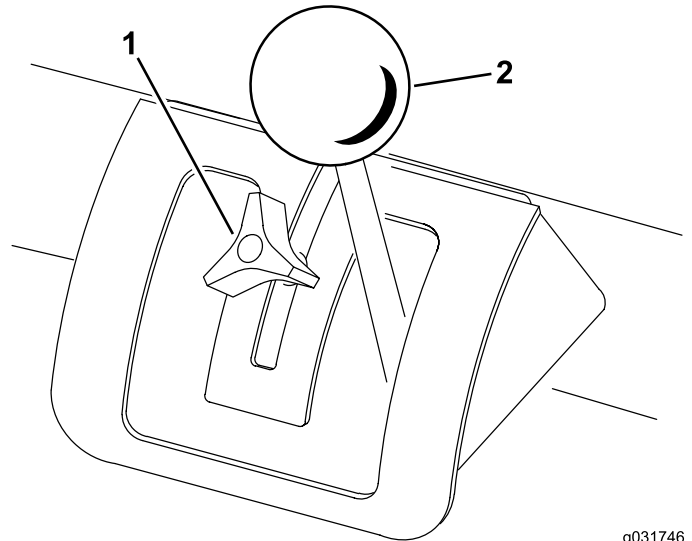

Figure 5

g031746

- |              |                                    |
|--------------|------------------------------------|
| 1. Stop knob | 2. Speed limiter and hand throttle |
|--------------|------------------------------------|

- With the speed-control lever in the OFF position, loosen the stop knob and move it fully upward.
- Slide the speed-control lever around stop and downward to the SLOW position.
- Press the accelerator pedal to desired maximum engine speed.
- Move the stop knob downward until it contacts the control lever and tighten the knob.
- Release the accelerator pedal and then press it again. The peddle should stop at the set engine speed.

To disengage the speed limiter, move the speed-control lever fully up.

The hand-throttle (left) slot is used for manually setting the engine speed. Use it for stationary attachments, like the generator, to set a constant engine or PTO speed.