



Backup-Alarm Kit

Workman® HDX-Auto Utility Vehicle

Model No. 127-8729

Form No. 3382-681 Rev B

Installation Instructions

Loose Parts

Use the chart below to verify that all parts have been shipped.

Description	Qty.	Use
Backup alarm	1	Install the kit.
Hex bolt	2	
Nut	2	
Wiring harness	1	
Cable tie	6	

Installing the Kit

1. Park the machine on a level surface, stop the engine, set the parking brake, and remove the key from the ignition.
2. Remove the 2 nuts from the ground stud of the backup alarm (Figure 1).

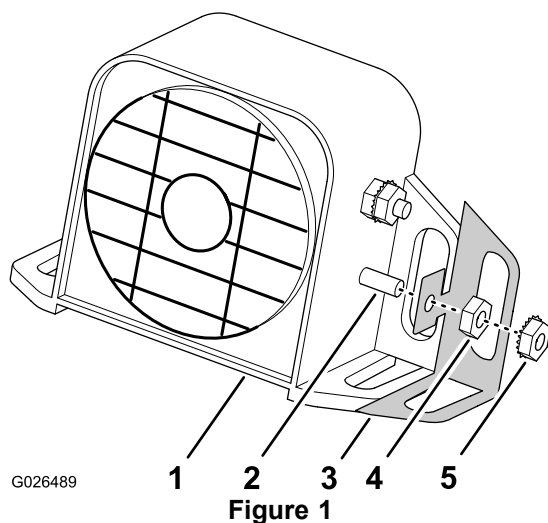

- | | |
|--------------------|--------------------|
| 1. Backup alarm | 4. Plain nut |
| 2. Ground stud | 5. Star-washer nut |
| 3. Grounding strap | |

3. Remove the grounding strap from the stud of the alarm (Figure 1).

Note: Discard the ground strap.

4. Install the plain-terminal nut onto the ground terminal hand tight (Figure 1).
5. Attach the backup alarm to the rear bracket of the machine using the hex bolts and nuts (Figure 2).

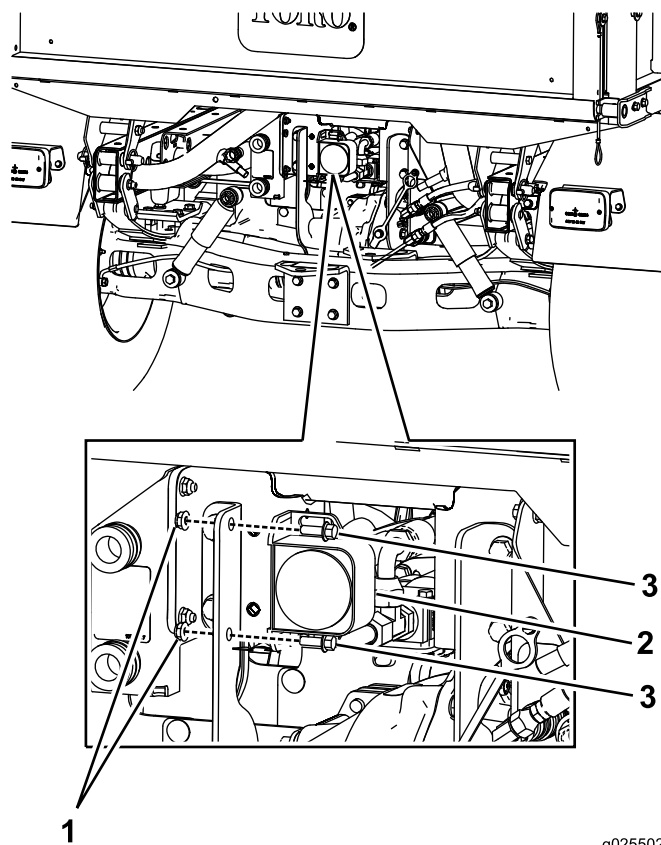

Figure 2

- | | |
|-----------------|-------------|
| 1. Nut | 3. Hex bolt |
| 2. Backup alarm | |



6. Secure the wiring harness to the backup alarm (Figure 3).

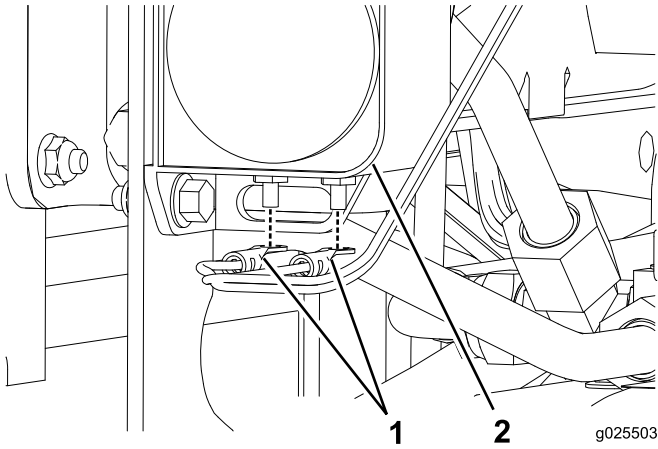

Figure 3

1. Backup-alarm wiring harness
2. Backup alarm

7. Route the wiring harness to the front of the machine by following the other wiring harnesses (Figure 4).

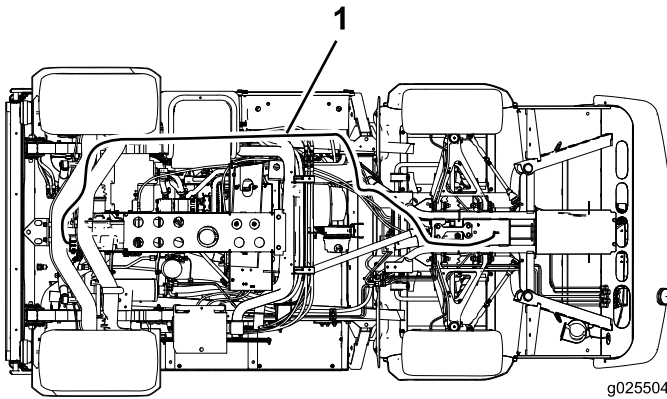

Figure 4

1. Backup-alarm wiring harness

8. Secure the wiring harness with cable ties.
9. Remove the screws and remove the control panel in-between the 2 seats (Figure 5).

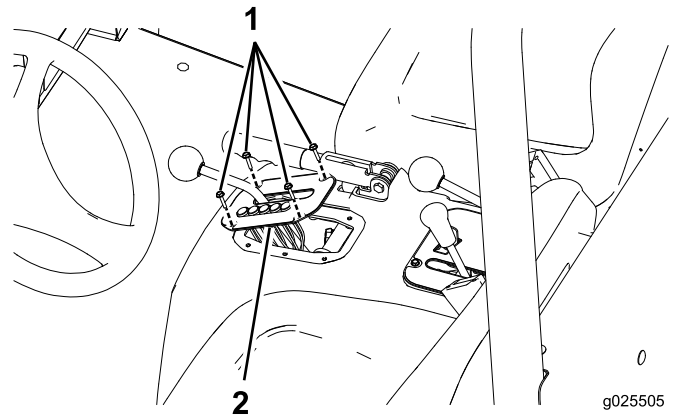

Figure 5

1. Screws
2. Control panel

10. Unplug the shift-indicator connector from the vehicle harness (Figure 6).

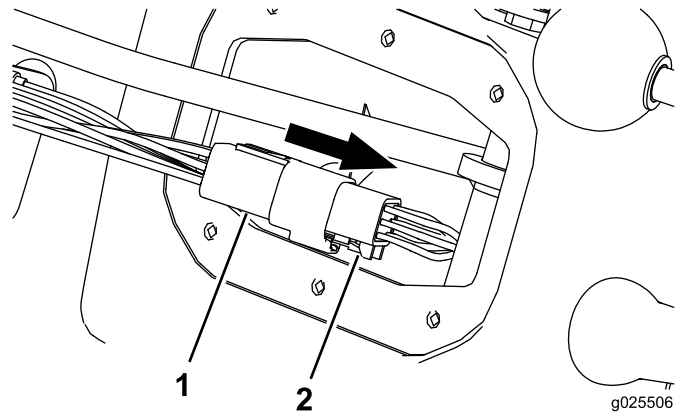

Figure 6

1. Shift-indicator connector
2. Vehicle harness

11. Plug the shift-indicator connector to the backup-alarm harness (Figure 7).

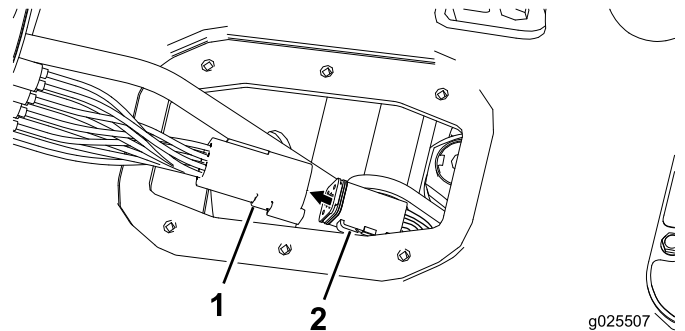

Figure 7

1. Shift-indicator connector
2. Backup-alarm harness

12. Plug in the vehicle connector harness to the backup-alarm harness (Figure 8).

Note: Ensure that the wiring harnesses are not in the way of moving parts.

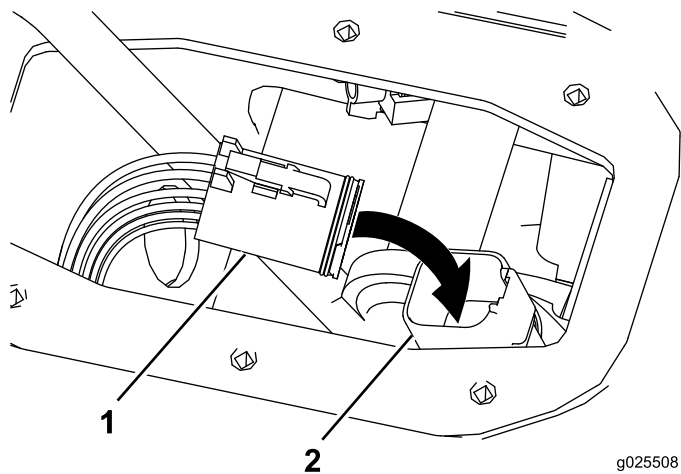

Figure 8

1. Vehicle harness 2. Backup-alarm harness

13. Replace the control panel.



Count on it.