



48V Chain Saw

Model No. 51888—Serial No. 314000001 and Up

Model No. 51889—Serial No. 314000001 and Up

Model No. 51889T—Serial No. 314000001 and Up

Operator's Manual



If you have questions or problems, contact us at www.Toro.com or call toll free 1-800-237-2654 (US) or 1-800-248-3258 (Canada) before returning this product.

▲ WARNING

CALIFORNIA Proposition 65 Warning

This product contains a chemical or chemicals known to the State of California to cause cancer, birth defects, or reproductive harm.

- C. Do not expose power tools to rain or wet conditions. *Water entering a power tool will increase the risk of electric shock.*
- D. Do not abuse the cord. Never use the cord for carrying, pulling or unplugging the power tool. Keep cord away from heat, oil, sharp edges or moving parts. *Damaged or entangled cords increase the risk of electric shock.*
- E. When operating a power tool outdoors, use an extension cord suitable for outdoor use. *Use of a cord suitable for outdoor use reduces the risk of electric shock.*
- F. If operating a power tool in a damp location is unavoidable, use a residual current device (RCD) protected supply. *Use of an RCD reduces the risk of electric shock.*

General Safety Rules

Model 51889T does not include a battery or a charger.

WARNING: When using electric power tools, basic safety precautions should always be followed to reduce the risk of fire, electric shock, and personal injury, including the following:

Read all instructions.

The term "power tool" in all of the warnings refers to your mains-operated (corded) power tool or battery-operated (cordless) power tool.

1. Work area safety

- A. Keep work area clean and well lit. *Cluttered or dark areas invite accidents*
- B. Do not operate power tools in explosive atmospheres, such as in the presence of flammable liquids, gases or dust. *Power tools create sparks which may ignite the dust or fumes.*
- C. Keep children and bystanders away while operating a power tool. *Distractions can cause you to lose control.*

2. Electrical safety

- A. Power tool plugs must match the outlet. Never modify the plug in any way. Do not use any adapter plugs with earthed (grounded) power tools. *Unmodified plugs and matching outlets will reduce risk of electric shock.*
- B. Avoid body contact with earthed or grounded surfaces such as pipes, radiators, ranges and refrigerators. *There is an increased risk of electric shock if your body is earthed or grounded.*

3. Personal safety

- A. Stay alert, watch what you are doing and use common sense when operating a power tool. Do not use a power tool while you are tired or under the influence of drugs, alcohol or medication. *A moment of inattention while operating power tools may result in serious personal injury.*
- B. Use personal protective equipment. Always wear eye protection. *Protective equipment such as dust mask, non-skid safety shoes, hard hat, or hearing protection used for appropriate conditions will reduce personal injuries.*
- C. Prevent unintentional starting. Ensure the switch is in the off-position before connecting to power source and/or battery pack, picking up or carrying the tool. *Carrying power tools with your finger on the switch or energizing power tools that have the switch on invites accidents.*
- D. Remove any adjusting key or wrench before turning the power tool on. *A wrench or a key left attached to the power tool may result in personal injury.*
- E. Do not overreach. Keep proper footing and balance at all times. *This enables better control of the power tool in unexpected situations.*
- F. Dress properly. Do not wear loose clothing or jewelry. Keep your hair, clothing and gloves away from moving parts. *Loose clothes, jewelry, or long hair can be caught in moving parts.*
- G. If devices are provided for the connection of dust extraction and collection facilities, ensure these are



connected and properly used. *Use of these devices can reduce dust-related hazards.*

H. **Keep hands and feet away from the cutting area.**

4. Power tool use and care

- A. **Do not force the power tool. Use the correct power tool for your application.** *The correct power tool will do the job better and safer at the rate for which it was designed.*
- B. **Do not use the power tool if the switch does not turn it on and off.** *Any power tool that cannot be controlled with the switch is dangerous and must be repaired.*
- C. **Disconnect the plug from the power source and/or the battery pack from the power tool before making any adjustments, changing accessories, or storing power tools.** *Such preventive safety measures reduce the risk of starting the power tool accidentally.*
- D. **Store idle power tools out of the reach of children and do not allow persons unfamiliar with the power tool or these instructions to operate the power tool.** *Power tools are dangerous in the hands of untrained users.*
- E. **Store idle appliances indoors.** *When not in use, appliances should be stored indoors in a dry and high or locked-up place, out of the reach of children.*
- F. **Maintain power tools. Check for misalignment or binding of moving parts, breakage of parts and any other condition that may affect the power tools operation. If damaged, have the power tool repaired before use.** *Many accidents are caused by poorly maintained power tools.*
- G. **Keep cutting tools sharp and clean.** *Properly maintained cutting tools with sharp cutting edges are less likely to bind and are easier to control.*
- H. **Use the power tool, accessories and tool bits etc., in accordance with these instructions and in the manner intended for the particular type of power tool, taking into account the working conditions and the work to be performed.** *Use of the power tool for operations different from those intended could result in a hazardous situation.*
- I. **Keep guards in place and in working order.**

5. Chain Saw Safety

- A. **Hold the power tool by insulated gripping surfaces only, because the saw chain may contact hidden wiring or its own cord.** *Saw chains contacting a "live" wire may make exposed metal parts of the power tool "live" and could give the operator an electric shock.*
- B. **Wear safety glasses and hearing protection. Further protective equipment for head, hands, legs, and feet is recommended.** *Adequate protective clothing will reduce personal injury by flying debris or accidental contact with the saw chain.*
- C. **Do not operate a chain saw in a tree.** *Operation of a chain saw while up in a tree may result in personal injury.*
- D. **Always keep proper footing and operate the chain saw only when standing on a fixed, secure, and level surface.** *Slippery or unstable surfaces such as ladders may cause a loss of balance or control of the chain saw.*
- E. **When cutting a limb that is under tension be alert for spring back.** *When the tension in the wood fibre is released the spring loaded limb may strike the operator and/or throw the chain saw out of control.*

- F. **Use extreme caution when cutting brush and saplings.** *The slender material may catch the saw chain and be whipped toward you or pull you off balance.*
- G. **Carry the chain saw by the front handle with the chain saw switched off and away from your body. When transporting or storing the chain saw always fit the guide bar cover.** *Proper handling of the chain saw will reduce the likelihood of accidental contact with the moving saw chain.*
- H. **Follow instructions for lubricating, chain tensioning, and changing accessories.** *Improperly tensioned or lubricated chain may either break or increase the chance for kickback.*
- I. **Keep handles dry, clean, and free from oil and grease.** *Greasy, oily handles are slippery causing loss of control.*

Kickback may occur when the nose or tip of the guide bar touches an object, or when the wood closes in and pinches the saw chain in the cut.

Tip contact in some cases may cause a sudden reverse reaction, kicking the guide bar up and back towards the operator.

Pinching the saw chain along the top of the guide bar may push the guide bar rapidly back towards the operator.

Either of these reactions may cause you to lose control of the saw which could result in a serious personal injury. Do not rely exclusively upon the safety devices built into your saw. As a chain saw user, you should take several steps to keep your cutting jobs free from accident or injury.

Kickback is the result of tool misuse and/or incorrect operating procedures or conditions and can be avoided by taking proper precautions as given below:

- **Maintain a firm grip, with thumbs and fingers encircling the chain saw handles, with both hands on the saw and position your body and arm to allow you to resist kickback forces.** *Kickback forces can be controlled by the operator, if proper precautions are taken. Do not let go of the chain saw.*
- **Do not overreach and do not cut above shoulder height.** *This helps prevent unintended tip contact and enables better control of the chain saw in unexpected situations.*
- **Only use replacement bars and chains specified by the manufacturer.** *Incorrect replacement bars and chains may cause chain breakage and/or kickback.*
- **Follow the manufacturer's sharpening and maintenance instructions for the saw chain.** *Decreasing the depth gauge height can lead to increased kickback.*

6. Service

Have your power tool serviced by a qualified repair person using only identical replacement parts. *This will ensure that the safety of the power tool is maintained.*

7. Battery Safety

- A. Do not charge power tool in rain, or in wet locations.
- B. Do not use battery-operated power tool in the rain.
- C. Use only the following type and size battery: Toro battery model 88508 or 88509 and battery charger 88507 or 88510.
- D. Remove or disconnect the battery before servicing, cleaning, or removing material from the power tool.

- E. Do not dispose of the battery in a fire. The cell may explode. Check with local codes for possible special disposal instructions.
- F. Do not open or mutilate the battery. Released electrolyte is corrosive and may cause damage to the eyes or skin. It may be toxic if swallowed.
- G. Do not open or mutilate the battery. Released electrolyte is flammable and can cause damage if exposed to fire.
- H. Exercise care in handling batteries in order not to short the battery with conducting materials such as rings,

bracelets, and keys. The battery or conductor may overheat and cause burns.

- I. Ideal charging temperature is between 0 degrees C and 50 degrees C (32 and 122 degrees F). Charging outside of this temperature range will increase the charging time.

WARNING—To reduce the risk of injury, user must read instruction manual.

SAVE THESE INSTRUCTIONS

Safety and Instructional Decals

Important: Safety and instruction decals are located near areas of potential danger. Replace damaged decals.

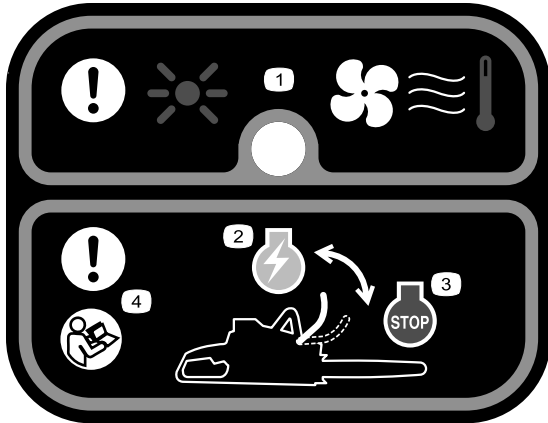

121-7647

- 1. Overheating/high amp indicator
- 2. Hand guard forward—motor stop
- 3. Hand guard backward—motor run
- 4. Warning—read the *Operator's Manual*



121-7644

- 1. Wear ear protection; wear eye protection; do not operate in wet conditions; contact of the guide bar tip with any object should be avoided; tip contact can cause the guide bar to move suddenly upward and backward, which can cause serious injury; always use two hands when operating the chain saw.



121-7652

- 1. Read the *Operator's Manual*—contact of the guide bar tip with any object should be avoided; tip contact can cause the guide bar to move suddenly upward and backward, which can cause serious injury; always use two hands when operating the chain saw.

1

WARNING TO REDUCE THE RISK OF INJURY, USER MUST READ INSTRUCTION MANUAL. Do not expose to rain. Use only Toro battery model 88508 & 88509.

AVERTISSEMENT POUR RÉDUIRE LES RISQUES DE BLESSURES, LISEZ ATTENTIVEMENT LE MANUEL DE L'UTILISATEUR. Ne l'exposez pas à la pluie. Utilisez uniquement avec batterie TORO 88508 & 88509.

48V MAX* DC BAR LENGTH: 14" / LONGUEUR DU GUIDE-CHAÎNE: 35cm

*Maximum initial voltage without workload, as rated by battery manufacturer. Under workload, nominal voltage is 43.2V.
*Tension initiale maximale sans charge, telle qu'indiquée par le fabricant de la batterie. Mesurée sous charge, la tension nominale est de 43.2 V.

Country of Origin: China / Pays d'origine: Chine
Manufactured by CHANGZHOU GLOBE CO.,LTD / Fabriqué par CHANGZHOU GLOBE CO.,LTD

Model: **51889** THE TORO COMPANY
Modèle: 8111 Lyndale Avenue South
Bloomington, MN 55420-1196 USA

Serial Number: 218549
Numéro de série: GARDENING
Date Code: APPLIANCES
Code de date:

121-7648

1. Wear ear protection; wear eye protection; do not operate in wet conditions; contact of the guide bar tip with any object should be avoided; tip contact can cause the guide bar to move suddenly upward and backward, which can cause serious injury; always use two hands when operating the chain saw.

1

WARNING TO REDUCE THE RISK OF INJURY, USER MUST READ INSTRUCTION MANUAL. Do not expose to rain. Use only Toro battery model 88508 & 88509.

AVERTISSEMENT POUR RÉDUIRE LES RISQUES DE BLESSURES, LISEZ ATTENTIVEMENT LE MANUEL DE L'UTILISATEUR. Ne l'exposez pas à la pluie. Utilisez uniquement avec batterie TORO 88508 & 88509.

48V MAX* DC BAR LENGTH: 14" / LONGUEUR DU GUIDE-CHAÎNE: 35cm

*Maximum initial voltage without workload, as rated by battery manufacturer. Under workload, nominal voltage is 43.2V.
*Tension initiale maximale sans charge, telle qu'indiquée par le fabricant de la batterie. Mesurée sous charge, la tension nominale est de 43.2 V.

Country of Origin: China / Pays d'origine: Chine
Manufactured by CHANGZHOU GLOBE CO.,LTD / Fabriqué par CHANGZHOU GLOBE CO.,LTD

Model: **51889T** THE TORO COMPANY
Modèle: 8111 Lyndale Avenue South
Bloomington, MN 55420-1196 USA

Serial Number: 218549
Numéro de série: GARDENING
Date Code: APPLIANCES
Code de date:

121-7699

1. Wear ear protection; wear eye protection; do not operate in wet conditions; contact of the guide bar tip with any object should be avoided; tip contact can cause the guide bar to move suddenly upward and backward, which can cause serious injury; always use two hands when operating the chain saw.

TORO 48V MAX* DC 86 Wh
Li-Ion Battery / Batterie au lithium-ion

*Maximum initial voltage without workload, as rated by battery manufacturer. Under workload, nominal voltage is 43.2V DC .

*Tension initiale maximale sans charge, telle qu'indiquée par le fabricant de la batterie. Mesurée sous charge, la tension nominale est de 43.2 V DC .

WARNING To reduce the risk of injury, user must read the instruction manual. Wear eye protection. Do not short terminals. Do not throw into fire. Use only with Toro battery charger 88507 & 88510. When charging make sure temperature is between 5° to 40° C (41° to 104° F), -10° to 45° C (14° to 113° F) for discharge. Risk of fire, explosion and burns. Do not disassemble, crush, expose to heat above 100° C (212° F), or incinerate. Keep battery out of reach of children. To reduce risk of injury to persons, remove battery pack when not in use.

AVERTISSEMENT Pour réduire le risque de blessures, l'utilisateur doit lire le manuel d'utilisation. Portez des lunettes de protection. Ne pas court-circuiter. Ne jetez pas au feu. Utilisez uniquement avec chargeur de batterie Toro 88507 & 88510. Lorsque vous chargez la batterie, assurez-vous que la température est de 5 à 40° C (41 à 104° F), -10 à 45° C (14 à 113° F) pour la décharge. Risque d'incendie, d'explosion et des brûlures. Ne pas démonter, écraser, exposer à une température au-dessus de 100° C (212° F) ou incinérer. Conservez la batterie hors de portée des enfants. Pour réduire les risques de blessures corporelles, retirez l'ensemble batterie quand la machine ne sert pas.

Country of Origin: China / Pays d'origine: Chine

Model: **88508** MH46448
Modèle: LW

Serial Number:
Numéro de série:
Date Code:
Code de date:

125-3240

TORO 48V MAX* DC 172 Wh
Li-Ion Battery / Batterie au lithium-ion

*Maximum initial voltage without workload, as rated by battery manufacturer. Under workload, nominal voltage is 43.2V DC .

*Tension initiale maximale sans charge, telle qu'indiquée par le fabricant de la batterie. Mesurée sous charge, la tension nominale est de 43.2 V DC .

WARNING To reduce the risk of injury, user must read the instruction manual. Wear eye protection. Do not short terminals. Do not throw into fire. Use only with Toro battery charger 88507 & 88510. When charging make sure temperature is between 5° to 40° C (41° to 104° F), -10° to 45° C (14° to 113° F) for discharge. Risk of fire, explosion and burns. Do not disassemble, crush, expose to heat above 100° C (212° F), or incinerate. Keep battery out of reach of children. To reduce risk of injury to persons, remove battery pack when not in use.

AVERTISSEMENT Pour réduire le risque de blessures, l'utilisateur doit lire le manuel d'utilisation. Portez des lunettes de protection. Ne pas court-circuiter. Ne jetez pas au feu. Utilisez uniquement avec chargeur de batterie Toro 88507 & 88510. Lorsque vous chargez la batterie, assurez-vous que la température est de 5 à 40° C (41 à 104° F), -10 à 45° C (14 à 113° F) pour la décharge. Risque d'incendie, d'explosion et des brûlures. Ne pas démonter, écraser, exposer à une température au-dessus de 100° C (212° F) ou incinérer. Conservez la batterie hors de portée des enfants. Pour réduire les risques de blessures corporelles, retirez l'ensemble batterie quand la machine ne sert pas.

Country of Origin: China / Pays d'origine: Chine

Model: **88509** MH46448
Modèle: LW

Serial Number:
Numéro de série:
Date Code:
Code de date:

125-3299

Setup

Assembling the Bar and Chain

DANGER

Contact with the chain saw teeth can cause serious injury.

- Remove the battery before performing any adjustments or maintenance to the chain saw.
- Always wear gloves when performing any adjustments of maintenance to the chain saw.

If the bar and chain are not already installed, perform the following steps:

1. Place the chain saw on a level surface.
2. Remove the two bolts that secure the cover (Figure 1).

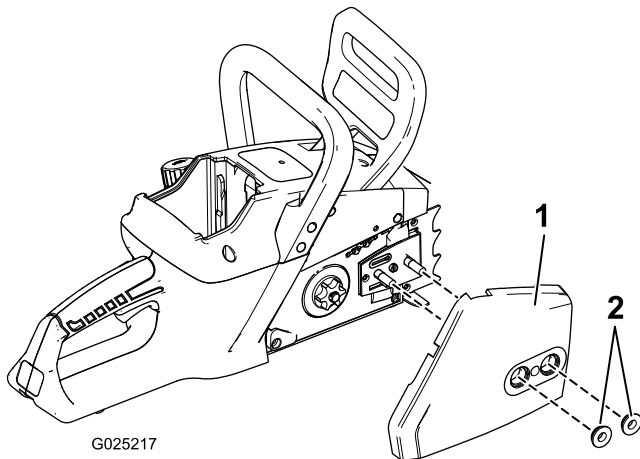

Figure 1

1. Cover
2. Nuts

3. Turn the chain tensioning bolt to the left to move the mounting plate close to the sprocket (Figure 2).

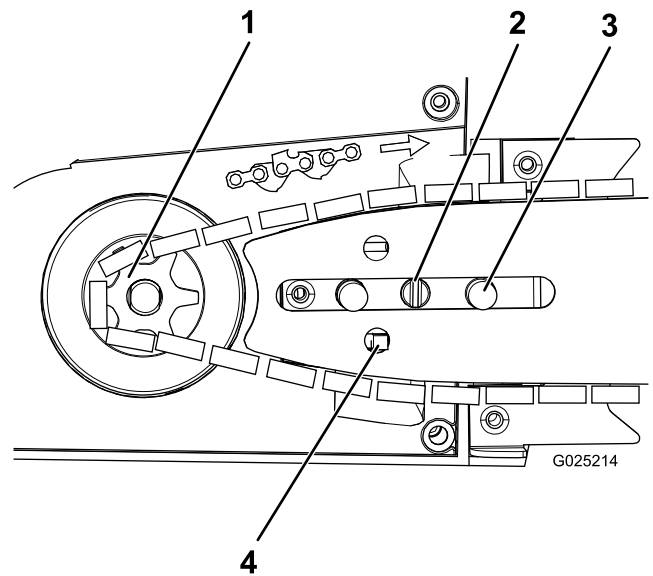

Figure 2

1. Sprocket
2. Tensioning bolt
3. Stud (2)
4. Adjusting pin

4. Align the bar with the two studs and the adjusting pin.
5. Place the chain around the drive sprocket, with the teeth of the chain facing away from the sprocket (Figure 2).
6. Feed the chain into the groove in the bar.
7. Install the cover and the nuts, but do not fully tighten the nuts.
8. Hold up the tip of the bar (Figure 3).

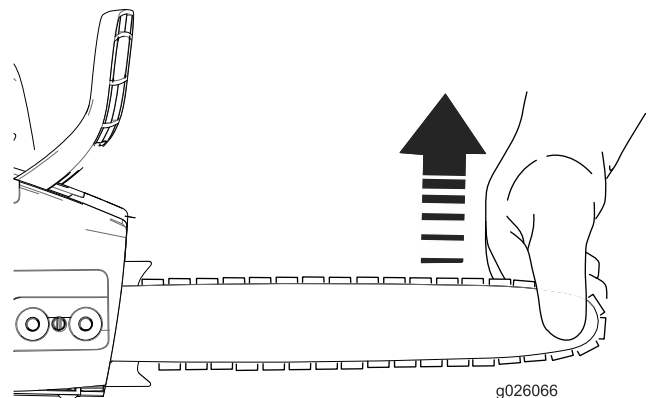

Figure 3

9. Tighten the chain by turning the tensioning bolt to the right (Figure 2), until the chain touches the underside of the bar.
10. Tighten the 2 nuts (Figure 1).
11. Check the chain tension. If more tensioning is required, repeat this procedure starting at 7.

Note: The chain tension is correct when you are able to use a gloved hand to pull the chain smoothly around the blade bar

Note: A new chain may need adjusting after it's first use. Refer to Adjusting the Chain Tension (page 14).

Filling the Chain Saw With Oil

1. Place the chain saw on a flat surface and remove the battery.
2. Clean the area around the oil cap (Figure 4).

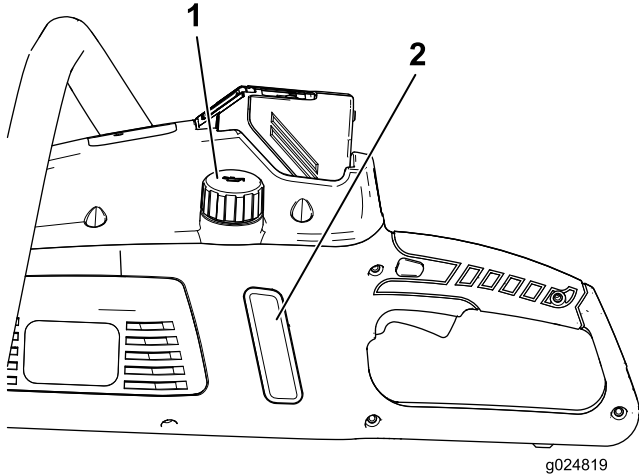

Figure 4

1. Oil cap
2. Window

-
3. Remove the cap and pour oil into the chain saw until the oil fills the window (Figure 4).

Note: Do not fill the chain saw higher than the bottom of the fill neck.

4. Clean up any spilled oil and replace the oil cap.

Operation

Important: The battery pack is not fully charged when it is purchased. Refer to Charging the Battery Pack (page 11).

Starting the Chain Saw

1. Set the chain saw down on a level surface.
2. Align the tongue of the battery pack with the battery cavity in the chain saw (Figure 5).

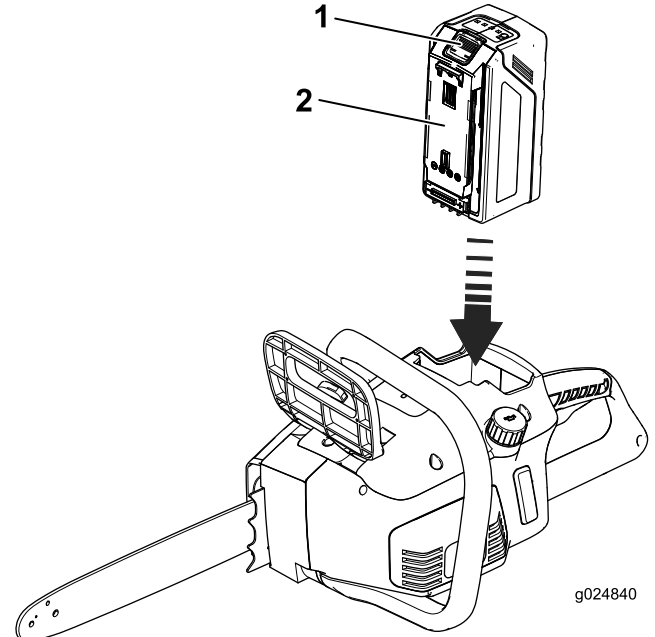

Figure 5

1. Latch
2. Tongue

-
3. Push the battery pack into the battery cavity until the latch locks into place.
 4. With one hand on the auxiliary handle and the other on the trigger handle, press the trigger lock, then squeeze the trigger to start the chain saw (Figure 6).

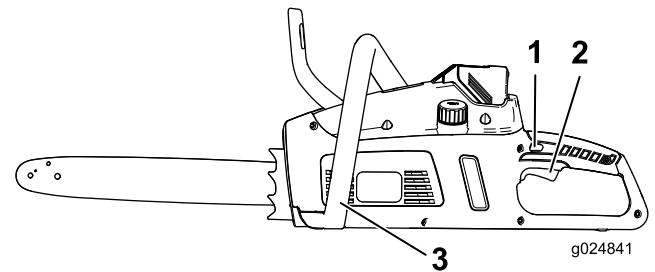

Figure 6

1. Trigger lock
2. Trigger switch
3. Auxiliary handle

Understanding the Automatic Motor Stop and Chain Brake

When the battery is at risk of overheating or the battery is delivering a high amperage, the motor will stop to prevent any damage to the battery, and the light will flash (Figure 7).

Release the trigger switch, then press the trigger switch. If the motor does not start, allow the battery to cool before continuing operation.

Note: Removing the battery from the chain saw may help the battery to cool down quicker.

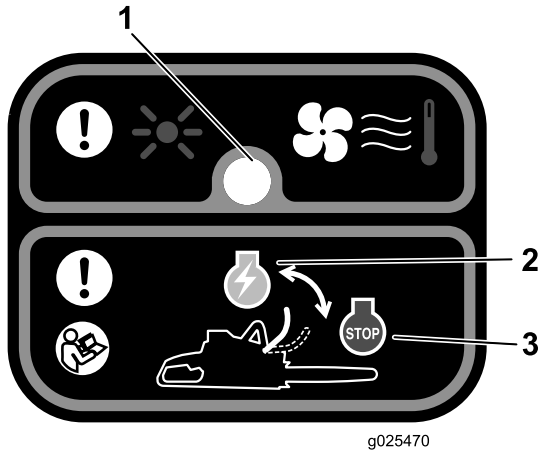

Figure 7

1. Battery overheating or high amp—light will flash
2. Hand guard not activated—motor will run if trigger lock and trigger switch are held.
3. Hand guard activated—motor will not run.

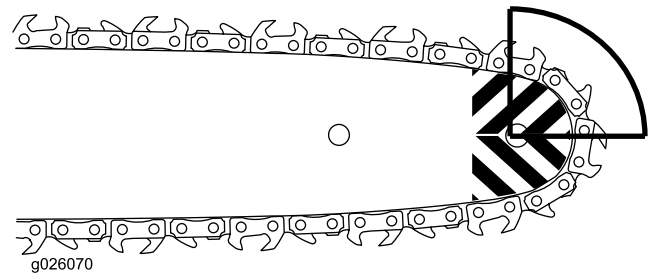

Figure 8

When kickback occurs, the hand guard moves forward to the stop position (Figure 9), activating the chain brake that stops the chain and motor.

Note: It is safe practice to activate the chain brake when transporting the chain saw.

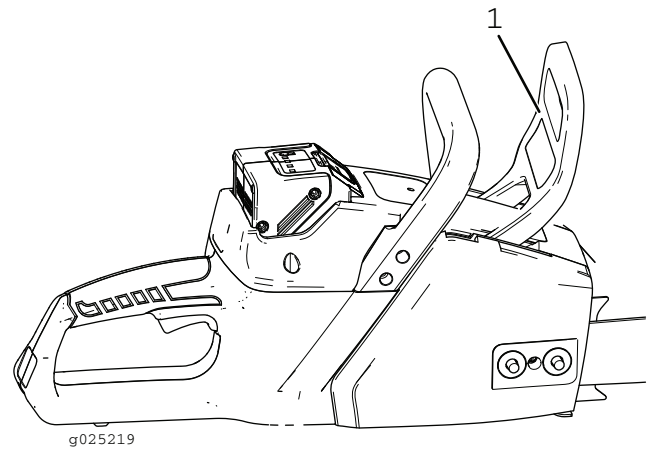

Figure 9

1. Hand guard—stop position

⚠ WARNING

Kickback can cause serious or fatal injury to the operator.

Always ensure the chain brake system is working properly before operation.

The two types of kickback are as follows:

- A fast upward motion of the chain saw that occurs when the chain at the nose or top of the bar (Figure 8) contacts an object.
- A fast backward motion of the chain saw that occurs when the chain at the nose or top of the bar (Figure 8) is pinched by the object being cut.

To restart the motor, move the hand guard back to the operation position (Figure 10).

Note: There is an audible click to indicate that the hand guard has been moved to the operating position.

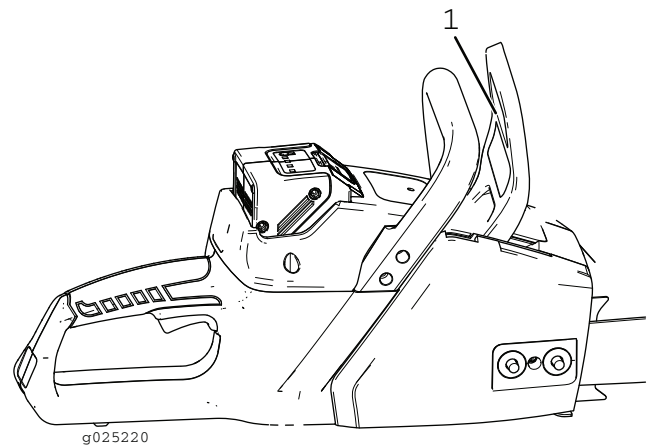

Figure 10

1. Hand guard—operation position

Stopping the Chain Saw

To stop the chain saw, release the trigger switch.

Cutting

1. Grip the chain saw with two hands as shown in (Figure 11).

Note: Keeping your left arm straight with your elbow locked will help reduce any kickback.

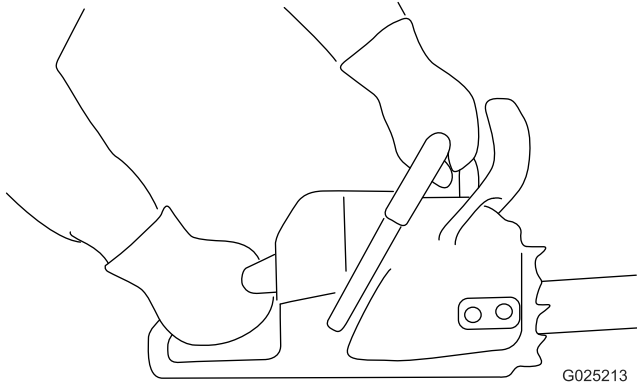

Figure 11

2. Stand on solid, even ground in front of the wood to be cut.
3. Press the chain saw lightly against the wood, allowing the weight of the chain saw to drive the cutting.
4. Keep steady pressure on the chain saw throughout the cut, and only release pressure near the end of the cut.

Pruning

1. Before pruning, ensure that all bystanders are away from the area where branches may fall.
2. Grip the chain saw as shown in (Figure 11).
3. For small branches, apply light pressure to the branch to be cut.
4. For larger branches, make a shallow undercut and then complete the cut from the topside of the branch.

Felling a Tree

1. Before starting the felling process, determine an appropriate retreat path. Refer to Figure 12.

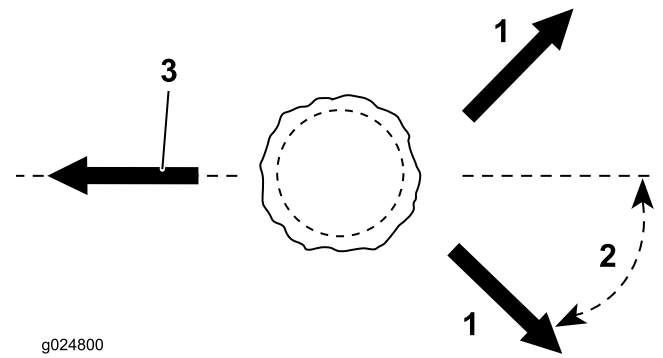

Figure 12

1. Retreat path
2. 45 degree angle
3. Direction of fall

2. Grip the chain saw as shown in (Figure 11).
3. Make a notching undercut that goes in one-third the diameter of the tree, perpendicular to the desired direction of fall (Figure 13).

Note: Making the undercut first will prevent the chain saw from being pinched while making the second notch.

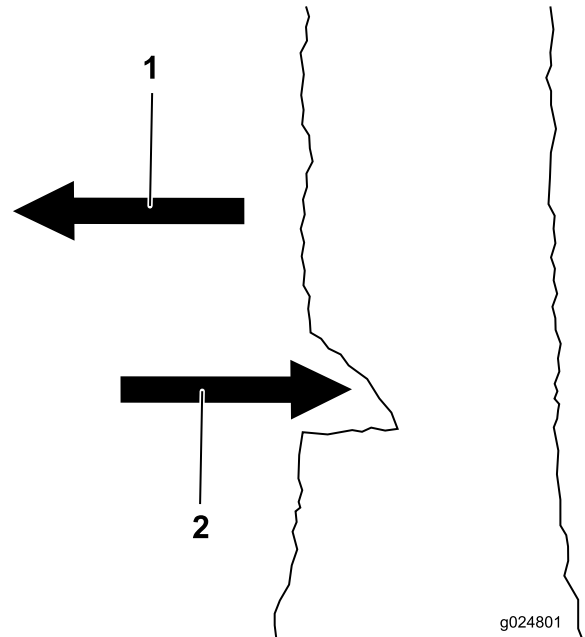

Figure 13

1. Direction of fall
2. Notching undercut

4. Make a back cut parallel to the notching undercut, keeping the back cut at least 51 mm (2 inches) above and away from the notching undercut (Figure 14).

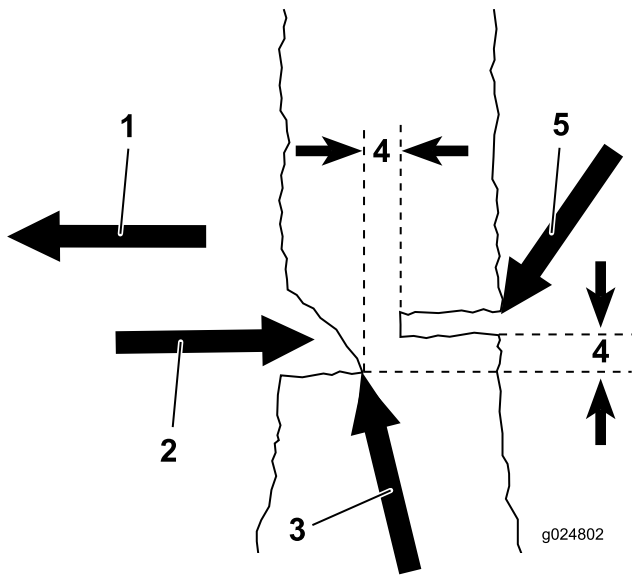

Figure 14

1. Direction of fall
2. Notching undercut
3. Hinge
4. 51 mm (2 inches)
5. Back cut

5. As the back cut nears the hinge (Figure 14), the tree should begin to fall. Remove the chain saw, stop the blade by releasing the trigger, place the chain saw down, and retreat along the path you determined in 1.

Important: If the tree begins to fall in an undesired direction, immediately stop the cut and use a wedge to open the cut and push the tree in the desired direction.

Limbing a Tree

1. Grip the chain saw as shown in (Figure 11).
2. First cut the smaller branches, leaving larger, supporting branches for last (Figure 15).

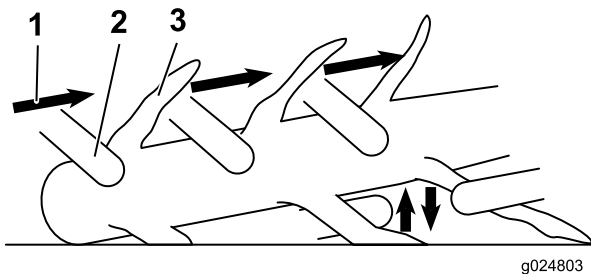

Figure 15

1. Direction of cut
2. Chain saw
3. Limb

3. If a branch is under tension, cut it from the underside to prevent binding of the chain saw (Figure 15).

Bucking a Log

If the log is supported along its entire length, cut all the way through the log from the top (Figure 16).

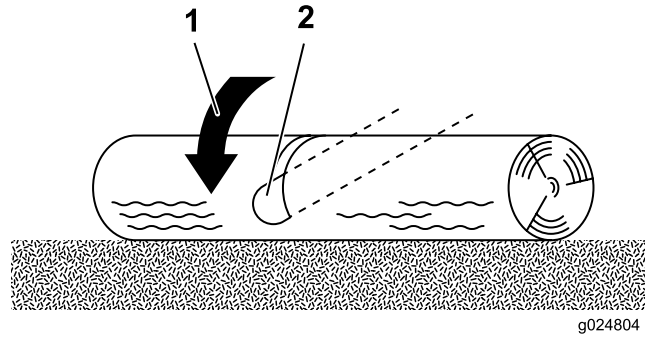

Figure 16

1. Cut from the top
2. Chain saw

If the log is supported on one end, cut one-third of the diameter from the bottom, then cut from the top to meet the first cut (Figure 17).

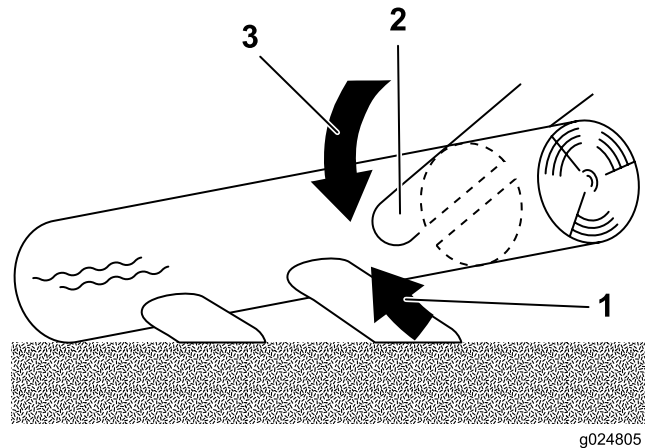

Figure 17

1. One-third diameter cut from the bottom
2. Chain saw
3. Second cut from the top

If the log is supported on both ends but not in the middle, cut one-third of the diameter from the top, then cut from the bottom to meet the first cut (Figure 18).

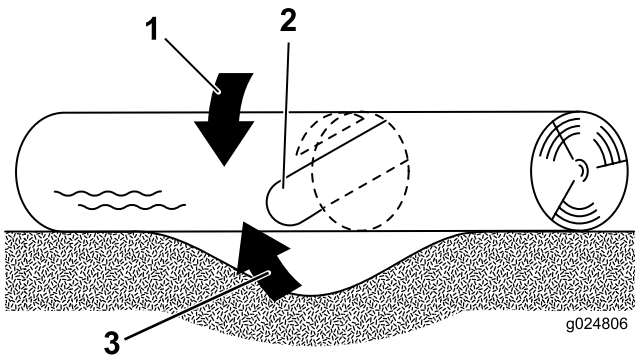

Figure 18

1. One-third diameter cut from the top
2. Chain saw
3. Second cut from the bottom

If the log is on a hill, always stand on the uphill side of the log (Figure 19).

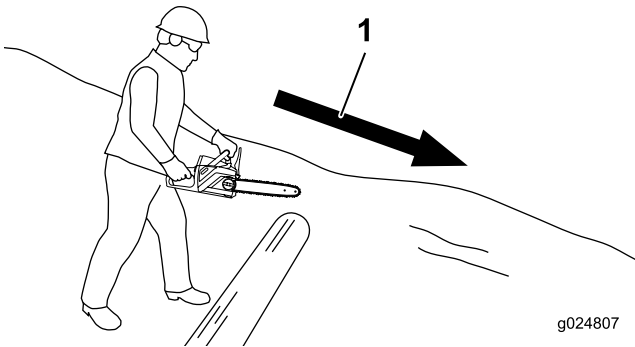

Figure 19

1. Direction of slope

Removing the Battery

1. Place the chain saw on a flat surface.
2. Press down on the latch and remove the battery from the cavity.

Note: If you have trouble removing the battery, apply some dielectric grease to the battery terminals (Figure 21). Do not use any other type of lubricant as it can cause damage to the terminals.

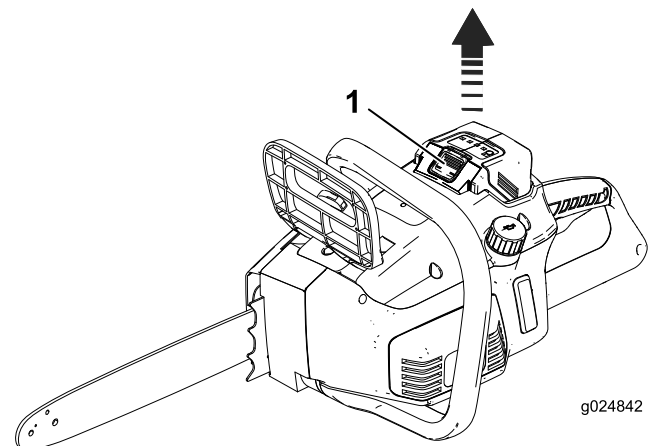

Figure 20

1. Latch

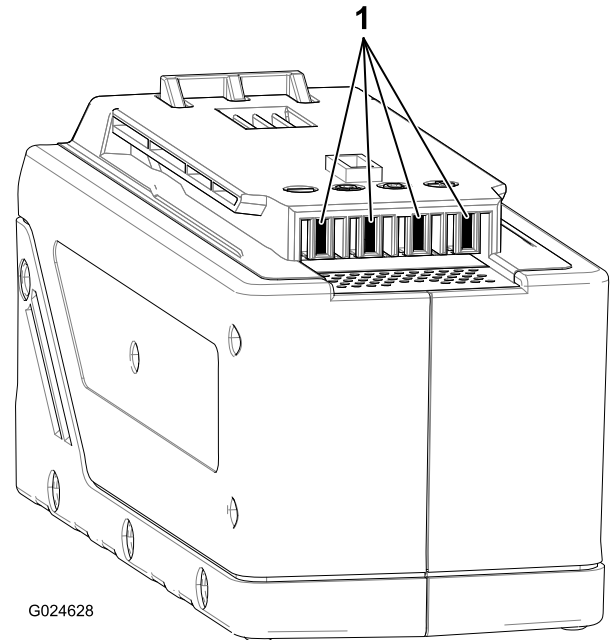

Figure 21

1. Battery terminals

Charging the Battery Pack

⚠ WARNING

CALIFORNIA

Proposition 65 Warning

Battery posts, terminals, and related accessories contain lead and lead compounds, chemicals known to the State of California to cause cancer and reproductive harm.

Wash hands after handling.

Important: For best results, your battery tool should be charged in a location where the temperature is more

than 5° C (41° F) but less than 40° C (104° F). To reduce the risk of serious personal injury, do not store outside or in vehicles. Charging time will be increased if not charged within this range.

1. If the power cord is not plugged in to the charger, plug it in to the charger (Figure 22), then plug the power cord into a power socket.
2. Turn the battery upside down and line up the battery terminal with the slot in the charger (Figure 22 and Figure 23).

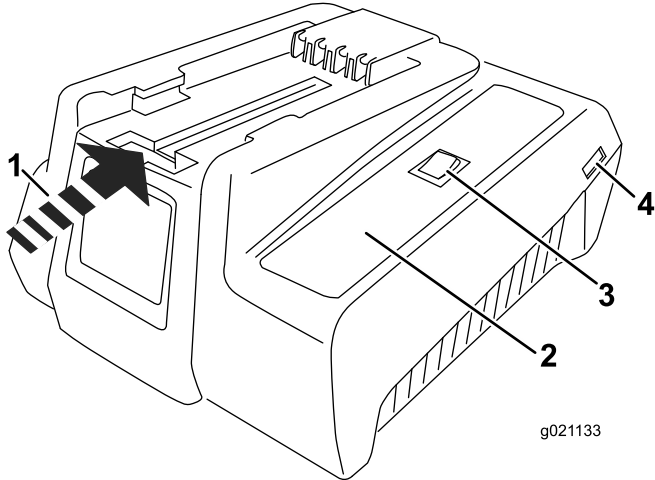

Figure 22

- | | |
|------------------------|--------------------------------|
| 1. Insert battery here | 3. Charge/storage mode switch |
| 2. LED indicators | 4. Power cord plug-in location |

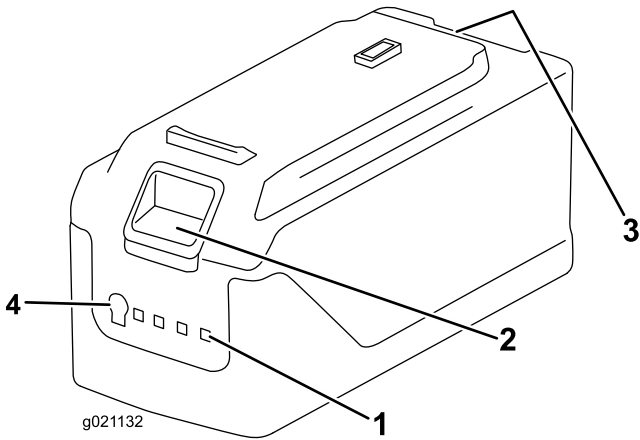

Figure 23

- | | |
|-------------------------------------|---------------------|
| 1. LED indicators (level of charge) | 3. Battery terminal |
| 2. Release button | 4. Test button |

3. Slide the battery into the charger until it clicks into place.
4. To remove the battery, pull up on the release button and slide the battery backwards out of the charger.

5. Refer to Figure 24 to interpret the LED indicators on the battery charger.

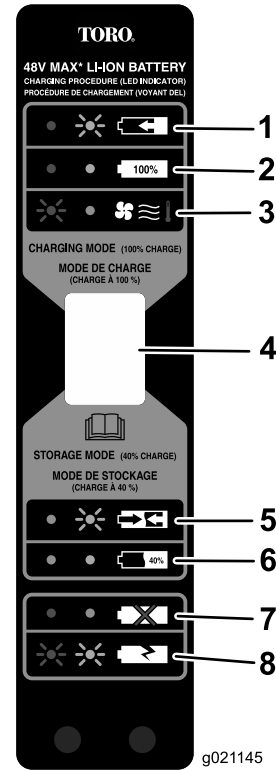

Figure 24

- | | |
|--|--|
| 1. Red light on; green light flashing—battery is charging. | 5. Red light off; green light flashing—battery is preparing for storage. |
| 2. Red light on; green light on—battery is fully charged. | 6. Red light off; green light on—battery is prepared for storage. |
| 3. Red light flashing; green light off—abnormal battery temperature (greater than 40 C (104 F) or less than 5 C (41 F)). | 7. Red light on; green light off—no battery inserted. |
| 4. Charge/storage mode switch | 8. Red light flashing; green light flashing—battery is defective. |

Important: If the charger indicates an abnormal battery temperature, allow the battery to cool or warm up as needed before inserting the battery into the charger.

Storing a lithium-ion battery at 40% of its capacity maximizes battery life.

Use storage mode (Figure 24) when the battery will not be used for 1 month or longer.

1. Insert the battery into the charger.
2. Turn storage mode on.
3. The battery will charge or discharge as necessary to approximately 40% charge.
4. When the battery is ready for storage (Figure 24, item 6.), remove the battery from the charger.

Maintenance

Recommended Maintenance Schedule(s)

Maintenance Service Interval	Maintenance Procedure
Before each use or daily	<ul style="list-style-type: none"> • Check the oil level. • Check the chain brake. • Clean the bar groove and oil passage holes. • Check the sprocket for wear. • Check the wear on the bar. • Check the wear on the chain.
After each battery drain cycle	<ul style="list-style-type: none"> • Adjust the chain tension.

Adding Oil to the Chain Saw

Service Interval: Before each use or daily

1. Place the chain saw on a flat surface and remove the battery.
2. Check the window. If the oil cannot be seen in the window, oil needs to be added to the chain saw (Figure 25).

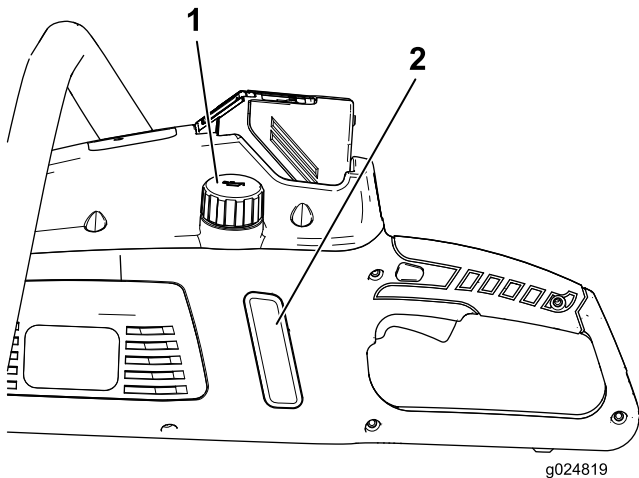

Figure 25

1. Oil cap
2. Window

3. Clean the area around the oil cap (Figure 25).
4. Remove the cap and pour oil into the chain saw until the oil fills the window (Figure 25).

Note: Do not fill the chain saw higher than the bottom of the fill neck.

5. Clean up any spilled oil and replace the oil cap.

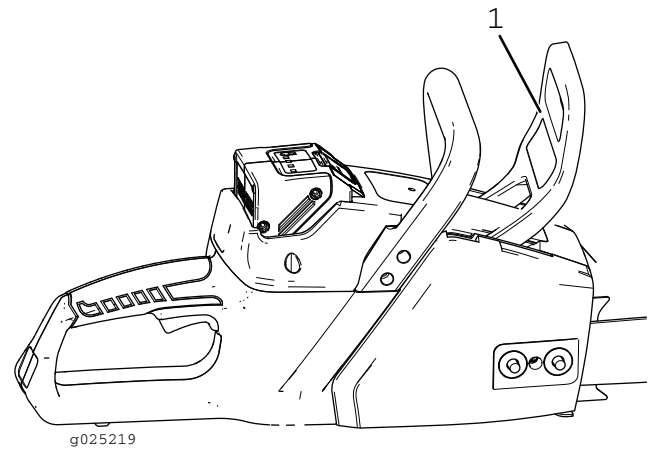

Figure 26

1. Hand brake—stop position
3. Using a gloved hand, grip the chain and attempt to pull it around the bar.
4. If the chain brake is working properly, the chain will not rotate around the bar.
5. Disengage the hand brake, then pull the chain around the bar to ensure that the hand brake disengages properly.

Cleaning the Bar Groove and Oil Passage Holes

Service Interval: Before each use or daily

1. Place the chain saw on a flat surface and remove the battery.
2. Remove the two nuts that secure the cover (Figure 27).

Checking the Chain Brake

Service Interval: Before each use or daily

1. Place the chain saw on a flat surface and remove the battery.
2. Engage the chain brake by pushing the hand brake forward to the stop position (Figure 26).

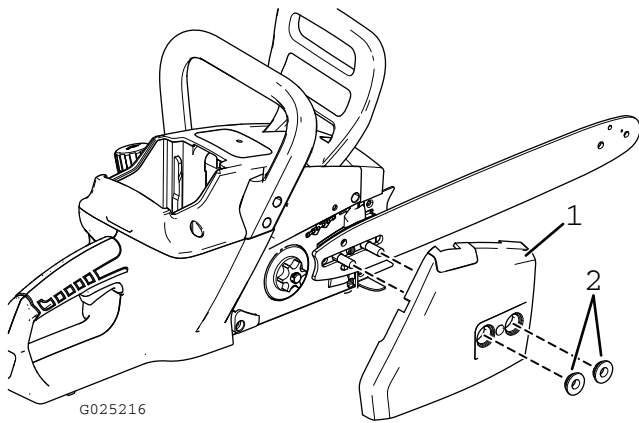

Figure 27

- 1. Cover
- 2. Nuts

- 3. Remove the chain from the bar and remove the bar.
- 4. Check the bar grooves and the oil passage hole for debris, and clean it if necessary (Figure 28).

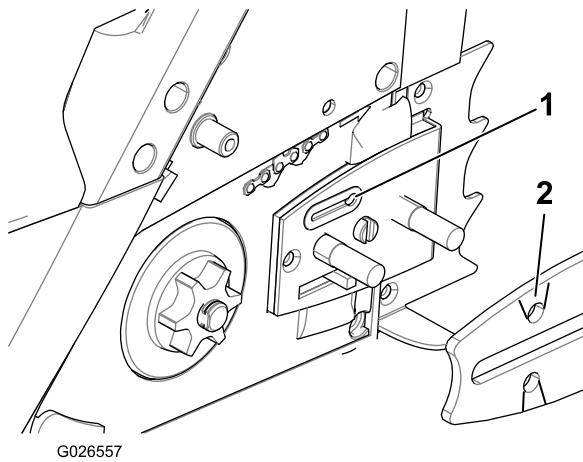

Figure 28

- 1. Oil passage
- 2. Oil groove

- 5. Install the chain, bar, and cover. Refer to Replacing the Bar and Chain (page 15).

Adjusting the Chain Tension

Service Interval: After each battery drain cycle



Contact with the chain saw teeth can cause serious injury.

- Remove the battery before performing any adjustments or maintenance to the chain saw.
- Always wear gloves when performing any adjustments of maintenance to the chain saw.

Check the chain tension by pulling the chain around the blade bar using a gloved hand.

Note: The chain should move smoothly around the blade bar when pulled by hand, and should remain in contact with the underside of the bar (Figure 29).

If the chain tension needs to be adjusted, perform the following steps:

- 1. Place the chain saw on a level surface.
- 2. Loosen the 2 nuts on the cover without removing the cover (Figure 29).

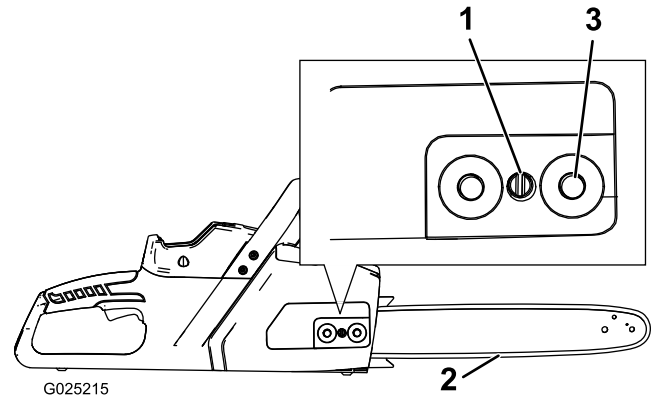

Figure 29

- 1. Tensioning bolt
- 2. Chain
- 3. Nut (2)

- 3. Hold up the tip of the bar (Figure 30).

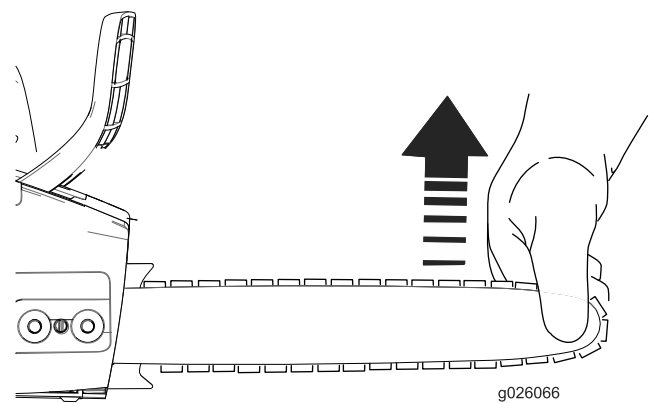

Figure 30

- 4. Tighten the chain by turning the tensioning bolt to the right, until the chain touches the underside of the bar.
- 5. Tighten the 2 nuts (Figure 29).
- 6. Check the chain tension. If more tensioning is required, repeat this procedure .

Checking and Replacing the Sprocket

Service Interval: Before each use or daily

- 1. Remove the cover, chain and guide bar; refer to Replacing the Bar and Chain (page 15).
- 2. Remove the E-clip (Figure 31).

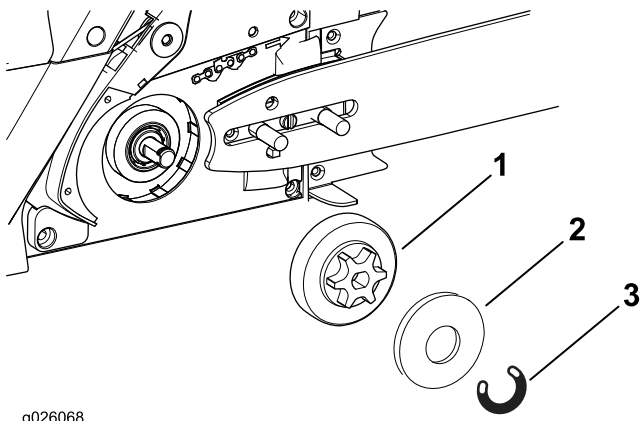

g026068

Figure 31

- | | |
|-------------|-----------|
| 1. Sprocket | 3. E-clip |
| 2. Spacer | |

3. Remove the spacer (Figure 31).
4. Remove the sprocket.
5. If the wear marks on the sprocket are deeper than 0.5 mm (0.02 in) it should be replaced (Figure 31).
 - A. Place the new sprocket on the crankshaft.
 - B. Place the spacer and clip onto the new sprocket.
 - C. Install the guide bar and the chain.
 - D. Check the chain tension; refer to Adjusting the Chain Tension (page 14).

Replacing the Bar and Chain

Service Interval: Before each use or daily
Before each use or daily



Contact with the chain saw teeth can cause serious injury.

- **Remove the battery before performing any adjustments or maintenance to the chain saw.**
- **Always wear gloves when performing any adjustments of maintenance to the chain saw.**

1. Place the chain saw on a level surface.
2. Remove the battery.
3. Remove the two nuts that secure the cover (Figure 32).

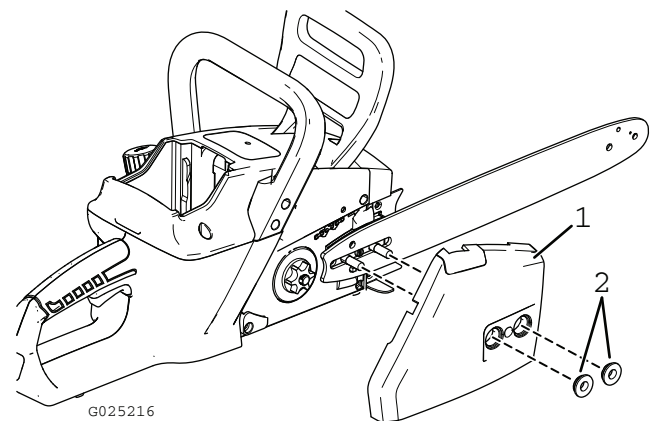

G025216

Figure 32

- | | |
|----------|---------|
| 1. Cover | 2. Nuts |
|----------|---------|

4. Loosen the chain by turning the chain-tightening screw to the left (Figure 33).

Note: The blade bar will move closer to the drive sprocket.

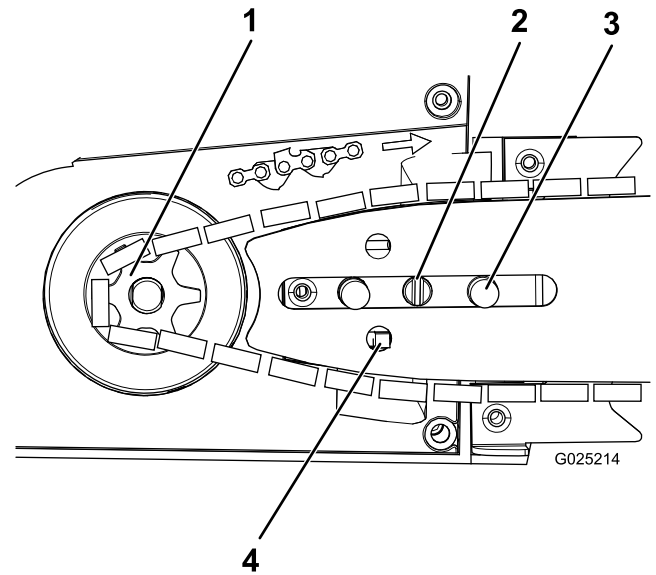

G025214

Figure 33

- | | |
|--------------------|------------------|
| 1. Sprocket | 3. Stud (2) |
| 2. Tensioning bolt | 4. Adjusting pin |

5. Separate the chain from the blade.
6. Align the bar with the two studs and the adjusting pin (Figure 33).
7. Place the new chain around the drive sprocket, with the teeth of the chain facing away from the sprocket (Figure 33).
8. Feed the chain into the groove in the blade bar.
9. Install the cover and the nuts, but do not fully tighten the nuts.
10. Hold up the tip of the bar (Figure 34).

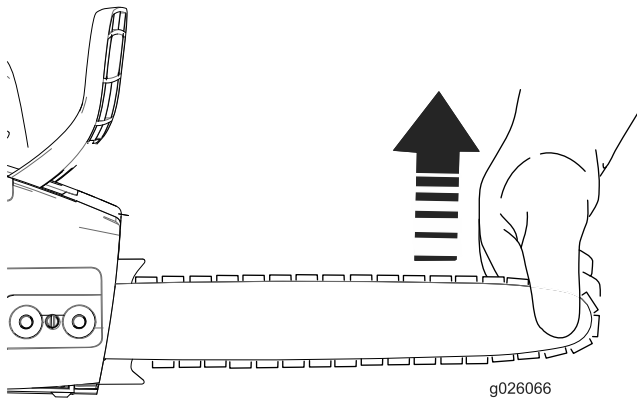

Figure 34

11. Tighten the chain by turning the tensioning bolt to the right (Figure 33), until the chain touches the underside of the bar.
12. Tighten the 2 nuts (Figure 32).
13. Check the chain tension. If more tensioning is required, repeat this procedure starting at 9.

Note: The chain tension is correct when you are able to use a gloved hand to pull the chain smoothly around the blade bar

Battery Pack Preparation For Recycling

⚠ WARNING

Upon removal, cover the battery pack's terminals with heavy-duty adhesive tape. Do not attempt to destroy or disassemble the battery pack or remove any of its components. Lithium-ion batteries must be recycled or disposed of properly at the nearest battery recycling facility.

Service

Should this item need service, take the product to your Authorized Toro Service Dealer. Your Toro Dealer is specially trained to repair Toro products and will ensure that your Toro stays "All" Toro.

Storage

- When storing or transporting the chain saw, always place the protective cover over the chain saw blade.
- Clean all foreign material from the product.
- Store it in a well-ventilated place that is inaccessible to children.
- Keep away from corrosive agents such as garden chemicals and de-icing salts.

Troubleshooting

Using the battery when it is hot can reduce the operating time. The battery will automatically stop working when it is overheated to prevent damage to it. Remove the battery from the charger and allow it to cool before placing it back into the chain saw.

Using the battery when there is moisture on the leads can cause the chain saw to malfunction. Allow the battery to dry or wipe it dry before placing it back into the chain saw.

Problem	Possible Cause	Corrective Action
The chain oil is not lubricating properly.	1. The oil port is plugged.	1. Clean out any debris from the oil port.
	2. The oil groove in the bar is plugged/	2. Clean out any debris from the oil groove.

Problem	Possible Cause	Corrective Action
The motor does not run or runs intermittently.	<ol style="list-style-type: none"> 1. The chain brake is engaged. 2. The battery is low on charge. 3. The battery is not fully seated. 4. The battery is too hot. 5. The battery has exceeded high amperage limits. 6. There is debris under the cover. 	<ol style="list-style-type: none"> 1. Disengage the chain brake by pulling the hand guard toward the handle until there is an audible click. 2. Charge the battery. 3. Make sure the battery is pushed all the way into the housing. 4. Allow the battery to cool. 5. Release the trigger switch, then press the trigger switch. 6. Remove the cover and clean out any debris.
The motor is running, but the chain does not rotate.	<ol style="list-style-type: none"> 1. The chain is not properly seated on the sprocket. 	<ol style="list-style-type: none"> 1. Reinstall the chain and ensure the links are properly seated in the sprocket.
The chain brake does not engage.	<ol style="list-style-type: none"> 1. There is a chain brake malfunction 	<ol style="list-style-type: none"> 1. Immediately take the chain saw to a local service location.
The chain saw does not properly cut.	<ol style="list-style-type: none"> 1. The chain is not tensioned correctly. 2. The chain is dull. 3. The chain is installed backwards. 4. The chain is dry. 	<ol style="list-style-type: none"> 1. Set the proper tension on the chain. 2. Replace the chain. 3. Reinstall the chain. 4. Check the oil level.

Notes:

Notes:

The Toro Promise - Electric Products

A Three-Year Full Warranty for Residential Use for the United States and Canada

The Toro Company and its affiliate, Toro Warranty Company, pursuant to an agreement between them, jointly warrant this product for three years against defects in material or workmanship when used for normal residential purposes.*

If you think your Toro Product contains a defect in materials or workmanship, if you have questions or problems, and before returning this product call toll free:

Trimmers:

1-800-237-2654 (US)
1-800-248-3258 (Canada)

Blowers:

1-888-367-6631 (US)
1-888-430-1687 (Canada)

Snowthrowers:

1-800-808-2963 (US)
1-800-808-3072 (Canada)

To receive a replacement or repair, at our option, return the complete unit to the seller. United States and Canada customers may return their product, with proof of purchase, to any Authorized Service Dealer. United States customers may also return their product, with proof of purchase, postage prepaid, to the Toro Service Center, 5500 SE Delaware, Ankeny, IA 50021.

This warranty covers product defects only. **Neither The Toro Company nor Toro Warranty Company is liable for indirect, incidental, or consequential damages in connection with the use of the Toro Products covered by this warranty, including any cost or expense of providing substitute equipment or service during reasonable periods of malfunction or non-use pending completion of repairs under this warranty. Some states do not allow exclusions of incidental or consequential damages, so the above exclusions may not apply to you.** This warranty gives you specific legal rights, and you may also have other rights which vary from state to state.

Countries Other than the United States and Canada

Customers who have purchased Toro products exported from the United States or Canada should contact their Toro Distributor (Dealer) to obtain guarantee policies for your country, province, or state. If for any reason you are dissatisfied with your Distributor's service or have difficulty obtaining guarantee information, contact the Toro importer. If all other remedies fail, you may contact us at Toro Warranty Company.

Australian Consumer Law

Australian customers will find details relating to the Australian Consumer Law either inside the box or at your local Toro Dealer.

* Residential use means use of the product on the same lot as your home.

Part Number 374-0262 Rev. F