



**CE Guard Kit**  
**Greensmaster® 3150 2-Wheel Drive Traction Unit**  
Model No. 04440

Form No. 3387-832 Rev A

**Installation Instructions**

# Installation

1. Insert the side tabs of the inner guard into the engine bell housing (Figure 1).
2. Attach the outer guard to the inner guard using 2 flange-head nuts (Figure 1).

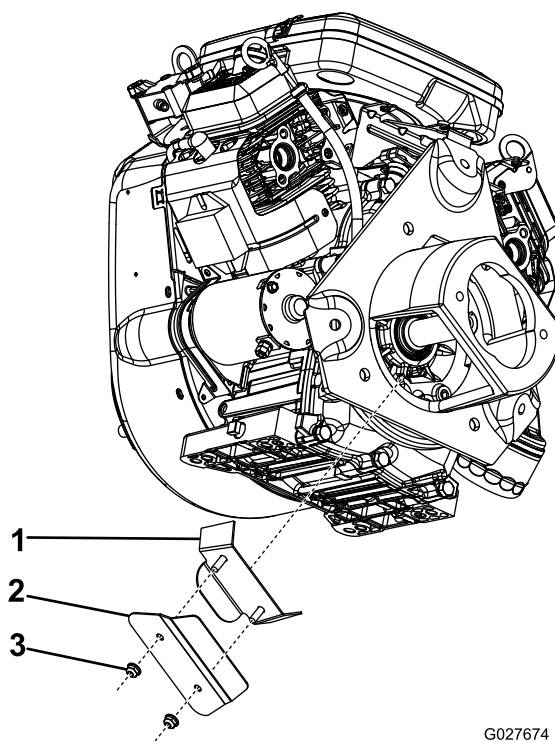

G027674

**Figure 1**

1. Inner guard
2. Outer guard
3. Flange-head nut

