



22in Reel Carrier

Pro Sneak 360 and 365 Vibratory Plow

Model No. 25419

Model No. 25419E

Installation Instructions

Installation

Loose Parts

Use the chart below to verify that all parts have been shipped.

Procedure	Description	Qty.	Use
1	Reel-carrier arms	2	Install the reel carrier.
	Reel-carrier pipe	1	
	Stop collar	4	
	Set screw (3/8 inch)	4	
	Clevis pin	4	
	Cotter pin	4	
2	ROPS-cable-guide bracket	1	Install the cable guides.
	U-bolt (4 inches)	1	
	Locknut (3/8 inch)	2	
	Spacers	4	
	Hood-cable-guide bracket (model 25400 only)	1	
	Nut (5/16) (model 25400 only)	2	
	Bolt (5/16 x 3/4 inch) (model 25400 only)	2	
	Bent hood-cable-guide bracket (model 25403 only)	1	
	Bolt (5/16 x 1 inch) (model 25403 only)	2	



1

Installing the Reel Carrier

Parts needed for this procedure:

2	Reel-carrier arms
1	Reel-carrier pipe
4	Stop collar
4	Set screw (3/8 inch)
4	Clevis pin
4	Cotter pin

1. Insert the reel carrier arms into the channels on each side of the machine as shown in Figure 1 and secure the arms with a cotter pin and clevis pin.

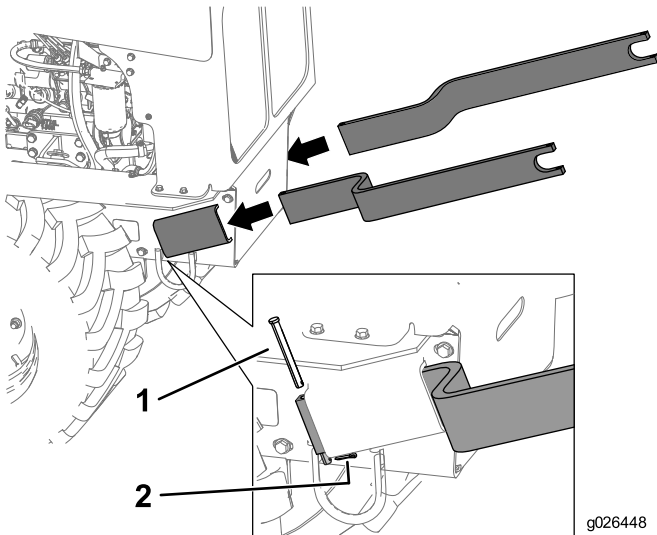

Figure 1

1. Clevis pin
2. Cotter pin

2. Install the 2 stop collars on the reel-carrier pipe, and place the pipe on the reel-carrier bracket so that the stop collars are on the inside of the bracket guide (Figure 2).

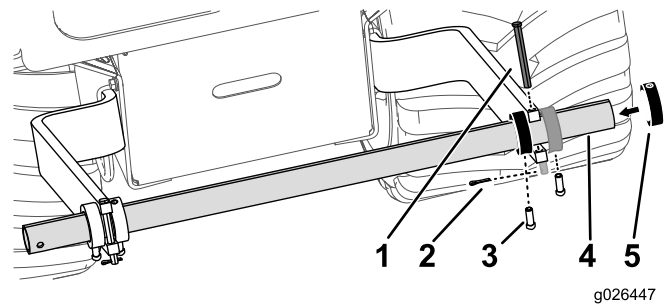

Figure 2

1. Clevis pin
 2. Cotter pin
 3. Set screw (3/8 inch)
 4. Reel carrier pipe
 5. Stop Collar
3. Install the 2 outside stop collars on the reel-carrier pipe, and secure the stop collars with 4 set screws (3/8 inch) as shown in Figure 2.
 4. Insert the 2 clevis pins to lock in the reel carrier pipe and secure them with the 2 cotter pins (Figure 2).

2

Installing the Cable Guides

Parts needed for this procedure:

1	ROPS-cable-guide bracket
1	U-bolt (4 inches)
2	Locknut (3/8 inch)
4	Spacers
1	Hood-cable-guide bracket (model 25400 only)
2	Nut (5/16) (model 25400 only)
2	Bolt (5/16 x 3/4 inch) (model 25400 only)
1	Bent hood-cable-guide bracket (model 25403 only)
2	Bolt (5/16 x 1 inch) (model 25403 only)

Installing the Cable Guides for the ProSneak 360

1. Raise the hood of the machine and support the hood with the prop rod.
2. Mount the hood-cable-guide bracket on the outside of the hood and place the 2 bolts (5/16 x 3/4 inch) through the holes on the bracket and the machine, and secure the bracket with the 2 nuts (5/16 inch) on the inside of the hood (Figure 3).

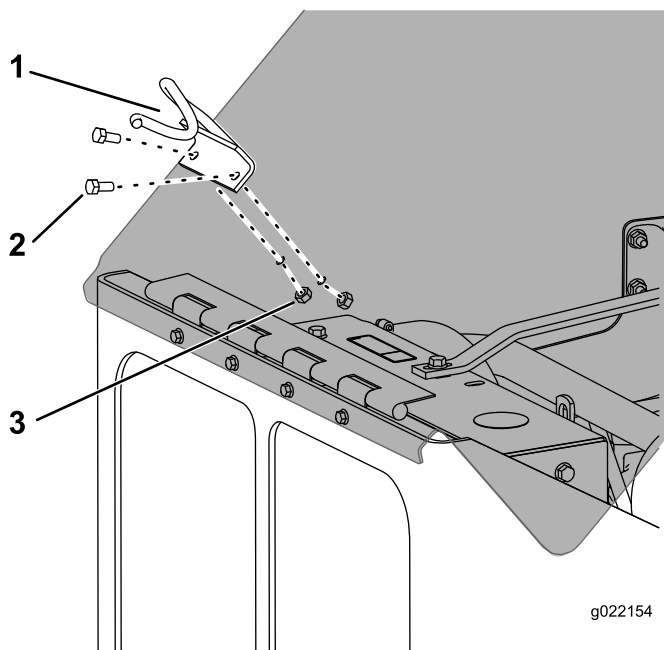

Figure 3

1. Bolt (5/16 x 3/4 inch)
2. Hood-cable-guide bracket
3. Nut (5/16 inch)

3. Secure the ROPS-cable-guide bracket using 1 U-bolt (4 inches), 4 spacers, and 2 locknuts (3/8 inch) as shown in Figure 6.

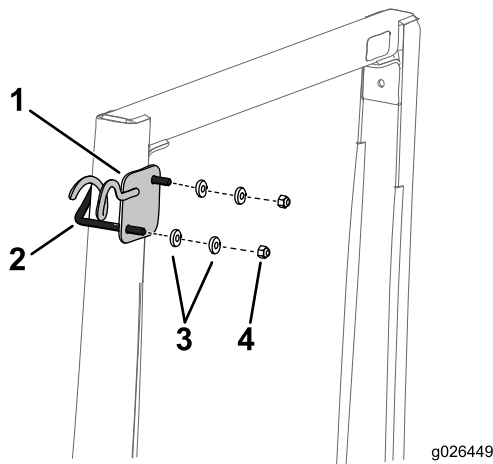

Figure 4

1. ROPS-cable-guide bracket
2. U-bolt
3. Spacers
4. Locknut (3/8 inch)

Installing the Cable Guides for the ProSneak 365

1. Open the right or left side panels of the machine hood.
2. Remove the existing bolts and nuts between the front nose cone and the center strip.

Note: Do not discard the nuts.

3. Secure the bent cable-guide bracket between the center strip and the front nose cone using 2 bolts (5/16 x 1 inch) and the 2 nuts previously removed (Figure 5).

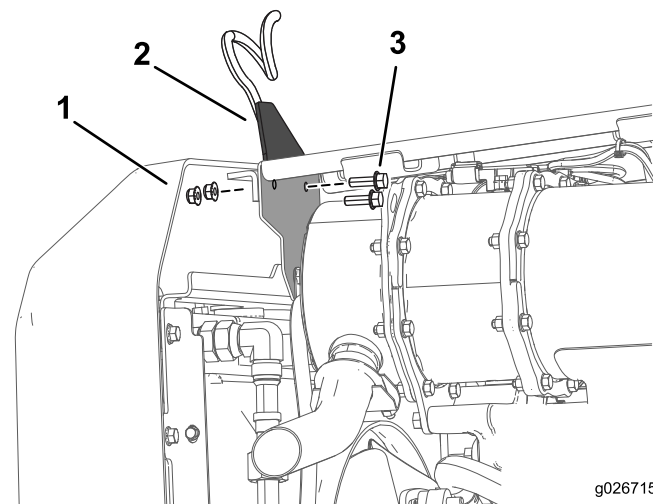

Figure 5

1. Nuts
2. Bracket
3. Bolts

4. Secure the ROPS-cable-guide bracket using 1 U-bolt (4 inches), 2 spacers, and 2 locknuts (3/8 inch) as shown in Figure 6.

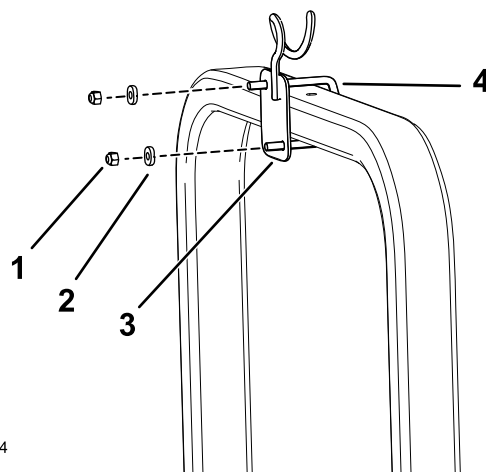

Figure 6

1. Locknut
2. Spacer
3. ROPS-cable-guide bracket
4. U-bolt

Operation

Important: Determine the location of underground lines before starting.

Using the Reel Carrier

1. Remove the chute gate and insert the cable or tubing.
2. Install the chute gate.

Note: Check the chute links for wear and freedom of movement.

3. Lower the blade to the ground and anchor the end of the cable as necessary.
4. Remove the plow sing locking pin and insert it into the hole by the seat.
5. Slowly lower the blade into the ground and start moving the machine forward slowly, using the creep-control lever.

An optional starting method is as follows:

- A. Dig a hole to the building and lower the blade to full depth.
 - B. Thread the cable or tubing into the chute and push it through the wall.
 - C. Secure the cable end and slowly move the machine forward.
6. Start the plow vibration after the blade enters the ground.

Note: When using a blade with chute links, be sure that the chute links are horizontal as the blade enters the ground. You will damage the cable and chute if the blade is forced into the ground too fast. If the ground is very hard, you can power the blade down.

7. Increase the creep speed.

Note: Do not allow tires to slip because this will lower the efficiency of the machine.

8. If you encounter an underground obstacle, increase vibration speed and maintain slight forward pressure with the machine.

Note: This lets the obstacle move to one side or allows the plow blade to move around the obstacle. Be sure that the plow swing lock is removed (Figure 7).

Note: When you use a chute blade, check it for wear and freedom of movement daily. Replace the links before they wear out.

Making a Service Connection

1. Dig a hole to the depth the cable is being laid and no wider than 0.6 m (2 ft).
2. As you pass over the hole with the machine, stop the plow vibration and insert the plow-swing lock (Figure 7).

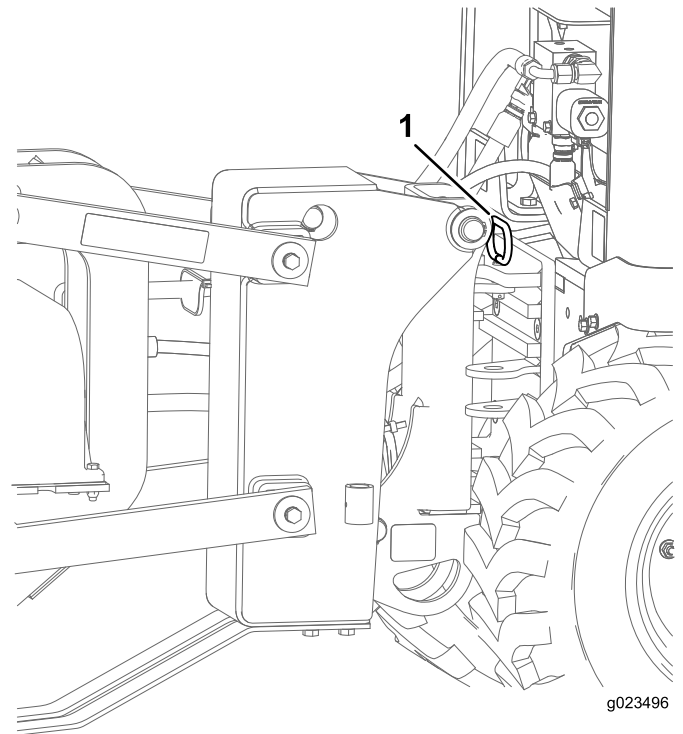

Figure 7

1. Plow-swing lock

3. Plow into the hole and stop the machine.
4. Connect the cables, make a loop in the connected cables and secure it.
5. Move the machine forward while pushing the cable down the chute.
6. Remove the plow sing locking pin and insert it into the hole by the seat.
7. Start the plow vibration after the blade enters the ground.