



TR-34D Trench Roller

Model No. 68039—Serial No. 31400001 and Up

Addendum

⚠ WARNING

CALIFORNIA Proposition 65 Warning

This product contains a chemical or chemicals known to the State of California to cause cancer, birth defects, or reproductive harm.

The engine exhaust from this product contains chemicals known to the State of California to cause cancer, birth defects, or other reproductive harm.

Important: This addendum describes how to connect the battery cable of your machine.

1

Opening the Front and Rear Hoods of the Machine

No Parts Required

Opening the Front Hood

1. At the front hood, pivot the latch handle for the hood to the vertical position (Figure 1).

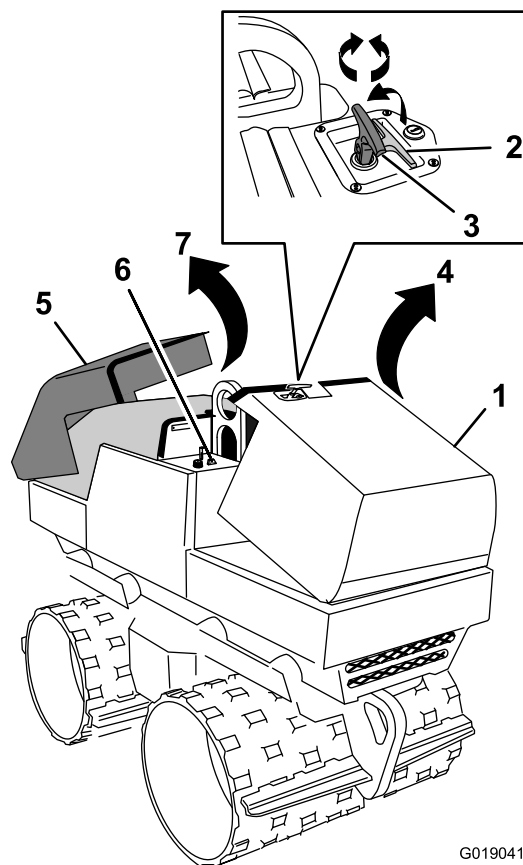

Figure 1

- | | |
|----------------------------|----------------------|
| 1. Front hood | 5. Rear hood |
| 2. Latch handle (stowed) | 6. Hood clip |
| 3. Latch handle (vertical) | 7. Rear hood opening |
| 4. Front hood opening | |

2. Rotate the latch handle clockwise (Figure 1).
3. Grasp the latch handle tightly and pull up firmly to unseat the hood from the hood clips (Figure 1).
4. Rotate the hood up (Figure 1).



Opening the Rear Hood

Note: Ensure that the forward hood is open before opening the rear hood.

1. Grasp the front edge of the rear hood.
2. Pull up firmly on the hood to unseat it from the hood clips (Figure 1).
3. Rotate the hood up (Figure 1).

2

Connecting the Battery Cable

No Parts Required

Procedure

1. Verify that the positive (red) cable clamp is securely connected to the positive post of the battery (Figure 2).

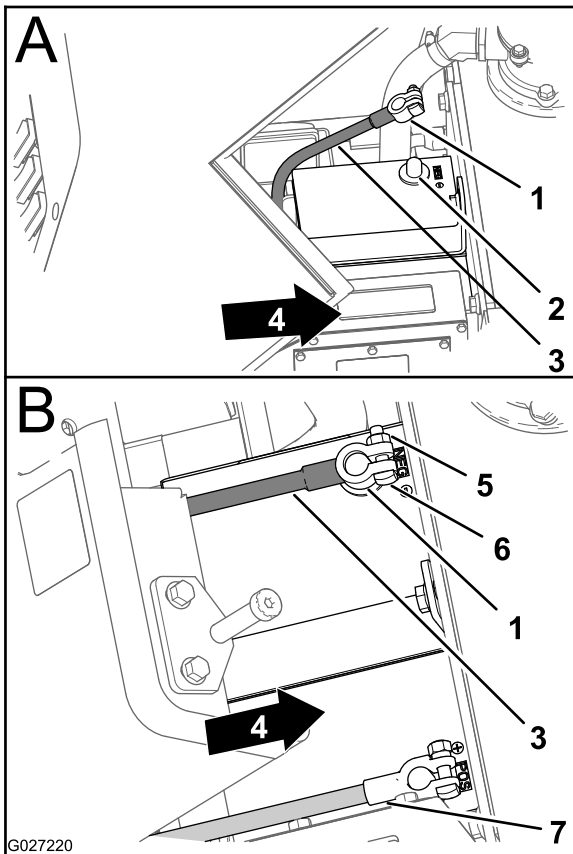

Figure 2

- | | |
|-----------------------------------|-------------------------------------|
| 1. Negative cable clamp | 5. Nut |
| 2. Negative battery post | 6. T-bolt |
| 3. Negative battery cable (black) | 7. Positive cable clamp (red cable) |
| 4. Front of the machine | |

2. Align the clamp of the negative (black) cable to the negative post of the battery (Figure 2).
3. Fully seat the terminal onto the post (Figure 2).
4. Torque the nut (Figure 2) and the T-bolt for the negative cable clamp to 678 to 791 N-cm (60 to 70 in-lb).

3

Checking the Battery Voltage

No Parts Required

Procedure

1. Insert the machine key into the key switch and rotate the key switch to the Run position.
2. Wait 5 minutes and note the voltage shown on the LED display.

Note: Refer to the battery charge table to determine the charge state of the battery.

3. If the charge state of the battery (indicated in the LED display) is less than **12.6** volts, charge the battery; refer to the *Operator's Manual* for charging instructions.

Battery Charge-state Table

Volts	Battery State
12.7 and above	100% charge
12.7 to 12.6	85 to 100% charge
12.6 to 12.4	75 to 85% charge
12.4 to 12.2	50 to 75% charge
12.2 to 12.0	25 to 50% charge
Below 12.0	Fully discharged

4

Closing the Rear and Front Hoods on the Machine

No Parts Required

Closing the Rear Hood

Note: If the rear hood and the front hood are open, the rear hood must be closed before closing the front hood.

1. Grasp the forward edge of the rear hood.
2. Rotate the hood down (Figure 1).
3. Push down firmly on the hood to seat it into the hood clips.

Closing the Front Hood

Note: Ensure that the rear hood is closed before closing the front hood.

1. Grasp the latch handle, and rotate the hood down (Figure 1).
2. Push down firmly on the hood to seat it into the hood clips.
3. Rotate the latch handle counterclockwise (Figure 1).
4. Pivot the handle down to the stowed position (Figure 1).



Count on it.