

TORO®

MODEL NO. 44206

**INSTALLATION
INSTRUCTIONS****3 POINT MOWER ADAPTER KIT
For Workman® 3000 Series****DANGER**

**CONTACT WITH MOVING PARTS CAN
CAUSE SERIOUS INJURY OR DEATH**

- Keep hands and feet away
- Keep bystanders away during operation
- Stop engine, apply parking brake, remove key and lower attachment to the ground when leaving vehicle unattended.
- Never exceed maximum lift capacity of 550 lbs.

Note: 3 Point Mower Adapter kit is used in conjunction with the H.D. Hitch Frame & Draw Bar Kit and H.D. Power Holster Hitch Kit. Refer to implement, vehicle and P.T.O. Operator's Manuals for additional operation, adjustment and safety information.

For WOODS Model RM 550 Rotary Mower

1. Remove capscrews, washers, sleeves and locknuts securing mounting lugs to deck rails and deck brackets at bottom end of each offset bar (Fig. 1). Remove mounting lugs but retain fasteners. Remove pins, nuts washers and sleeves from mounting lugs (Fig. 1).

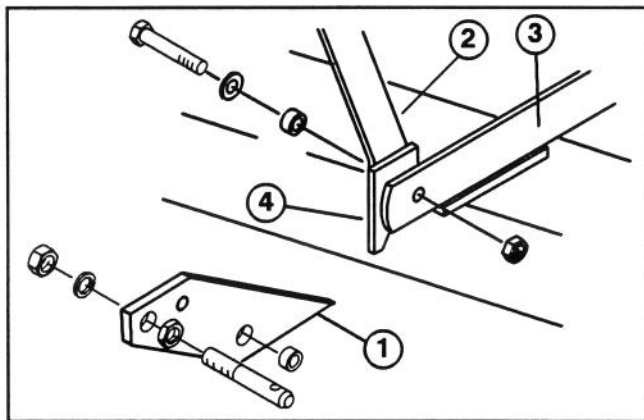
**Figure 1**

- | | |
|-----------------|-----------------|
| 1. Mounting lug | 3. Deck rail |
| 2. Offset bars | 4. Deck bracket |

2. Using capscrews, washers, sleeves and locknuts previously removed, install a lower link plate to deck rails and deck brackets at bottom end of each offset

bar (Fig. 2). Install pins, nuts and washers, previously removed, to lower link plates (Fig. 2).

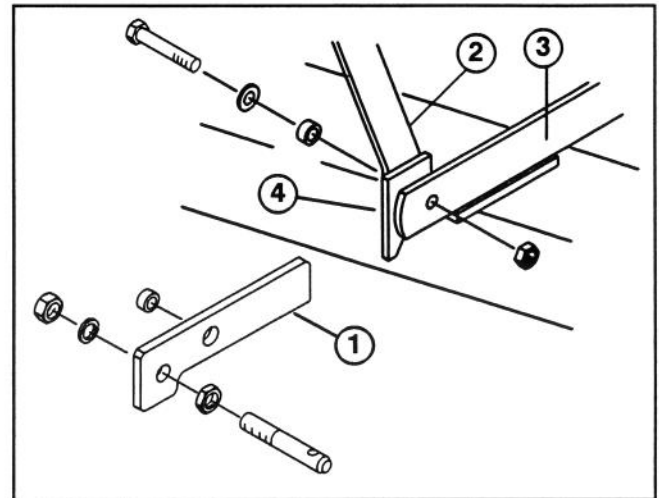
**Figure 2**

- | | |
|---------------------|-----------------|
| 1. Lower link plate | 3. Deck rail |
| 2. Offset bars | 4. Deck bracket |

3. Slide lift arms into holsters until holes in lift arms are aligned with holes in holsters.

4. Secure lift arms in holsters with mounting pins and lynch pins (included with holster hitch kit), as shown in figure 3.

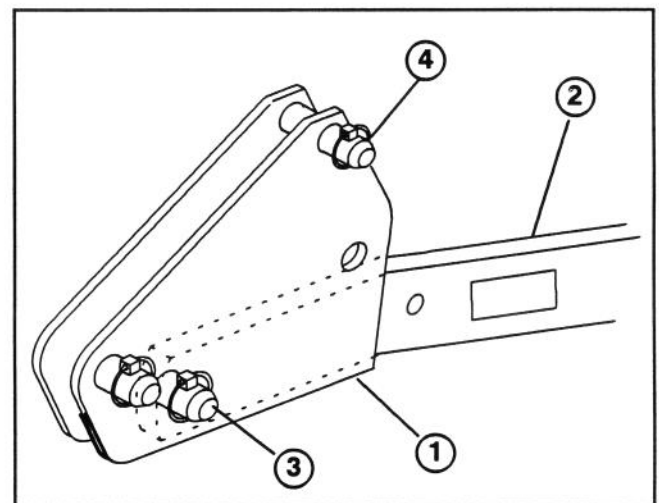
**Figure 3**

- | | |
|---------------------|---|
| 1. Holster assembly | 3. Mounting pin |
| 2. Lift arm | 4. Rear locking pin in storage position |

5. Install rear holster locking pins in storage position, as shown in figure 3.

6. Back vehicle up to implement, lower holster hitch kit and align holsters with lower lift arms.

7. Mount a lower lift arm to each lower link plate pin with a lynch pin (Fig. 4).

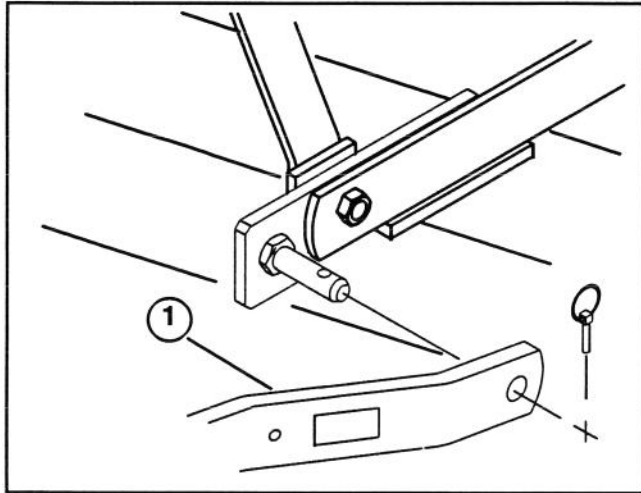

Figure 4

- 1. Lower lift arm
- 2. Lower link plate pin

8. Secure bottom end of each to chain to appropriate lower lift arm with a shackle, clevis pin and hair pin cotter, as shown in figure 5.

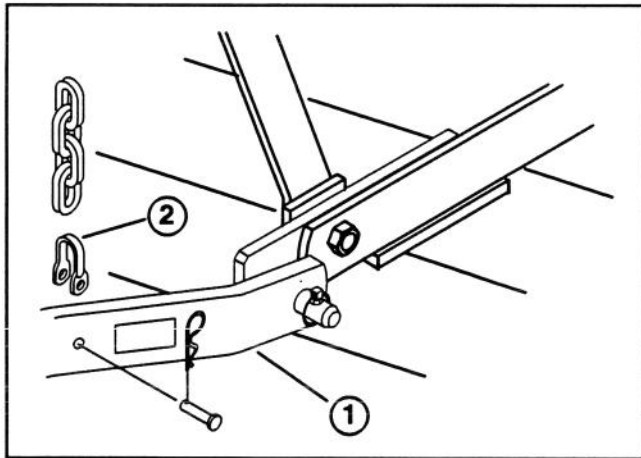

Figure 5

- 1. Lower lift arm
- 2. Shackle

9. Mount chain adjust brackets between tops of offset bars with a clevis pin and (2) lynch pins as shown in figure 6.

10. Hook a chain end in each bracket slot and secure with safety pin, as shown in figure 6.

Note: When vehicle and mower are on a level surface, chains should have some slack to allow mower to follow ground contours.

11. Carefully raise holsters and check position of mower. Mower should be parallel to the ground when in raised position. Lower holster and adjust chains as required.

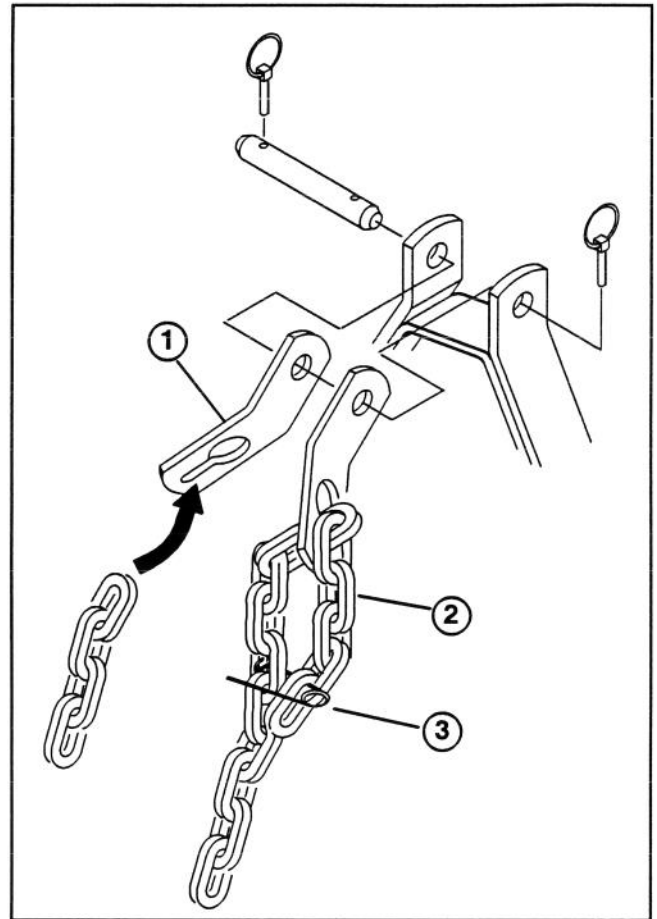

Figure 6

- 1. Chain adjuster bracket
- 2. Chain
- 3. Safety pin

For LAND PRIDE Model FD 2560 Rotary Mower

1. Remove clevis pins and hair pin cotters securing lower hitch lugs to front deck brackets (Fig. 7). Remove hitch lugs but retain clevis pins and hair pin cotters.

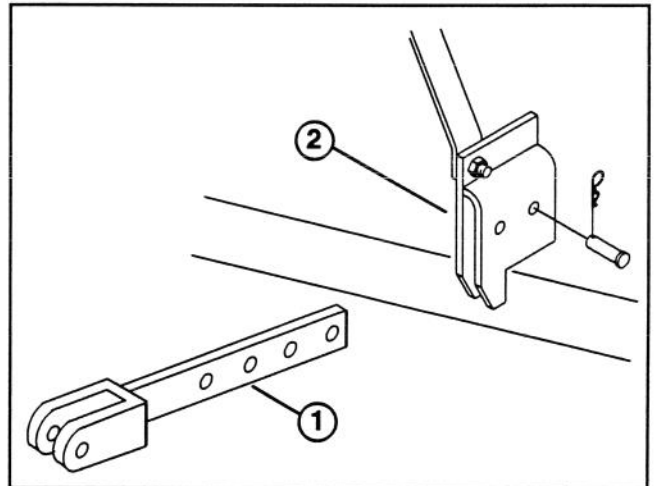

Figure 7

- 1. Lower hitch lug
- 2. Front deck bracket

2. Mount lower lift arms to rear holes in front deck brackets with clevis pins and hair pin cotters, previously removed (Fig. 8).

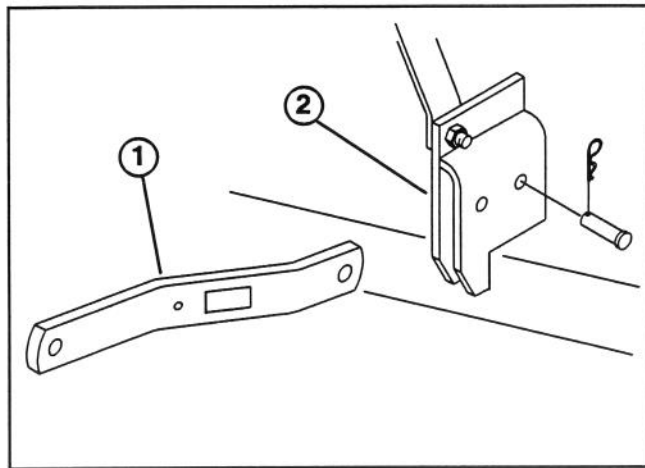

Figure 8
1. Lower lift arm
2. Front deck bracket

3. Remove capscrew, lockwasher and hex nut securing upper pivoting hitch and spacer between upper hitch brackets and braces (Fig. 9).

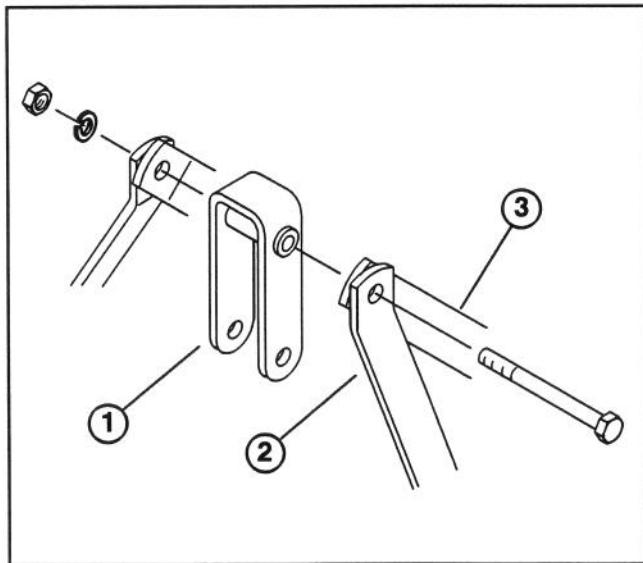

Figure 9
1. Upper pivoting hitch & spacer
2. Upper hitch bracket
3. Upper hitch brace

4. Secure a chain adjust bracket to outsides of the upper hitch brackets and braces with a new capscrew and locknut as shown in figure 10.

5. Hook a chain end in each bracket slot and secure with safety pin, as shown in figure 10.

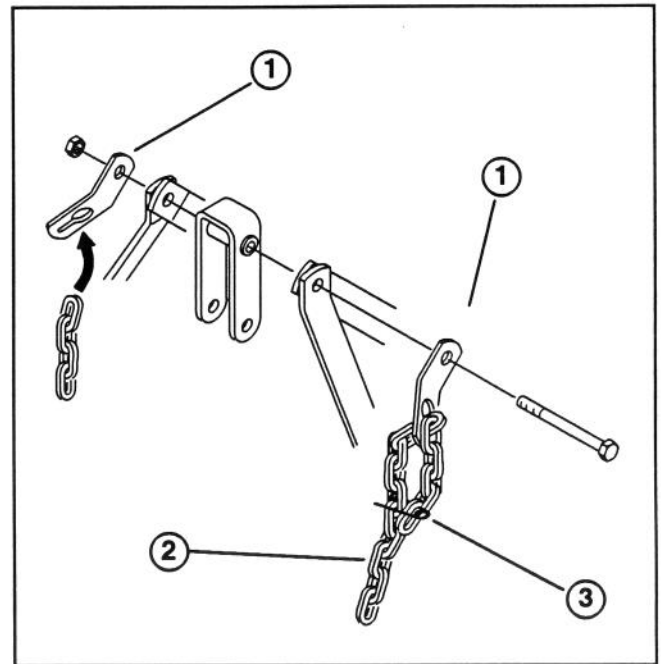

Figure 10
1. Chain adjust bracket
2. Chains
3. Safety pin

6. Secure bottom end of each to chain to appropriate lower lift arm with a shackle, clevis pin and hair pin cotter, as shown in figure 11.

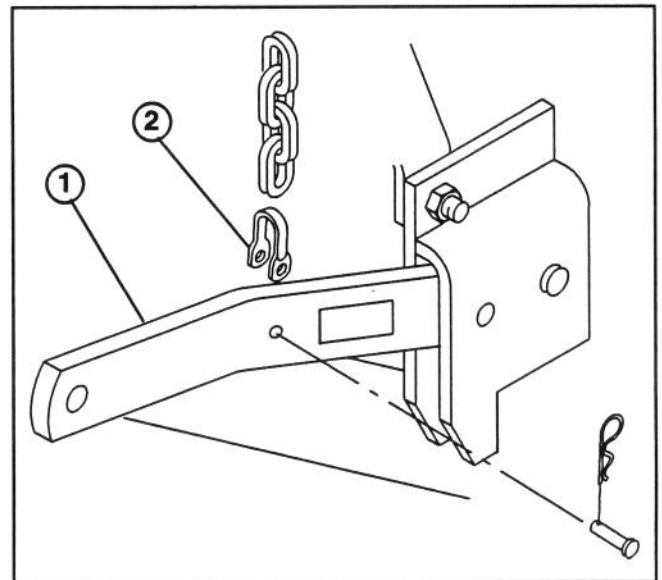

Figure 11
1. Lower lift arm
2. Shackle

7. Back vehicle up to implement, lower holster hitch kit and align holsters with lower lift arms.

8. Slide lift arms into holsters until holes in lift arms are aligned with holes in holsters.

9. Secure lift arms in holsters with mounting pins and lynch pins (included with holster hitch kit), as shown in figure 12.

10. Install rear holster locking pins in storage position, as shown in figure 12.

Note: When vehicle and mower are on a level surface, chains should have some slack to allow mower to follow ground contours.

11. Carefully raise holsters and check position of mower. Mower should be parallel to the ground when in raised position. Lower holster and adjust chains as required.

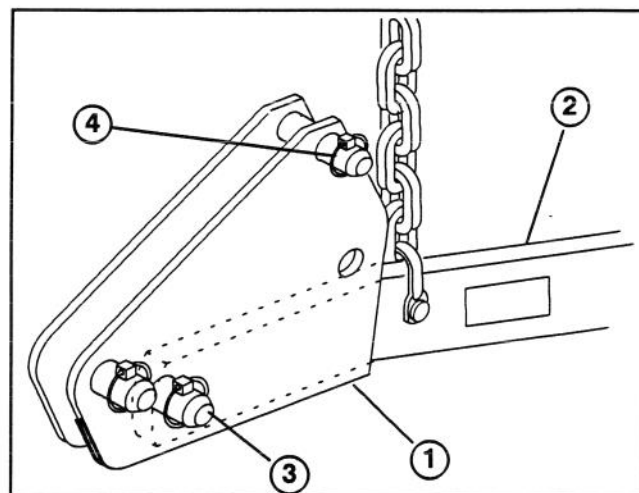

Figure 12

- | | |
|---------------------|---|
| 1. Holster assembly | 3. Mounting pin |
| 2. Lift arm | 4. Rear locking pin in storage position |