

# **Vacuum Bagger**

**For 42- and 48-inch Mowers**

**Model No. 79203—4900001 & Up**

**Model No. 99201—4900001 & Up**

**Model No. 9861906—T4N0001 & Up**

## **Operator's Manual**

**Important:** Read this manual carefully. It contains information about your safety and the safety of others. Become familiar with the controls and their proper use before you operate the product. Also read the safety and operating instructions in your tractor operator's manual.

# Safety and Instruction Decals

The following safety and instruction decals are affixed to the bagger unit. If any decal becomes illegible or damaged, install a new decal. Part numbers are listed below. Order replacements from your authorized TORO dealer.

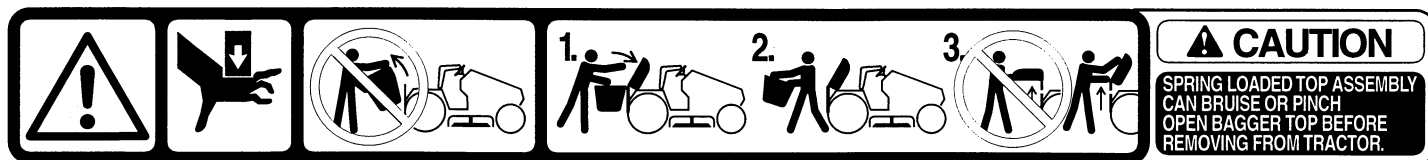

ON THE INSIDE BAGGER HINGE FRAME  
(Part No. 92-7113)



MOLDED ON THE BELT COVER



MOLDED ON THE BELT COVER



MOLDED ON THE BELT COVER

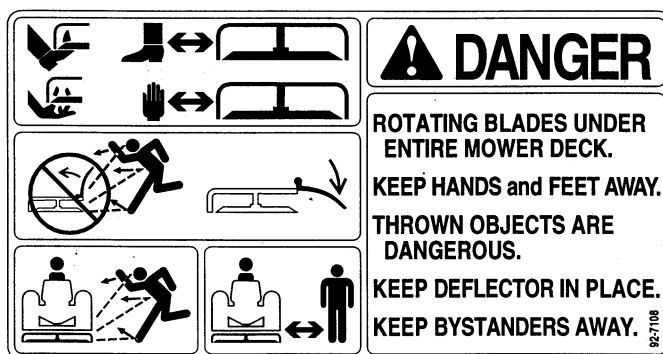

ON THE INNER SHIELD  
(Part No. 92-7108)

# Model Number

Your bagging attachment has a decal listing its model and serial number. This decal is on the inside of the Bagger's top assembly. Always refer to the model number when consulting with your dealer or the factory about service, replacement parts, or questions you may have. Replace the model number decal if it is lost during operation or maintenance. For your reference,

record the number on the lines below.

**Model No.** \_\_\_\_\_

**Serial No.** \_\_\_\_\_

## Assembly

### Mower Preparation

1. **Shut the engine off.** Lower the mower to its lowest position and engage the parking brake.
2. Remove the grass deflector and belt cover from the mower (Fig. 1). Save both the deflector and the belt cover for use if you remove the bagger later and want to discharge grass to the side.

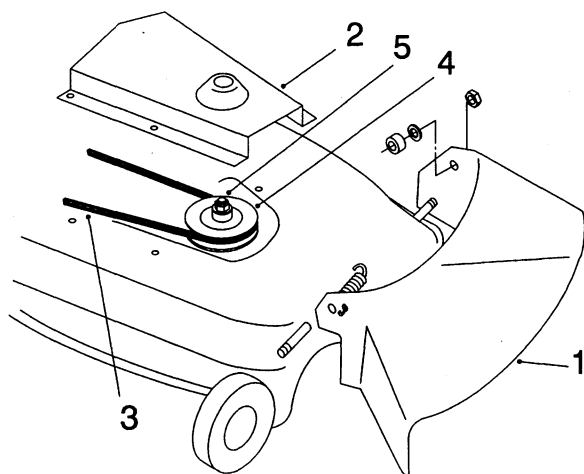

**Figure 1**

- |                              |                                 |
|------------------------------|---------------------------------|
| 1. Grass deflector           | 4. Pulley                       |
| 2. Belt cover (shape varies) | 5. Pulley nut and washer (5/8") |
| 3. Mower drive belt          |                                 |

3. Rotate the mower drive belt off the pulley (Fig. 1).
4. Remove the 5/8" pulley nut and lock washer. Block the blade with a piece of wood or some other device

to stop it from turning while you remove the pulley nut.

**Note:** Save the pulley because you must reinstall it if you use the mower to side discharge. The 5/8" nut and washer are used in the next step when you install the new double pulley.

5. Slide the new double pulley onto the pulley shaft and secure it in place with a 5/8" lock washer and nut (Fig. 2). Make sure the word "TOP", stamped into largest pulley, faces up. Tighten the nut to 60–80 ft-lb.

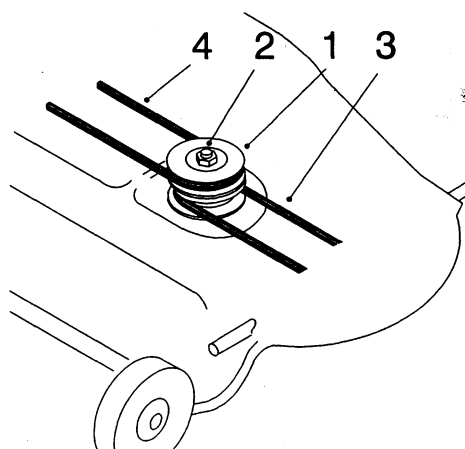

**Figure 2**

- |                                   |
|-----------------------------------|
| 1. New double pulley (note "TOP") |
| 2. Lock washer and nut (5/8")     |
| 3. Blower belt                    |
| 4. Mower belt                     |

6. Install the **blower** belt onto the lower pulley, leav-

ing the other end of the blower belt loose (Fig. 2).

**Note:** Use the belt with part number “79-7480” for 42” mowers and the belt with part number “79-7490” for 48” mowers.

7. Install the existing mower belt by rotating it onto the top pulley (Fig. 2).

**Note:** Make sure the mower belt stays on the spring-loaded idler and the other spindle pulleys.

## Mount the Blower to the Mower

1. Install the blower assembly by inserting the pivot pin into the blower pivot support (Fig. 3).

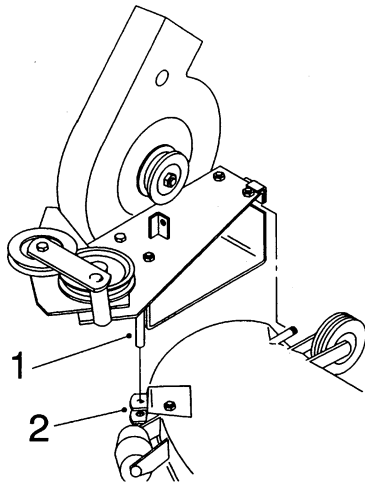

1. Pivot pin
2. Pivot support

2. With the blower swung out in the open position, install the blower belt between the idler pulley bracket and pulley. Then loop the belt around the remaining pulleys (Fig. 4).

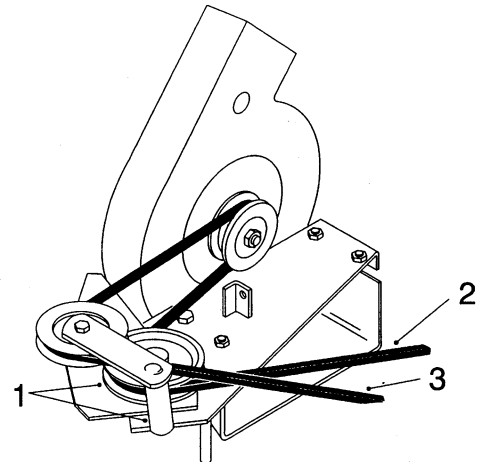

Figure 4

1. Idler pulley bracket and pulley
2. Top side of belt against bottom pulley
3. V-side of belt into top pulley

3. With the belt installed, swing the blower toward the mower until the blower latch locks over the pin at the back of the mower (Fig. 5).

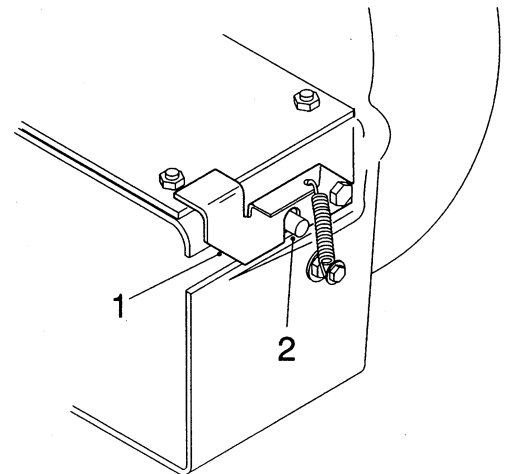

Figure 5

1. Blower latch
2. Pin

## Install the Belt Covers

1. **42” mowers only:** Mount the **mower** belt-cover bracket (Fig. 6) to the mower using two  $\frac{1}{4}$ ” x  $\frac{1}{2}$ ” thread-forming hex-head flange screws in the same holes that the original cover used.

**Note:** Be sure the flange screws are centered in the slot in the bracket when you tighten them.

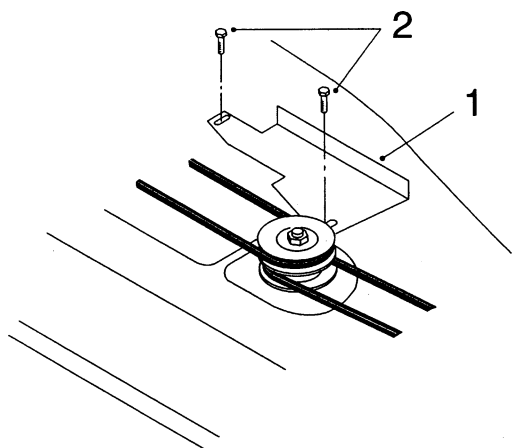

**Figure 6**

1. 42" Mower belt-cover bracket
2. Thread-forming hex-head flange screws ( $\frac{1}{4}$ " x  $\frac{1}{2}$ ")

2. Install the **mower** belt cover (Fig. 7).

- a. **42" belt cover**—Mount the mower belt cover loosely on the outside of the belt-cover bracket and the top of the mower using four  $\frac{1}{4}$ " x  $\frac{1}{2}$ " thread-forming hex-head flange screws (Fig. 7).

**Do not tighten the screws** because an adjustment must be made later.

- b. **48" mower belt cover**—Mount the mower belt cover loosely to the top of the mower, using two  $\frac{1}{4}$ " x  $\frac{1}{2}$ " thread-forming hex-head flange screws (Fig. 7). **Do not tighten the screws** because an adjustment must be made later.

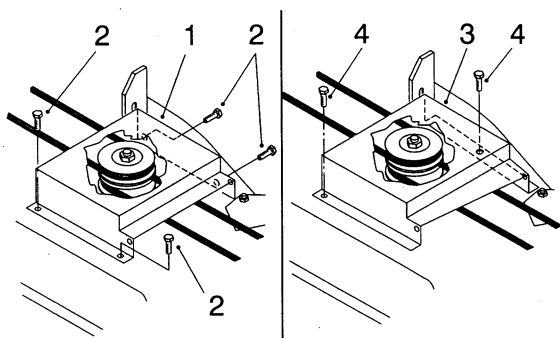

**Figure 7**

1. 42" Mower belt cover
2. Thread-forming flange screws—42" mower ( $\frac{1}{4}$ " x  $\frac{1}{2}$ ")
3. 48" Mower belt cover
4. Thread-forming flange screws—48" mower ( $\frac{1}{4}$ " x  $\frac{1}{2}$ ")

3. Install the **blower** belt cover using two  $\frac{1}{4}$ " x  $\frac{5}{8}$ " hex-head bolts and  $\frac{1}{4}$ " nylon lock nuts (Fig. 8). Tighten the nuts until you feel a slight drag on the cover when you rotate it. The cover must close freely.
4. Close the blower cover completely. While holding the blower cover down, tighten the mower belt-cover screws (Fig. 7).

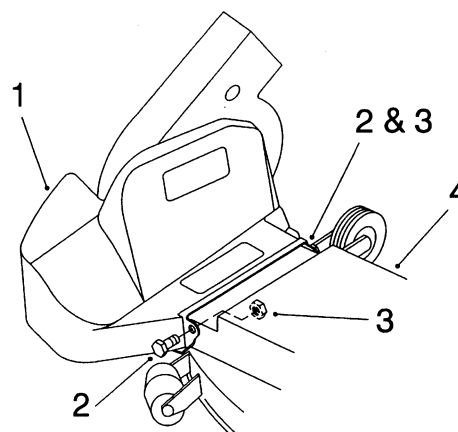

**Figure 8**

1. Blower belt cover
2. Bolts ( $\frac{1}{4}$ " x  $\frac{5}{8}$ ")
3. Nylon lock nuts ( $\frac{1}{4}$ ")
4. Mower belt cover—tighten screws

## Install the Bagger Assembly

1. Slide the bottom of the quick-attach bracket down into the hole in the rear drawbar and hook the notches onto the spacers located inside the tractor frame (Fig. 9). Secure the quick-attach bracket with the large hairpin cotter.

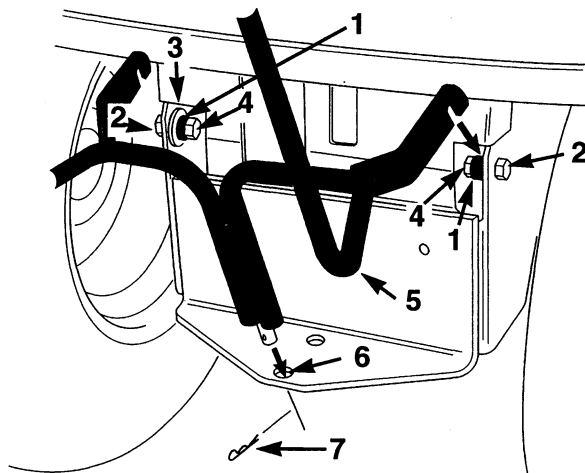

Figure 9

1. Spacers
2. Hex-head bolts ( $\frac{3}{8}$ " x  $1\frac{3}{4}$ " )
3. Washers ( $\frac{3}{8}$ " )(each side)
4. Locknut ( $\frac{3}{8}$ " )
5. Quick-attach bracket
6. Mounting hole
7. Large hairpin cotter

2. Tilt the tractor seat forward. Slide the bagger top onto the quick-attach bracket (Fig. 10).

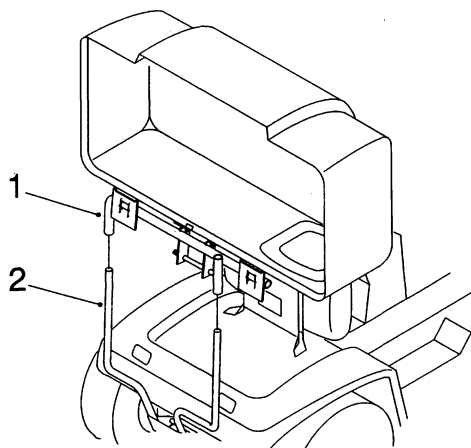

Figure 10

1. Bagger top
2. Quick-attach bracket

3. Slide the bag frame hook onto the retaining bracket (Fig. 11).

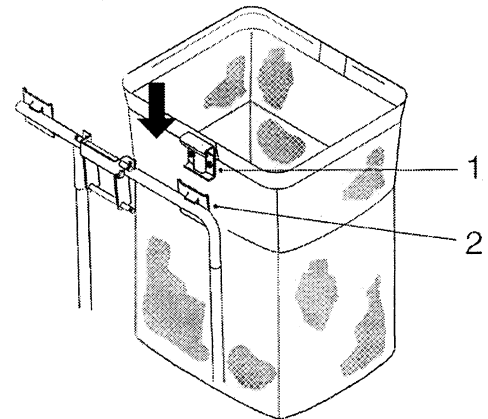

Figure 11

1. Bag frame hook
2. Retaining bracket

4. Close the bagger top and push down on both bag retainer handles until they lock on the bag frame.

## Mount the Discharge Tube

1. Insert the upper end of the discharge tube into the bagger top. Slide the lower end of the discharge tube over the blower discharge opening (Fig. 12).
2. Hook the rubber latch onto the blower knob (Fig. 12).

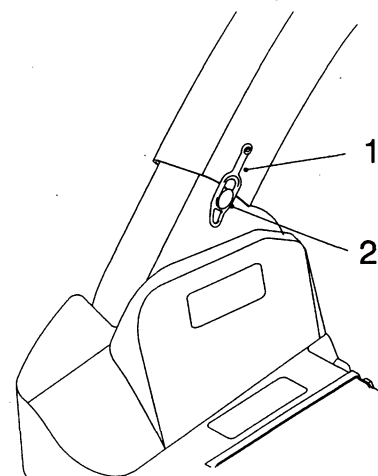

Figure 12

1. Rubber latch
2. Blower knob

# Operation

## CAUTION

### To Avoid Personal Injury:

- Become familiar with all operating instructions and safety suggestions in the operator's manuals for your tractor and mower before operating this equipment.
- **Never** do maintenance or repairs while the engine is running.
- **Never** remove the discharge tube, bagger top or grass bags while the engine is running.
- Shut off the engine before unclogging the discharge tube.
- **Never** operate the mower with the bagger removed and the grass deflector off. Always replace the grass deflector and belt cover, if operating without the bagger, to avoid personal injury.

1. **Size.** Remember that the tractor is made longer and wider with this attachment, so be sure to avoid sharp turns in confined places.
2. **Trimming.** Don't trim with the right side of the mower. Trimming with the right side of the mower can damage the blower and discharge tube.
3. **Speed.** Generally you can operate the bagger at normal mowing speed. Because of the extra power required to drive the blower, sometimes it may be necessary to reduce the tractor's ground speed to keep the engine running smoothly at maximum rpm. When mowing uphill, reduce the tractor's ground speed by at least one gear. This will help avoid a large power drop and loss of blower efficiency. When practical, set up a mowing pattern that will permit as much downhill mowing as possible.

## CAUTION

### Quick stops or starts on hills can tip tractors!

Do not stop or start suddenly when going uphill or downhill. Avoid uphill starts. If the tractor is stopped going up a slope, turn the attachment off and back slowly down the slope, keeping the machine in gear. Do not stop or change gears (speed) on slopes.

4. **Grass Bags Full.** Lift the "full-bag" indicator rod periodically to check if the grass bags are becoming full. The left bag will normally fill first. Then, as the right bag fills, you will feel resistance when you lift the full-bag indicator rod. During operation, a small amount of grass clippings will normally be blown out the front of the mower. When this flow increases, it is also an indication that the grass bags are full.

**IMPORTANT:** If suction action or pick-up should stop during use, disengage the mower and shut off the engine. Check for full grass bags or a clogged discharge tube, mower or blower. Always empty bags when filled and after each use.

## CAUTION

### Rotating parts or debris from the blower or bagger can cause injury!

Never operate the bagger without the discharge tube and bags installed.

## CAUTION

### Grass stored in bags can cause fires!

Grass bags are not storage containers. Never leave fresh grass clippings or other organic matter in bags for any length of time. Under the right conditions, spontaneous combustion (a fire-generating process that occurs without an external source of ignition) can occur with this type of material.

Grass bags can weigh up to 90 lb. (41 kg) when full. Use care when removing or handling a filled grass bag.

5. **Emptying the Bags.** Raise the seat of the tractor and release both bagger top latches. Raise the bagger top and gently compress debris into the bags. With both hands, lift up on one of the bags to release it from the frame hook. Dispose of debris and reinstall the bag. Repeat for the other bag.

Plastic liners may be inserted in grass bags for more convenient grass clipping disposal. If you use a plastic liner, remove the bag and tie the top of the liner. Pull the liner out of the bag or turn the bag upside down while holding the web handle on the

bottom of the bag to allow the filled liner to slide out.

## Removing The Bagger

### **WARNING**

**Operating Without The Grass Deflector Can Lead to Serious Injury!**

Install the original grass deflector, belt, pulley and belt cover if you operate the mower without the bagger attachment.

# Maintenance

1. **Inspect the Bagger.** After the first 10 hours of operation, check that all parts of the bagger and all fasteners are tight and in good condition. Pay special attention to the condition of the discharge tube and top—replace these parts if they are cracked or broken.

**IMPORTANT:** Check grass bags often for wear and deterioration. Always replace damaged or torn bags with TORO Wheel Horse bags.

2. **Washing.** After use, remove and wash the bagger top and discharge tube with a garden hose. Use a mild automotive detergent to remove stubborn dirt. After washing, let all parts dry thoroughly.

**IMPORTANT:** Remove bags and check the blower and underside of the mower after use and clean as necessary. Matted grass in these areas can seriously affect cutting performance.

3. **Grass Bags.** Store bags in a way that will insure complete drying after use. Keeping grass bags dry will help prevent deterioration of bag material and add to the useful life of bags. Washing bags is not recommended.

4. **Blades.** Inspect blades at specified intervals, and whenever a blade strikes a foreign object. If blades are badly worn, install new blades.
5. **Storage.** Before storing the attachment, clean it thoroughly and allow it to dry. Store the bagger in a clean, dry place, out of direct sunlight. This will protect the plastic parts and extend the life of the bagger. Use a weatherproof cover if storing the equipment outside.