

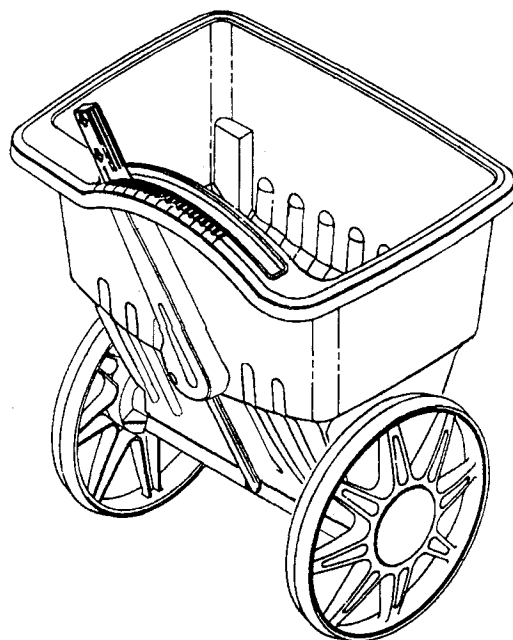

Mow & Feed™ Fertilizer Spreader

Model No. 52070—49000001 & up



Operator's Manual

Table of Contents

Parts for Assembly	3
Parts for Installation	4
Assembly Instructions	5
Installation Instructions	
Toro Mowers	8
Lawn-Boy Silver Series	12
Lawn-Boy L Series	16
Lawn-Boy S Series	19
Lawn-Boy 1993 Gold Series	22
Lawn-Boy 1994 Gold Series	27
Lawn-Boy 1994 Green Series	30
Operating Instructions	33
Maintenance	34
Lawn Care Guide	35
The Toro Promise	Back Cover

Parts For Assembly

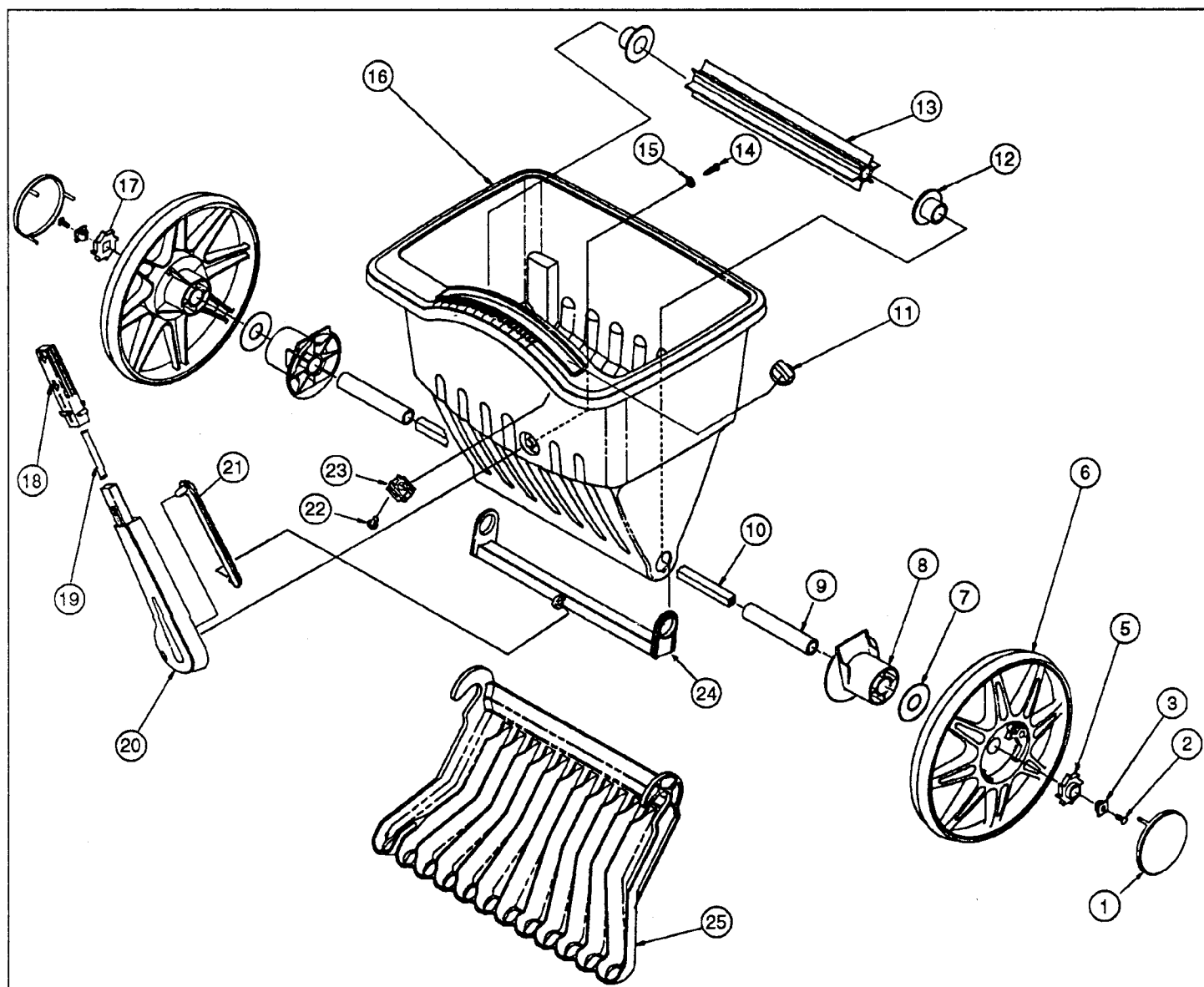

- | | |
|---|---|
| 1. Cap Wheel (2) | 15. Flat Washer |
| 2. Hex-head screw (2) | 16. Hopper |
| 3. Axle Retainer (2) | 17. Gear Wheel—Left |
| 5. Gear Wheel—Right | 18. Lever Handle |
| 6. Tire/Wheel Assembly (Left Hand and Right Hand) | 19. Compression Spring |
| 7. Washer (2) | 20. Hopper Lever |
| 8. Axle Support (2) | 21. Connecting Rod |
| 9. Axle Bushing (2) | 22. Carriage Bolt $\frac{1}{4}$ -20 x $\frac{1}{2}$ |
| 10. Axle | 23. Lever Stop |
| 11. Knob | 24. Flow Adjuster |
| 12. Hopper Bushing (2) | 25. Chute |
| 13. Impeller | |
| 14. Phillips #8 screw | |

Parts For Installation

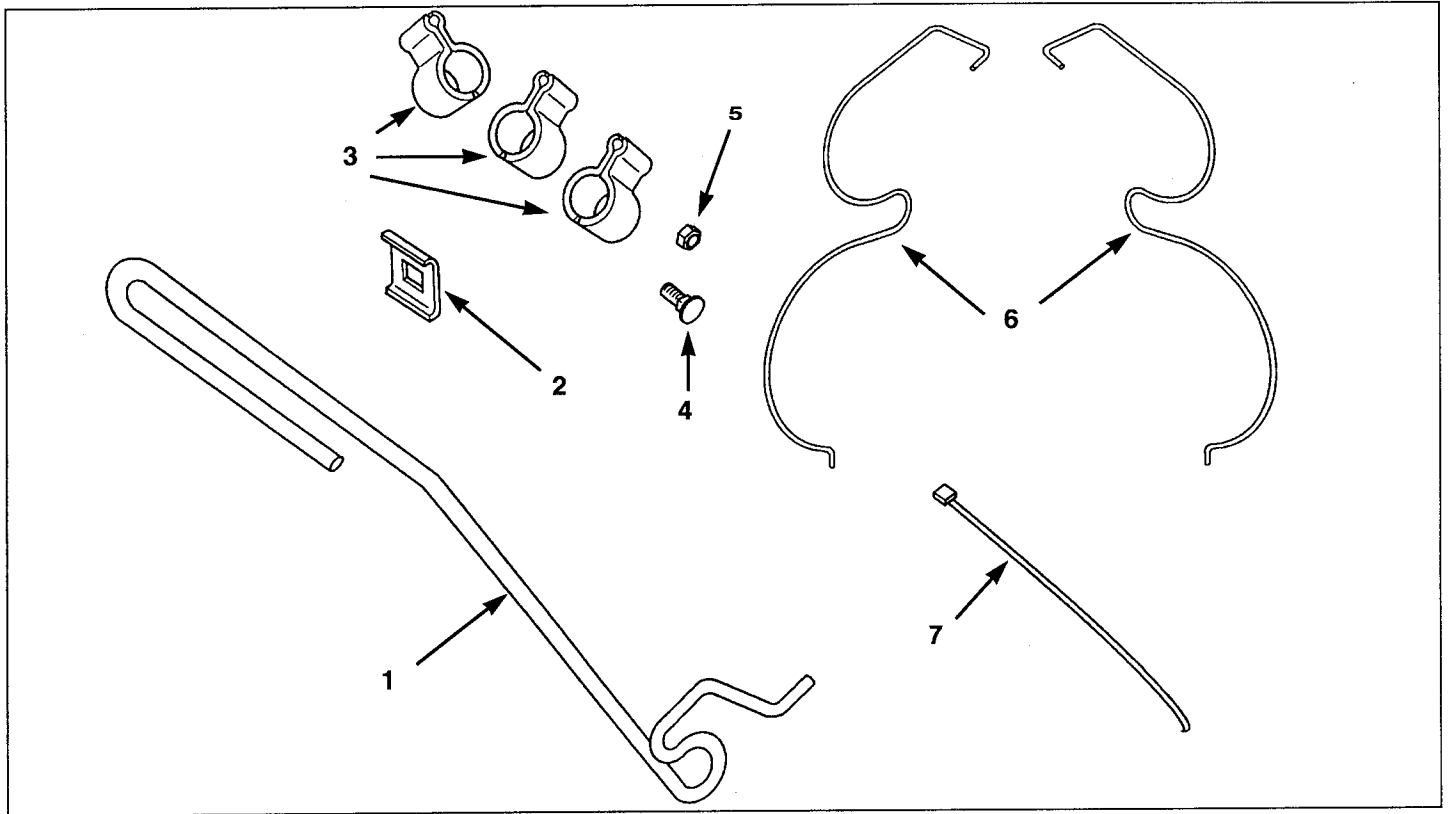

Figure 2

- | | |
|---------------------|--|
| 1. Mounting rod | 4. Carriage bolt $\frac{1}{4}$ -20 x $\frac{3}{4}$ (3) |
| 2. Mounting bracket | 5. Lock nut $\frac{1}{4}$ -20 (3) |
| 3. Clamps (3) | 6. Hold-down springs |
| | 7. Cable tie |

Assembly Instructions

1. Mount the flow adjuster to the hopper

- A. Tip the hopper on end.
- B. Place the flow adjuster on the bottom of the hopper and align the holes. Make sure the tab on the flow adjuster is on the back side of the hopper (Fig. 3).
- C. Insert the two hopper bushings (Fig. 3) through the inside of the hopper and through the flow adjuster. Turn each hopper bushing until its key locks into place.

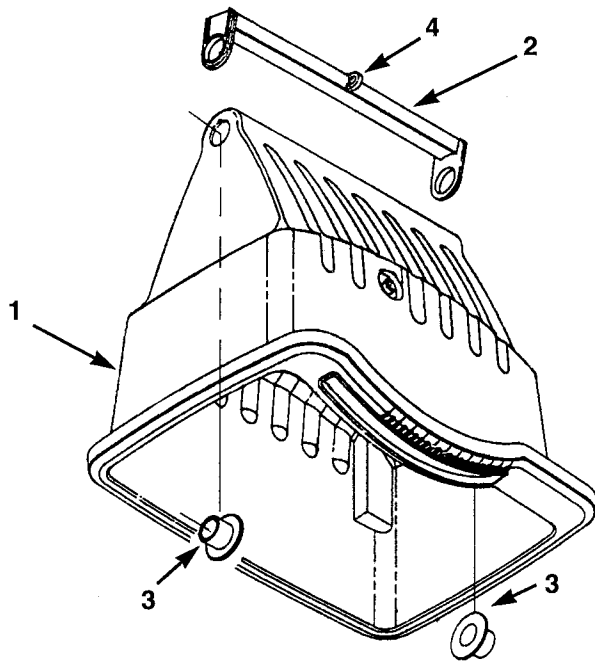

Figure 3

- | | |
|------------------|----------------------|
| 1. Hopper | 3. Hopper Bushing |
| 2. Flow Adjuster | 4. Flow Adjuster Tab |

2. Carefully turn the hopper over and put the impeller (Fig. 4), between the flanges of the two hopper bushings.

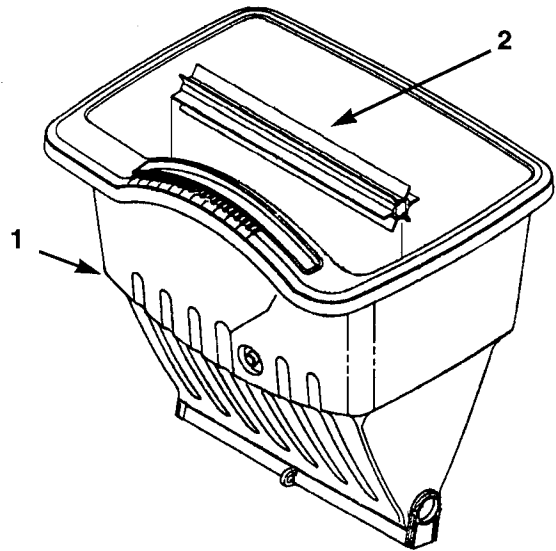

Figure 4

- | | |
|-----------|-------------|
| 1. Hopper | 2. Impeller |
|-----------|-------------|

3. Align the square axle with the square hole of the impeller and slide the axle through the hopper until it extends equally from each side (Fig. 5).
4. Place an axle bushing on each end of the axle and slide them *into* the hopper bushings (Fig. 5).

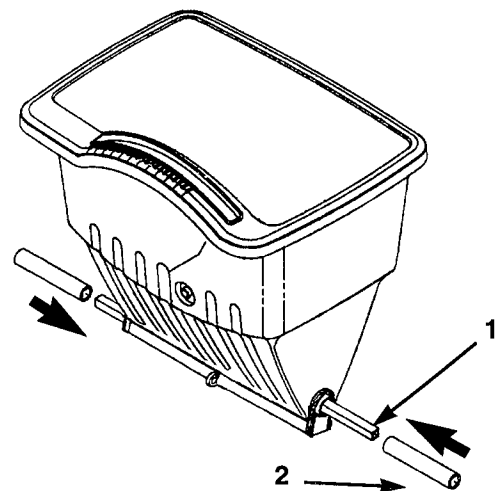

Figure 5

- | | |
|---------|-----------------|
| 1. Axle | 2. Axle Bushing |
|---------|-----------------|

5. Slide the two axle supports onto each end of the axle (Fig. 6 or 7).

IMPORTANT: Be sure to position the axle supports according to the model and serial number of your mower. Lawn-Boy "L-Series mowers have model numbers beginning with "L" and "S-Series mowers have model numbers beginning with "S".

Install this way for Toro, Lawn-Boy L Series, Silver Series, self-propelled S Series, 1993 Gold Series (1993 mowers have serial numbers that begin with "39") and Green Series.

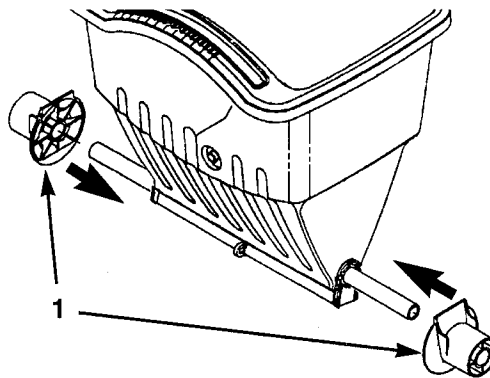

Figure 6

1. Axle support

Install this way for Lawn-Boy hand-push S series, and 1994 Gold Series (1994 mowers have the serial numbers that begin with "49").

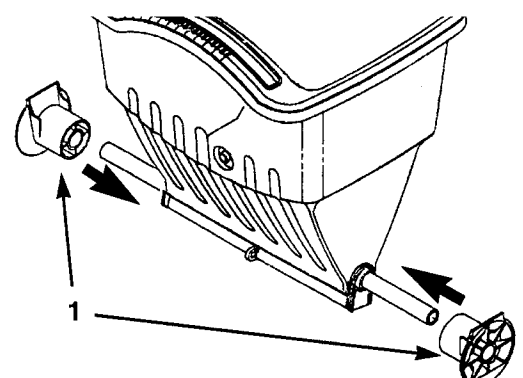

Figure 7

1. Axle support

6. Slide a thrust washer onto each axle bushing (Fig. 8).
7. The black ratchet arm (Fig. 8) in each wheel is marked either "Left Hand Out" or "Right Hand Out", for the left wheel or right wheel, respectively. Position the hopper as shown and install the left and right wheels. Note: the right and left side of the spreader are determined by standing behind the unit in the mower operator position.
8. Each wheel gear is marked either "Left Hand Out" or "Right Hand Out". Install the left and right wheel gears and make sure they engage the black ratchet arm in the wheels. Next, push both axle retainers fully into the ends of the axle (Fig. 8) and make sure the flange on the retainer is against the axle. Now install the hex head screws into both axle retainers (Fig. 8). Hold the opposite end of the axle to prevent it from turning as you tighten the screws.
9. Line up the key of the connecting rod with the slot in the flow adjuster tab. From right to left, insert the end of the connecting rod into the flow adjuster tab (Fig. 9).

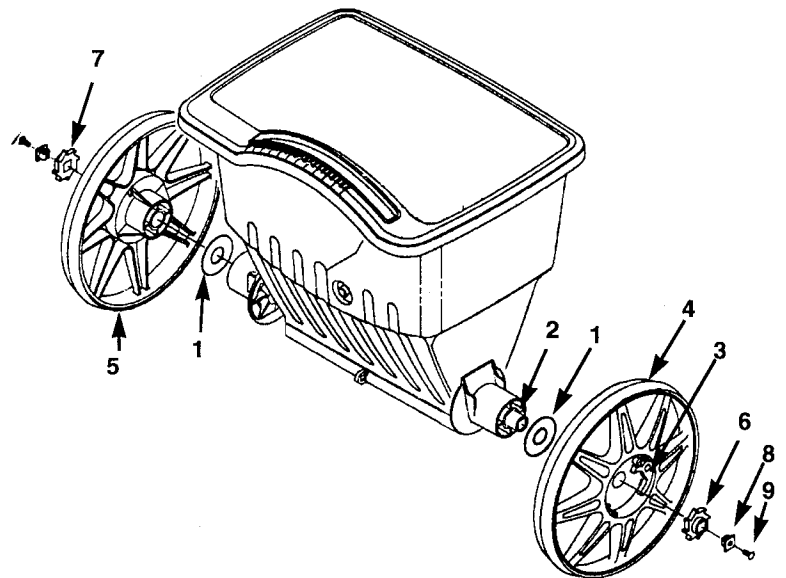

Figure 8

- | | | |
|------------------|---------------------|--------------------|
| 1. Thrust washer | 4. Right wheel | 7. Left wheel gear |
| 2. Axle bushing | 5. Left wheel | 8. Axle retainer |
| 3. Ratchet arm | 6. Right wheel gear | 9. Hex-head screw |

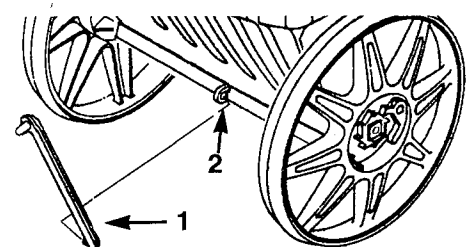

Figure 9

- | | |
|-------------------|----------------------|
| 1. Connecting rod | 2. Flow adjuster tab |
|-------------------|----------------------|

10. Insert the spring into the top handle and slide it onto the hopper lever until the tab snaps into the hole (Fig. 10).

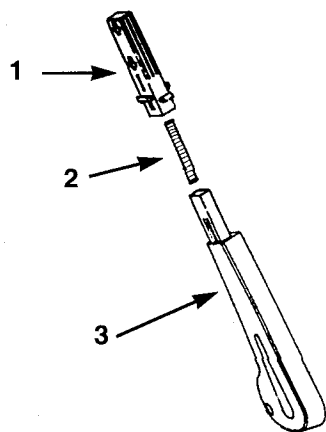

Figure 10

1. Top handle
2. Spring
3. Hopper lever

11. Line up the slot in the hopper lever with the key of the connecting rod and insert the connecting rod into the hopper lever (Fig. 11). Then rotate the hopper lever up.

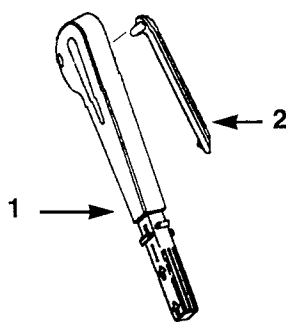

Figure 11

1. Hopper lever
2. Connecting rod

12. Insert the handle end of the hopper lever through the slot in the hopper (Fig. 12).

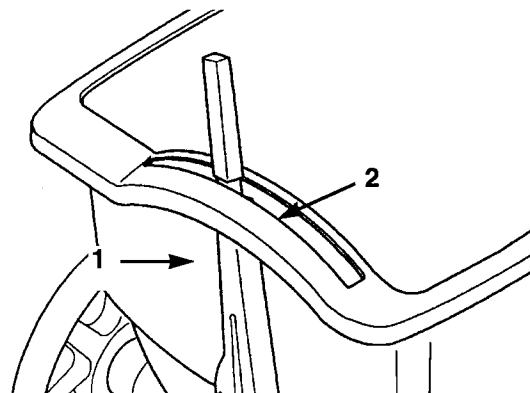

Figure 12

1. Hopper lever
2. Slot

13. Retain the hopper lever against the hopper, using a Phillips screw and washer from inside the hopper (Fig. 13).

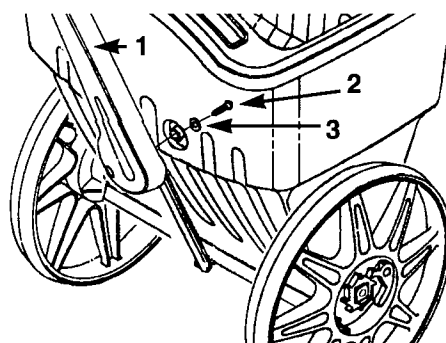

Figure 13

1. Hopper lever
2. Phillips screw
3. Washer

14. Install the lever stop, using a carriage bolt and knob (Fig. 14). Make sure the center of the stop fits up into the slot in the hopper.

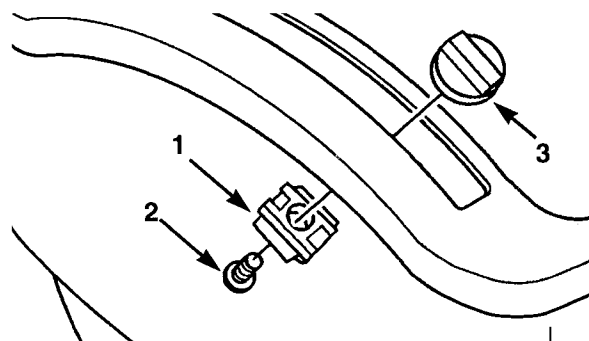

Figure 14

1. Lever stop
2. Carriage bolt
3. Knob

15. Install the hub cap (Fig. 15). Be sure to align the tabs of the hub cap with the grooves in the wheel as you snap the hub cap in place.

IMPORTANT: If you ever need to service the wheel or remove it, you must press the three tabs (behind the wheel) together while you remove the hub cap. If you try to pry the hub cap off, you will break the tabs and the hub cap will not stay on the wheel.

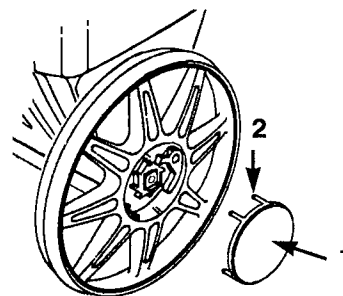

Figure 15

1. Hub cap
2. Tabs (3)

Installation on TORO® Mowers

1. Place the spreader on your mower (Fig. 16). The wheels of the spreader must rest on the wheels of the mower.

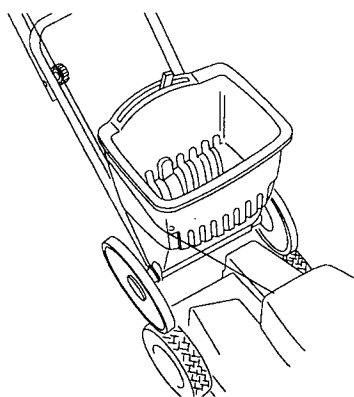

Figure 16

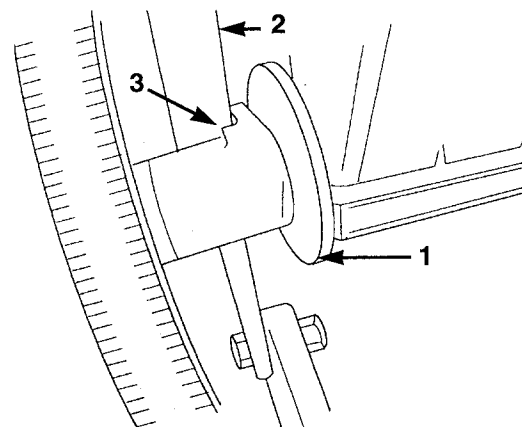

Figure 17

1. Axle support
2. Mower handle.
3. Rib

2. Rotate both axle supports so the raised rib contacts the mower handle (Fig. 17).
3. Remove the handle knob (Fig. 18) from the right side of the mower.
4. Install the mounting rod.
 - A. Insert the end of the mounting rod into the hole on the right side of the hopper (Fig. 18).

- B. Put the engine rope into the curve in the mounting rod (Fig. 18).
- C. Install the U-shaped end of the mounting rod onto the handle bolt, using a bracket and handle knob (Fig. 19). Make sure the curved sides of the bracket fit around the mounting rod.

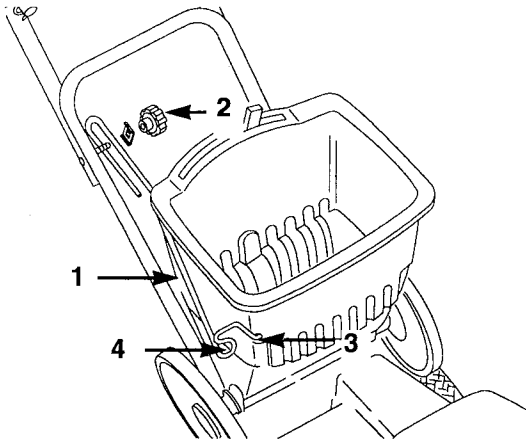

Figure 18

- | | |
|-----------------|-------------------------|
| 1. Mounting rod | 3. Mounting rod hole |
| 2. Handle knob | 4. Engine rope location |

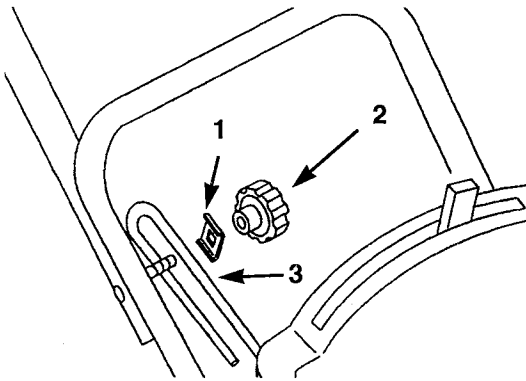

Figure 19

- | | |
|------------|-----------------|
| 1. Bracket | 3. Mounting rod |
| 2. Knob | |

5. Install the chute (Fig. 20). Notice that the chute has a hook at both sides.
 - A. Place the chute under and slightly forward of the hopper. Then hook the chute onto the axle. You must lift the hopper up slightly to install the chute on self-propelled mowers.
 - B. Rotate the chute down until its back edge fits into the notch on the ribs on the lower front side of the hopper. You may need to move the mower control cables out of the way.

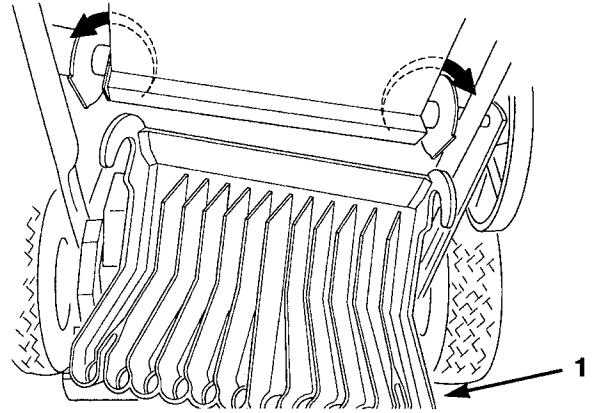

Figure 20

1. Chute

6. Loosely install a clamp to each side of the mower handle, using carriage bolts and lock nuts (Fig. 21). Make sure the clamps slide on the handle.

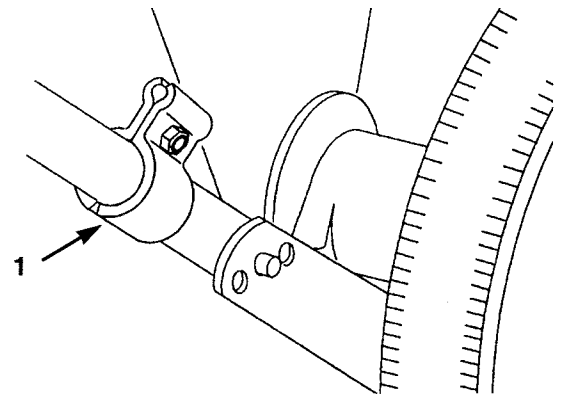

Figure 21

1. Clamp

7. Install the hold-down springs.
 - A. Identify the left and right hold-down springs (Fig. 22).

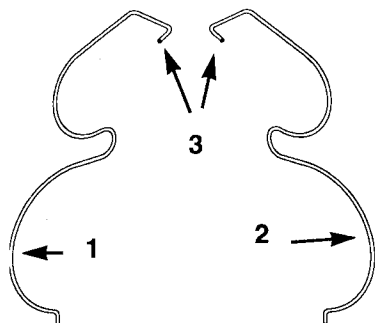

Figure 22

1. Left hold-down spring 3. Hooks
2. Right hold-down spring.

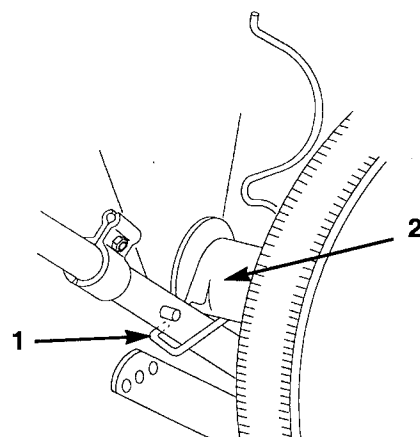

Figure 24

1. Right hold-down spring 2. Axle support

- B.** Disengage the handle adjustment lever from the stud on the handle, then rotate the lever down (Fig. 23).

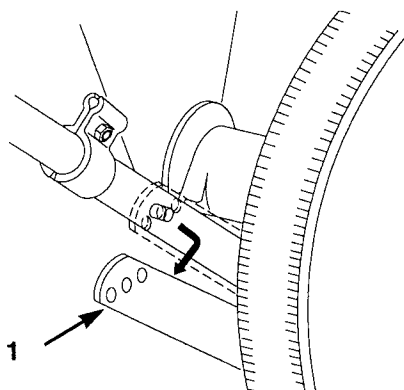

Figure 23

1. Handle adjustment lever

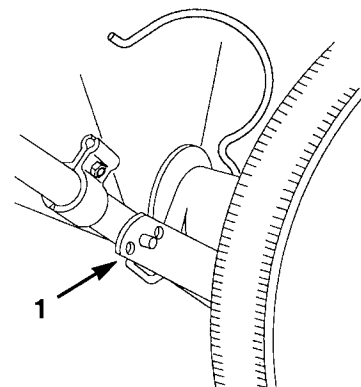

Figure 25

1. Handle adjustment lever

- C.** Place the right-hand hold-down spring under the axle support and hook it under the mower handle (Fig. 24).
- D.** Re-connect the handle adjustment lever to the handle stud, making sure to trap the spring between both parts (Fig. 25).
- E.** Rotate the hold-down spring over the axle support and toward the clamp (Fig. 26). Now move the clamp so its back edge lines up with the end of the hold-down spring and secure the clamp in place by tightening the lock nut.

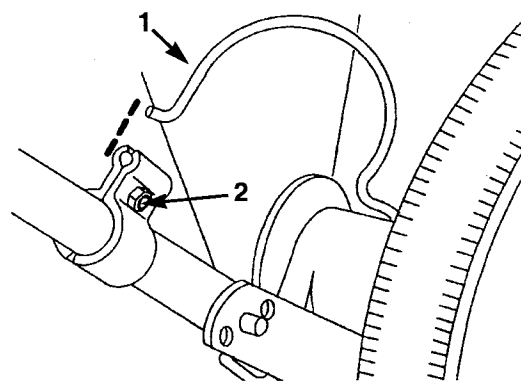

Figure 26

1. Right hold-down spring 2. Lock nut

- F.** Rotate the spring and insert its end into the hold-down clamp (Fig. 27).

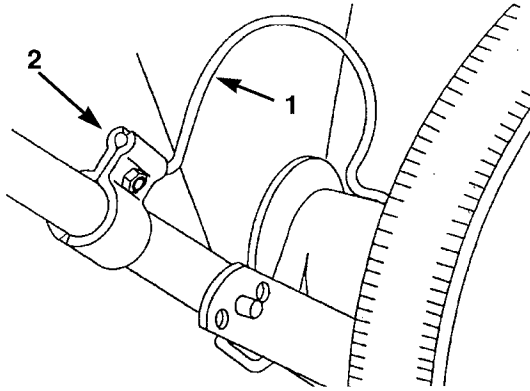

Figure 27

1. Right hold-down spring 2. Clamp

- G.** Install the other spring, using the same procedure.

Note: If you change the handle height or the height of cut on your mower, you must reposition both clamps to assure the spreader stays on the mower and operates properly.

- 8.** Adjust the hopper so it is level and tighten the handle knob securely to lock the hopper in place (Fig. 28).

Note: The extra clamp, carriage bolt, and lock nut are not used on your mower.

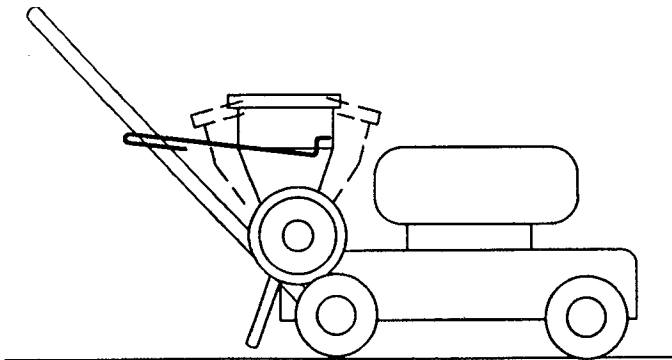

Figure 28

Removing the Spreader

1. Pull the hold-down spring out of the clamp (Fig. 27).
2. Remove mounting rod and bracket from the handle and the hopper (Fig. 18). Reinstall the handle knob and bolt.
3. Rotate the chute up and slide it forward to disengage the hooks from the axle (Fig. 20).
4. Lift the spreader off your mower.

Note: Leave the clamps installed on the handle for easy spreader installation.

Installation on Lawn-Boy® Silver Series Mowers

Self-Propelled Silver Series Models Only:

1. Remove the transmission cover screw and slide the cover to the right (Fig. 29)

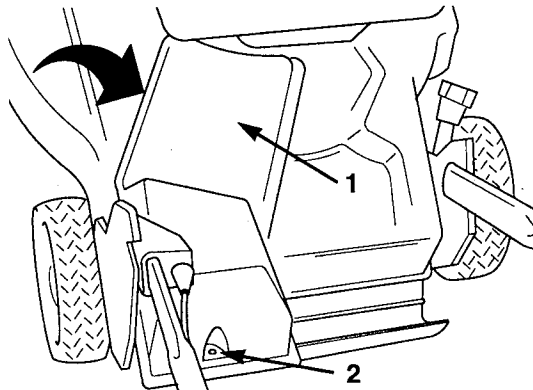

Figure 29

1. Transmission cover 2. Screw

2. Notice where the left side of the handle mounts on the mower. Squeeze the two tabs on the bottom of the cable retainer and remove it from the cable bracket (Fig. 30).
3. Pull the bottom left side of the mower handle inward to remove it from the mounting pin (Fig. 30).
4. Slide the cable bracket off the bottom end of the handle (Fig. 30) and do not re-use the bracket.
5. Install the mower handle onto its mounting pin. Make sure you use the same hole as the opposite side of the handle.

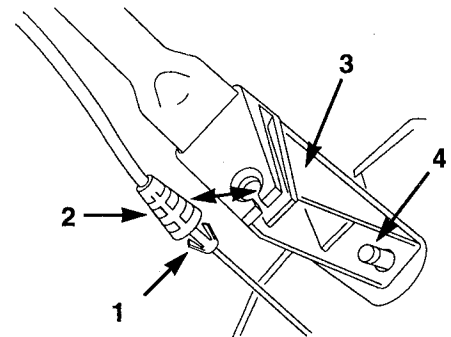

Figure 30

1. Tabs 3. Cable bracket
2. Cable retainer (removed) 4. Mounting pin

6. Install the transmission cover (Fig. 31), using the screw removed in step one. Make sure the tab on the transmission cover goes into the opening in the mower housing (Fig. 31).

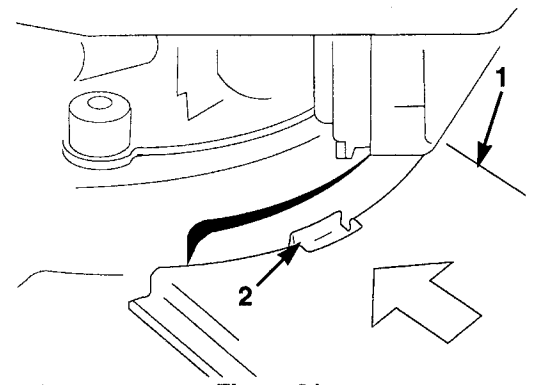

Figure 31

1. Transmission cover 2. Tab

All Silver Series Models:

1. Place the spreader on your mower (Fig. 32). The wheels of the spreader must rest on the wheels of the mower.

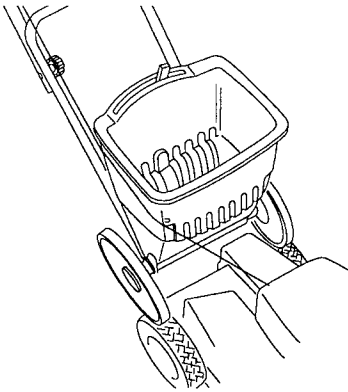

Figure 32

2. Rotate the axle supports so the thin part of its flange fits between the mower handles (Fig. 33).

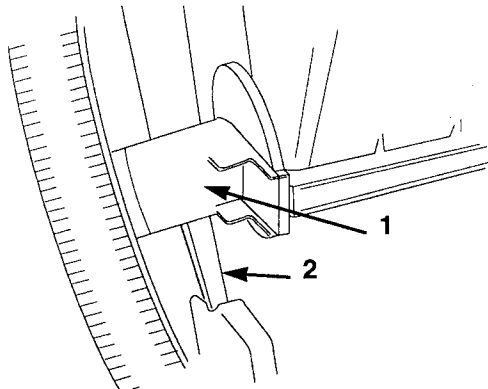

Figure 33

1. Axle support
2. Mower handle

3. Remove the handle knob and bolt (Fig. 34) from the right side of the mower.
4. Install the mounting rod.
 - A. Insert the mounting rod into the hole on the right side of the hopper (Fig. 34).
 - B. Put the engine rope into the curve in the mounting rod (Fig. 34).
 - C. Install the U-shaped end of the mounting rod against the outside of the mower handle, using the new bracket and the original bolt and handle knob (Fig. 35). Make sure the curved sides of the bracket fit around the mounting rod.

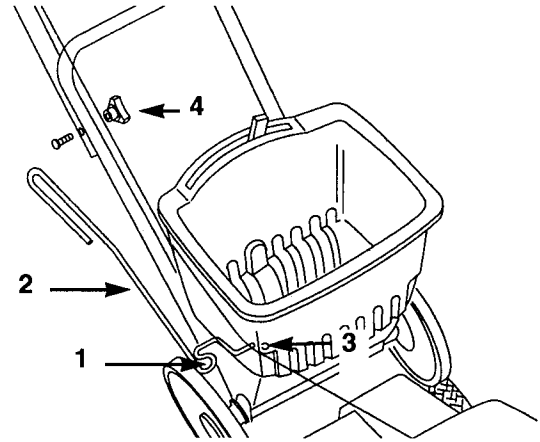

Figure 34

1. Curve in mounting rod
2. Mounting rod
3. Hole for mounting rod
4. Handle knob

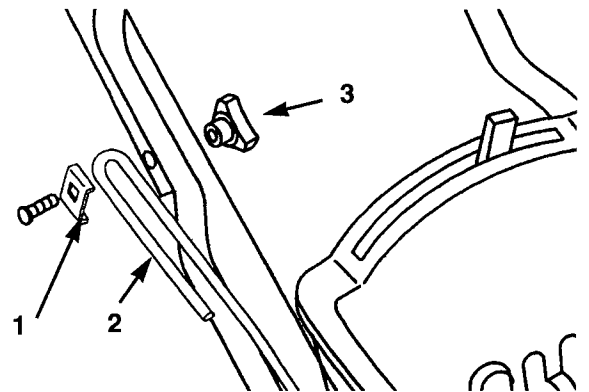

Figure 35

1. Mounting rod bracket
2. Mounting rod
3. Handle knob

5. Install the chute (Fig. 36). Notice that the chute has a hook at both sides.
 - A. Place the chute under and slightly forward of the hopper. Then hook the chute onto the axle.
 - B. Rotate the chute down until its back edge fits into the notch on the ribs on the lower front side of the hopper. You may need to move the mower control cables out of the way.

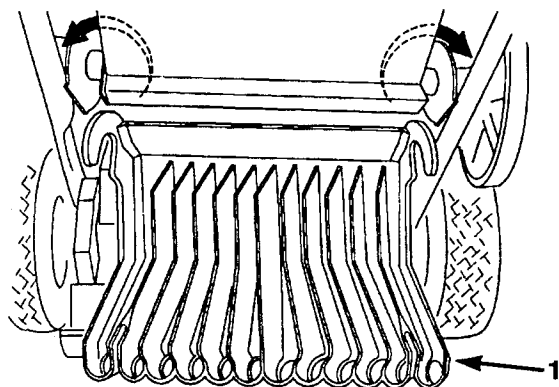

Figure 36

1. Spreader chute

6. Loosely install a clamp to each side of the mower handle, using carriage bolts and lock nuts (Fig. 37). Make sure the clamps slide on the handle.

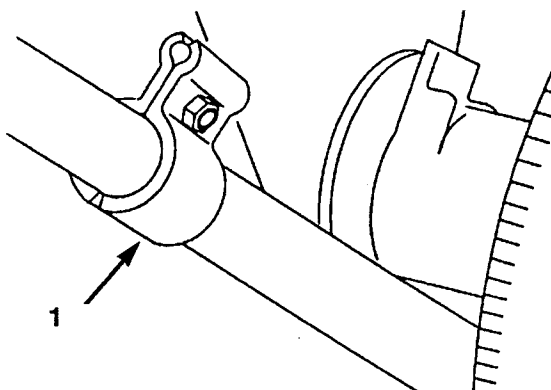

Figure 37

1. Clamp

7. Install the hold-down springs.

- A. Identify the left and right hold-down springs (Fig. 38).
- B. Place the right-hand hold-down spring under the axle support and hook it under the mower handle (Fig. 39).
- C. Rotate the hold-down spring over the axle support and toward the clamp (Fig. 39). Now move the clamp so its back edge lines up with the end of the hold-down spring and secure the clamp in place by tightening the lock nut.
- D. Rotate the spring and insert its end into the hold-down clamp (Fig. 40).

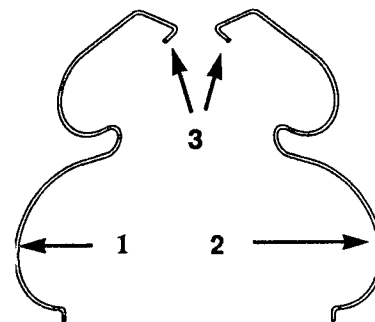

Figure 38

1. Left hold-down spring 3. Hooks
2. Right hold-down spring

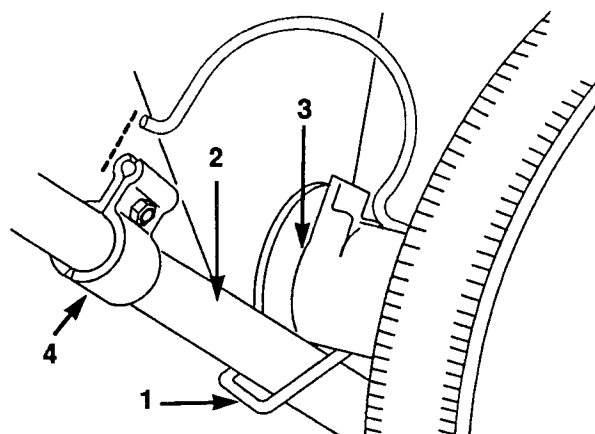

Figure 39

1. Right hold-down spring 3. Axle support
2. Mower handle 4. Clamp

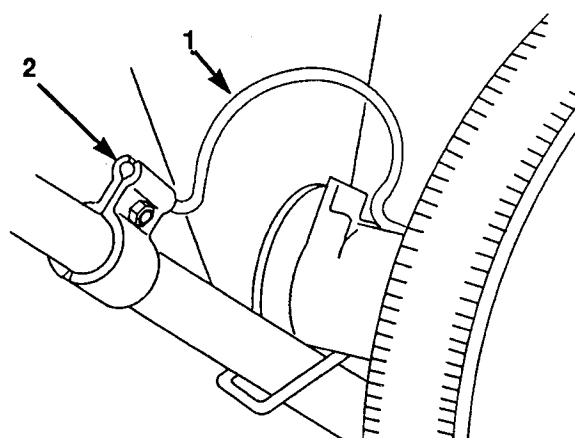

Figure 40

1. Right hold-down spring 2. Clamp

- E. Install the other spring, using the same procedure.

Note: If you change the handle height or the height-of-cut on your mower, you must reposition both clamps to assure the spreader stays on the mower and operates properly.

8. Adjust the hopper so it is level and tighten the handle knob securely to lock the hopper in place (Fig. 41).

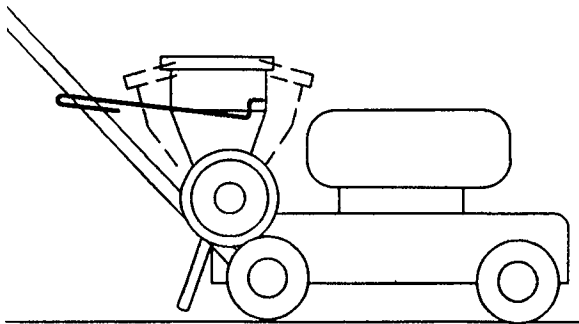

Figure 41

9. Using the carriage bolt and lock nut, loosely install a clamp for the traction control cable (Fig. 42). Next, insert the cable into the clamp and tighten the lock nut just enough to retain the cable. Now rotate the clamp so the traction cable fits between the chute and the handle bracket on the mower. While holding the clamp in place, slide the traction cable backward to remove slack and tighten the lock nut.
10. Check the traction control cable adjustment by operating the traction control lever. If you feel it takes too much hand pressure to operate the control lever, loosen the clamp and move the control cable slightly toward the engine. If the traction drive system slips, adjust the control cable backward slightly.

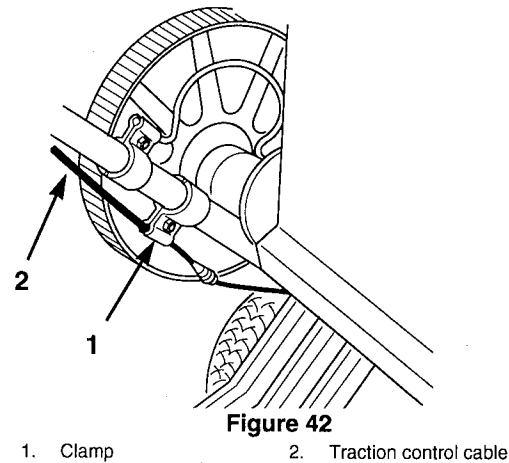

Figure 42

Removing the Spreader

1. Pull the hold-down spring out of the clamp (Fig. 40).
2. Remove the mounting rod from the handle and the hopper (Fig. 34). Reinstall the handle knob and bolt.
3. Rotate the chute up and slide it forward to disengage the hooks from the axle (Fig. 36).
4. Lift the spreader off your mower.

Note: Leave the clamps installed on the handle for easy spreader installation.

Installation on Lawn-Boy® “L” Series Mowers

IMPORTANT: Look at your mower and find the model and serial number tag on the housing. You have an “L” series mower if the first character of the model number is an “L”.

1. Place the spreader on your mower (Fig. 43). The wheels of the spreader must rest on the wheels of the mower.

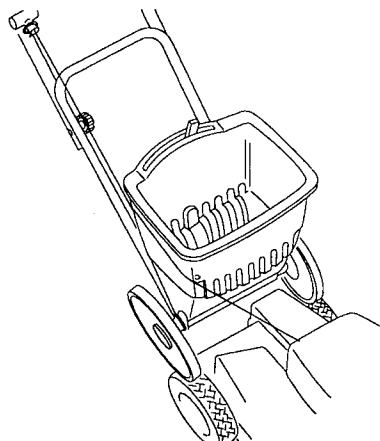

Figure 43

2. Rotate the axle supports so the thin part of its flange fits between the mower handles (Fig. 44).

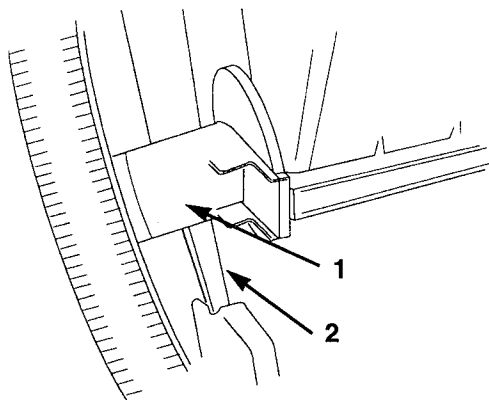

Figure 44

1. Axle support
2. Mower handle

3. Remove the handle knob and bolt (Fig. 45) from the right side of the mower.
4. Install the mounting rod.

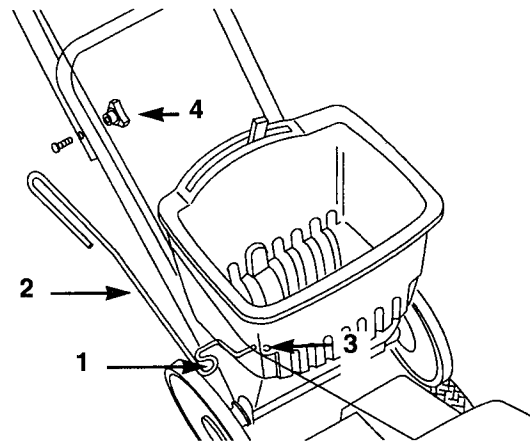

Figure 45

1. Curve in mounting rod
2. Mounting rod
3. Hole for mounting rod
4. Handle knob

- A. Insert the mounting rod into the hole on the right side of the hopper (Fig. 45).
- B. Put the engine rope into the curve in the mounting rod (Fig. 45).
- C. Install the U-shaped end of the mounting rod against the outside of the mower handle, using the new bracket and the original bolt and handle knob (Fig. 46). Make sure the curved sides of the bracket fit around the mounting rod.

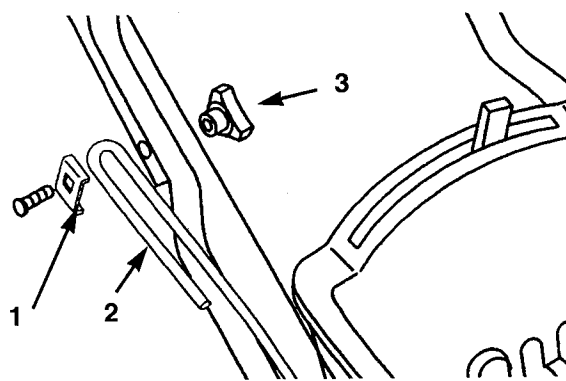

Figure 46

1. Mounting rod bracket
2. Mounting rod
3. Handle knob

5. Install the chute (Fig. 47). Notice that the chute has a hook at both sides.

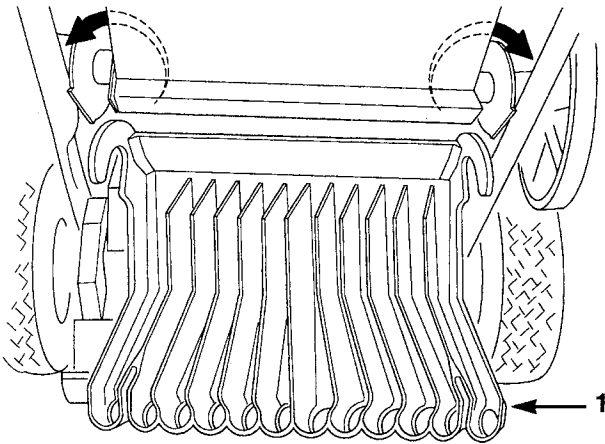

Figure 47

1. Spreader chute.

- A. Place the chute under and slightly forward of the hopper. Then hook the chute onto the axle. You must lift the hopper up slightly to install the chute on self-propelled mowers.
 - B. Rotate the chute down until its back edge fits into the notch on the ribs on the lower front side of the hopper. You may need to move the mower control cables out of the way.
6. Loosely install a clamp to each side of the mower handle, using carriage bolts and lock nuts (Fig. 48). Install the clamps at a 45° angle to the ground. Make sure the clamps slide on the handle.
 7. Install the hold-down springs.

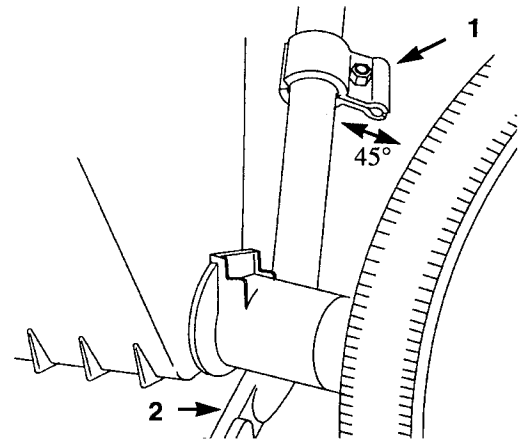

Figure 48

1. Clamp
2. Mower handle

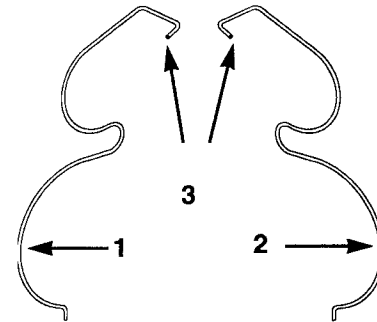

Figure 49

1. Left hold-down spring
2. Right hold-down spring
3. Hooks

- A. Identify the left and right hold-down springs (Fig. 49).
- B. Hook the hold-down spring under the mower handle and between the control cable (Fig. 50).
- C. Rotate the hold-down spring over the axle support and toward the clamp (Fig. 50). While keeping the clamp at a 45° angle to the ground, move the clamp so its back edge lines up with the end of the hold-down spring and secure the clamp in place by tightening the lock nut.
- D. Rotate the spring and insert its end into the hold-down clamp (Fig. 51).

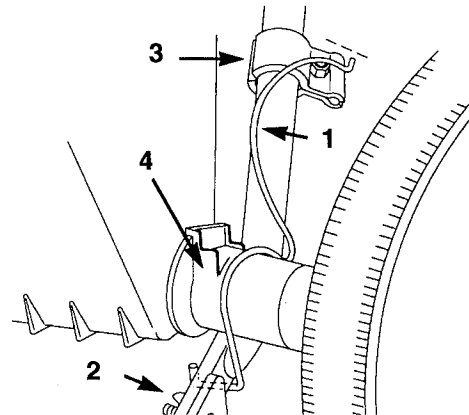

Figure 50

1. Hold-down spring
2. Mower handle
3. Clamp
4. Axle support

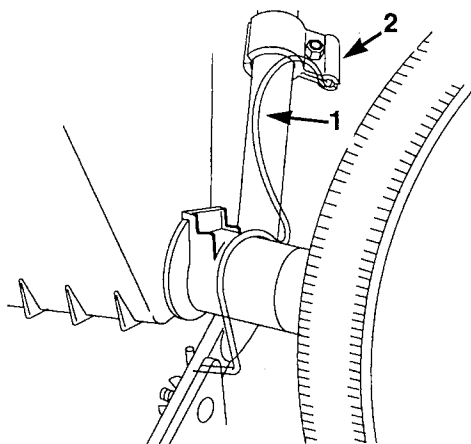

Figure 51

1. Spring 2. Clamp

- E. Install the other spring, using the same procedure.

Note: If you change the handle height or the height-of-cut on your mower, you must reposition both clamps to assure the spreader stays on the mower and operates properly.

8. Adjust the hopper so it is level and tighten the handle knob securely to lock the hopper in place (Fig. 52).

Note: The extra clamp, carriage bolt, and lock nut are not used on your mower.

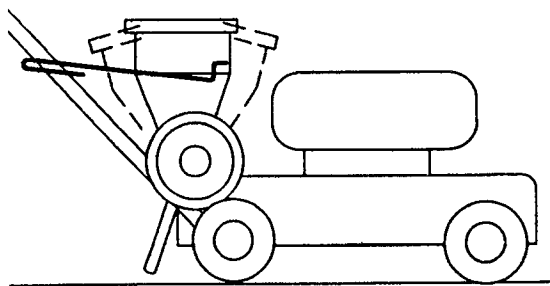

Figure 52

Removing the Spreader

1. Pull the hold-down spring out of the clamp (Fig. 51).
2. Remove the mounting rod and bracket from the handle and the hopper (Fig. 45). Reinstall the handle knob and bolt.
3. Rotate the chute up and slide it forward to disengage the hooks from the axle (Fig. 47).
4. Lift the spreader off your mower.

Note: Leave the clamps installed on the handle for easy spreader installation.

Installation on Lawn-Boy® “S” Series Mowers

IMPORTANT: Look at your mower and find the model and serial number tag on the housing. You have an “S” series mower if the first character of the model number is an “S”.

1. Place the spreader on your mower (Fig. 53). The wheels of the spreader must rest on the wheels of the mower.

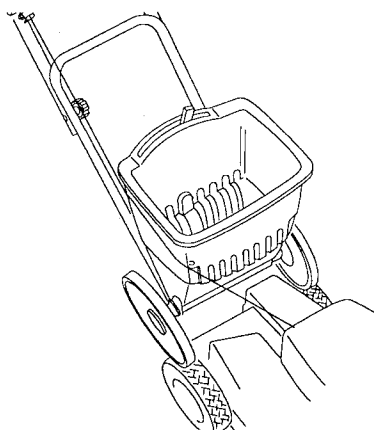
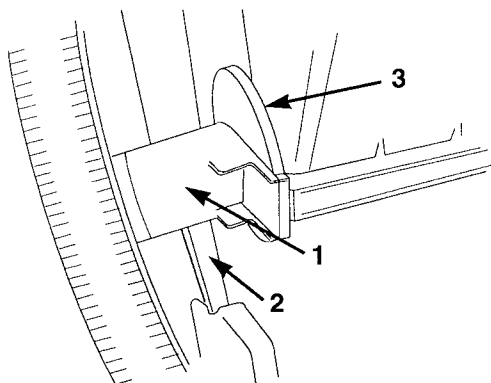

Figure 53

2. Rotate the axle supports so the thin part of its flange fits between the mower handle (Fig. 54 & Fig. 55).

Note: On self-propelled models, assure the flange on the axle support is toward the hopper (Fig. 54). On hand-push models, assure the flange on the axle support is toward the wheel (Fig. 55).



**Figure 54
(Self-Propelled Model)**

- | | |
|-----------------|-----------|
| 1. Axle support | 3. Flange |
| 2. Mower handle | |

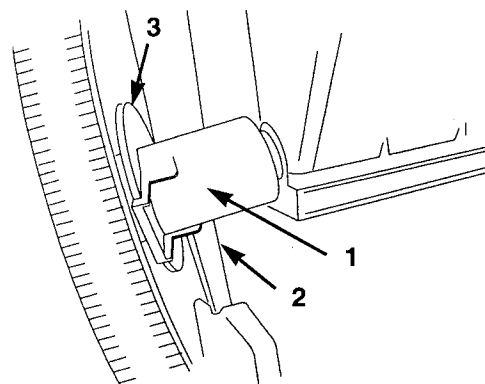

**Figure 55
(Hand-Push Model)**

- | | |
|-----------------|-----------|
| 1. Axle support | 3. Flange |
| 2. Handle | |

3. Remove the handle knob and bolt (Fig. 56) from the right side of the mower.
4. Install the mounting rod.
 - A. Insert the mounting rod into the hole on the right side of the hopper (Fig. 56).
 - B. Put the engine rope into the curve in the mounting rod (Fig. 56).
 - C. Install the U-shaped end of the mounting rod against the outside of the mower handle, using the new bracket and the original bolt and handle knob (Fig. 57). Make sure the curved sides of the bracket fit around the mounting rod.

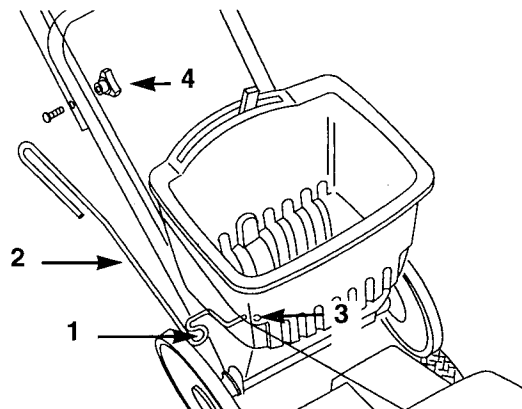

Figure 56

- | | |
|--------------------------|--------------------------|
| 1. Curve in mounting rod | 3. Hole for mounting rod |
| 2. Mounting rod | 4. Handle knob |

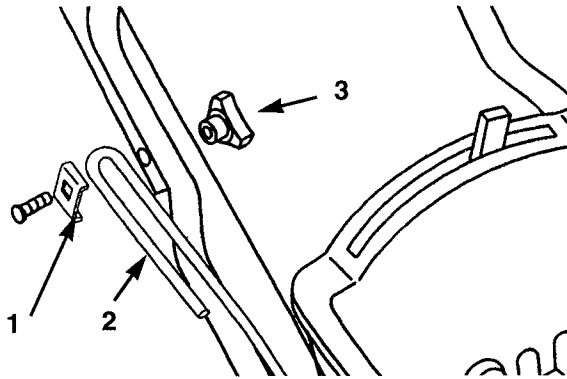

Figure 57

- 1. Mounting rod bracket
- 2. Mounting rod
- 3. Handle knob

5. Install the chute (Fig. 58). Notice that the chute has a hook at both sides.
 - A. Place the chute under and slightly forward of the hopper. Then hook the chute onto the axle. You must lift the hopper up slightly to install the chute on self-propelled mowers.
 - B. Rotate the chute down until its back edge fits into the notch on the ribs on the lower front side of the hopper. You may need to move the mower control cables out of the way.

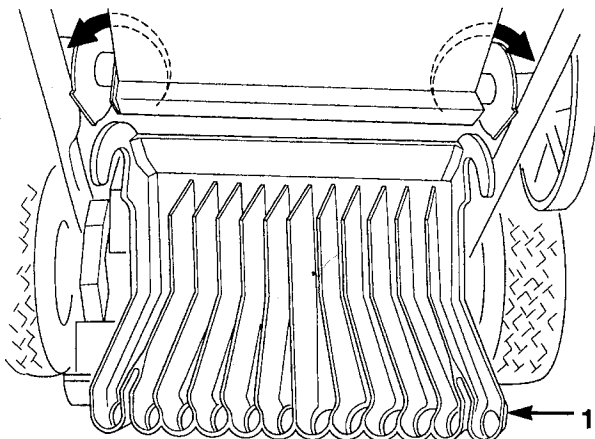

Figure 58

- 1. Spreader chute

6. Loosely install a clamp to each side of the mower handle, using carriage bolts and lock nuts (Fig. 59). Install the clamps at a 45° angle to the ground. Make sure the clamps slide on the handle.
7. Install the hold-down springs.

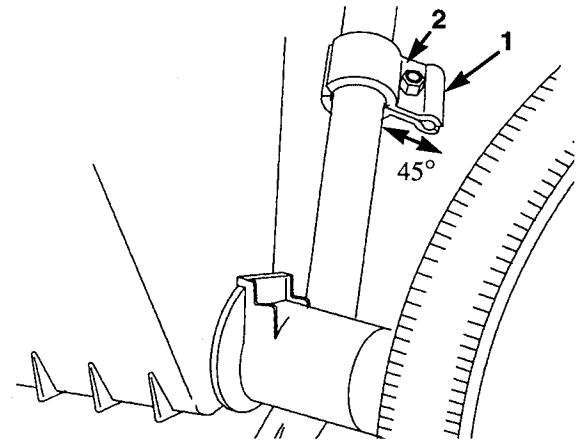

Figure 59

- 1. Clamp
- 2. Bolt and nut

- A. Identify the left and right hold-down springs (Fig. 60).

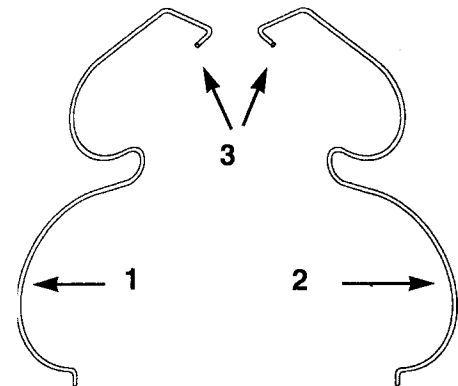

Figure 60

- 1. Left hold-down spring
- 2. Right hold-down spring
- 3. Hooks

- B. Hook the hold-down spring under the mower handle and between the control cable (Fig. 61).
- C. Rotate the hold-down spring over the axle support and toward the clamp (Fig. 61). While keeping the clamp at a 45° angle to the ground, move the clamp so its back edge lines up with the end of the hold-down spring and secure the clamp in place by tightening the lock nut.
- D. Rotate the spring forward and insert its end into the hold-down clamp (Fig. 62).

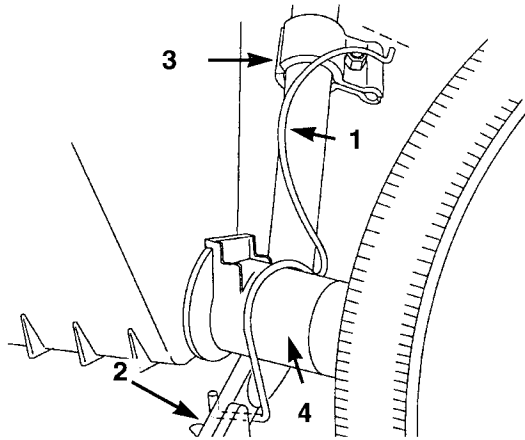

Figure 61

- | | |
|---------------------|-----------------|
| 1. Hold-down spring | 3. Clamp |
| 2. Mower handle | 4. Axle support |

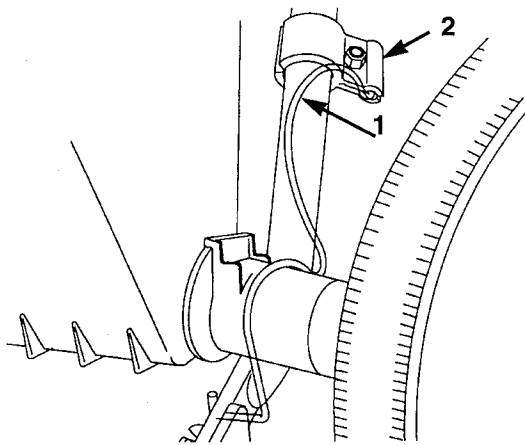

Figure 62

- | | |
|---------------------|----------|
| 1. Hold-down spring | 2. Clamp |
|---------------------|----------|

- E. Install the other spring, using the same procedure.

Note: If you change the handle height or the height-of-cut on your mower, you must reposition both clamps to assure the spreader stays on the mower and operates properly.

8. Adjust the hopper so it is level and tighten the handle knob securely to lock the hopper in place (Fig. 63).

Note: The extra clamp, carriage bolt, and lock nut are not used on your mower.

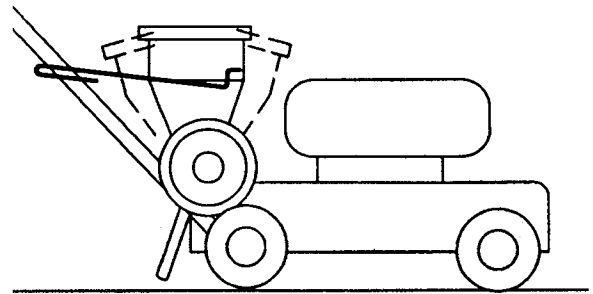

Figure 63

Removing the Spreader

1. Pull the hold-down spring out of the clamp (Fig. 62).
2. Remove the mounting rod and bracket from the handle and the hopper (Fig. 56). Reinstall the handle knob and bolt.
3. Rotate the chute up and slide it forward to disengage the hooks from the axle (Fig. 58).
4. Lift the spreader off your mower.

Note: Leave the clamps installed on the handle for easy spreader installation.

Installation on 1993 Lawn-Boy® Gold Series Mowers

IMPORTANT: Look at the top of the engine to verify that you have a Lawn-Boy Gold Series mower. Then find the model and serial number tag on the mower housing. You have a 1993 model if the first two digits of the serial number are "39".

Install the *Mow & Feed*™ Mounting Kit (Model 52085)

1. Remove the wing nut and lock washer holding the traction bracket against the left-hand handle bracket (Fig. 64).

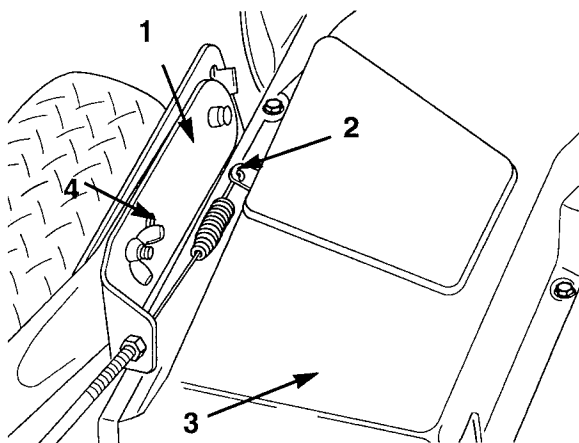

Figure 64

- | | |
|------------------------|---------------|
| 1. Traction bracket | 3. Belt cover |
| 2. Traction cable hook | 4. Wing nut |

2. Rotate the traction cable and bracket assembly upward and remove the cable hook from the transmission lever (Fig. 64).
3. Remove the two screws and set the belt cover aside.
4. Remove the original shift cable.
 - A. Remove the hex-head screw holding the shift cable bracket on the transmission (Fig. 65).
 - B. Rotate the shift cable and bracket assembly upward and remove the cable hook from the shift lever (Fig. 65).

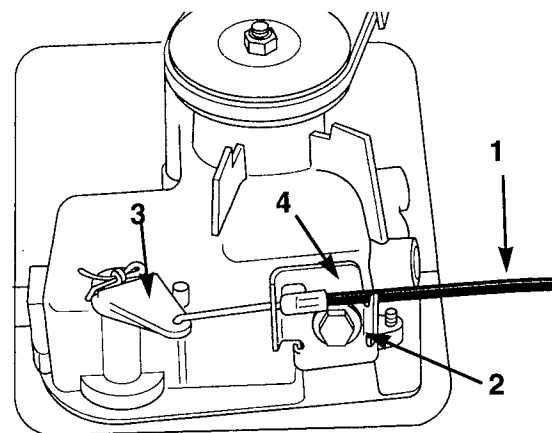

Figure 65

- | | |
|-------------------|------------------------|
| 1. Shift cable | 3. Shift lever |
| 2. Hex-head screw | 4. Shift cable bracket |

- C. Slide the shift cable out of the bracket (Fig. 66).

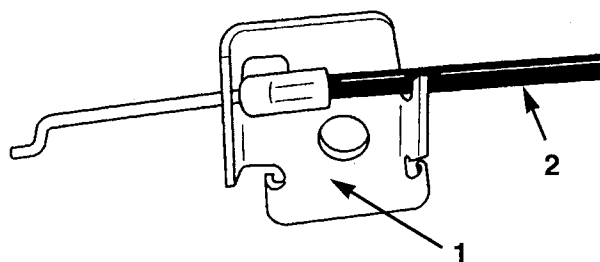

Figure 66

- | | |
|------------------------|----------------|
| 1. Shift cable bracket | 2. Shift cable |
|------------------------|----------------|

- D. While flexing the tab under the control panel away from the shift control, remove the control from the panel. Completely remove the shift control and do not use it again.(Fig. 67).
5. Install the new shift cable.
 - A. Insert the end of the shift cable through the slot and the hole in the control panel (Fig. 68).
 - B. Push the shift control into the slot in the control panel until it snaps into place (Fig. 67).

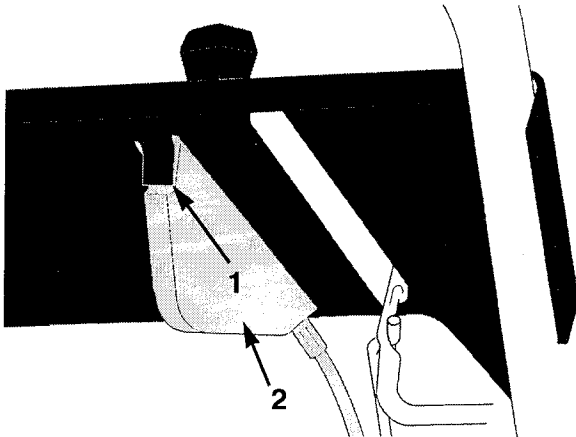

Figure 67

1. Tab securing shift control 2. Shift control

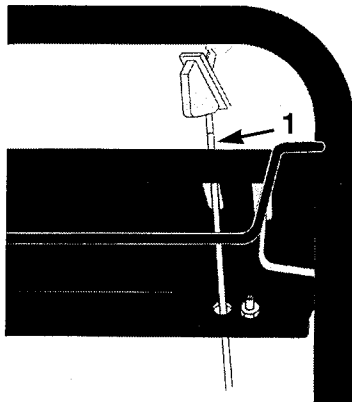

Figure 68

1. Shift cable (through slot and hole)

- C. Slide the shift cable into the bracket (Fig. 66).
- D. Insert the end of the shift cable into the shift lever (Fig. 69).
- E. Secure the original shift cable bracket to the transmission, using the original hex-head screw (Fig. 69).
6. Install the belt cover, using two screws (Fig. 70).
7. Hook the end of the traction cable into the hole in the traction lever (Fig. 70).
8. Install an L-shaped bracket on the left-hand handle bracket (Fig. 70).

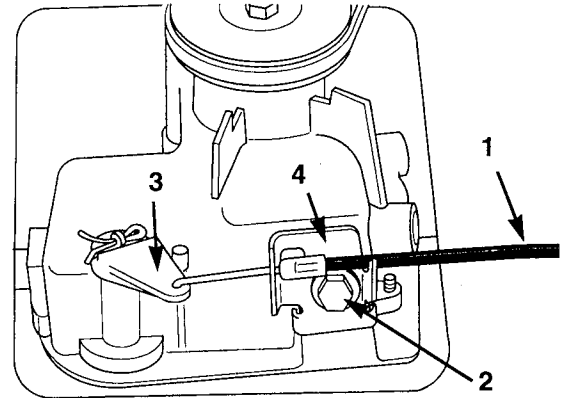

Figure 69

1. Shift cable 3. Shift lever
2. Hex-head screw 4. Shift bracket

9. Install the shift bracket so its three holes line up with the holes in the handle mounting bracket. Secure the brackets together with the original carriage bolt, lock washer and wing nut. (Fig. 70).

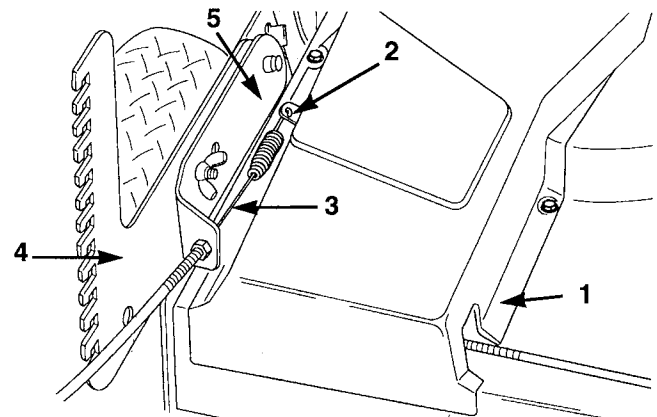

Figure 70

1. Belt cover 4. L-Shaped bracket
2. Traction lever 5. Shift bracket
3. Traction cable

10. Remove the wing nut and lock washer holding the handle against the right-hand handle bracket (Fig. 71). Mount the remaining L-shaped bracket and handle on the handle bracket with the original carriage bolt, lock washer, and wing nut.
11. Secure the shift cable to the hole in the right-hand L-shaped bracket, using the plastic cable tie (Fig. 71). Cut off the excess cable tie, leaving about 1/4 inch extending.

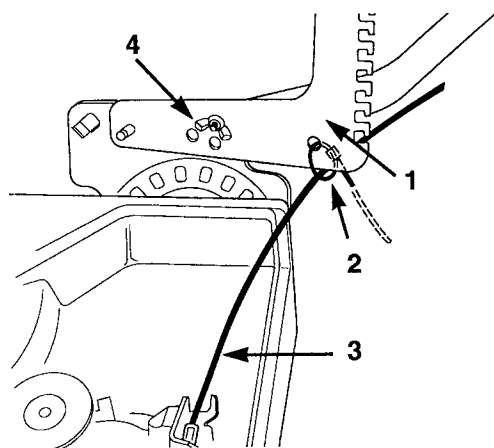

Figure 71

- | | |
|--------------|----------------|
| 1. L bracket | 3. Shift cable |
| 2. Cable tie | 4. Wing nut |

Spreader Installation

1. Place the spreader on your mower (Fig. 72). The wheels of the spreader must rest on the wheels of the mower. The axle support flanges must also fit between the L-shaped brackets.

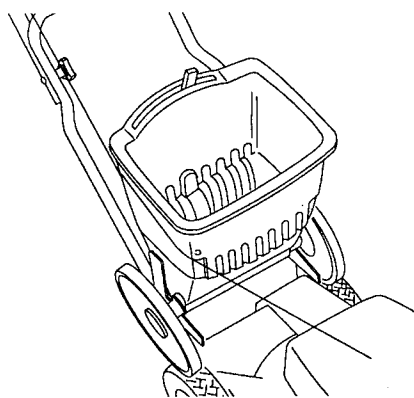

Figure 72

2. Rotate the axle supports so the raised rib points forward, away from the L-shaped bracket (Fig. 73).
3. Remove the handle knob and bolt (Fig. 74) from the right side of the mower.
4. Install the mounting rod.
 - A. Insert the mounting rod into the hole on the right side of the hopper (Fig. 74).

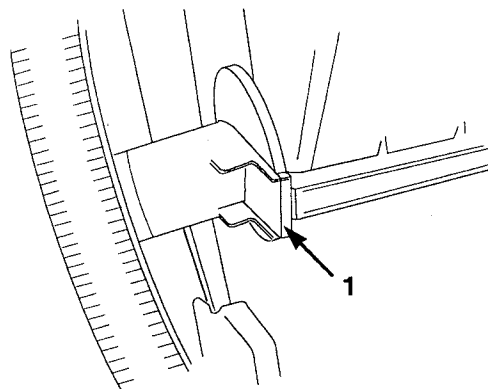

Figure 73

1. Axle support raised rib

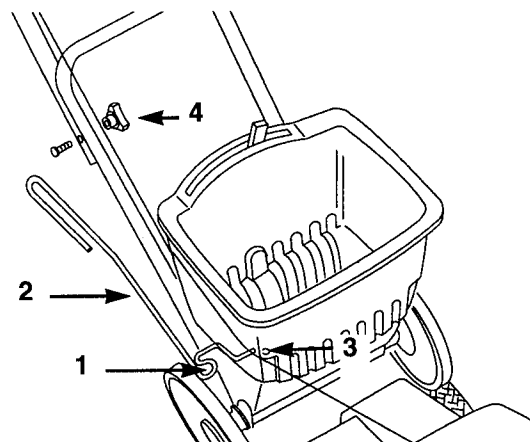

Figure 74

- | | |
|--------------------------|--------------------------|
| 1. Curve in mounting rod | 3. Hole for mounting rod |
| 2. Mounting rod | 4. Handle knob |

- B. Put the engine rope into the curve in the mounting rod (Fig. 74).
- C. Install the U-shaped end of the mounting rod against the outside of the mower handle, using the new bracket and the original bolt and handle knob (Fig. 75). Make sure the curved sides of the bracket fit around the mounting rod.
5. Install the chute (Fig. 76). Notice that the chute has a hook at both sides.
 - A. Place the chute under and slightly forward of the hopper. Then hook the chute onto the axle. You must lift the hopper up slightly to install the chute on self-propelled mowers.
 - B. Rotate the chute down until its back edge fits

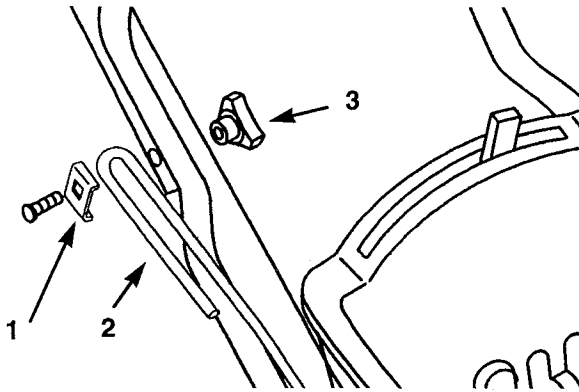

Figure 75

- 1. Mounting rod bracket
- 2. Mounting rod
- 3. Handle knob

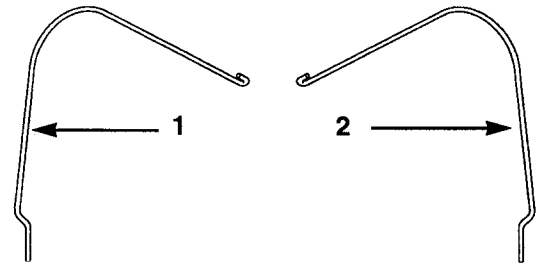

Figure 77

- 1. Left hold-down spring
- 2. Right hold-down spring

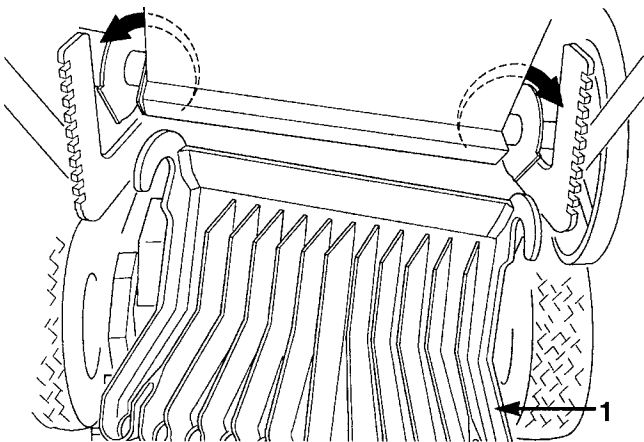

Figure 76

- 1. Chute

into the notch on the ribs on the lower front side of the hopper. You may need to move the mower control cable out of the way.

6. Install the hold-down springs.

- A.** Identify the left and right hold-down springs (Fig. 77).
- B.** From the front side of the spreader, place the right-side, hold-down spring under the spreader's axle support so the U-shaped hook of the hold-down spring hooks into the lowest possible notch on the bracket (Fig. 78).
- C.** Rotate the hold-down spring around the spreader axle support and hook it into the lowest possible notch on the upper part of the L-shaped bracket (Fig. 79).

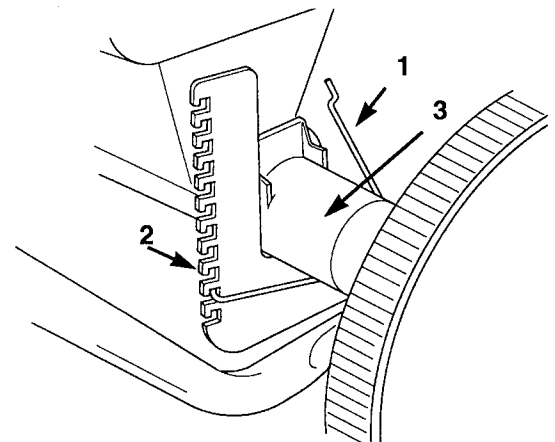

Figure 78

- 1. Hold-down spring
- 2. L-bracket
- 3. Axle support

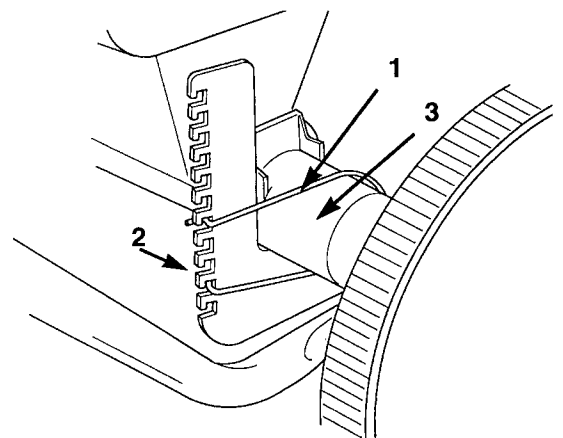

Figure 79

- 1. Hold-down spring
- 2. L-bracket
- 3. Axle support

- D. Install the other spring, using the same procedure.

Note: If you change the handle height or the height-of-cut on your mower, you must reposition both clamps to assure the spreader stays on the mower and operates properly.

7. Adjust the hopper so it is level and tighten the handle knob securely to lock the hopper in place (Fig. 80).

Note: The extra clamp, carriage bolt, and lock nut are not used on your mower.

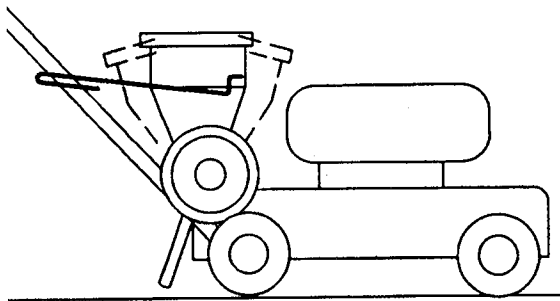

Figure 80

Removing the Spreader

1. Remove the hold-down spring by disengaging it from the L-shaped bracket (Fig. 79).
2. Remove the mounting rod and bracket from the handle and the hopper (Fig. 74). Reinstall the handle knob and bolt.
3. Rotate the chute up and slide it forward to disengage the hooks from the axle (Fig. 76).
4. Lift the spreader off your mower.

Note: Leave the L-brackets installed on the mower for easy spreader installation.

Installation on 1994 Lawn-Boy® Gold Series Mowers

IMPORTANT: Look at the top of the engine to verify that you have a Lawn-Boy Gold Series mower. Then find the model and serial number tag on the mower housing. You have a 1994 model if the first two digits of the serial number are "49".

1. Place the spreader on your mower (Fig. 81). The wheels of the spreader must rest on the wheels of the mower. Be careful not to kink the traction cable (Fig. 81).

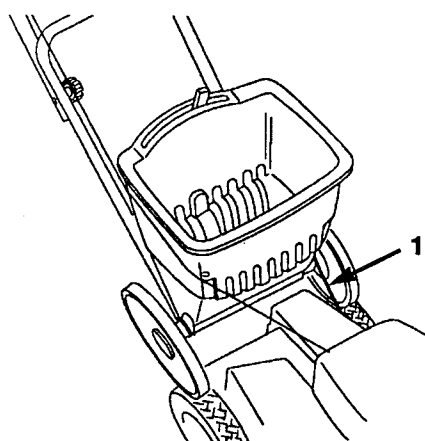

Figure 81

1. Traction cable

2. Rotate the axle supports so the thin part of its flange fits between the mower handles (Fig. 82). Assure that the flange on the axle support is toward the wheel (Fig. 82).

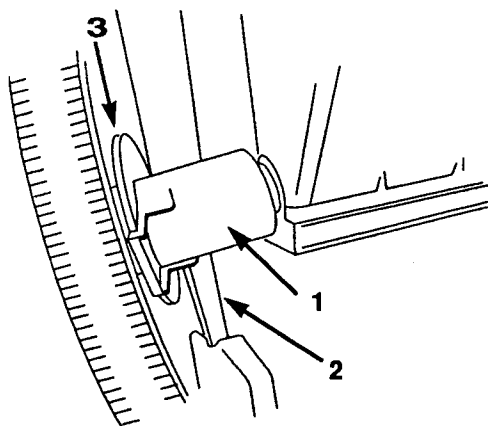

Figure 82

1. Axle support
2. Mower handle
3. Flange

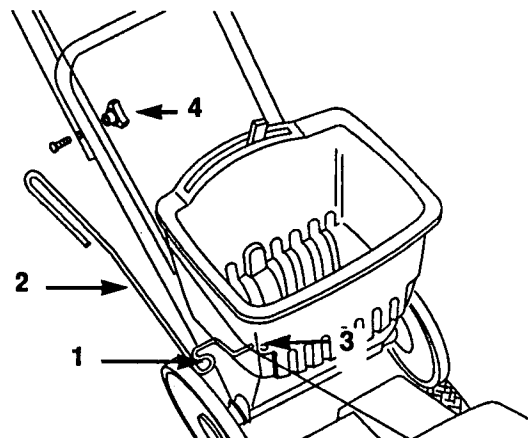

Figure 83

1. Curve in mounting rod
2. Mounting rod
3. Hole for mounting rod
4. Handle knob

3. Remove the handle knob and bolt (Fig. 83) from the right side of the mower.
4. Install the mounting rod.
 - A. Insert the mounting rod into the hole on the right side of the hopper (Fig. 83).
 - B. Put the engine rope into the curve in the mounting rod (Fig. 83).
 - C. Install the U-shaped end of the mounting rod against the outside of the mower handle, using the new bracket and the original bolt and handle knob (Fig. 84). Make sure the curved sides of the bracket fit around the mounting rod.

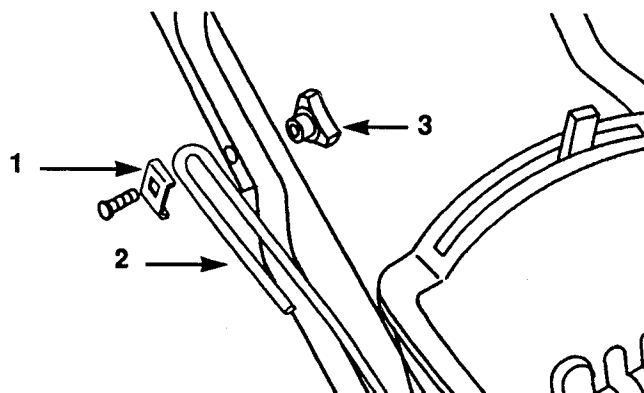

Figure 84

1. Mounting rod bracket
2. Mounting rod
3. Handle knob
4. Handle knob

5. Install the chute (Fig. 85). Notice that the chute has a hook at both sides.

- A. Place the chute under and slightly forward of the hopper. Then hook the chute onto the axle. You must lift the hopper up slightly to install the chute on self-propelled mowers.
- B. Rotate the chute down until its back edge fits into the notch on the ribs on the lower front side of the hopper. You may need to move the mower control cables out of the way.

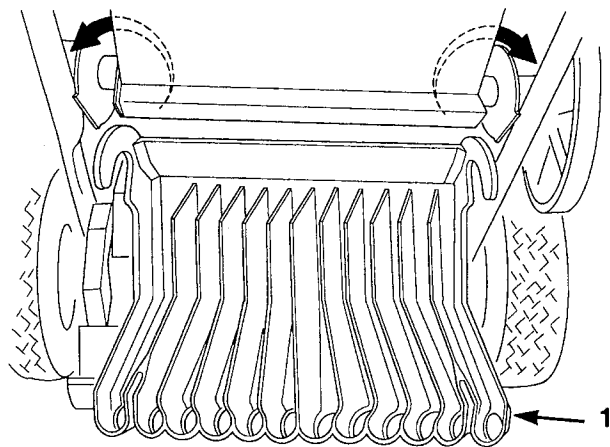

Figure 85

1. Spreader Chute

6. Loosely install a clamp to each side of the mower handle, using carriage bolts and lock nuts (Fig. 86). Make sure the clamps slide on the handle.

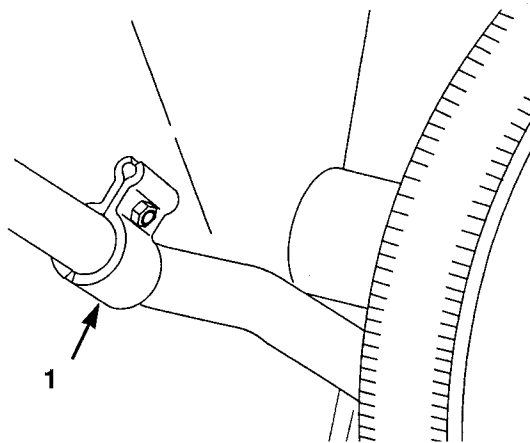

Figure 86

1. Clamp

7. Install the hold-down springs.

- A. Identify the left and right hold-down springs (Fig. 87).

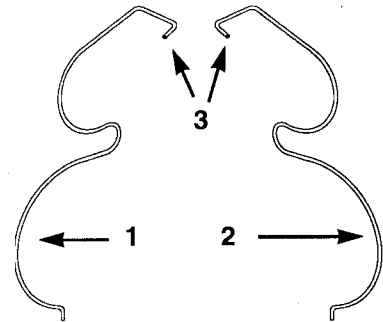

Figure 87

1. Left Hold-down Spring 3. Hooks
2. Right Hold-down Spring

- B. Place the right-hand hold-down spring under the axle support and hook it under the mower handle (Fig. 88).

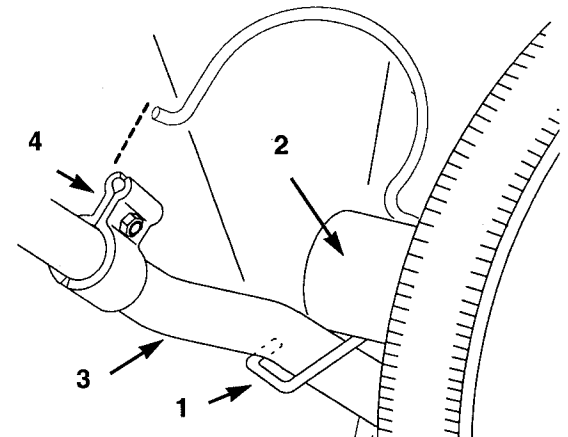

Figure 88

1. Right hold-down spring 3. Mower handle
2. Axle support 4. Clamp

- C. Rotate the hold-down spring over the axle support and toward the clamp (Fig. 88). Now move the clamp so its back edge lines up with the end of the hold-down spring and secure the clamp in place by tightening the lock nut.
- D. Rotate the spring and insert its end into the hold-down clamp (Fig. 89).

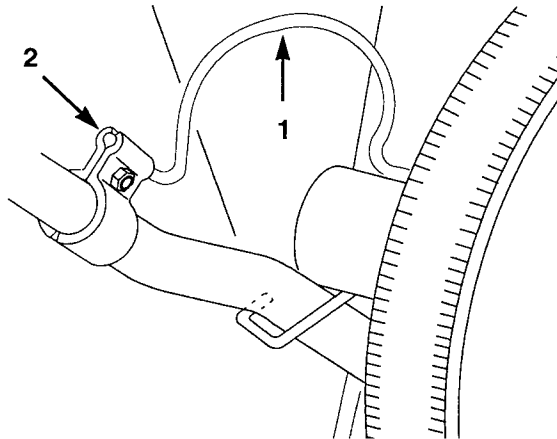

Figure 89

1. Spring

2. Clamp

- E. Install the other spring, using the same procedure.

Note: If you change the handle height or the height-of-cut on your mower, you must reposition both clamps to assure the spreader stays on the mower and operates properly.

8. Adjust the hopper so it is level and tighten the handle knob securely to lock the hopper in place (Fig. 90).

Note: The extra clamp, carriage bolt, and lock nut are not used on your mower.

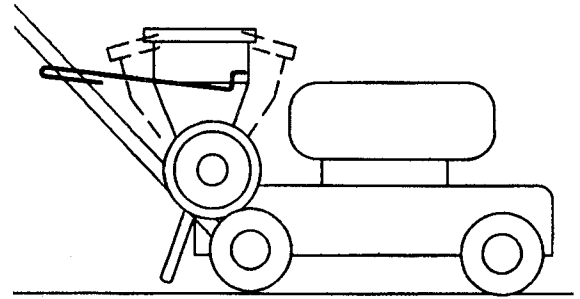

Figure 90

Removing the Spreader

1. Pull the hold-down spring out of the clamp (Fig. 89).
2. Remove the mounting rod and bracket from the handle and the hopper (Fig. 83). Reinstall the handle knob and bolt.
3. Rotate the chute up and slide it forward to disengage the hooks from the axle (Fig. 85).
4. Lift the spreader off your mower.

Note: Leave the clamps installed on the handle for easy spreader installation.

Installation on 1994 Lawn-Boy® Green Series Mowers

IMPORTANT: Look at the top of the engine to verify that you have a Lawn-Boy Green Series mower. Then find the model and serial number tag on the mower housing. You have a 1994 model if the first two digits of the serial number are "49".

1. Place the spreader on your mower (Fig. 91). The wheels of the spreader must rest on the wheels of the mower.

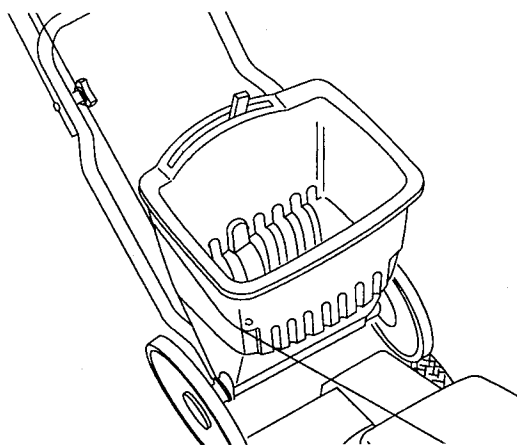

Figure 91

2. Rotate the axle supports so the thin part of its flange fits between the mower handles (Fig. 92). The flange of the axle support must be next to the hopper.

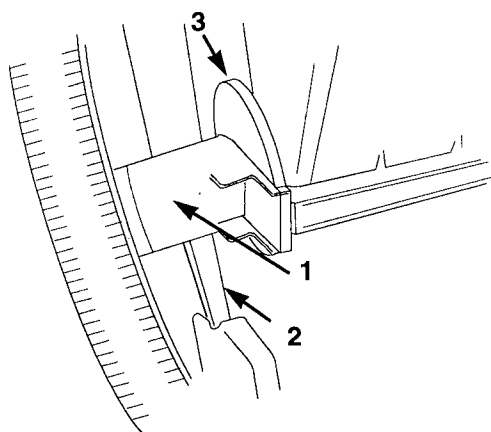

Figure 92

- | | |
|-----------------|-----------|
| 1. Axle support | 3. Flange |
| 2. Mower handle | |

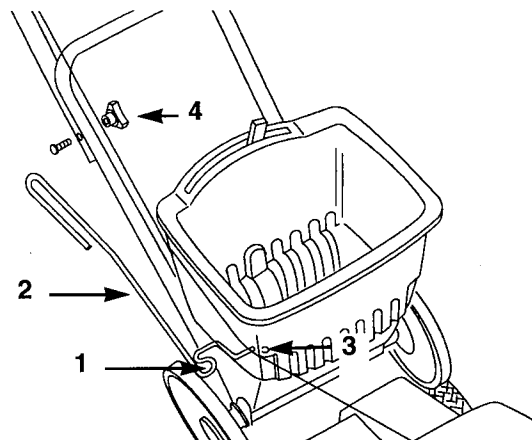

Figure 93

- | | |
|--------------------------|--------------------------|
| 1. Curve in mounting rod | 3. Hole for mounting rod |
| 2. Mounting rod | 4. Handle knob |

3. Remove the handle knob and bolt (Fig. 93) from the right side of the mower.
4. Install the mounting rod.
 - A. Insert the mounting rod into the hole on the right side of the hopper (Fig. 93).
 - B. Put the engine rope into the curve in the mounting rod (Fig. 93).
 - C. Install the U-shaped end of the mounting rod against the outside of the mower handle, using the new bracket and the original bolt and handle knob (Fig. 94). Make sure the curved sides of the bracket fit around the mounting rod.

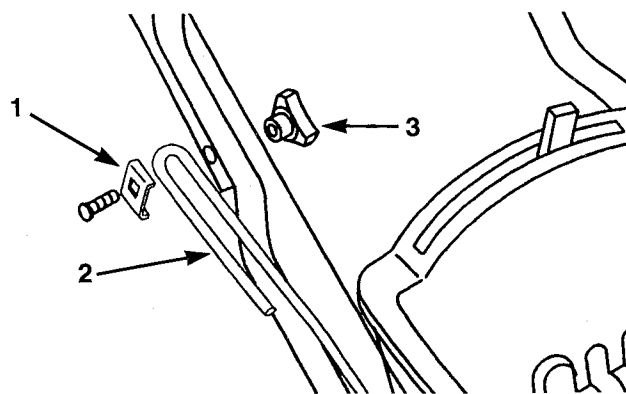

Figure 94

- | | |
|-------------------------|----------------|
| 1. Mounting rod bracket | 3. Handle knob |
| 2. Mounting rod | |

5. Install the chute (Fig. 95). Notice that the chute has a hook at both sides.

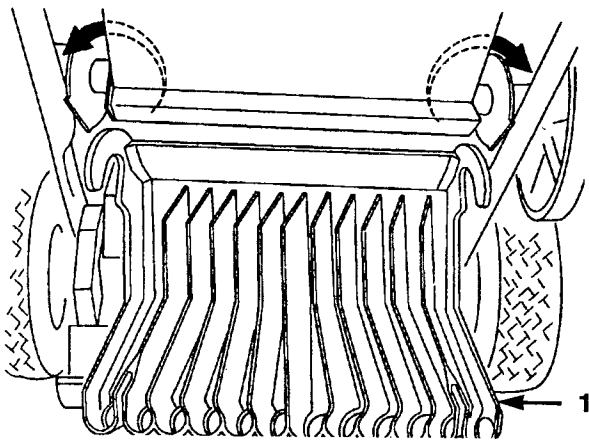

Figure 95

1. Spreader chute

- A. Place the chute under and slightly forward of the hopper. Then hook the chute onto the axle. You must lift the hopper up slightly to install the chute on self-propelled mowers.
 - B. Rotate the chute down until its back edge fits into the notch on the ribs on the lower front side of the hopper. You may need to move the mower control cables out of the way.
6. Loosely install a clamp to each side of the mower handle, using carriage bolts and lock nuts (Fig. 95). Make sure the clamps slide on the handle.

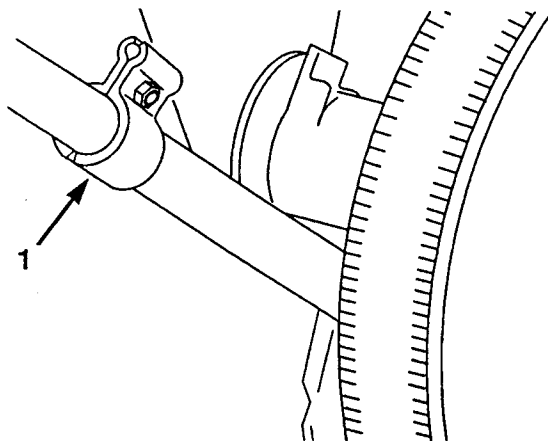

Figure 96

1. Clamp

7. Install the hold-down springs.

- A Identify the left and right hold-down springs (Fig. 97).

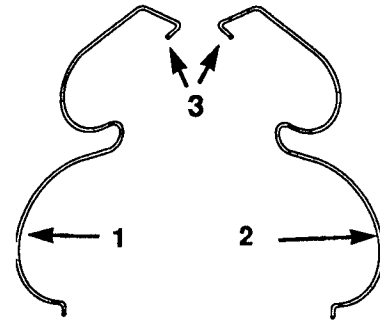

Figure 97

1. Left Hold-down Spring 3. Hooks
2. Right Hold-down Spring

- B. Place the right-hand hold-down spring under the axle support and hook it under the mower handle (Fig. 98).
- C. Rotate the hold-down spring over the axle support and toward the clamp (Fig. 98). Now move the clamp so its back edge lines up with the end of the hold-down spring and secure the clamp in place by tightening the lock nut.

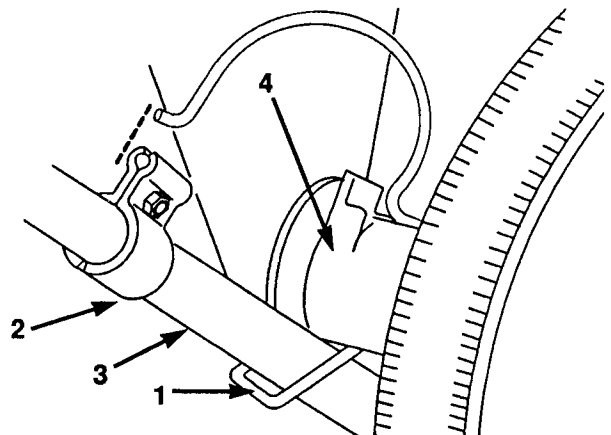

Figure 98

1. Right hold-down spring 3. Mower handle
2. Clamp 4. Axle support

- D. Rotate the spring and insert its end into the hold-down clamp (Fig. 99).

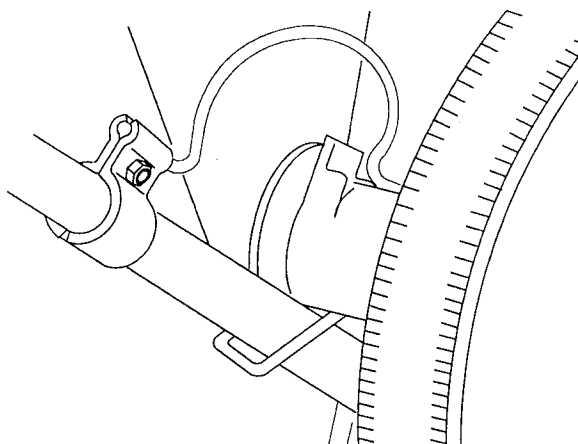

Figure 99

1. Right hold-down spring 2. Clamp

- E.** Install the other spring, using the same procedure.

Note: If you change the handle height or the height-of-cut on your mower, you must reposition both clamps to assure the spreader stays on the mower and operates properly.

- 8.** Adjust the hopper so it is level and tighten the handle knob securely to lock the hopper in place (Fig. 100).

Note: The extra clamp, carriage bolt, and lock nut are not used on your mower.

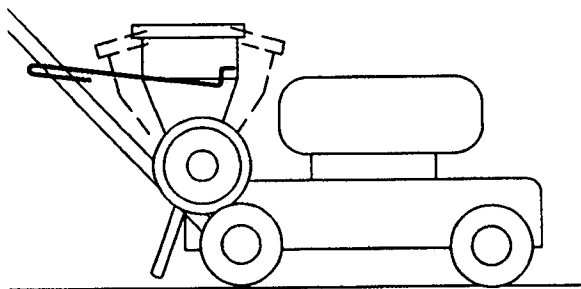

Figure 100

Removing the Spreader

1. Pull the hold-down spring out of the clamp (Fig. 99).
2. Remove the mounting rod and bracket from the handle and the hopper (Fig. 93). Reinstall the handle knob and bolt.
3. Rotate the chute up and slide it forward to disengage the hooks from the axle (Fig. 95).
4. Lift the spreader off your mower.

Note: Leave the clamps installed on the handle for easy spreader installation.

Operating Instructions

Before You Begin

Adjust the mower's handle and height-of-cut settings to the desired position. If these positions have changed since the last time you used the spreader, refer to the installation instructions for your mower for proper adjustments.

CAUTION

Follow the fertilizer manufacturer's instructions for safe use of their product. For best results, use TORO® brand fertilizers.

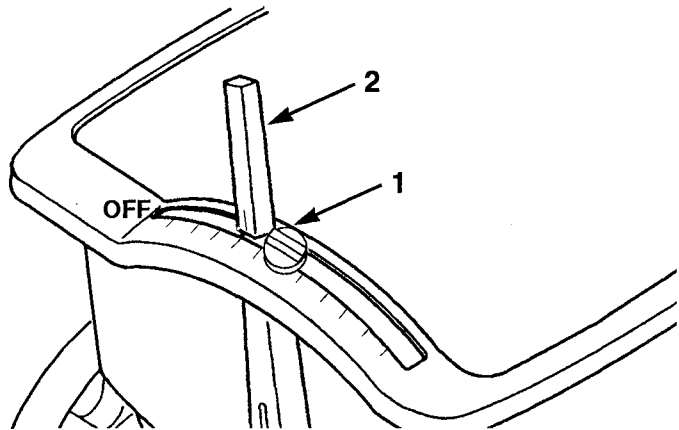

Figure 101

1. Adjustable stop

2. Hopper lever

1. Determine the spreading rate.

Table 1 shows the correct *Mow & Feed™* spreader settings for the fertilizer products shown.

For other fertilizers, pour the number of pounds the manufacturer recommends for 1,000 square feet into the spreader. (A 1,000 square-foot area is equivalent to a 50' by 20' area, for example). Adjust the spreader setting to a higher number if the spreader does not dispense

the recommended amount of fertilizer. Adjust the spreader setting to a lower number if the spreader dispenses the full amount of fertilizer before completing the 1,000 square-foot area. To adjust spreader settings, push down and slide the hopper lever against the adjustable stop and release. Then loosen the adjustable stop knob, and slide the lever until the line on the lever aligns with the desired hopper setting. Then tighten the adjustable stop knob.

Table 1.

Fertilizer Type	Spreader Setting	Approximate Application Rate
TORO Nurture Intensive Care (12-3-9)	#7 ¹ / ₄	7.5 lbs./1,000 square feet
TORO Nurture Intensive Care (9-3-7)	#9	10 lbs./1,000 square feet
TORO Nurture Regular Care (16-4-6)	#7	5 lbs./1,000 square feet
TORO Nurture Premium Care (22-2-3)	#6	3.76 lbs./1,000 square feet
Scotts® (29-3-4)	#5	3lbs./1,000 square feet

2. Fill the spreader.

Before filling, always move the lever on the spreader to the "OFF" position. Fill the hopper on the driveway or sidewalk, never on the lawn. After filling the hopper, move the mower to where you intend to start mowing. Slide and latch the lever to the preset spreader setting position.

3. Start mowing.

Always move the hopper lever to the "OFF" position when crossing the driveway, sidewalk, or lawn areas already fertilized. The Accufeed™ system automatically stops feeding fertilizer when you stop or move the mower backward. **Note:** A small amount of fertilizer controlled by the impeller will continue to flow but

quickly ceases when you initially stop or back up (Fig. 102). This is normal and will not have an adverse effect on your lawn.

The Accufeed™ system applies fertilizer exactly where you mow. Simply align the inside edge of the **rear** mower wheel with the edge of the uncut grass (Fig. 103).

For best results, mow your lawn back and forth in the

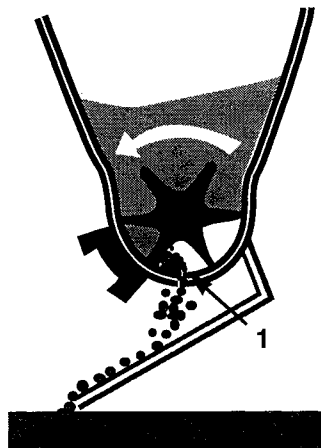

Figure 102

1. Residual fertilizer already partitioned flows when you stop or back up.

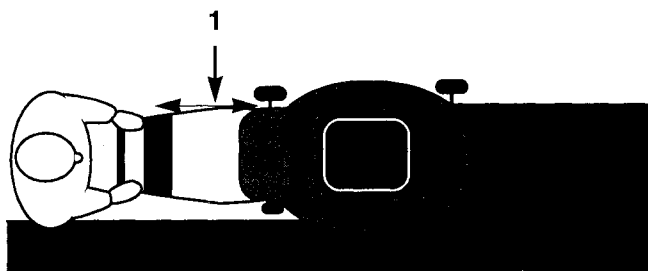

Figure 103

1. Align the inside edge of the rear mower wheel with the edge of uncut grass.

longest direction. To simplify turning, cut two header strips at each end of the lawn. Slide the hopper lever to the "OFF" position as you reach the end of the uncut grass.

Mowing Speed

The *Mow & Feed™* spreader is specially designed to operate with greatest accuracy with the constant speed of self-propelled mowers. The spreader flow-rate settings in Table 1 are based on using the second-gear speed for mowers with 3-speed transmissions. If you are using a hand-push model or are using a speed other than second gear, follow the general instructions given for determining the spreader rate for other fertilizers (see *Determine the spreading rate*, page 33).



CAUTION

For your safety and the safety of others, always follow the safe operating procedures recommended in the operator's manual for your mower.

Maintenance

1. Remove the *Mow & Feed™* spreader from the mower after each use.
2. Never leave unused fertilizer in the spreader. Pour all unused fertilizer into a container by turning the spreader upside down and rotating the impeller by turning the wheels.
3. Thoroughly wash the spreader. Pay particular attention to the impeller and bushings in the bottom of the hopper. Rotate the impeller while washing the hopper to remove all residual fertilizer in the bottom of the hopper.
4. Store the *Mow & Feed™* spreader upright with its lever in the preset open position. Store the chute, mounting rod and springs inside the hopper.
5. Thoroughly wash all fertilizer residue from the mower. After washing, start the engine, engage the blade and operate for 1 to 2 minutes. This clears all water from the engine and blade system.
6. Since fertilizer dust may get into the air cleaner, check the condition of the engine air filter frequently, using the procedures in the operator's manual for your mower.

Lawn Care Guide

Total Lawn Care Guide

	GENERAL CARE	MOWING	FERTILIZING	WATERING
Spring	Clear lawn of debris, leaves, toys before you mow. Remove winter weeds (often a sign of poor drainage or need for aerification) and aerate if necessary. Fill in low spots.	Cut your lawn lower than normal to help remove excess dormant vegetation and let in heat and light. Never remove more than 1/3 of the grass leaf height per mowing.	Late spring, 2 to 4 weeks after your lawn has first "greened" up is the first time to fertilize when your lawn has exhausted its winter nitrates.	Water about 1" every week. Consider a Toro Automatic Irrigation system. It conserves and applies water precisely. Avoid overwatering.
Summer	Avoid leaving wading pools, water slides or other large items on your lawn for more than a day	Cut high to improve root growth, improve water retention and increase heat tolerance. Each time you mow, cut in a different direction for stronger, healthier grass. See the Recommended Cutting Height guide below:	Late Summer is the second most important feeding next to fall. See Feeding Guide below.	Water about 1" - 2" every week, depending on heat and wind. Avoid overwatering. For Clay - 1" every week For Sand - 1/2" 3 times a week.
Fall	Optimum time for reseeding and sodding. Clear lawn of leaves and other debris.	Maintain summer height to protect against winter damage. Remove leaves and other matting materials.	The most important time to feed your lawn. See Feeding Guide below.	Water about 1" a week until the soil freezes to reduce winter damage.

Cutting, Watering, Feeding

CUTTING HEIGHT (INCHES)				
	EARLY SPRING	NORMAL	WATER NEEDS	FEEDING SCHEDULE
Cool Season Grasses				
Bent	0.25	1.0	High	Late Spring, early Summer, late Summer, Fall
Bluegrass				
Common	2.0	3.0	High	Late Spring, late Summer, Fall
Improved	1.5	3.0	High	Late Spring, late Summer, Fall
Buffalo	1.5	2.5	Low	Fall
Fescue				
Chewing/Hard	1.0	3.0	Moderate	Late Spring, late Summer, Fall
Red	1.5	3.0	Moderate	Late Spring, late Summer, Fall
Tall	2.0	3.0	Moderate	Late Spring, late Summer, Fall
Annual Rye	1.5	3.0	High	Late Spring, late Summer, Fall
Perennial Rye	1.5	3.0	High	Late Spring, late Summer, Fall
Warm Season Grasses				
Bahia	2.0	3.0	Moderate	Late Spring, late Summer, Fall
Bermuda				
Common	0.75	1.0	Low	Late Spring, early Summer, late Summer, Fall
Improved	0.50	1.5	Low	Late Spring, early Summer, late Summer, Fall
Centipede	1.0	2.5	Low	Fall
St. Augustine	2.0	3.5	Moderate	Late Spring, late Summer, Fall
Zoysia	1.0	2.5	Low	Late Spring, late Summer, Fall

MULCH WHENEVER POSSIBLE:

Finely Chopped Grass clipping can provide up to 25% of your lawn food need! Mulching is best on the NORMAL recommended high cut height because then mulching not only feeds, your lawn, but it also helps cool it and the longer height helps promote deeper, stronger root growth.

If you can't mulch, compost your clippings and use the finished compost as a top dressing for your lawn or a mulch to reseed your yard. Compost is an outstanding top dressing and the best seed starter you can make.

The Toro Promise

A Full Two-Year Residual Warranty

Toro warrants this product for two years against defects in material or workmanship. To receive a replacement or repair, at our option, just return the complete unit, postage prepaid, to the seller or any authorized TORO Service Dealer or the Toro Service Center, 5300 Shoreline Blvd., Mound, MN 55364, along with proof of purchase. This warranty covers product defects only. **It does not cover incidental or consequential damage, but some states do not allow such a limitation.** This warranty gives you specific legal rights, and you may have other rights which vary from state to state.

