



Finishing Kit

Foam Marker for Multi Pro® 1200 Series Turf Sprayer

Model No. 130-8281

Installation Instructions

Note: The Foam Marker Kit is required for the installation of this product. Contact your Authorized Toro Dealer for more information.

⚠ WARNING

CALIFORNIA Proposition 65 Warning

This product contains a chemical or chemicals known to the State of California to cause cancer, birth defects, or reproductive harm.

Use of this product may cause exposure to chemicals known to the State of California to cause cancer, birth defects, or other reproductive harm.

Installation

Loose Parts

Use the chart below to verify that all parts have been shipped.

Procedure	Description	Qty.	Use
1	Foam marker adapter harness	1	Install the foam marker adapter harness—2009 and before models.
	Cable tie	4	
2	Foam marker (sold separately)	1	Attach the foam marker (sold separately).
	Hex-head screw (1/4 x 0.62 inch)	4	
	Locknut (1/4 inch)	4	
3	Foam-marker bracket	1	Install the finishing-kit bracket.
	Carriage screw (3/8 x 1 inch)	5	
	Flange nut (3/8 inch)	5	
4	Switch	2	Install the switches and the fuse.
	Fuse (15 amp)	1	



1

Installing the Foam Marker Adapter Harness—2009 and Before Models

Parts needed for this procedure:

1	Foam marker adapter harness
4	Cable tie

Verifying the Machine Wiring Harness

1. Look for the wiring harness of the machine at the right side, approximately mid way along the tank, between the tank and the chassis.
2. Look for a branch of the machine wiring harness with a 4-socket electrical connector labeled **Foam Marker** (Figure 1).

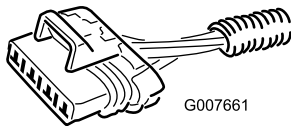

Figure 1

-
- If the branch of the machine wiring harness with the 4-socket connector is not present, proceed to [Routing and Connecting the Foam Marker Adapter Harness \(page 3\)](#)

Note: If the plug **is not** part of the machine wiring harness, the machine requires installation of the foam marker adapter harness.

- If the connector labeled Foam Marker is present, skip to [3 Installing the Finishing-Kit Bracket \(page 4\)](#).

Note: If the plug **is** part of the machine wiring harness, the machine does not require the foam marker adapter harness.

Routing and Connecting the Foam Marker Adapter Harness

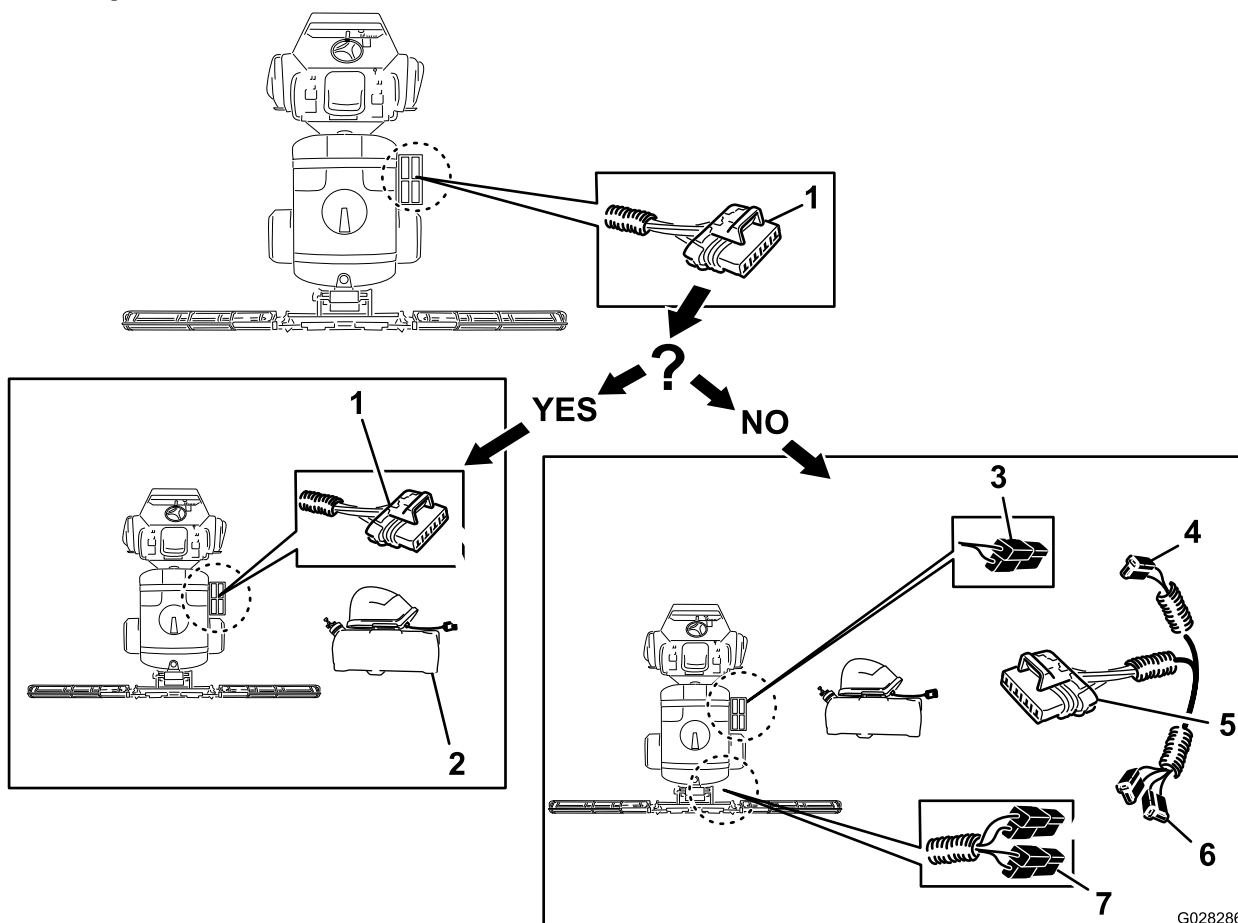

Figure 2

1. Foam-marker connector (if present on the machine harness)
2. Foam-marker tank assembly
3. 2-pin connector—black power plug (main wiring harness—2009 and before models)—labeled **Foam Marker**
4. 2-socket connector—power plug (foam marker adapter harness)
5. 4-socket electrical connector (foam marker adapter harness)
6. 2-socket connector—labeled **Left** and **Right** (foam marker adapter harness)
7. 2-pin connectors—labeled **Left** and **Right** solenoid (main wiring harness—2009 and before models)

1. Locate the foam marker wiring harness in loose parts.
2. Locate the main wiring harness on the vehicle. Follow the harness from the rear of the machine to locate the black power plug labeled **Foam Marker**.
3. Plug the 2-pin connector on the main wiring harness labeled **Foam Marker** into the single 2-socket connector (black-square power plug) from the foam marker adapter harness.

Note: This will provide power to the pump for the foam-marker tank.

4. Route the 2 solenoid plugs labeled **Left** and **Right** on the foam marker adapter harness rearward along the existing wiring.

Note: Secure the harness to the main wiring every 3 to 4 feet with plastic ties.

5. At the rear of the machine, locate the foam-marker connectors labeled **left solenoid** and **right solenoid** on the machine wiring harness.
6. Connect the 2-pin connector machine wiring harness labeled **Left** solenoid into the 2-socket connector labeled **Left** of the foam marker adapter harness.
7. Connect the 2-pin connector machine wiring harness labeled **Right** solenoid into the 2-socket connector labeled **Right** of the foam marker adapter harness.

Note: These connections link the foam marker to the existing wiring in the control panel to allow the switches to control the foam marker.

8. Ensure that the 4-socket connector for the foam marker adapter harness is located near the area where the mounting bracket for the foam-marker assembly is

located so that you can connect the harness once the foam-marker assembly is installed.

- Tie back any loose wiring along the harness to avoid snagging it during operation.

2

Attaching the Foam Marker (Sold separately)

Parts needed for this procedure:

1	Foam marker (sold separately)
4	Hex-head screw (1/4 x 0.62 inch)
4	Locknut (1/4 inch)

Procedure

- Secure the foam marker to the bracket using the 4 hex-head bolts (1/4 x 0.62 inch) and 4 locknuts (1/4 inch) as shown in [Figure 3](#).

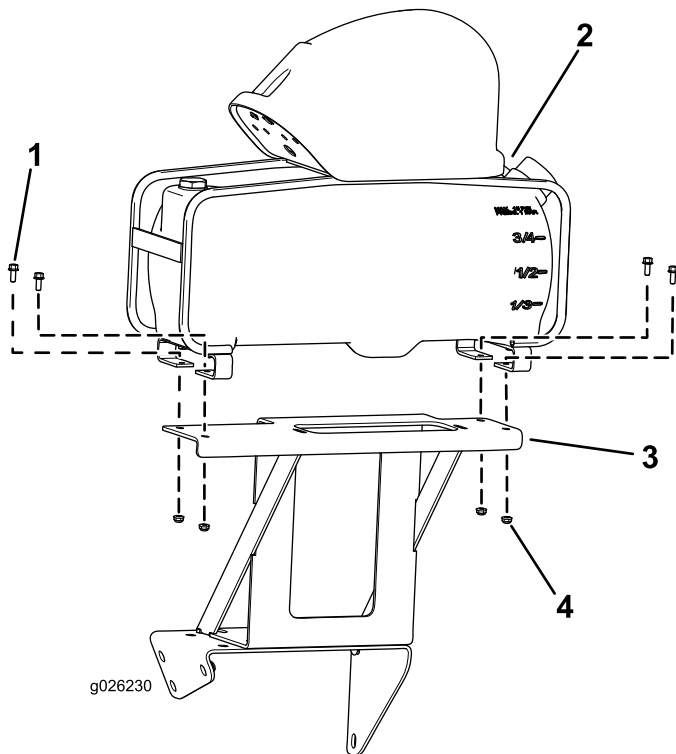

Figure 3

- | | |
|-----------------------------------|------------------------|
| 1. Hex-head bolt (1/4 x 5/8 inch) | 3. Foam-marker bracket |
| 2. Foam marker | 4. Locknut (1/4 inch) |

- Torque the bolts and locknuts to 1017 to 1243 N-cm (90 to 110 in-lb).

3

Installing the Finishing-Kit Bracket

Parts needed for this procedure:

1	Foam-marker bracket
5	Carriage screw (3/8 x 1 inch)
5	Flange nut (3/8 inch)

Procedure

- Assemble the foam-marker bracket to the battery bracket with the 5 carriage bolts (3/8 x 1 inch) and 5 flange nuts (3/8 inch) as shown in [Figure 4](#).
- Torque the carriage bolts and flanged nuts to 37 to 45 N-m (27 to 33 ft-lb).

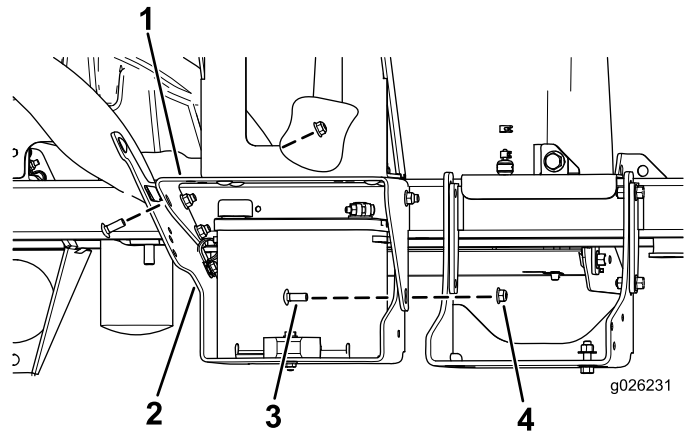

Figure 4

- | | |
|------------------------|---------------------------------|
| 1. Foam-marker bracket | 3. Carriage bolt (3/8 x 1 inch) |
| 2. Battery bracket | 4. Flange nut (3/8 inch) |

4

Installing the Switches and the Fuse

Parts needed for this procedure:

2	Switch
1	Fuse (15 amp)

Procedure

1. Remove the 2 plugs from the control panel (Figure 5).

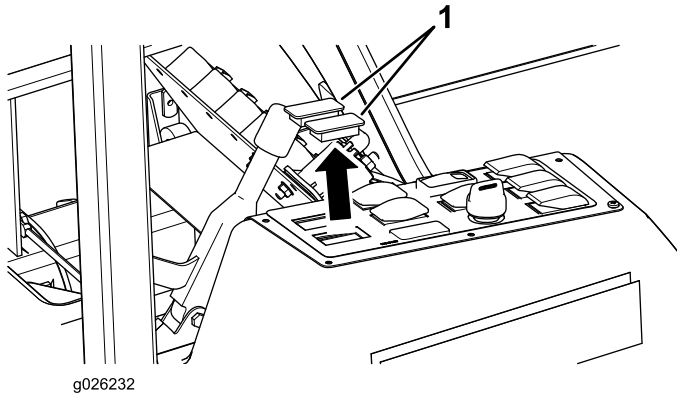

Figure 5

1. Plugs

2. Connect the switches to the electrical connectors in the control panel and then insert the switches into the panel (Figure 6).

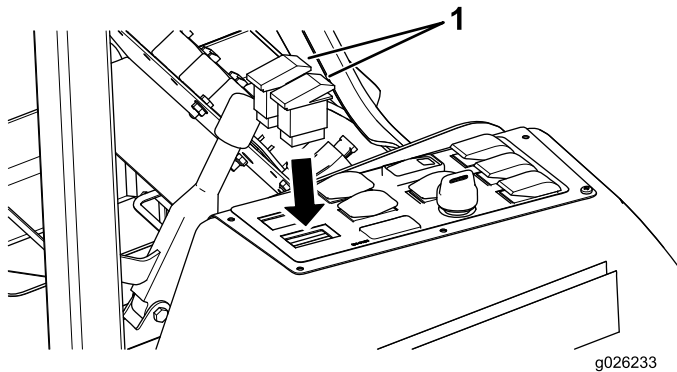

Figure 6

1. Switches

3. Insert the 15-amp fuse into the top socket of the fuse block (Figure 7).

Note: Ensure that the fuse is fully seated in the socket.

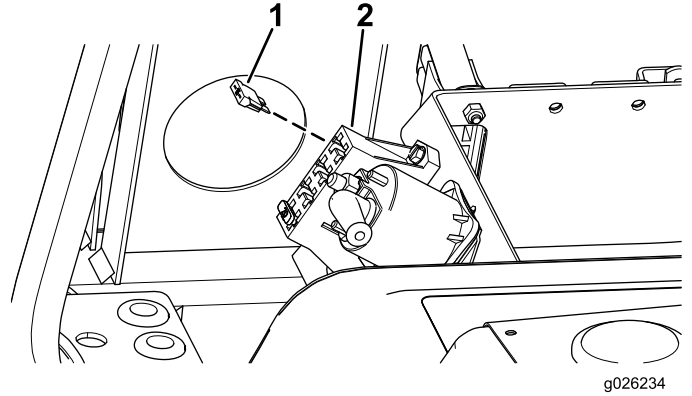

Figure 7

1. 15-amp fuse
2. Fuse block

Operation

Using the Controls

Right foam on/off switch—Use the right foam on/off switch to activate the compressor, generating a flow of foam to the right boom.

Left foam on/off switch—Use the left foam on/off switch to activate the compressor, generating a flow of foam to the left boom.

Indicator markings—Use the indicator markings located on the side of the foam-marker tank to identify the level of foam solution in the tank.

Foam regulator adjustment valve—Use the foam regulator adjustment valve to adjust consistency of the foam solution. Adjusting the valve controls the amount of soap solution delivered to the foam nozzles. Increasing the flow results in larger, more frequent foam drops; decreasing the flow results in smaller, less frequent foam drops (Figure 8).

Note: A watery marker consistency may be helpful on windy days.

Pressure relief valve—Pull the red tab on the tank cap outward to relieve pressure in the tank (Figure 8).

Filling the Tank and Adjusting the Foam Density

Important: Flush the system with clean water after each use, especially after using hard water. Do not apply lubricating oils, grease, or other petroleum products to the compressor motor assembly.

1. Ensure that both the left and right boom switches (located on the console) are in the Off position.
2. Pull out on the red tab of the pressure-relief valve at the tank cap, and then remove the cap from the tank.
3. Through the filler neck of the tank, pour in the proper amount of water into the tank and foam concentrate according to the manufacturer's instructions.

Important: Extreme pH levels (hardness or softness) of the water will affect the amount of foam concentrate needed.

4. Install the cap on the tank and tighten it hand tight.
5. For the initial foam density, open the foam regulator adjustment valve 1/8 to 1/4 turn (Figure 8).

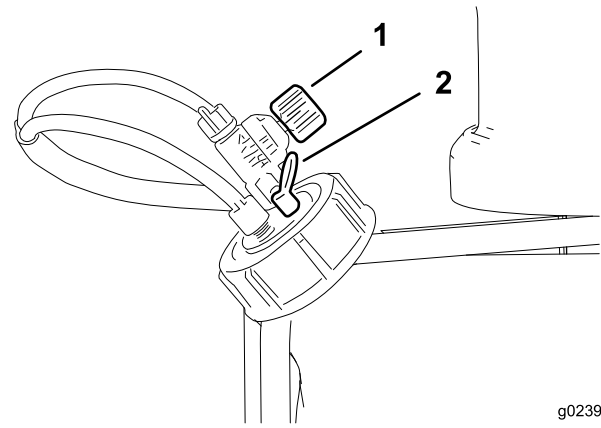

g023901

Figure 8

1. Foam regulator adjustment valve
2. Pressure-relief valve

6. Operate the marking system and make a test pattern on the ground.
Note: When you first start the marking system, allow 1 to 2 minutes for the foam to flow through the line.
7. Adjust the foam density adjustment valve to obtain the desired consistency and spray as normal.

Note: If you leave the foam in the line for more than 2 hours, it may become watery. Before operating the foam marker—after stopping the machine for 2 or more hours, run the machine for 1 to 2 minutes to remove the excess water.

If the foam in the machine is very watery, do the following:

- A. Close the foam density adjustment valve completely.
- B. Operate the pump for the foam marker for 2 minutes.
- C. Wait 1 minute and then make a test pattern on the ground to check the consistency of the foam.
- D. Adjust the foam density adjustment valve to achieve the desired foam consistency.

Notes:



Count on it.