



Cab Kit

Workman® HDX and HDX-Auto Utility Vehicle

Model No. 07392—Serial No. 315000001 and Up

Installation Instructions

Safety

⚠ WARNING

CALIFORNIA

Proposition 65 Warning

This product contains a chemical or chemicals known to the State of California to cause cancer, birth defects, or reproductive harm.

Safety and Instructional Decals



Safety decals and instructions are easily visible to the operator and are located near any area of potential danger. Replace any decal that is damaged or lost.

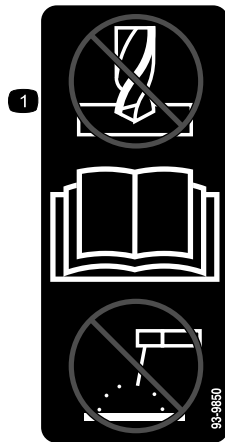

93-9850

1. Do not repair or revise—read the *Operator's Manual*.



117-4955

1. Warning—read the *Operator's Manual*; wear the seat belt when seated in the operator's position; avoid tipping the machine.
2. Warning—wear hearing protection.

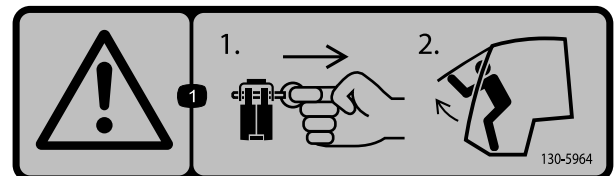

130-5964

1. Warning—in the event of an emergency 1) Pull the locking pin out of each hinge; 2) Push the front window out to exit.



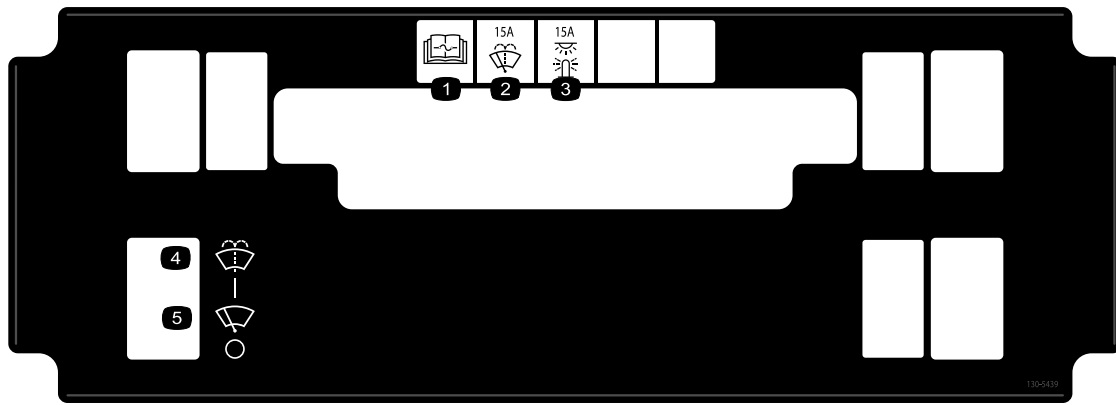

130-5439

1. Read the *Operator's Manual* for information on fuses.
2. Windshield wiper—15A
3. Lights—15A
4. Windshield spray
5. Windshield wiper

Installation

Loose Parts

Use the chart below to verify that all parts have been shipped.

Procedure	Description	Qty.	Use
1	No parts required	—	Prepare to install the kit.
2	No parts required	—	Remove the center console panel and seats.
3	No parts required	—	Remove the CVT cooling duct (HDX-Auto only), coolant tank, ROPS assembly, and seat shroud.
4	No parts required	—	Jack up the machine and remove the front wheels.
5	Compression spring (white)	2	Install the compression spring rod.
6	Rear cab mount bracket Internal front cab mount bracket External front cab mount bracket Rubber isolator mounts Bolts (3/8 inch) Nut (3/8 inch) Bolts (1/2 inch) Washer Nuts (1/2 inch)	2 2 2 4 4 4 2 2 2	Install the cab mounts.
7	No parts required	—	Install the seat shroud.
8	Side-plate panels	2	Install the side panels.

Procedure	Description	Qty.	Use
9	Cab frame	1	Install the cab frame.
	Bolts (1/2 inch)	4	
	Washers (1/2 inch)	4	
	Nuts (1/2 inch)	4	
10	Wiring harness	1	Route the wiring harness.
	Cable ties	4	
	Fuse, 30 amp	1	
11	Floor-plate panel	2	Install the floor and side plates.
	Side-plate panel	2	
	Bolts (1/4 inch)	12	
12	Bolts (1/4 inch)	2	Install the center console panel, seats, coolant tank, and operator's manual tube.
	Spacers	2	
	Strap	1	
	Nuts (1/4 inch)	2	
	CVT intake hood assembly (Sold separately)	1	
13	No parts required	–	Connect the battery, lower the bed, and install the hood.

Media and Additional Parts

Description	Qty.	Use
Compression spring tool	1	Installing the compression spring.
CVT intake hood assembly (Workman HDX-Auto only)	1	Installing the CVT intake hood assembly.

1

Preparing to Install the Kit

No Parts Required

Procedure

1. Move the machine to a level surface and set the parking brake.
2. Raise or remove the bed from the vehicle, if so equipped.

Note: Refer to the vehicle *Operator's Manual* for more detailed information on raising and removing the bed.

3. Shut off the engine, set the parking brake, and remove the key.
4. Disconnect the battery; refer to the *Operator's Manual* for the machine.
5. While grasping the hood in the headlight openings, lift up on the hood to release the lower mounting tabs from the slots in the bumper ([Figure 1](#)).

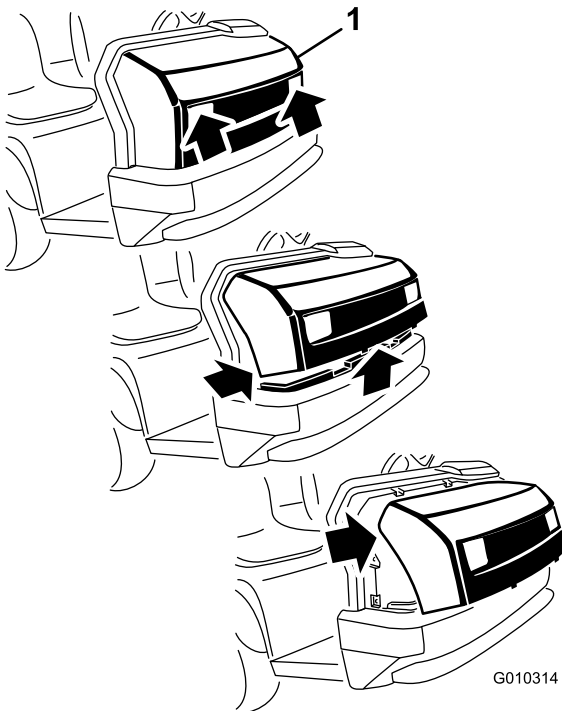

Figure 1

1. Hood

6. Pivot the bottom of the hood upward until the top mounting tabs can be pulled from the frame slots ([Figure 1](#)).
7. Pivot the top of hood forward and unplug the wire connectors from the head lights ([Figure 1](#)).

8. Remove the hood.

2

Removing the Center Console Panel and Seats

No Parts Required

Removing the Center Console Panel from the Workman HDX Machines

1. Unscrew and remove all knobs from console levers and from the gear shift lever ([Figure 2](#)).

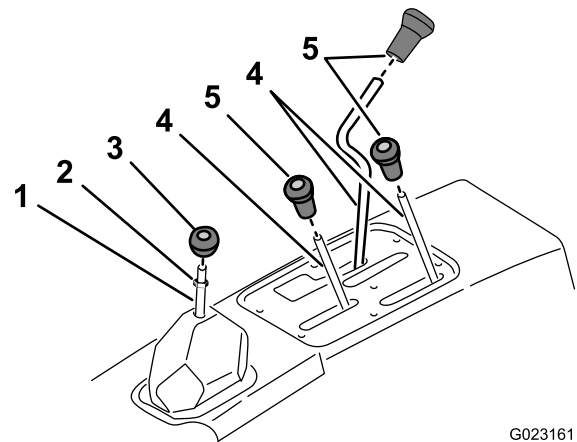

G023161

Figure 2

- | | |
|-------------------|-----------------|
| 1. Shifter rod | 4. Control rod |
| 2. Jam nut | 5. Control knob |
| 3. Shifter handle | |

2. Remove the jam nut from the gear shift lever ([Figure 2](#)).
3. Remove the 6 screws securing the outside edge of the cover plate of the center console to the chassis and remove the cover plate ([Figure 3](#)).

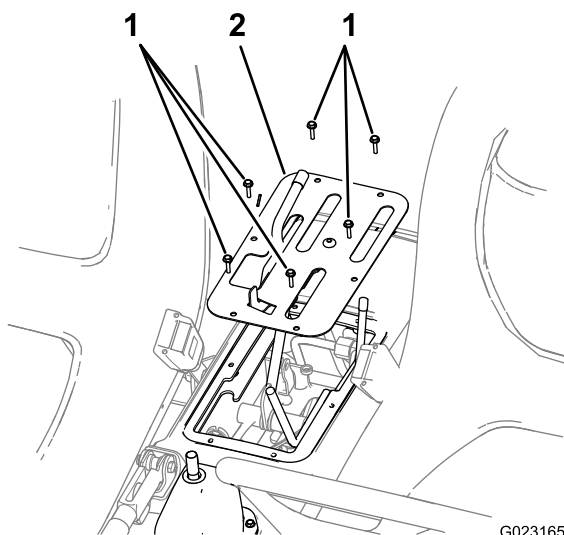

Figure 3

1. Screw
2. Cover plate

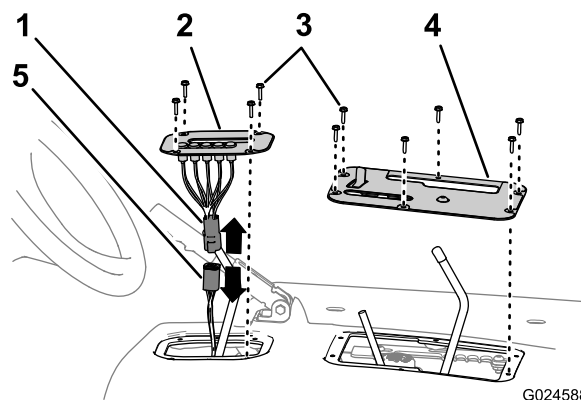

Figure 5

1. Indicator connector
2. Shift-indicator cover
3. Hex-head screws
4. Control cover
5. Machine-harness connector

Removing the Center Console Panel from the Workman HDX-Auto Machines

1. Remove all knobs from console levers and from the transmission lever by rotating the knobs counterclockwise (Figure 4).

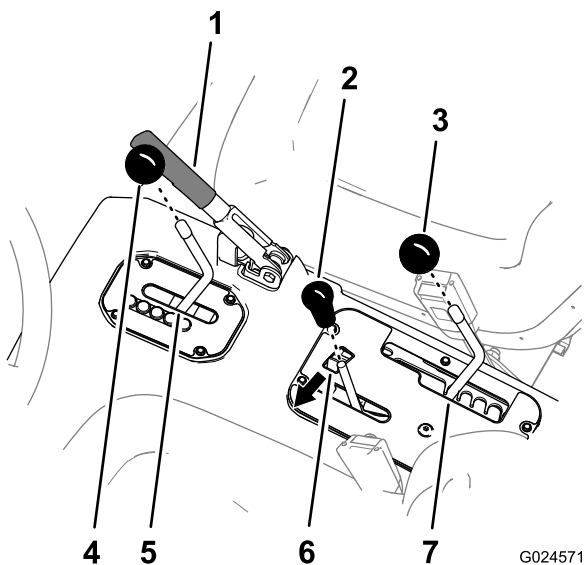

Figure 4

1. Brake lever
2. Hydraulic-lift lever knob
3. Speed-range lever knob
4. Transmission lever knob
5. Transmission lever (L position) knob
6. Hydraulic-lift lock (locked position — left)
7. Speed-range lever (A position)

2. Remove the 4 hex-head screws that secure the shift-indicator cover to the seat shroud (Figure 5).

Removing the Seats from the Machines

Remove the 8 socket-head bolts that secure the seat rails of the seat to the chassis and remove the seats (Figure 6).

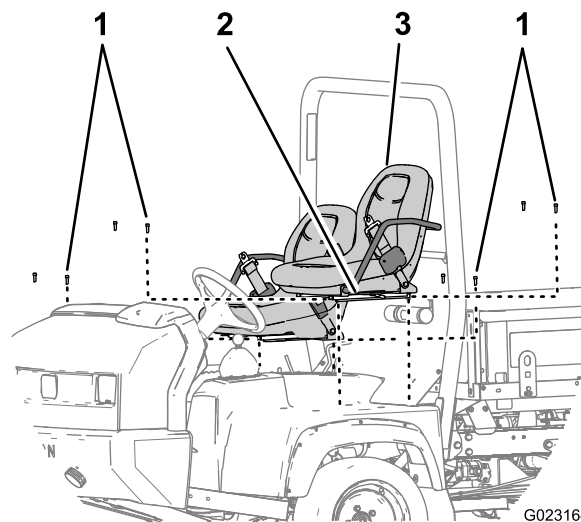

Figure 6

1. Socket-head bolts
2. Seat rail
3. Seat

3

Removing the CVT Cooling Duct (HDX-Auto only), Coolant Tank, ROPS Assembly, and Seat Shroud

No Parts Required

Removing the CVT Cooling Duct (HDX-Auto only)

Remove the hose clamp that secures the CVT cooling duct to the flange of the CVT intake at the back of the ROPS panel on the passenger side (Figure 7).

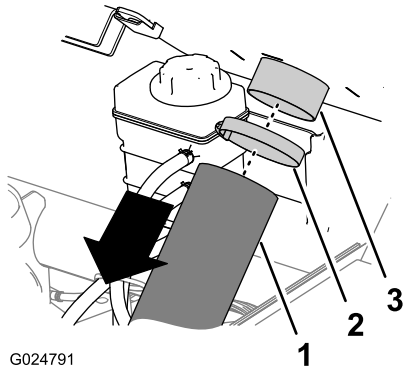

Figure 7

1. CVT intake hose
2. Hose clamp
3. Intake-tube connector

Removing the Coolant Tank

1. Lift the coolant tank up and out of the support pocket on the back of the seat shroud (Figure 8).

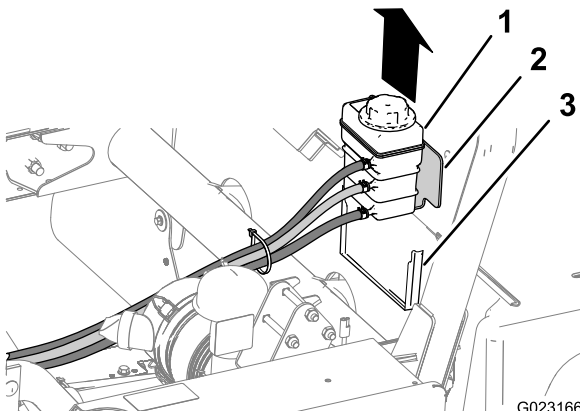

Figure 8

1. Coolant tank
2. Coolant-tank bracket
3. Seat shroud

2. Set the coolant tank upright onto the engine/chassis.

Removing the ROPS Assembly

Remove the 6 bolts that secure the ROPS assembly to the frame of the machine as shown in Figure 9 and Figure 10.

Note: Do not discard the bolts.

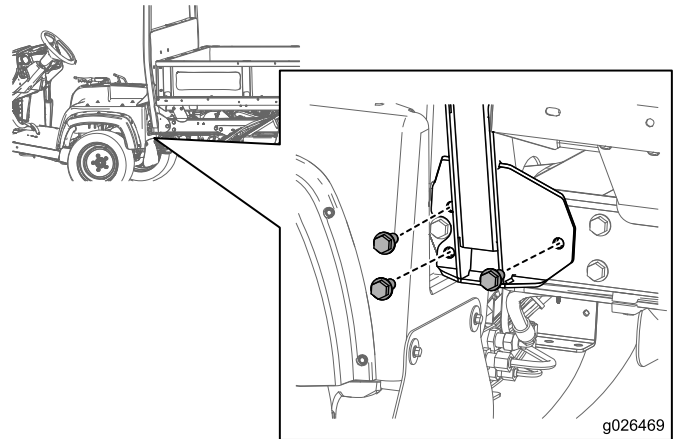

Figure 9

Remove the *Operator's Manual* tube and R-clamps from the ROPS assembly and set it aside.

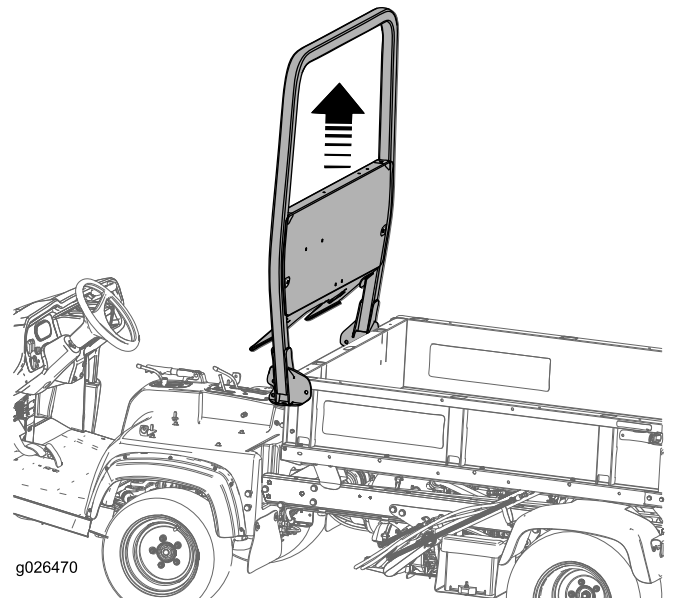

Figure 10

Removing the Seat Shroud

For the Workman HDX machine:

1. Ensure that the parking brake is set (Figure 11).

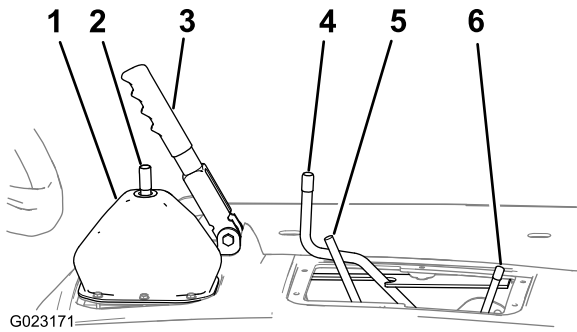

Figure 11

- | | |
|-----------------------|--------------------------------|
| 1. Gear selector boot | 4. Rod, differential lock |
| 2. Rod, gear selector | 5. Rod, hydraulic bed lift |
| 3. Parking brake | 6. Rod, high-low range shifter |

2. Move the rod for the differential lock forward and to the right to lock it in the engaged position (Figure 11).

For the Workman HDX-Auto machine:

1. Unplug the shift-indicator connector from the vehicle harness (Figure 12).

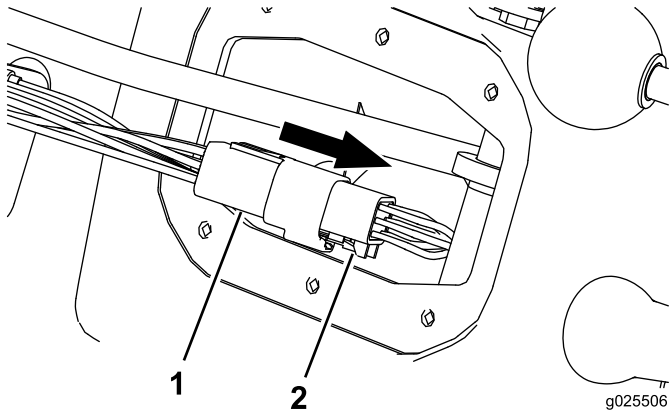

Figure 12

- | | |
|------------------------------|--------------------|
| 1. Shift-indicator connector | 2. Vehicle harness |
|------------------------------|--------------------|

2. Lift and rotate the center control assembly out of the way to gain access to the suspension springs.

Both machines:

Lift the seat shroud up and remove it from the machine (Figure 13).

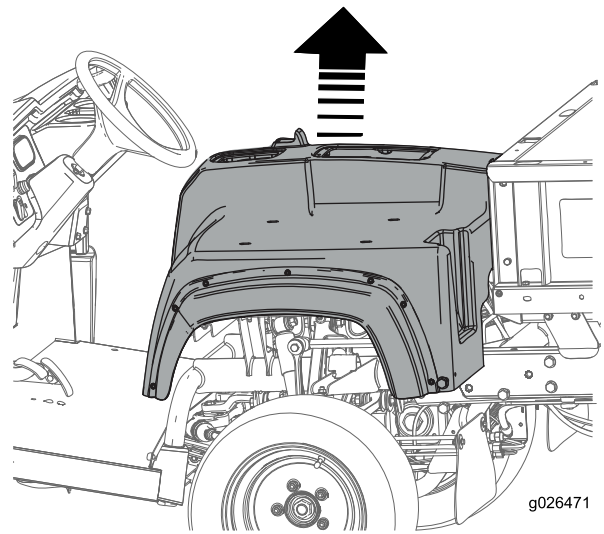

Figure 13

For the Workman HDX-Auto machine:

Remove the bolts securing the lift valve to the controls bracket and the nuts and bolts holding the control bracket to the machine (Figure 14).

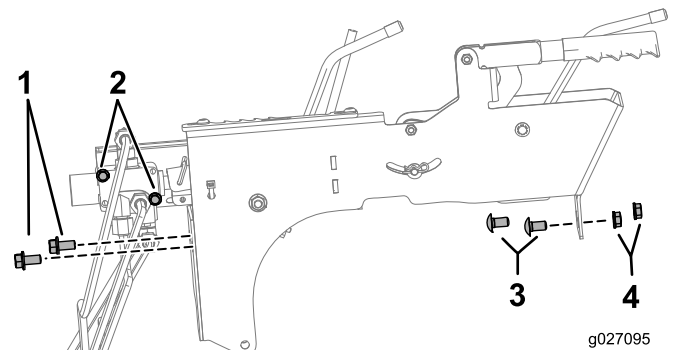

Figure 14

- | | |
|---|--|
| 1. Bolts holding the control bracket to the machine. | 3. Bolts holding the control bracket to the machine. |
| 2. Bolts securing the lift valve to the controls bracket. | 4. Nuts |

4

Jacking Up the Machine and Removing the Front Wheels

No Parts Required

Jacking Up the Machine

⚠ DANGER

A vehicle on a jack may be unstable and slip off of the jack, injuring anyone beneath it.

- Do not start the vehicle while the vehicle is on a jack.
- Always remove the key from the switch before getting off of the vehicle.
- Block the tires when the vehicle is on a jack.
- Do not start the engine while the vehicle is on a jack, because the engine vibration or wheel movement could cause the vehicle to slip off of the jack.
- Do not work under the vehicle without jack stands supporting it. The vehicle could slip off a jack, injuring any one beneath it.
- When jacking up the front of the vehicle, always place a 2 x 4 block (or similar material) between the jack and the vehicle frame.
- The jacking point at the front of the vehicle is under the front center frame support (Figure 15).

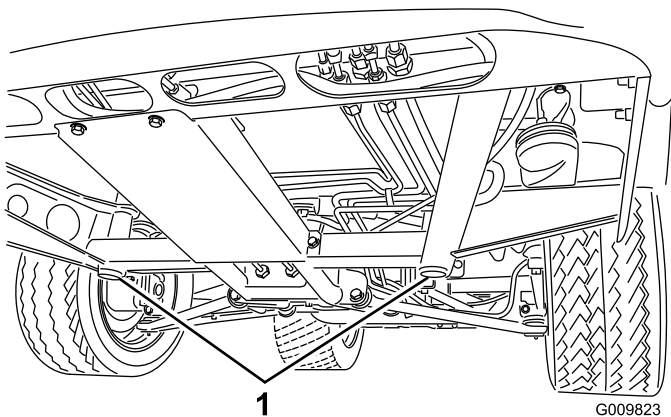

Figure 15

1. Front jacking points

Removing the Front Wheels

1. Remove the 5 lug nuts that secure the front wheel to the wheel hub (Figure 16).

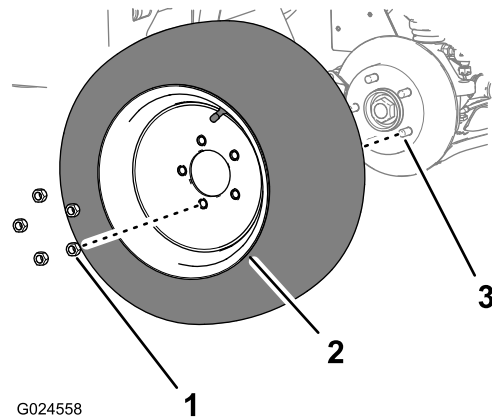

Figure 16

1. Lug nuts
2. Front wheel
3. Wheel hub

2. Remove the wheel from the wheel hub (Figure 16).
3. Repeat steps 1 and 2 for the front wheel on the other side of the machine.

5

Installing the Compression Spring

Parts needed for this procedure:

- | | |
|---|----------------------------|
| 2 | Compression spring (white) |
|---|----------------------------|

Procedure

1. Using a compression spring tool as specified in Figure 17, install the compression spring rod through the holes in each spring cradle (Figure 18).

Important: Use caution when removing the spring cradle; the spring is under compression.

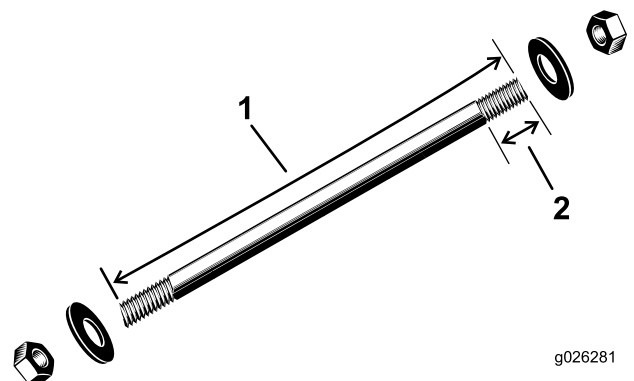

Figure 17

1. 51 cm (20 inches)
2. 13 cm (5 inches)

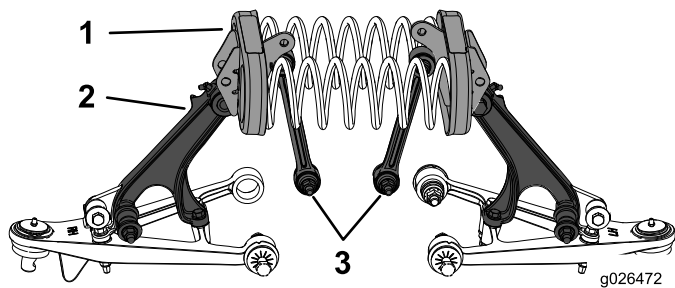

Figure 18

1. Spring cradle
2. Control arm
3. Stabilizer link

2. Measure and note the length of the springs.
3. Install the nuts and washers on both ends of the rod (Figure 19).

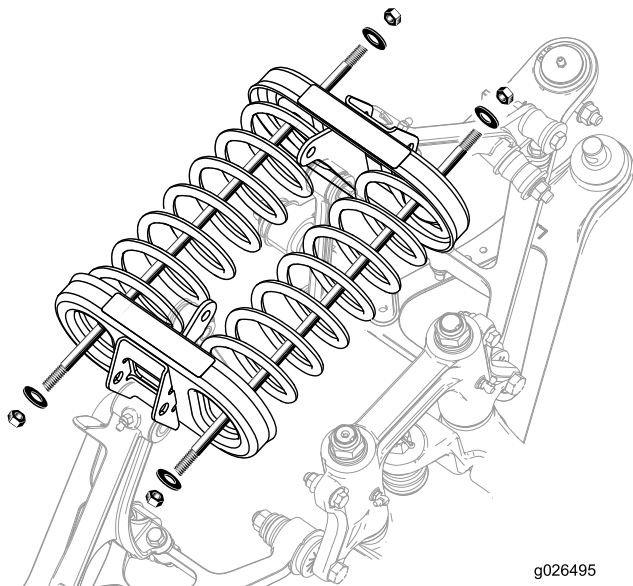

Figure 19

4. Tighten 1 nut on each rod to secure the springs.
5. Remove the bolts and nuts from the end of each stabilizer link as shown in Figure 20; Box A.

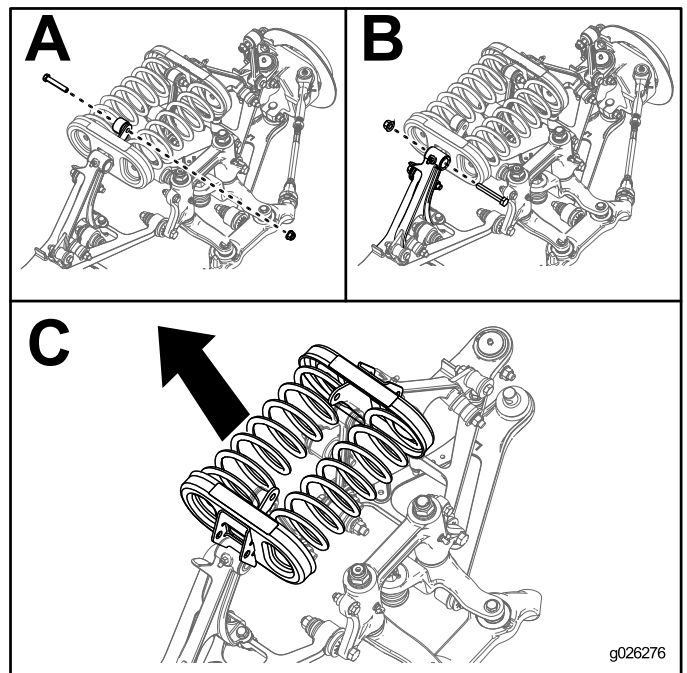

Figure 20

6. Remove the bolts and nuts from the control arm that is securing each spring cradle as shown in Figure 20; Box B.
 7. Remove the spring cradles and springs from the machine as shown in Figure 20; Box C.
- Note:** Note the position of the decals on the spring cradles. The cradles need to be put back in the same location.
8. Remove the current springs from the spring cradles and place the springs from this kit (white springs) in the spring cradles.
 9. Use the compression spring tool rod to compress the springs to the number measured in step 2.
 10. Place the springs and the cradle back in the machine.
 11. Install the bolts and nuts previously removed from the stabilizer links and control arm.
 12. Install the front wheels and lower the machine.
 13. Torque the wheel nuts to 109 to 122 N-m (80 to 90 ft-lb).

6

Installing the Cab Mount Brackets

Parts needed for this procedure:

2	Rear cab mount bracket
2	Internal front cab mount bracket
2	External front cab mount bracket
4	Rubber isolator mounts
4	Bolts (3/8 inch)
4	Nut (3/8 inch)
2	Bolts (1/2 inch)
2	Washer
2	Nuts (1/2 inch)

Procedure

1. Install the rear brackets on the machine as shown in [Figure 21](#), using the hardware removed from the ROPS in [Removing the ROPS Assembly](#) (page 6).

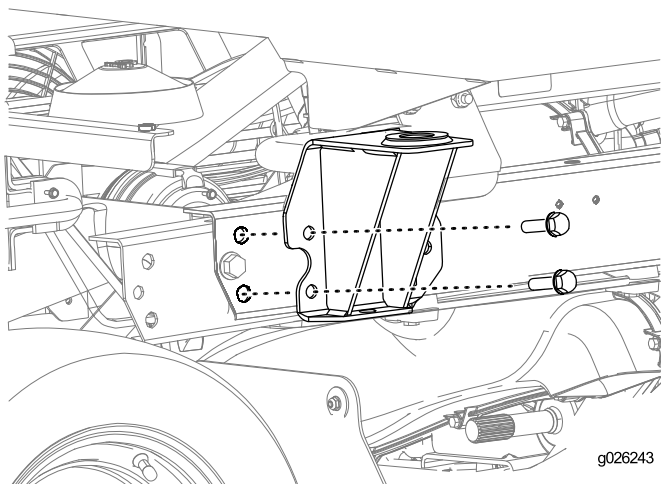

Figure 21

2. Torque to 94 to 108 N-m (70 to 80 ft-lb).
3. Install the front internal and external brackets on each side of the machine as shown in [Figure 22](#) using 2 bolts (3/8 inch), 2 nuts (3/8 inch), 1 bolt (1/2 inch), 1 washer, and 1 nut (1/2 inch).

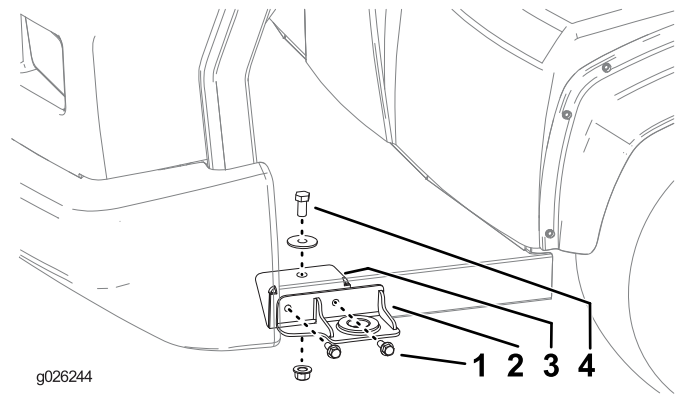

Figure 22

1. Bolts (3/8 inch)
2. External bracket
3. Internal Bracket
4. Bolt (1/2 inch)

4. Torque the 2 bolts (3/8 inch) to 37 to 45 N-m (27 to 33 ft-lb), and the 1 bolt (1/2 inch) to 91 to 113 N-m (67 to 83 ft-lb)
5. Install the 4 rubber isolator mounts as shown in [Figure 23](#).

Note: Use soapy water to assist with installing the bracket support mounts.

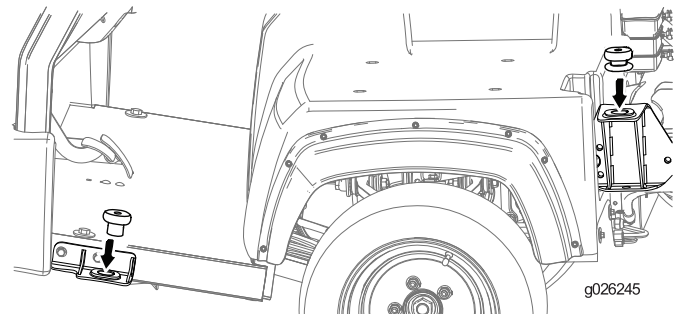

Figure 23

7

Installing the Seat Shroud

No Parts Required

Installing the Seat Shroud

Both machines:

1. Align the opening in the seat shroud for the parking brake with the parking brake handle.
2. Align the hole in the gear selector boot with the rod for the gear selector.
3. Align the opening in the seat shroud for the rods for the lift bed control, high-low range shifter, and the differential lock.

4. Lower the seat shroud down.
5. Align the holes in the shroud for the seat mounting with the seat support brackets of the chassis.

Note: Do not tighten the bolts.

For the Workman HDX-Auto machine:

Plug in the shift indicator and secure the controls bracket with the screws (Figure 14 and Figure 12) removed in the procedure [Removing the Seat Shroud](#) (page 7).

8

Installing the Side Panels

Parts needed for this procedure:

2	Side-plate panels
---	-------------------

Installing the Side-Plate Panels

1. Loosen the bolts, approximately 1 turn, on the fenders to allow room for the side-plate panels to slide into place.
2. Slide the side-plate panels between the seat shroud and side fenders as shown in [Figure 24](#).

Note: Ensure that the panels are seated fully before tightening the bolts.

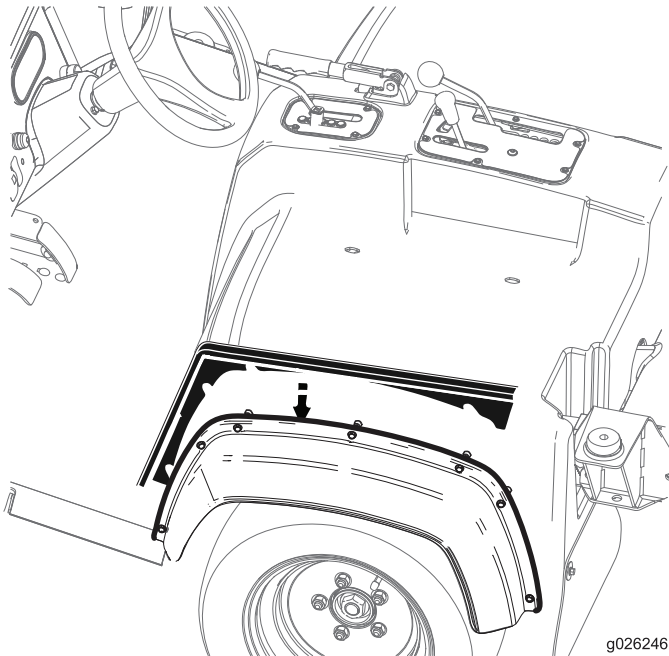

Figure 24

Note: Do not over tighten the bolts.

9

Installing the Cab Frame

Parts needed for this procedure:

1	Cab frame
4	Bolts (1/2 inch)
4	Washers (1/2 inch)
4	Nuts (1/2 inch)

Procedure

Hold the cab frame using the lifting points and place it on the machine ([Figure 25](#)).

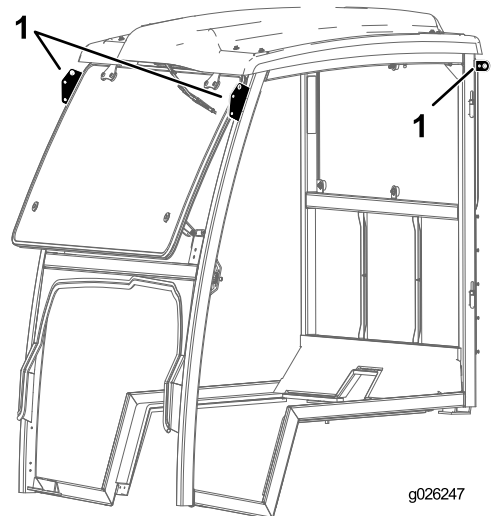

Figure 25

1. Lifting points

Secure the frame to the machine using 4 (1/2 inch) bolts, 4 (1/2 inch) washers, and 4 (1/2 inch) nuts as shown in [Figure 26](#).

3. Tighten the bolts on the fenders.

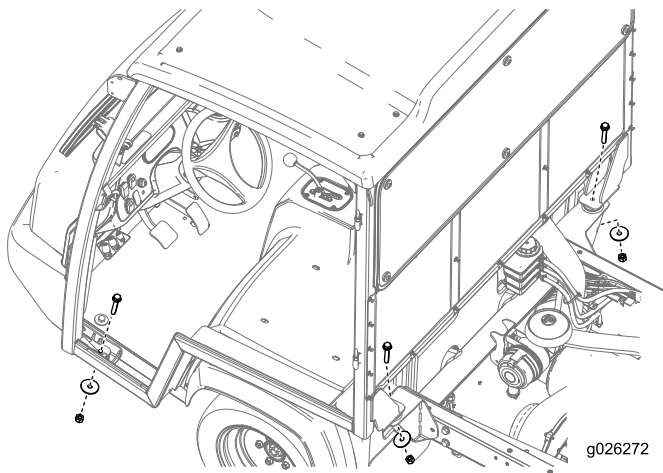

Figure 26

Torque the bolts to 91 to 113 N-m (67 to 83 ft-lb).

10

Routing the Wiring Harness

Parts needed for this procedure:

1	Wiring harness
4	Cable ties
1	Fuse, 30 amp

Procedure

Route the wiring harness as shown in [Figure 27](#) and secure it with the 4 cable ties.

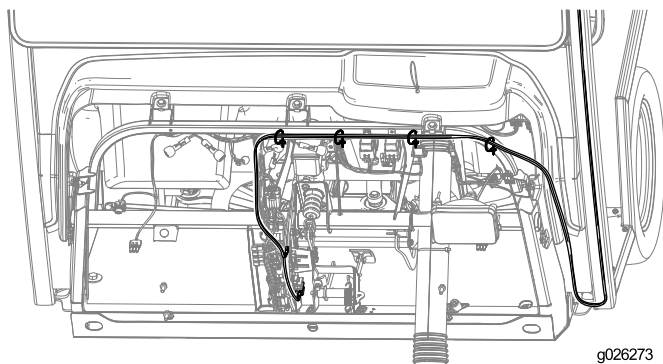

Figure 27

Connect the ring terminal on the harness to the grounding block and insert the fuse block connector into an available fuse block connection ([Figure 28](#)). If there is not an available fuse block connection, a fuse block will need to be added to the fuse block grouping. Contact your Authorized Service Dealer for more information.

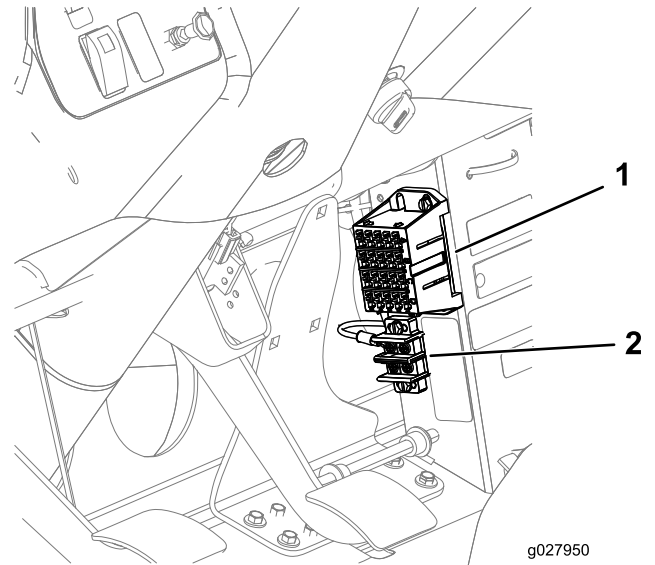

Figure 28

1. Fuse block

2. Ground block

11

Installing the Floor and Side Plate Panels

Parts needed for this procedure:

2	Floor-plate panel
2	Side-plate panel
12	Bolts (1/4 inch)

Procedure

Install the floor-plate panels on each side of the machine using 3 bolts (1/4 inch) as shown in [Figure 29](#).

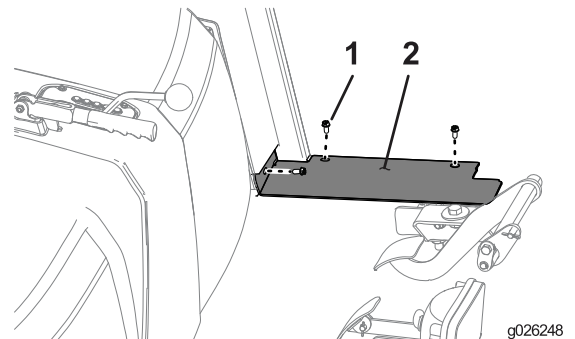

Figure 29

1. Bolt

2. Floor-plate panel

Torque the bolts to 1017 to 1243 N-cm (90 to 110 in-lb).

Install the side-plate panels on each side of the machine using 2 bolts (1/4 inch) as shown in [Figure 30](#).

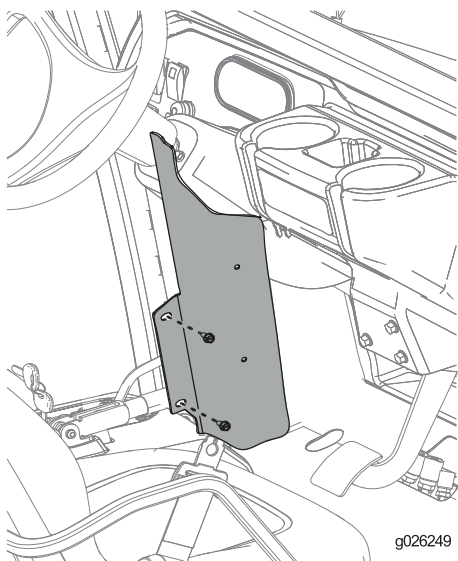

Figure 30

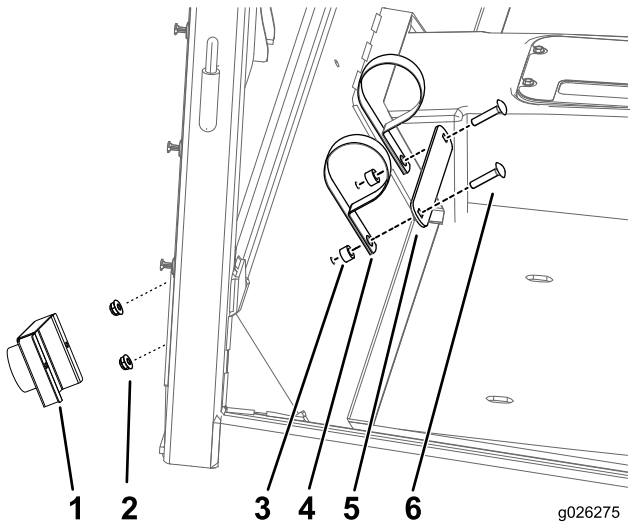

Figure 31

- | | |
|---|-------------|
| 1. Nuts | 4. R-clamps |
| 2. CVT intake hood assembly (Workman HDX-Auto only / kit sold separately) | 5. Plate |
| 3. Spacers | 6. Bolts |

Torque the bolts to 1017 to 1243 N-cm (90 to 110 in-lb).

12

Installing the Center Console Panel, Seats, Coolant Tank, CVT Cooling Duct (HDX-Auto only), and Operator’s Manual Tube

Parts needed for this procedure:

2	Bolts (1/4 inch)
2	Spacers
1	Strap
2	Nuts (1/4 inch)
1	CVT intake hood assembly (Sold separately)

Procedure

1. Install the operator manual tube as shown in [Figure 31](#).

2. Align the holes in the seat rails with the holes in the shroud for the seat mounting positions ([Figure 6](#)).
 3. Secure the seats to the chassis with the 8 socket-head bolts ([Figure 6](#)) that you removed in step 2 [Removing the Center Console Panel and Seats](#) (page 4).
 4. **For the Workman HDX-Auto only:** Secure the CVT cooling duct ([Figure 7](#)) to the intake-tube connector using the hose clamp that you removed in step 3 [Removing the CVT Cooling Duct \(HDX-Auto only\), Coolant Tank, ROPS Assembly, and Seat Shroud](#) (page 5).
- Note:** CVT intake hood assembly needs to be added to this kit for the Workman HDX-Auto machine. See your Authorized Service Dealer.
5. Align the center console panel over the control rods at the center console ([Figure 3](#) and [Figure 5](#)) and secure the panel with the screws that you removed in step 2 [Removing the Center Console Panel and Seats](#) (page 4).
 6. Install the knobs removed in step 2 [Removing the Center Console Panel and Seats](#) (page 4).
 7. Align the left and right flanges of the coolant-tank bracket with the coolant tank support on the seat shroud ([Figure 8](#)).
 8. Lower the tank into the support until the tank is firmly seated ([Figure 8](#)).

13

Connecting the Battery, Lowering the Bed, and Installing the Hood

No Parts Required

Procedure

Refer to the *Operator's Manual* for the machine.

1. Connect the positive battery cable to the battery.
 2. Squeeze the battery cover, align the tabs to battery base, and release battery cover.
- Note:** Refer to the *Operator's Manual* for the machine.
3. Lower the bed; refer to the *Operator's Manual*.
 4. Align the bottom of the hood to the top of the bumper.
 5. Connect the lights.
 6. Insert the top mounting tabs into the frame slots.
 7. Insert the lower mounting tabs into the pockets in the bumper.
 8. Ensure that the hood is fully engaged in the top, sides, and bottom grooves.

Product Overview

Controls

Control Panel

Windshield Wiper Switch

Push the top of the switch to activate the windshield wipers (Figure 32).

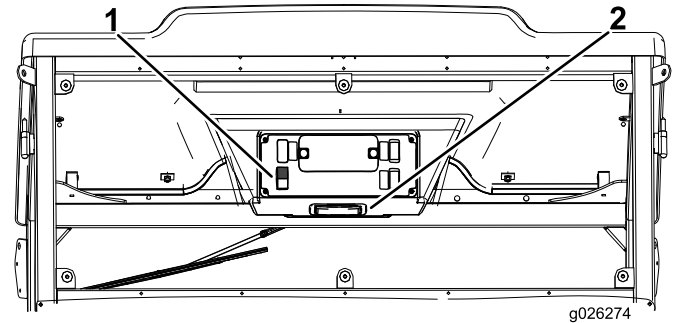

Figure 32

1. Windshield wiper control
2. Light switch

Light Switch

Push the light plate to turn on the light (Figure 32).

Windshield Latch

Lift up on latches to open the windshield (Figure 33). Press in on latch to lock windshield in open position. Pull out and down on latch to close and secure windshield.

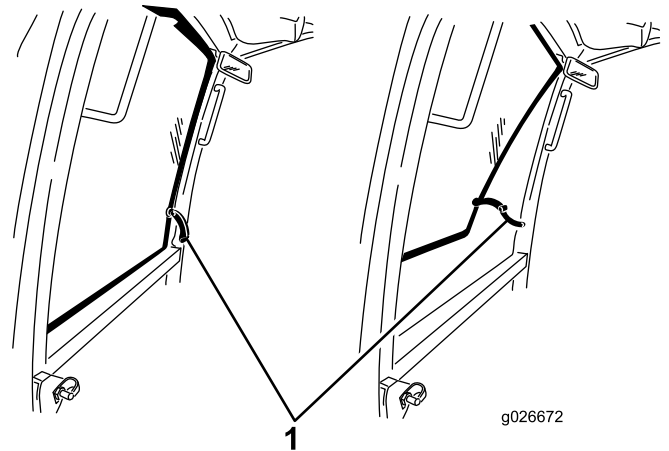

Figure 33

1. Windshield latch

Notes:

Declaration of Incorporation

Model No.	Serial No.	Product Description	Invoice Description	General Description	Directive
07392	315000001 and Up	Cab Kit, Workman HDX and HDX-Auto Utility Vehicle	CAB-HD WORKMAN	Utility Vehicle	2006/42/EC, 2000/14/EC

Relevant technical documentation has been compiled as required per Part B of Annex VII of 2006/42/EC.

We will undertake to transmit, in response to requests by national authorities, relevant information on this partly completed machinery. The method of transmission shall be electronic transmittal.

This machinery shall not be put into service until incorporated into approved Toro models as indicated on the associated Declaration of Conformity and in accordance with all instructions, whereby it can be declared in conformity with all relevant Directives.

Certified:



David Klis
Sr. Engineering Manager
8111 Lyndale Ave. South
Bloomington, MN 55420, USA
November 13, 2014

EU Technical Contact:

Peter Tetteroo
Toro Europe NV
B-2260 Oevel-Westerloo
Belgium

Tel. 0032 14 562960
Fax 0032 14 581911