



# **Vac-Bagger**

**for 42 and 48 inch  
GARDEN TRACTOR  
SIDE DISCHARGE MOWERS**

**Model No. 79301 – 6900001 & Up**

---

## **Operator's Manual**

**IMPORTANT:** Read this manual carefully. It contains information about your safety and the safety of others. Also become familiar with the controls and their proper use before you operate the product.

# Introduction

We want you to be completely satisfied with your new product, so feel free to contact your local Authorized Service Dealer for help with service, genuine replacement parts, or other information you may require.

Whenever you contact your Authorized Service Dealer or the factory, always know the model and serial numbers of your product. These numbers will help the Service Dealer or Service Representative provide exact information about your specific product. You will find the model and serial number plate located in a unique place on the product as shown below.

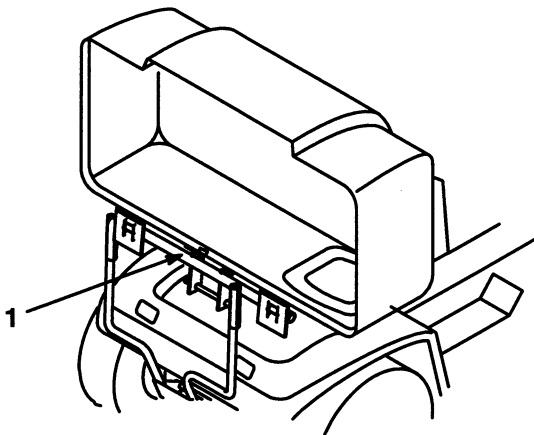

1. Model and Serial Number Plate

For your convenience, write the product model and serial numbers in the space below.

Model No: \_\_\_\_\_

Serial No. \_\_\_\_\_

The warning system in this manual identifies potential hazards and has special safety messages that help you and others avoid personal injury, even death. **DANGER**, **WARNING** and **CAUTION** are signal words used to identify the level of hazard. However, regardless of the hazard, be extremely careful.

**DANGER** signals an extreme hazard that will cause serious injury or death if the recommended precautions are not followed.

**WARNING** signals a hazard that may cause serious injury or death if the recommended precautions are not followed.

**CAUTION** signals a hazard that may cause minor or moderate injury if the recommended precautions are not followed.

Two other words are also used to highlight information. “Important” calls attention to special mechanical information and “Note” emphasizes general information worthy of special attention.

The left and right side of the machine is determined by sitting on the seat in the normal operator’s position.

# Contents

	<b>Page</b>		<b>Page</b>
Safety and Instruction Decals .....	2	Maintenance .....	22
Assembly .....	3	Service Interval Chart .....	22
Loose Parts .....	3	Inspecting the Vac Bagger Attachment ...	23
Preliminary Assembly .....	5	Inspecting the Mower Blades .....	23
Installing Vac-Bagger .....	9	Caring for the Grass Bags .....	23
Remove the Bagger .....	14	Cleaning the Vac Bagger Attachment ....	23
Operation .....	19	Storage .....	24
Using the Full Bag Tester .....	19		
Emptying the Grass Bags .....	19		
Clearing Obstructions From Bagger .....	20		
Operating and Bagging Tips .....	20		

## Safety and Instruction Decals



Safety decals and instructions are easily visible to the operator and are located near any area of potential danger. Replace any decal that is damaged or lost.

### ON INSIDE BAGGER HINGE FRAME (Part No. 92-7113)



### MOLDED INTO THE BELT COVER



### MOLDED INTO THE BLOWER HOUSING AND BELT COVER

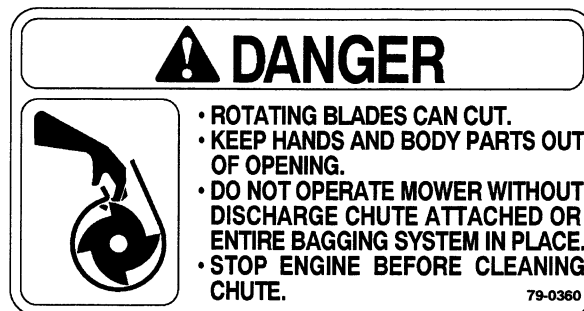

### MOLDED INTO THE BELT COVER

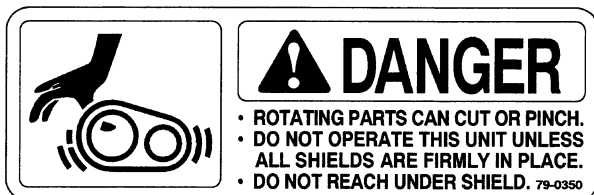

### ON THE INNER COVER (Part No. 92-7108)



# Assembly

## Loose Parts

**Note:** Use the chart below to identify parts used for assembly.

DESCRIPTION	QTY.	USE
Leveler assembly	1	Install leveler assembly to mower
Grass baffle (1 hole 42" mower only)	1	Install grass baffle 42" mower only
Bolt 3/8–16 x 1"	1	
Lock nut 3/8"	1	
Grass baffle (2 holes 48" mower only)	1	Install grass baffle 48" mower only
Bolt 3/8–16 x 1"	2	
Lock nut 3/8"	2	
Pivot support	1	Install blower pivot support to mower
Jam nut 1/4"	1	
Bolt 5/16–18 x 3/4"	1	
Flange nut 5/16"	1	
Blower mounting plate	1	Assemble the blower
Blower assembly	1	
Carriage bolt 5/16–18 x 3/4"	3	
Flange nut 5/16"	3	
L–support bracket	1	
Bolt 5/16–18 x 1"	1	
Washer 5/16"	1	
Flange nut 5/16"	1	
Spring	1	
Screw #10–32 x 3/4"	1	
Washer 7/32"	2	
Nut #10	2	
Latch (long 48" mower only)	1	
Latch (short 42" mower only)	1	
Bolt 1/4–20 x 3/4"	1	
Washer 1/4"	1	
Lock nut 1/4"	1	

DESCRIPTION	QTY.	USE
Support bracket LH	1	Install bagger brackets to tractor
Support bracket RH	1	
Bolt 5/16–18 x 7/8"	4	
Lock nut 5/16"	4	
Bagger Cover	1	Assemble the bagger
Indicator rod	1	
Handle	1	
Jam nut 1/4"	1	
Clips	2	
Pan head screw 1/4–20 x 5/8"	2	
Lock nut 1/4"	2	
Frame hinge assembly	1	
Bolt 1/4–20 x 3/4"	2	
Lock nut 1/4"	2	
Belt cover	1	Install belt cover
Bolt 1/4–20 x 5/8"	2	
Lock nut 1/4"	2	
Bagger mount	1	Install bagger mount to tractor
Bolt 3/8–16 x 1-3/4"	2	
Lock nut 3/8"	2	
Spacer	2	
Hairpin cotter	1	
Bag	2	Mount into bagger cover
Discharge tube	1	Assemble knob to discharge chute
Knob	1	
Washer 1/4"	1	
Screw 1/4–20 x 3/4"	1	
Operator's Manual	1	Read before operating

## Preliminary Assembly

### Remove the Discharge Chute

1. Park the machine on a level surface, disengage the blade control (PTO), set the parking brake, and turn the ignition key to "OFF" to stop the engine. Remove the key.
2. Lower the mower to its lowest position and remove mower from tractor. Refer to Mower Operator's Manual for instructions.
3. Thoroughly clean mower deck. All debris must be removed to ensure baffles will fit against mower properly.
4. Remove discharge chute from the mower (Fig. 1).
5. Remove belt cover from right side (Fig. 1).

**Note:** Save all parts and hardware for use when using mower to side discharge.

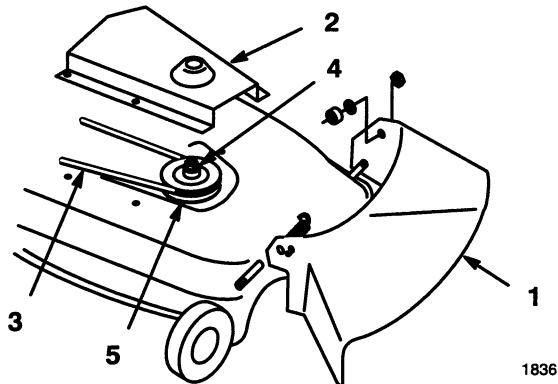
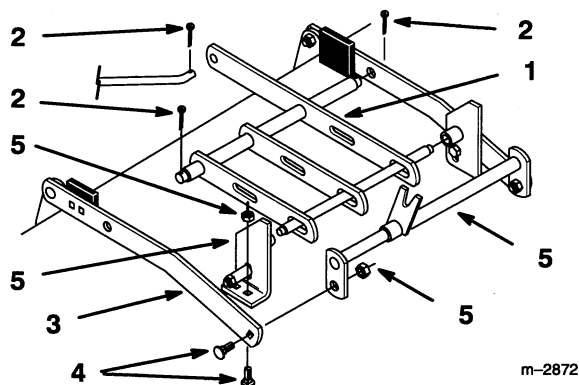

**Figure 1**

- |                    |                       |
|--------------------|-----------------------|
| 1 Discharge chute  | 4 Nut and lock washer |
| 2 Belt cover       | 5 Single pulley       |
| 3 Blade drive belt |                       |

### Install Leveling Bar

1. Remove cotter pins securing leveling assembly to mower (Fig. 2). Remove hardware securing front mounting bar to right leveling bar (Fig. 2).
2. Remove hardware securing right bracket to mower and remove leveler assembly (Fig. 2).
3. Replace leveler assembly with new one, containing three bars, and secure right bracket to mower with previously removed hardware (Fig. 2).
4. Attach front mounting bar to right leveling bar with previously removed hardware and install cotter pins in leveling assembly (Fig. 2).



**Figure 2**

- |                      |                 |
|----------------------|-----------------|
| 1 Leveling assembly  | 5 Right bracket |
| 2 Cotter pin         | 6               |
| 3 Leveling bar       | 7 Bolt          |
| 4 Front mounting bar | 8 Locknut       |

## Install Mower Baffle

1. Remove the bolt(s) and nut(s) at the end of the grass plate. Inside the mower near the back edge of the discharge opening. Discard the hardware.
2. Select appropriate grass baffle (42" single hole or 48" two holes) Install grass baffle tight against grass plate with top edge up against inside of mower.
3. Secure with new 3/8 x 1" carriage bolt(s) and 3/8" lock nut(s) (Fig. 3-42" or 4-48").

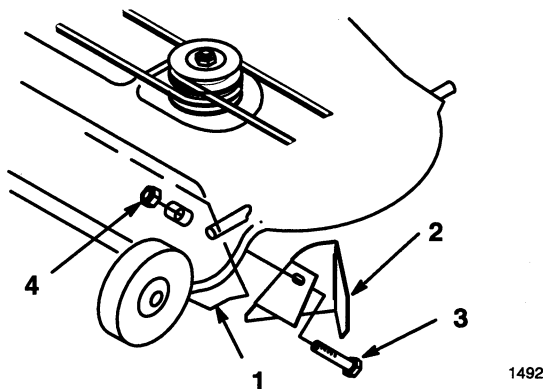

Figure 3

- |               |                          |
|---------------|--------------------------|
| 1 Grass plate | 3 Carriage Bolt 3/8 x 1" |
| 2 42" Baffle  | 4 Nut 3/8"               |

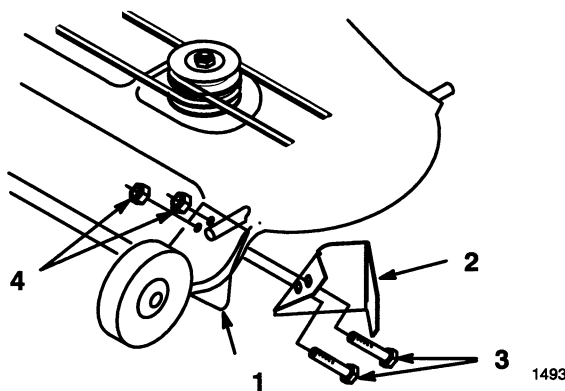

Figure 4

- |               |                          |
|---------------|--------------------------|
| 1 Grass plate | 3 Carriage bolt 3/8 x 1" |
| 2 48" Baffle  | 4 Nut 3/8"               |

4. Rotate blade and check for clearance with baffle. If necessary adjust baffle so blade does not hit.

## Assemble Blower

5. Assemble blower mounting plate to blower with (3) 5/16 x 3/4" carriage bolts and 5/16" flange nuts (Fig. 5).
6. In the front inside hole of the blower insert a 5/16 x 1" carriage bolt item 6 (Fig. 5).
 

**Note:** This carriage bolt must be installed down thru plate and blower for proper belt clearance.
7. Inside the blower housing slide the L-bracket over the bolt. Hold the L-bracket tight against the blower housing wall and secure with 5/16" washer and 5/16" flange nut (Fig. 5).

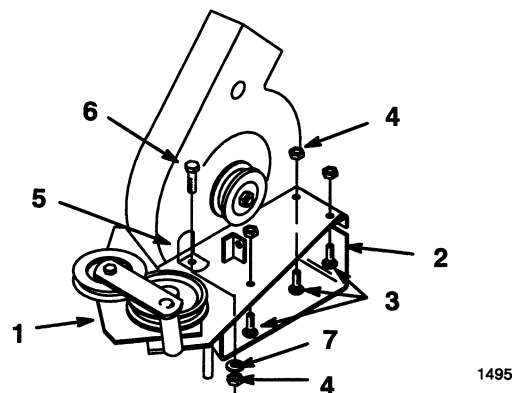

Figure 5

- |                             |                  |
|-----------------------------|------------------|
| 1 Blower mounting plate     | 5 L-bracket      |
| 2 Blower assembly           | 6 Bolt 5/16 x 1" |
| 3 Carriage bolt 5/16 x 3/4" | (down from top)  |
| 4 Flange nut 5/16"          | 7 Washer 5/16"   |



8. Install one end of tension spring and #10 nut onto #10 x 3/4" screw. Thread nut on within 1/8" from end of screw so spring rotates freely (Fig. 6).
9. Slide #10 washer onto screw and insert through blower housing. Secure with second #10 washer and #10 nut (Fig. 6).
10. Select appropriate latch (42" short, 48" long) Hook spring into latch and mount to blower housing with 1/4 x 3/4" bolt, 1/4" washer and 1/4" lock nut (Fig. 6). Check that latch pivots freely.

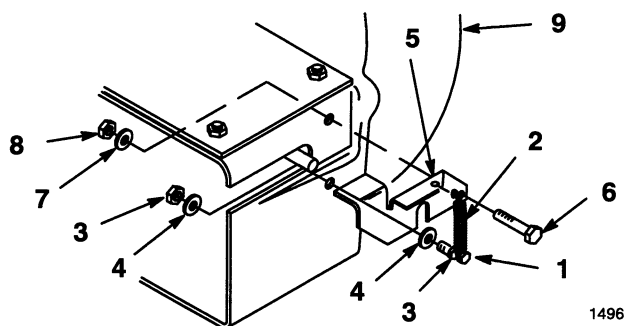

Figure 6

- |                    |                   |
|--------------------|-------------------|
| 1 Screw #10 x 3/4" | 6 Bolt 1/4 x 3/4" |
| 2 Spring           | 7 Washer 1/4"     |
| 3 Nut #10          | 8 Lock nut 1/4"   |
| 4 Washer #10       | 9 Blower assembly |
| 5 Latch            |                   |

## Tractor Set-Up

1. Remove (4) bolts and nuts from the rear of the tractor frame and discard (Fig. 7).
2. Mount the (2) support brackets against the tractor frame with (4) 5/16 x 3/4" bolts and 5/16" lock nuts (Fig 7). Wide bracket on the left side and narrow bracket on the right side.

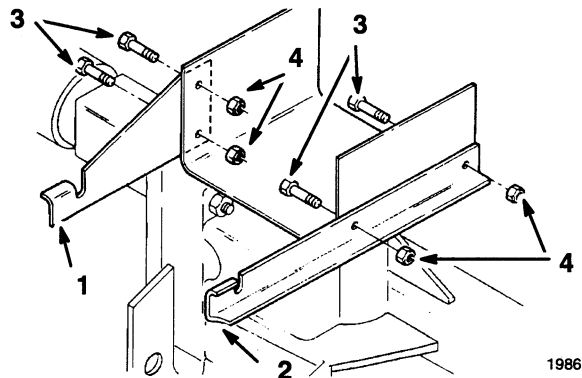

Figure 7

- |                      |                    |
|----------------------|--------------------|
| 1 Support bracket LH | 3 Bolt 5/16 x 7/8" |
| 2 Support bracket RH | 4 Lock nut 5/16"   |

## Assemble Bagger Cover

1. Slide threaded end of indicator rod through (2) clips, then rubber seal and slot in cover (Fig. 8).
2. Secure clips to cover with (2) 1/4 x 5/8" pan head screws and 1/4" lock nuts (Fig. 8).
3. Thread jam nut and handle completely onto threaded end of indicator rod. Rotate handle so you can read decal from operators position then tighten jam nut (Fig. 8).

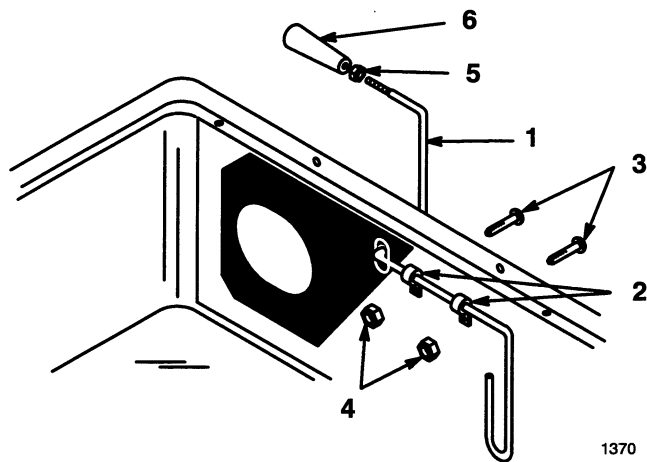

Figure 8

- |                             |                 |
|-----------------------------|-----------------|
| 1 Indicator rod             | 4 Lock nut 1/4" |
| 2 Clips                     | 5 Jam nut 1/4"  |
| 3 Pan head screw 1/4 x 5/8" | 6 Handle        |

4. Mount the frame hinge to the cover with (2) 1/4" bolts attached to it. Secure with (2) 1/4" lock nuts (Fig. 9).

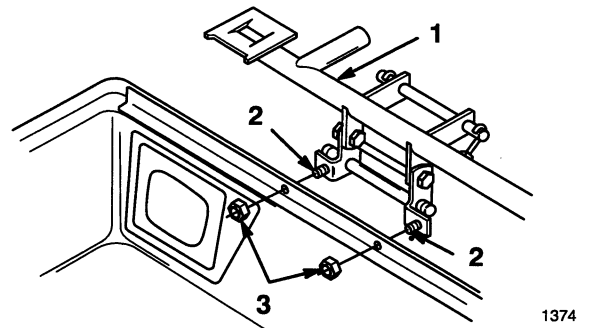

Figure 9

- |                        |                 |
|------------------------|-----------------|
| 1 Frame hinge          | 3 Lock nut 1/4" |
| 2 Bolt 1/4" (attached) |                 |

## Assemble Discharge Tube

1. Cut 2-3/4" (7 cm) off the bottom of the discharge tube (Fig. 10).
2. Attach the knob to the center hole in the discharge tube and secure with 1/4" washer and 1/4 x 3/4" screw (Fig. 10).

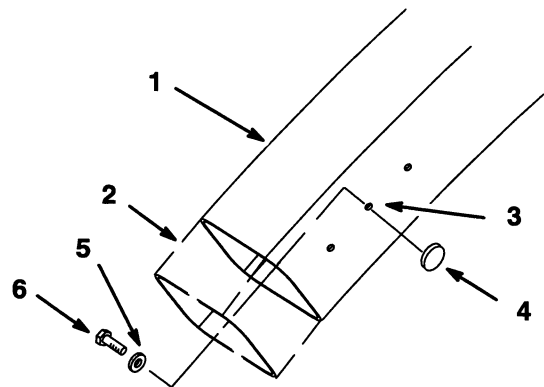

Figure 10

- |                     |                    |
|---------------------|--------------------|
| 1 Discharge tube    | 4 Knob             |
| 2 Cut 2-3/4" (7 cm) | 5 Washer 1/4"      |
| 3 Tube center hole  | 6 Screw 1/4 x 3/4" |

## Installing Vac-Bagger

### Remove the Discharge Chute

1. Park the machine on a level surface, disengage the blade control (PTO), set the parking brake, and turn the ignition key to "OFF" to stop the engine. Remove the key.
2. Lower the mower to its lowest position and remove mower from tractor. Refer to Mower Operator's Manual for instructions.
3. Thoroughly clean mower deck. All debris must be removed to ensure baffles will fit against mower properly.
4. Remove discharge chute from the mower (Fig. 11).
5. Remove belt cover from right side (Fig. 11).

**Note:** Save all parts and hardware for use when using mower to side discharge.

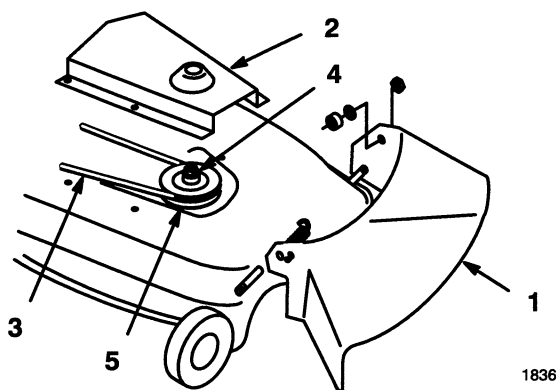

**Figure 11**

- |                    |                       |
|--------------------|-----------------------|
| 1 Discharge chute  | 4 Nut and lock washer |
| 2 Belt cover       | 5 Single pulley       |
| 3 Blade drive belt |                       |

### Install Blower Drive Pulley

6. Pull on mower idler assembly to release belt tension and remove blade drive belt from right side pulley (Fig. 11).
7. Remove nut and lock washer from right hand blade spindle (Fig. 11). Remove single pulley.

**Note:** Block blade with a piece of wood to stop it from turning while you remove the pulley nut. If blade slips hold hex portion of spindle above the blade with a wrench.

**Note:** When nut is removed the shaft is free to drop out of the spindle.

8. Select proper diameter top double pulley 42"=3-1/4" and 48"=3-3/4". Slide the new double pulley onto the spindle shaft with the word "TOP", stamped into pulley, facing up. Secure with previously removed 5/8" lock washer and nut (Fig. 12).
9. Tighten the nut to 70 ft. lb. (95 Nm).
10. Install the existing mower belt by rotating it onto the bottom pulley (Fig. 12).

**Note:** Check that mower belt is properly located on idler and pulleys.

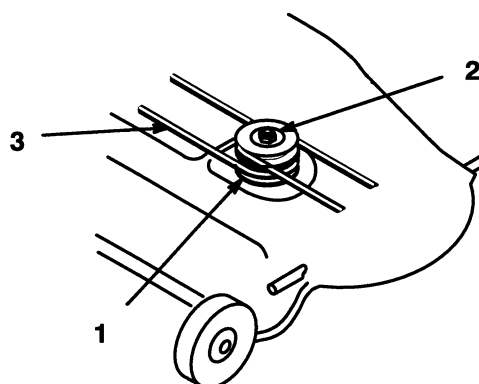

**Figure 12**

- |                                  |                            |
|----------------------------------|----------------------------|
| 1 New double pulley (note "TOP") | 2 Lock washer and nut 5/8" |
|                                  | 3 Mower belt               |

## Install Blower Pivot Support

11. Select proper hole (42" outside, 48" inside) and slide pivot support over threaded stud welded to front of mower near discharge opening (Fig. 13).
12. Align pivot support parallel with front curved edge and tight against top of mower (Fig. 13). Clamp in this position.
13. Drill  $11/32$ " diameter hole in top of mower using the pivot support as a guide. Secure pivot support to the mower with a  $5/16 \times 3/4$ " bolt, through from the underside of the mower, and a flange nut (Fig. 13). Place  $3/8$ " washer and  $3/8$ " jam nut (removed from discharge chute) snug onto stud. Do not overtighten jam nut.

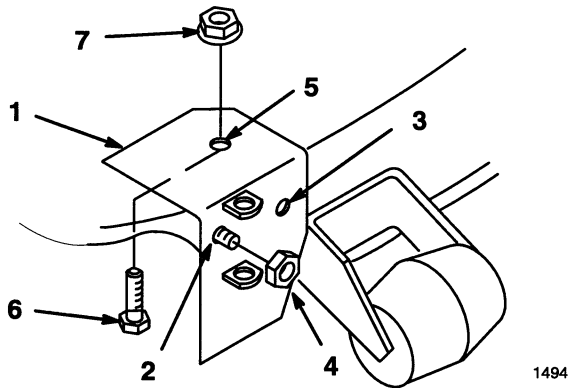

Figure 13

- |   |                               |
|---|-------------------------------|
| 1 Pivot support                                     | 5 Drill $11/32$ diameter hole |
| 2 Mounting hole 42"                                 | 6 Bolt $5/16 \times 3/4$ "    |
| 3 Mounting hole 48"                                 | 7 Flange nut $5/16$ "         |
| 4 Jam nut $3/8$ "<br>(removed from discharge chute) |                               |

## Mount the Blower

14. Insert pivot pin on blower into pivot support bracket on mower (Fig. 14).

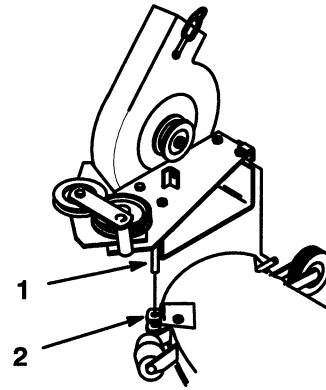

Figure 14

- |             |                         |
|-------------|-------------------------|
| 1 Pivot pin | 2 Pivot support bracket |
|-------------|-------------------------|

15. Install drive belt as shown around idler pulleys and blower drive pulley. (Fig. 15).

**Note:** Use belt part number 79-7480 for 42" mowers and the belt part number 79-7490 for 48" mowers.

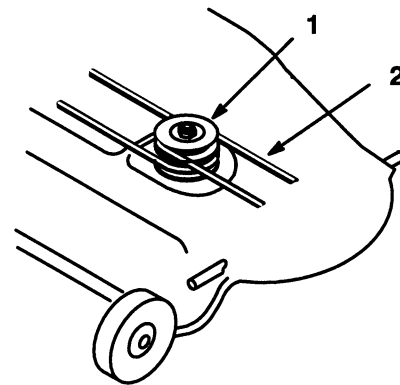
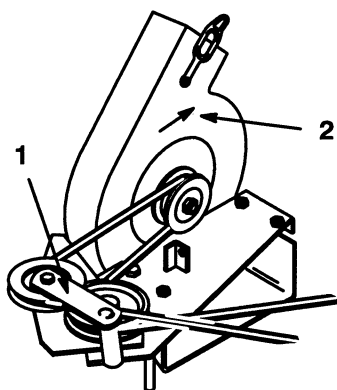

Figure 15

- |                             |                     |
|-----------------------------|---------------------|
| 1 Blower drive pulley (Top) | 2 Blower drive belt |
|-----------------------------|---------------------|

16. With the blower swung out in the open position, install the blower drive belt between the idler pulley bracket and pulley. Then loop the belt around the remaining pulleys (Fig. 16).
17. Check direction of blower rotation (Fig. 16).



1839

**Figure 16**

- |                                   |                      |
|-----------------------------------|----------------------|
| 1 Idler pulley bracket and pulley | 2 Rotation direction |
|-----------------------------------|----------------------|

18. With the belt installed, swing the blower toward the mower until the blower latch locks over pin at the back of the mower (Fig. 17).

**Note:** If blower cannot be latched on 42" mowers because of interference between mower and blower housing, cut housing until blower closes and latches.

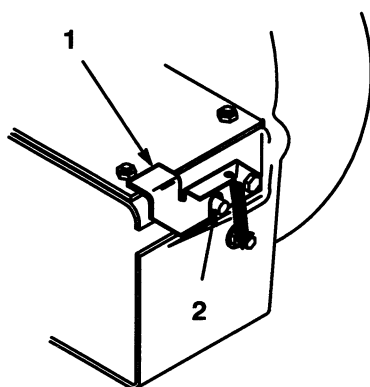

1840

**Figure 17**

- |                |       |
|----------------|-------|
| 1 Blower latch | 2 Pin |
|----------------|-------|

## Install Belt Covers

19. Two belt covers brackets are supplied (Fig. 18). The short, wide bracket is for 42" mowers. The long, narrow bracket is for 48" mowers.

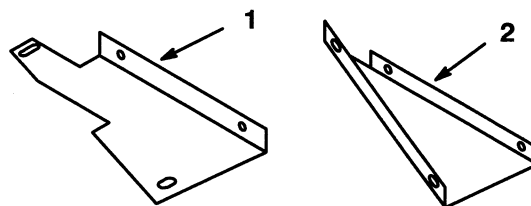

1993

**Figure 18**

- |                          |                          |
|--------------------------|--------------------------|
| 1 Belt cover bracket 42" | 2 Belt cover bracket 48" |
|--------------------------|--------------------------|

20. On 42" mowers mount belt cover using (2) 1/4 x 1/2" thread forming flange screws in holes used by original cover (Fig. 19).
21. On 48" mowers mount belt cover bracket to the rib on the top of the mower using (2) 1/4 x 3/8" flange screws (Fig. 19).

**Note:** Center slots of cover bracket before tightening flange screws.

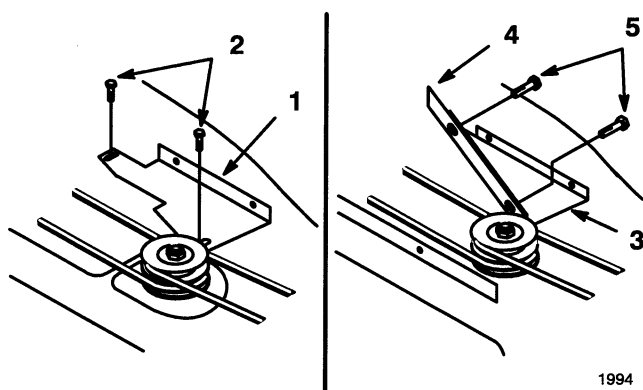

Figure 19

- |   |   |
|---|---|
| 1 Belt cover bracket 42"                  | 4 Rib                                     |
| 2 Flange screws 1/4 x 1/2" thread forming | 5 Flange screws 1/4 x 3/8" thread forming |
| 3 Belt cover bracket 48"                  |   |

22. On 42" mowers mount belt cover loosely to the outside of the belt cover bracket and top of the mower using (3) 1/4 x 1/2" flange screws (Fig. 20).

**Note:** Do not tighten screws as adjustment must be made later.

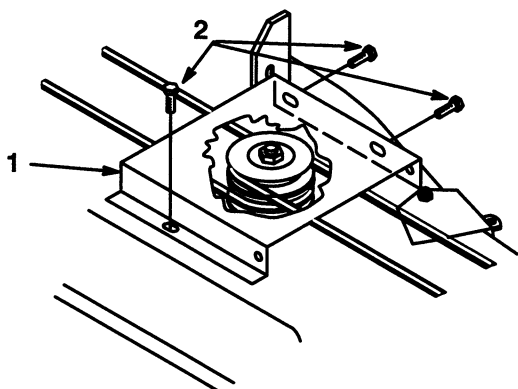

Figure 20

- |                  |   |
|------------------|---|
| 1 Belt cover 42" | 2 Flange screws 1/4 x 1/2" thread forming |
|------------------|---|

23. On 48" mowers mount belt cover loosely to the outside of the belt cover bracket (2) 1/4 x 3/8" flange screws and to rib using 1/4 x 1/2" flange screw (Fig. 21).

**Note:** Do not tighten screws as adjustment must be made later.

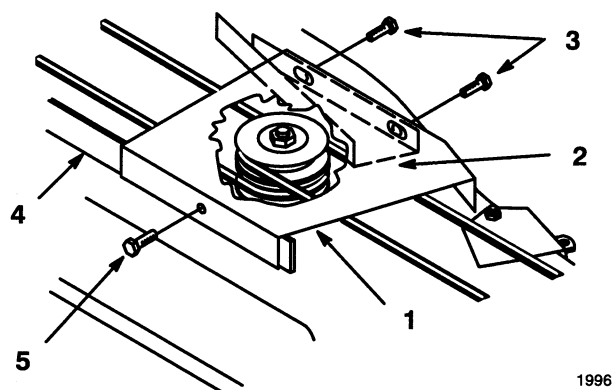

Figure 21

- |   |   |
|---|---|
| 1 Belt cover 48"                          | 4 Rib                                     |
| 2 Belt cover bracket 48"                  | 5 Flange screws 1/4 x 1/2" thread forming |
| 3 Flange screws 1/4 x 3/8" thread forming |   |

24. Mount blower belt cover to deck belt cover using (2) 1/4 x 5/8" bolts and lock nuts (Fig. 22). Tighten lock nuts slightly so light drag is felt on belt cover when tilted upward. Cover must close freely when assembled.

25. Adjust mower belt cover by sliding so blower belt cover just touches blower, but still opens freely. Tighten mower belt cover mounting screws.

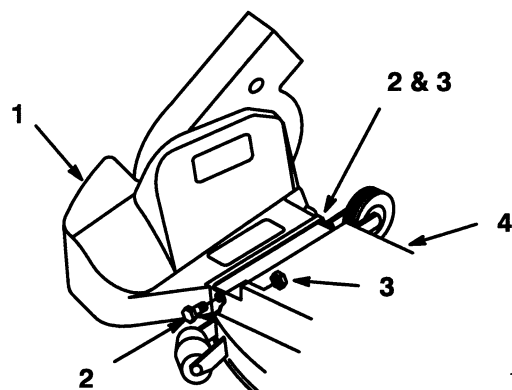
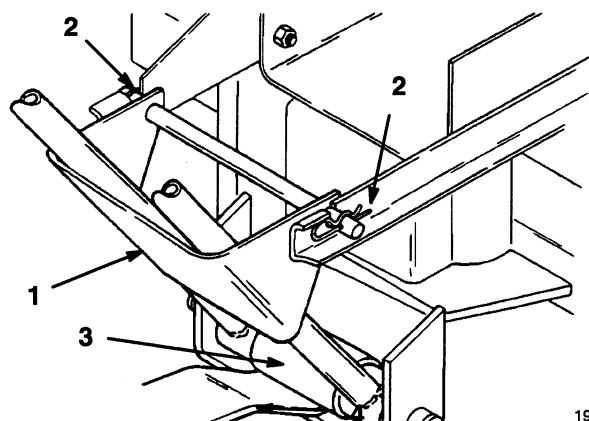

Figure 22

- |                     |                    |
|---------------------|--------------------|
| 1 Blower belt cover | 3 Lock nut 1/4"    |
| 2 Bolt 1/4 x 5/8"   | 4 Mower belt cover |

## Install Bagger Assembly

1. Lower the quick-attach bracket into the notches in the support brackets on the tractor frame and onto the drawbar hitch (Fig. 23).
2. Secure with (2) hair pin cotters through holes in rod of quick-attach bracket (Fig. 23).



1998

**Figure 23**

- |                        |                 |
|------------------------|-----------------|
| 1 Quick-attach bracket | 3 Drawbar hitch |
| 2 Hair pin cotter      |                 |

3. Tip the tractor seat forward.
4. Carefully lift the bagger top and slide it onto the quick-attach bracket (Fig. 24). The bagger top is easier to install if two people work together.

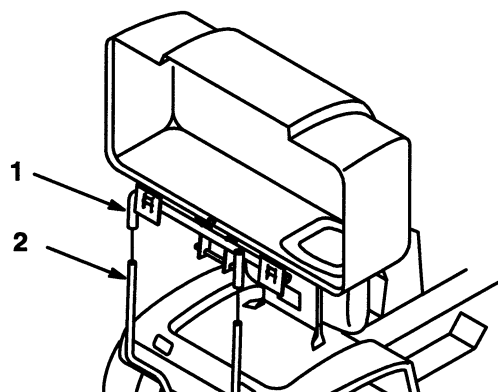

**Figure 24**

- |              |                        |
|--------------|------------------------|
| 1 Bagger top | 2 Quick-attach bracket |
|--------------|------------------------|

## CAUTION

### POTENTIAL HAZARD

- The hinge frame on the bagger top is spring-loaded.

### WHAT CAN HAPPEN

- If you remove the bagger top when it is closed (in the down position), the top may suddenly fly open and you or someone else may be bruised, pinched, or injured in another way.

### HOW TO AVOID THE HAZARD

- Always open (raise) the bagger top before you remove or install it on the quick-attach bracket.

5. Install the bags by sliding the bag frame hooks onto the retaining brackets (Fig. 25).

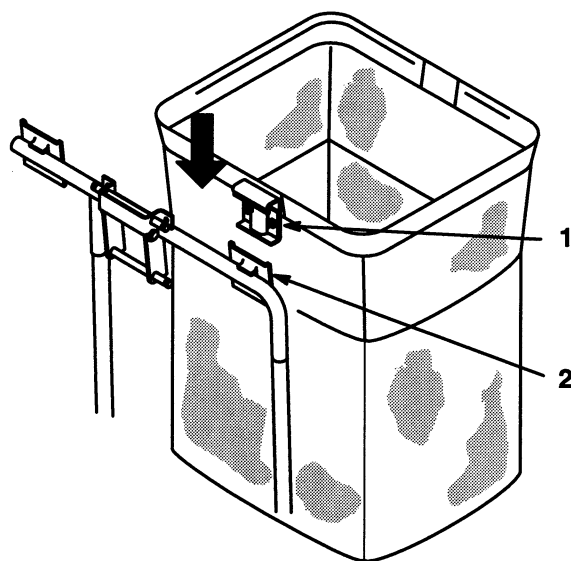

1373

**Figure 25**

- |                  |                     |
|------------------|---------------------|
| 1 Bag frame hook | 2 Retaining bracket |
|------------------|---------------------|

6. Lower the bagger top onto the bags. Then push down on both bag retainer handles until they lock on the bag frame (Fig. 26).

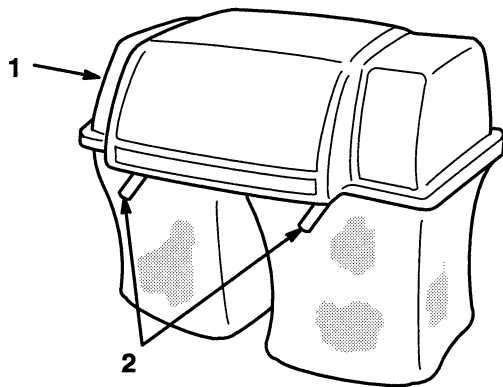

1376

**Figure 26**

- 1 Bagger top                      2 Bag retainer handles

## Install Discharge Tube

7. Move the tractor seat to its normal position.
8. Insert the upper end of the discharge tube into the bagger top. Slide the lower end of the discharge tube over the blower opening (Fig. 27).
9. Hook the rubber latch over knob (Fig. 27).

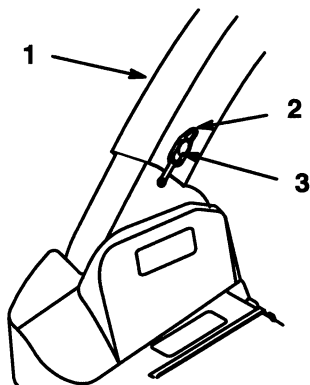

1847

**Figure 27**

- 1 Discharge tube                      3 Knob  
2 Rubber latch

## Remove the Bagger



**DANGER**

### POTENTIAL HAZARD

- Sometimes people are tempted to operate the tractor and mower without both grass bags installed on the Twin Bagger or with the discharge tube removed. This exposes you and others to thrown debris and blade contact.

### WHAT CAN HAPPEN

- You and others may die or be injured severely if you are hit by thrown debris or cut by the blade.

### HOW TO AVOID THE HAZARD

- Always operate the mower with either the complete Twin Bagger grass catcher mounted in place or use the mower to side discharge, making sure that the spring-loaded grass deflector is in the down position.

## Remove the Discharge Tube

1. Unhook the rubber latch from the knob (Fig. 28).
2. Slide the lower end of the discharge tube off the blower discharge opening (Fig. 28). Pull the upper end of discharge tube out of bagger top.

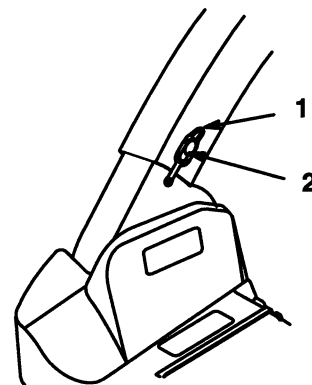

1847

**Figure 28**

- 1 Rubber latch                      2 Knob



## Remove the Bagger

1. Tip the tractor seat forward.
2. Raise the bagger top and remove the grass bags from the bag frame (Fig. 29).

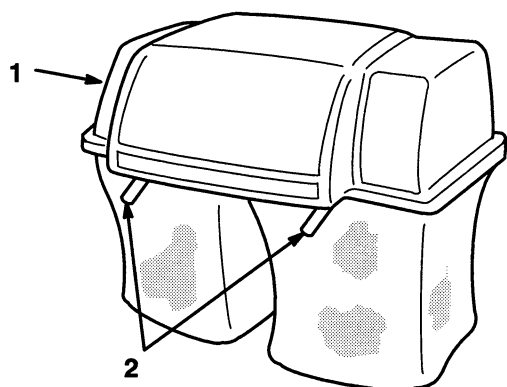

1376

**Figure 29**

- 1 Bagger top                      2 Bag retainer handles

### **! CAUTION**

#### **POTENTIAL HAZARD**

- The hinge frame on the bagger top is spring-loaded.

#### **WHAT CAN HAPPEN**

- If you remove the bagger top when it is closed (in the down position), the top may suddenly fly open and you or someone else may be bruised, pinched, or injured in another way.

#### **HOW TO AVOID THE HAZARD**

- Always open (raise) the bagger top before you remove or install it on the quick-attach bracket.

3. Carefully lift the bagger top and slide off the quick-attach bracket (Fig. 30). The bagger top is easier to remove if two people work together.

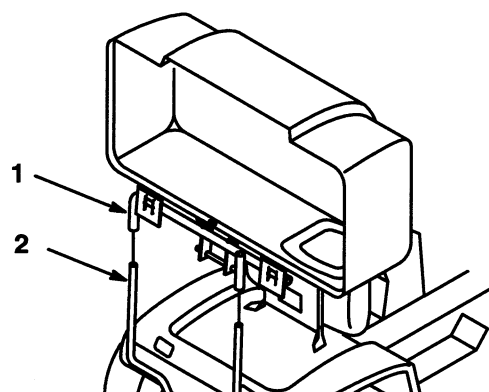

**Figure 30**

- 1 Bagger top                      2 Quick-attach bracket

4. Remove (2) hair pin cotters from holes in rod of quick-attach bracket (Fig. 31).
5. Remove the quick-attach bracket from notches in the support brackets on the tractor frame and the drawbar hitch (Fig. 31).

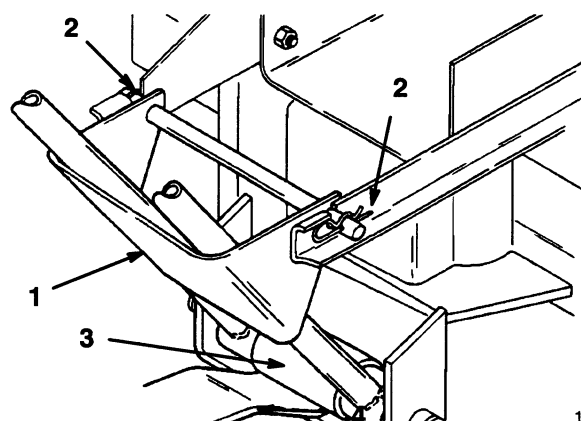

1998

**Figure 31**

- 1 Quick-attach bracket                      3 Drawbar hitch  
2 Hair pin cotter

6. Move the tractor seat to its normal position.

## Remove Blower Belt Cover

7. Remove the blower belt cover by removing (2) lock nuts and bolts (Fig. 32).

**Note:** Save all parts and hardware for use when installing blower.

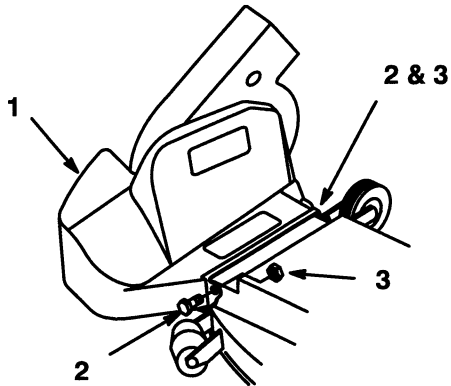
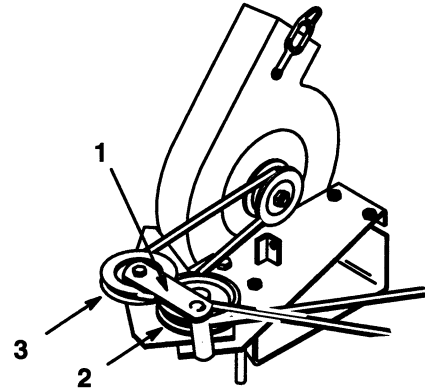

**Figure 32**

- |                    |            |
|--------------------|------------|
| 1 Mower belt cover | 3 Lock nut |
| 2 Bolt             |            |

## Remove the Blower from the Mower

1. Open latch and swing the blower out away from the mower, remove the blower belt from idler and blower pulleys (Fig. 33).



**Figure 33**

- |  |                                  |
|--|----------------------------------|
| 1 Idler pulley bracket and pulley        | 3 V-side of belt into top pulley |
| 2 Top side of belt against bottom pulley |                                  |

2. Remove the blower by lifting the pivot pin out of the pivot support (Fig. 34).

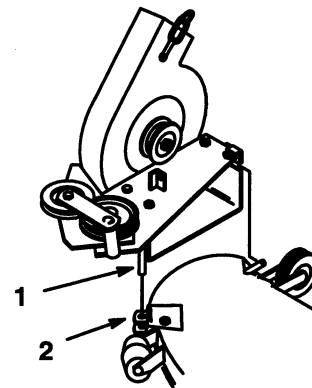

**Figure 34**

- |             |                 |
|-------------|-----------------|
| 1 Pivot pin | 2 Pivot support |
|-------------|-----------------|

## Remove the Blower Belt Cover

1. Lower the mower to its lowest position and remove mower from tractor. Refer to Mower Operator's Manual for instructions.
2. Remove the mower belt cover from the right side pulley (Fig. 35). Save mounting hardware.
3. Unhook blower belt from blower pulley and slide the belt out of opening in belt cover (Fig. 35).

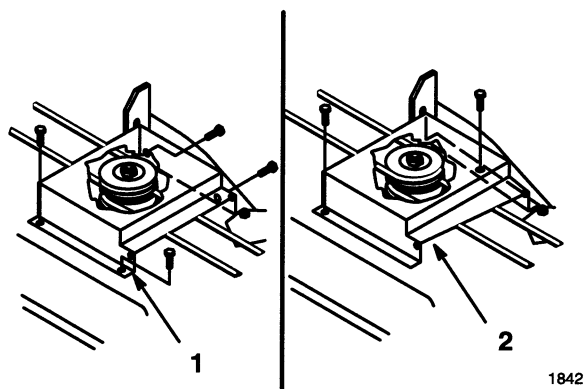

Figure 35

1 Belt cover 42"

2 Belt cover 48"

4. Remove belt cover bracket (Fig. 36).

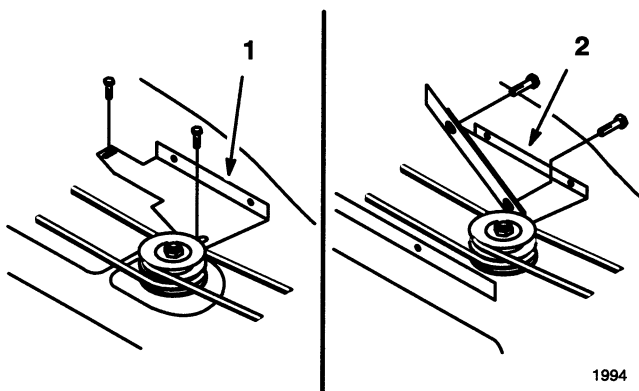

Figure 36

1 Belt cover bracket 42"

2 Belt cover bracket 48"

## Remove the Blower Drive Pulley

5. Pull on mower idler assembly to release belt tension and remove blade drive belt from right side pulley (Fig. 37).
6. Remove nut and lock washer from right hand blade spindle (Fig. 37). Remove double pulley.

**Note:** Block blade with a piece of wood to stop it from turning while you remove the pulley nut. If blade slips hold hex portion of spindle with a wrench.

**Note:** When nut is removed the shaft is free to drop out of the spindle.

7. Slide the single pulley onto the spindle shaft. Secure with previously removed lock washer and nut (Fig. 37).
8. Tighten the nut to 70 ft. lb. (95 Nm).
9. Install the existing mower belt by rotating it onto the pulley (Fig. 39).

**Note:** Check that mower belt is properly located on idler and pulleys.

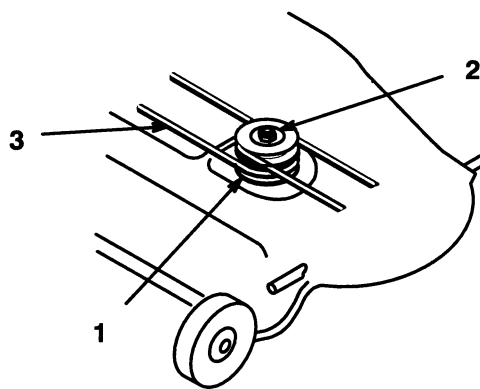

Figure 37

1 Double pulley

3 Blade drive belt

2 Lock washer and nut

1837

## Remove the Blower Pivot Support

1. Remove the pivot support from the mower (Fig. 38).

**Note:** Save all parts and hardware for use when installing blower.

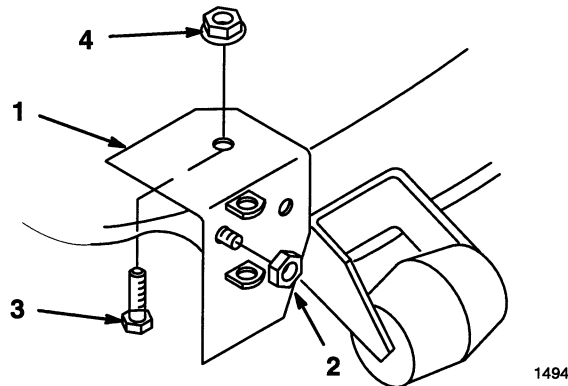
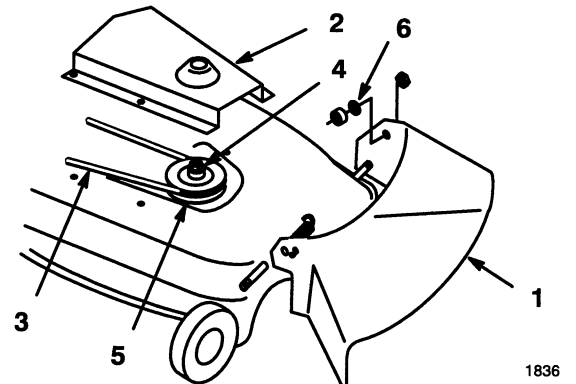

**Figure 38**

- |                  |              |
|------------------|--------------|
| 1 Pivot support  | 3 Bolt       |
| 2 Nut and washer | 4 Flange nut |

## Install Belt Cover and Discharge Chute

1. Install discharge chute onto mower with saved hardware (Fig. 39).
2. Install original belt cover onto mower with saved hardware (Fig. 39).



**Figure 39**

- |                    |                            |
|--------------------|----------------------------|
| 1 Discharge chute  | 4 Nut and lock washer 5/8" |
| 2 Belt cover       | 5 Single pulley            |
| 3 Blade drive belt | 6 Plastic washer           |

# Operation

## CAUTION

### To Avoid Personal Injury:

- **Become familiar with all operating and safety instructions in the operator's manual for your tractor and mower before using this attachment.**
- **Never remove the discharge tube, bags, bagger top, or the blower while the engine is running.**
- **Always shut the engine off before clearing an obstruction from the vac bagging system.**
- **Never do maintenance or repairs while the engine is running.**

## Using the Full Bag Tester

As grass is cut and blown into the bags, the left bag fills first, then the right bag. If you overfill the bags, grass will eventually plug the discharge tube or elbow.

1. Stop the tractor and apply the brake.
2. To check if both bags are full, periodically raise the full bag tester handle (Fig. 40). If you feel resistance as you raise the handle, the bags must be emptied because they are full (Fig. 40).

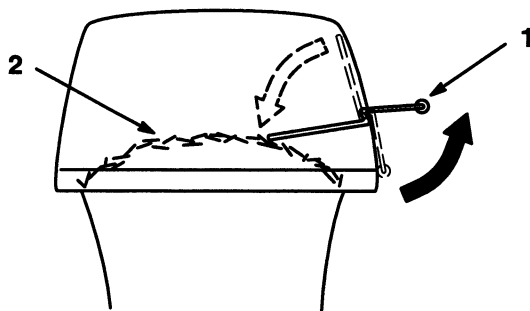

1381

**Figure 40**

1 Full bag tester handle

2 Bag full

## Emptying the Grass Bags

Grass bags can weigh up to 90 lb (41kg) when full. Be careful when lifting or handling a grass bag that is full. To empty the grass bags:

1. Stop the tractor, set the parking brake, and disengage the power take off (PTO) by pushing the PTO control to OFF (this stops the mower blades). Shut the engine off before you get off the tractor.
2. Tip the tractor seat forward.
3. Pull up on both bag retainer handles until they unlock from the bag frame (Fig. 26). Now open (raise) the bagger top.
4. Compress debris into the bags. With both hands, lift up on the bag and unhook it from the retaining bracket (Fig. 25). Empty the bag. Repeat for the other bag.
5. Install the bags by sliding the bag frame hooks onto the retaining brackets (Fig. 25).
6. Lower the bagger top onto the bags. Then push down on both bag retainer handles until they lock on the bag frame (Fig. 26).
7. Move the tractor seat to its normal position.

## Clearing Obstructions From Bagger

1. Stop the tractor, shift into neutral, set the parking brake, push the PTO control to OFF (this stops the mower blades), turn the ignition key to OFF to stop the engine, and remove the key from the switch.
2. Check the grass bags and empty them if they are full.
3. Remove and separate the discharge tube and blower from the bagger top and mower. Using a stick or similar object, carefully remove and clear the obstruction from the mower, discharge tube, blower, and the bagger top.
4. After you remove the obstruction, install the complete bagger system and resume operation.

## Operating and Bagging Tips

### Size

Remember that the tractor is longer and wider with this attachment installed. By turning too sharply in confined places you may damage the attachment.

### Trimming

Always trim with the left side of the mower. Do not trim with the right side of the mower because you could damage the bagger's blower and discharge tube.

### Cutting Height

Do not set the mower cutting height too low because long grass surrounding the mower can prevent air from getting under the mower and entering the bagging system. If enough air doesn't get under the mower, the bagging system will plug.

### Cutting Frequency

Cut the grass often, especially when it grows rapidly. You will have to cut your grass twice if it gets excessively long (refer to Bagging Long Grass, page 21).

### Cutting Technique

For best lawn appearance, be sure to slightly overlap the mower into the previously cut area. This helps reduce the load on the engine and reduces the chance of plugging the blower and discharge tube.

### Using Bags

Although not required, bags may be inserted into each cloth grass bag as a liner to collect clippings and make disposal more convenient (Fig. 41). If you use a bag liner, remove the filled grass bag and close the top of the liner. Then pull the liner out the grass bag or turn the bag upside down while holding the handle on the bottom of the grass bag (allows liner to slide out).

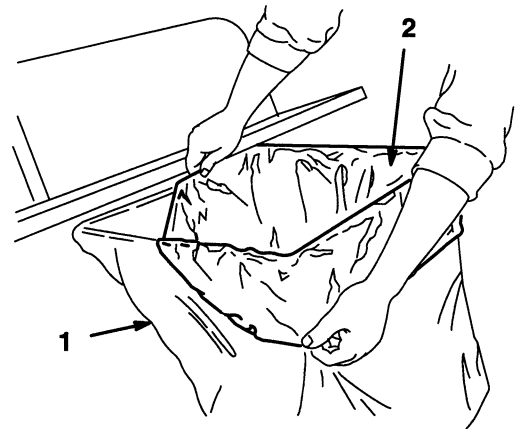

1378

**Figure 41**

1 Cloth grass bag

2 Bag (liner)

### Bagging Speed

Most often you will bag with the tractor throttle in the FAST position and drive at a normal ground speed. However, in extremely dry and dusty grass, you may want to slightly reduce throttle speed and increase ground speed of the tractor. The bagging system may plug if you drive too fast and the engine speed gets too slow. On hills it may be necessary to slow the tractor's ground speed. This helps maintain engine speed and bagging efficiency. Mow down hill whenever possible.

**CAUTION****POTENTIAL HAZARD**

- As the grass bags fill, extra weight is added to the back of the tractor.

**WHAT CAN HAPPEN**

- If you stop and start suddenly on hills, you may lose steering control or the tractor may tip.

**HOW TO AVOID THE HAZARD**

- Do not start or stop suddenly when going uphill or downhill. Avoid uphill starts.
- If you do stop the tractor when going uphill, disengage the PTO (stop the mower blades) by pushing the PTO control to OFF. Then back down the hill using slow reverse speed.
- Do not change speeds or stop on slopes.

**Bagging Long Grass**

Excessively long grass is heavy and may not be propelled completely into the grass bags. If this happens, the discharge tube and blower may plug. To avoid plugging the bagging system, mow the grass at a high height-of-cut, then lower the mower to your normal cutting height and repeat the bagging process.

**Bagging Wet Grass**

Always try to cut grass when it is dry because your lawn will have a neat appearance. If you must cut wet grass, use the conventional side discharge feature of the mower. Several hours later, when the clippings are dry, install the complete bagger attachment and vacuum up the grass clippings.

**Signs of Plugging**

As you are bagging, a small amount of grass clippings normally blow out the front of the mower. An excessive amount of clipping blow-out indicates that the bags are full or the system is plugged.

# Maintenance

## Service Interval Chart

Service Operation	Each Use	5 Hours	25 Hours	Storage Service	Spring Service	Notes
Cutter Blade—check		X	X	X		
Grease—Mower deck			X	X		
Belts—check for wear/cracks				X		
Mower Housing—clean	X	X		X		
Chipped Surfaces—paint				X		

### CAUTION

#### POTENTIAL HAZARD

- If you leave the key in the ignition switch, someone could start the engine.

#### WHAT CAN HAPPEN

- Accidental starting of the engine could seriously injure you or other bystanders.

#### HOW TO AVOID THE HAZARD

- Remove the key from the ignition switch and pull the wire off the spark plug before you do any maintenance. Also push the wire aside so it does not accidentally contact the spark plug.



## Inspecting the Vac Bagger Attachment

Inspect the blower and bagger attachment after the first ten hours of operation, and monthly thereafter.

1. Check the discharge tube, elbow, and the bagger top. Replace these parts if they are cracked or broken.
2. Tighten all nuts bolts and screws.
3. Inspect the grass bags for deterioration.

### DANGER

#### POTENTIAL HAZARD

- The grass bag material may tear, wear, and eventually deteriorate.

#### WHAT CAN HAPPEN

- You or bystanders could be severely injured by flying debris or thrown objects that may pass through worn or deteriorated grass bags.

#### HOW TO AVOID THE HAZARD

- Frequently check the grass bags for holes, rips, wear, and other deterioration. Do not wash the grass bags. If the bag has deteriorated, install new grass bags supplied by the manufacturer of this bagger attachment.

## Inspecting the Mower Blades

1. Inspect the mower blades regularly and whenever a blade strikes a foreign object.
2. If blades are badly worn or damaged, install new blades. Refer to your tractor or mower operator's manual for complete blade maintenance.

## Caring for the Grass Bags

1. Washing the grass bags is not recommended.
2. To prevent rapid deterioration of bag material, store the bags so they dry completely after each use.

### CAUTION

#### POTENTIAL HAZARD

- If you store grass clippings in the bagger attachment cloth grass bags, under the right conditions, spontaneous combustion (a fire-generating process that occurs without an external source of ignition) could occur.

#### WHAT CAN HAPPEN

- If a fire occurs, property could be damaged and/or someone could be injured.

#### HOW TO AVOID THE HAZARD

- The cloth grass bags are not storage containers. Never store grass clippings and debris in the grass bags.

## Cleaning the Vac Bagger Attachment

1. After each use, remove and wash the inside and outside of the bagger top, discharge tube, discharge elbow, blower and the underside of the mower, using water sprayed from a garden hose. Use a mild automotive detergent to remove stubborn dirt.
2. Make sure you remove matted grass from all parts.
3. After washing let all parts dry thoroughly. Do not wash the grass bags.

## **Storage**

1. Clean the bagger attachment (refer to Cleaning the Vac Bagger Attachment, page 23).
2. Inspect the bagger attachment for damage (refer to Inspecting the Vac Bagger Attachment, page 23).
3. Make sure the grass bags are empty and thoroughly dry.
4. Store the machine in a clean, dry place, out of direct sunlight. This protects the plastic parts and extends the life of the machine. If you must store the machine outside, cover it with a weatherproof cover.



