



42'' Vac Bagger

for ZRT

Model No. 79401 - 6900001 & up

Operator's Manual

IMPORTANT: Read this manual carefully. It contains information about your safety and the safety of others. Also become familiar with the controls and their proper use before you operate the product.

Safety and Instruction Decals

The following safety and instruction decals are affixed to the bagger unit. If any decal becomes illegible or damaged, install a new decal. Part numbers are listed below. Order replacements from your authorized TORO dealer.



ON THE INSIDE BAGGER HINGE FRAME
(Part No. 79-7410)



MOLDED INTO THE BLOWER HOUSING



ON THE INNER SHIELD
(Part No. 79-7610)



MOLDED INTO THE THE BELT COVER



MOLDED INTO THE BELT COVER



ON THE BAGGER COVER
(Part No. 79-3970)

Model Number

Your TORO bagging attachment has a decal listing its model and serial number. This decal is on the inside of the bagger's top assembly. Always refer to the model number when consulting with your dealer or the factory about service, replacement parts, or questions you may have. For your reference, record the number on the lines below.

Model No. _____

Serial No. _____

Setup

Prepare the mower according to the instructions under *Mower Preparation*, page 6, steps 1–4.

Install the Grass Baffle

1. Remove the hex-head bolt and nut at the end of the grass plate (on the inside of the mower) near the back edge of the discharge opening. Do not use the bolt and nut again.
2. Install the grass baffle on the inside of the mower, using a $\frac{3}{8}$ " x 1" hex-head bolt and $\frac{3}{8}$ " nylon lock nut in the hole closest to the discharge opening (Fig. 1). Be sure the grass baffle is tight against the underside of the mower.
3. Rotate the blade to assure it does not hit the baffle. Adjust the baffle if the blade hits it.

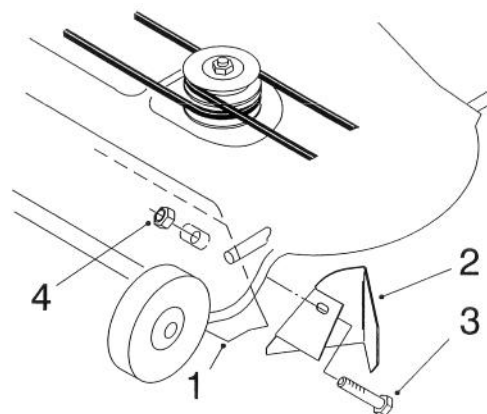

Figure 1

- | | |
|-----------------|--|
| 1. Grass plate | 3. Hex-head bolt ($\frac{3}{8}$ " x 1") |
| 2. Grass baffle | 4. Nylon lock nut ($\frac{3}{8}$ ") |

Mount the Blower Pivot Support

1. Slide the pivot support onto the threaded rod that is welded onto the front of the mower near the discharge opening (Fig. 2).

Note: The pivot support has one hole for mounting it to a 42" mower and a different hole for a 48" mower (Fig. 2). Use the hole for a 42" mower for this installation.

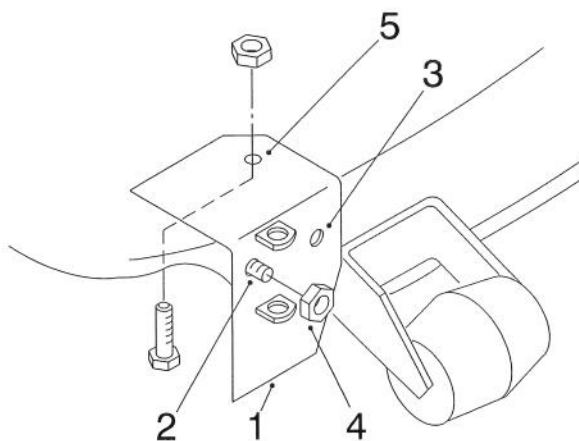

Figure 2

- | | |
|---------------------------------------|-------------------------|
| 1. Pivot support | 4. Jam nut |
| 2. Hole for 42"Y mower | 5. 11/32" diameter hole |
| 3. Hole for other mowers (do not use) | |

2. Screw the $\frac{3}{8}$ " deflector jam nut (Fig. 2) onto the threaded rod until the nut is flush with the end of the rod.
3. Push the vertical side (front) of the pivot support against the front of the mower and clamp it snugly, making sure the top of the pivot support lies flat on the top of the mower.
4. Drill an $1\frac{1}{32}$ " diameter hole in the mower, using the hole in the pivot support as a template (Fig. 2). Remove the clamp after you drill the hole.
5. Secure the pivot support to the top of the mower using a $\frac{5}{16}$ " x $\frac{3}{4}$ " hex-head bolt (from the underside of the mower) and a $\frac{5}{16}$ " hex-head flange nut.

Assemble the Blower

1. Install the blower mounting plate assembly to the blower housing using three $\frac{5}{16}$ " x $\frac{3}{4}$ " carriage bolts and $\frac{5}{16}$ " hex-head flange nuts (Fig. 3).

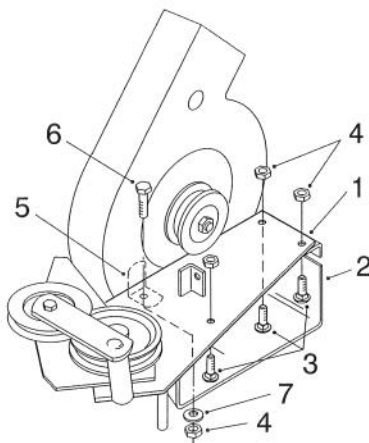

Figure 3

- | | |
|---|---|
| 1. Blower mounting plate | 5. L-Shaped bracket |
| 2. Blower housing | 6. Hex-head bolt ($\frac{5}{16}$ " x 1") |
| 3. Carriage bolts($\frac{5}{16}$ "x $\frac{3}{4}$ ") | 7. Flat washer($\frac{5}{16}$ ") |
| 4. Hex-head flange nuts ($\frac{5}{16}$ ") | |

2. Install the L-Shaped support bracket inside the blower housing using a $\frac{5}{16}$ " x 1" hex-head bolt, $\frac{5}{16}$ " flat washer and $\frac{5}{16}$ " hex-head flange nut (Fig 3). Do not tighten the flange nut.
3. Pull the L-shaped support bracket up tightly against the inside wall of the blower housing and tighten the flange nut (Fig. 3).

4. Insert a #10 x $\frac{3}{4}$ " screw through the extended loop at the end of the tension spring (Fig. 4). Screw one #10 nut to within $\frac{1}{8}$ inch (3.2 mm) from the screw head, allowing the spring to pivot freely (Fig. 4).

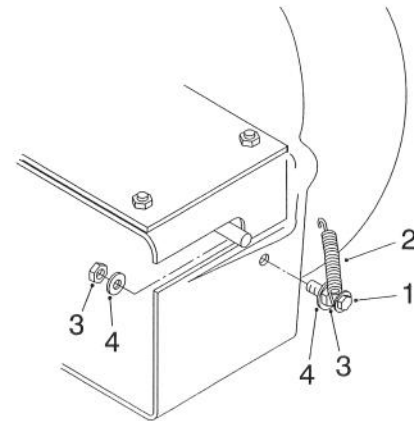

Figure 4

- | | |
|----------------------------------|------------------------------------|
| 1. Screw (#10 x $\frac{3}{4}$ ") | 3. Nut (#10) |
| 2. Spring | 4. Flat washer ($\frac{7}{32}$ ") |

5. Slide one $\frac{7}{32}$ " flat washer onto the spring and screw assembly (Fig. 4). Insert the screw through the hole in the blower housing from the outside and secure it in place with another flat washer and nut (Fig. 4). Tighten the nut.
6. To install the latch, hook the end of the spring in the small hole in the latch. Slide the $\frac{1}{4}$ " x $\frac{3}{4}$ " hex-head bolt through the latch and the hole in the blower housing. Secure it in place with a $\frac{1}{4}$ " washer and $\frac{1}{4}$ " nylon lock nut (Fig. 5), but make sure the latch pivots freely.

Mount the Blower to the Mower

Refer to the instructions under *Mount the Blower to the Mower*, page 6.

Install the Belt Covers

Refer to the instructions under *Install the Belt Covers*, page 7.

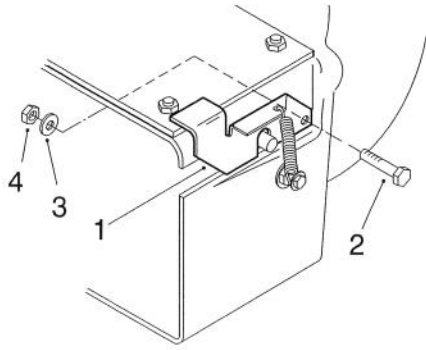

Figure 5

- | | |
|--------------------------------|--------------------------|
| 1. Latch | 3. Flat washer (1/4") |
| 2. Hex-head bolt (1/4" x 3/4") | 4. Nylon lock nut (1/4") |

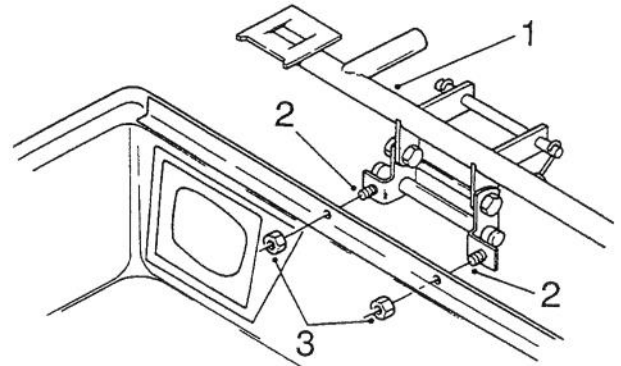

Figure 7

- | | |
|--------------------------------|--------------------------|
| 1. Frame & hinge assembly | 3. Nylon lock nut (1/4") |
| 2. Hex-head bolt (1/4" x 3/4") | |

Assemble the Bagger

1. Install the "full-bag" indicator rod through the hole in the rubber seal and the slot in the bagger cover (Fig. 6). Mount the full-bag indicator rod against the bagger cover using two clips, 1/4" x 5/8" pan-head screws, and 1/4" nylon lock nuts (Fig. 6).
2. Screw the jam nut completely onto the indicator rod (Fig. 6). Then screw the handle (Fig. 6) close to the jam nut so you can read the decal from the operator's position. Tighten the jam nut up against the handle to lock it in place.

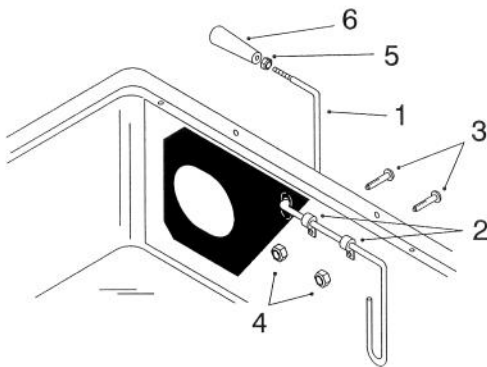

Figure 6

- | | |
|-----------------------------|--------------------------|
| 1. "Full-bag" indicator rod | 4. Nylon lock nut (1/4") |
| 2. Clips | 5. Jam nut |
| 3. Pan-head screw | 6. Handle |

3. Mount the frame and hinge assembly to the bagger top (Fig. 7) using two 1/4" x 3/4" bolts (already installed on the hinge assembly) and two 1/4" nylon lock nuts.

Install the Bagger Assembly

Refer to the instructions under *Install the Bagger Assembly*, page 8.

Install the Discharge Tube

1. Insert the upper end of the discharge tube into the bagger cover. Slide the lower end of the discharge tube over the blower discharge opening.
2. Hook the rubber latch onto the knob (Fig. 8).

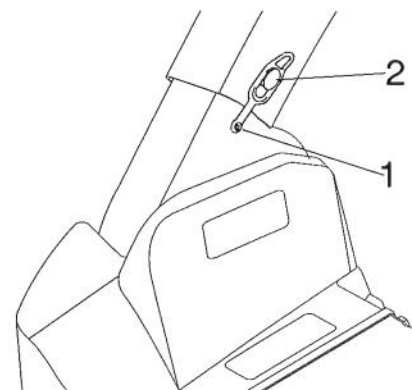

Figure 8

- | |
|-----------------|
| 1. Rubber latch |
| 2. Knob |

Installing the Blower onto the Cutting Unit

DANGER

Serious Injury Can Result Unless Front Weights Are Attached!

The Z118 or 600-Series ZRT Rider require that front weights be installed on the rider before attaching the bagger. The rider and bagger must never be operated without front weights installed.

Mower Preparation

1. Lower the mower to its lowest position and engage the parking brake.
2. Remove the grass deflector and belt cover from the mower (Fig. 9). Save both the deflector and the belt cover for use if you remove the bagger later and want to discharge grass to the side.

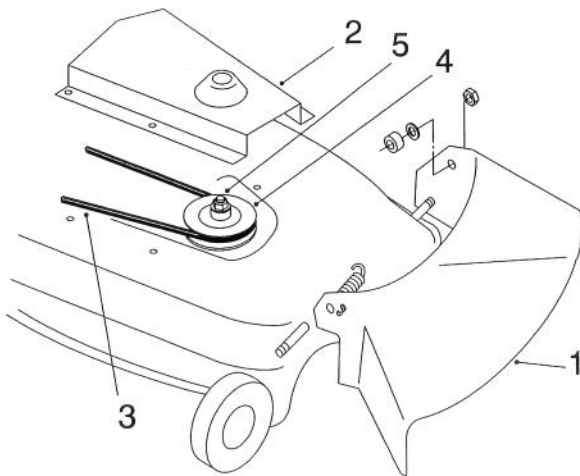

Figure 9

- | | |
|---------------------|---------------------------------|
| 1. Grass deflector | 4. Pulley |
| 2. Belt cover | 5. Pulley nut and washer (5/8") |
| 3. Mower drive belt | |

3. Remove the $\frac{5}{8}$ " pulley nut. Block the blade with a piece of wood or some other device to stop it from turning while you remove the pulley nut.

Service Tip: If you cannot loosen the pulley nut because the blade slips, remove the blade. Then hold

the hex portion of the spindle and continue removing the pulley nut. However, when you remove the nut, the spindle shaft is free to drop out of the spindle.

Note: Leave the pulley and lock washer on the spindle shaft. Save the $\frac{5}{8}$ " pulley nut because you must install it if you use the mower to side discharge.

4. Screw the new pulley onto the pulley shaft making sure the hex-head nut side is facing up. Tighten the nut to 60-80 ft-lb. (Fig. 10).

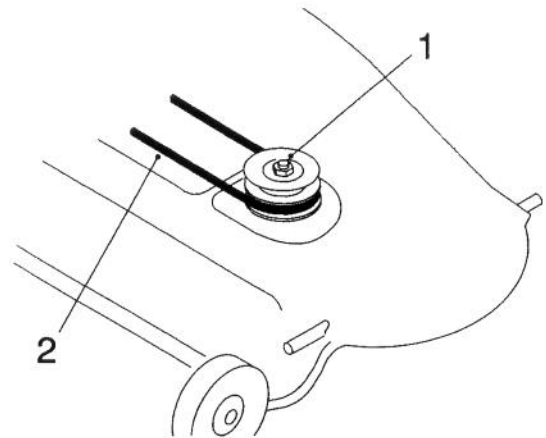

Figure 10

1. New pulley (note hex nut) 2. Mower belt

Mount the Blower to the Mower

1. Install the blower assembly by inserting the pivot pin into the blower pivot support (Fig. 11).
2. Install the blower belt onto the upper pulley, leaving the other end loose (Fig. 12).
3. With the blower swung out in the open position, install the blower belt between the idler pulley bracket and pulley. Then loop it around the remaining pulleys (Fig. 13).

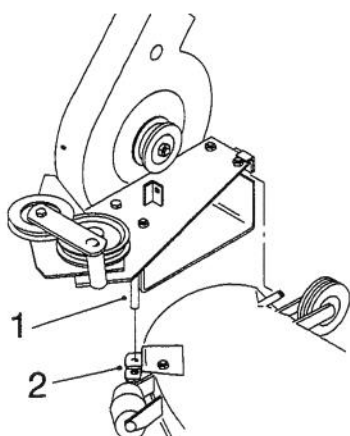

Figure 11

1. Pivot pin 2. Pivot support

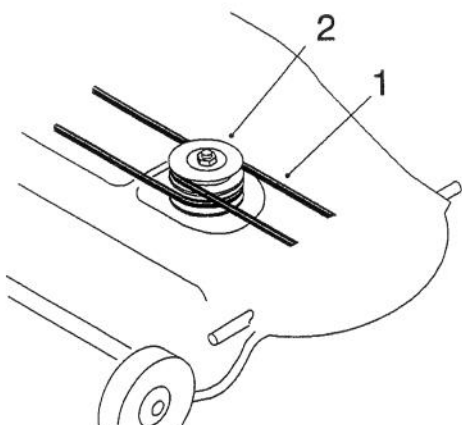

Figure 12

1. Blower belt 2. upper pulley

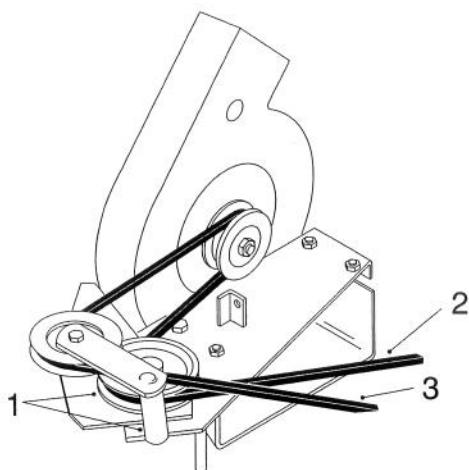

Figure 13

1. Idler pulley bracket and pulley
2. Top side of belt against bottom pulley
3. V-side of belt into top pulley

4. With the belt installed, swing the blower toward the mower until the blower latch locks over the pin at the back of the mower (Fig. 14).

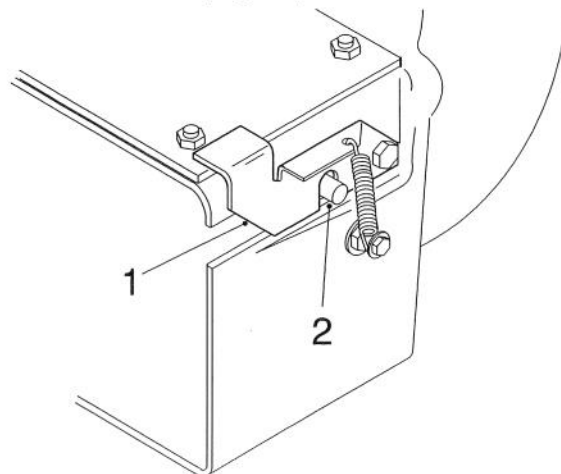

Figure 14

1. Blower latch 2. Pin

Install the Belt Covers

1. Install the mower belt-cover bracket (Fig. 15). Mount the belt-cover bracket using two $\frac{1}{4}$ " x $\frac{1}{2}$ " thread-forming hex-head flange screws in the same holes that the original cover used.

Note: Be sure the flange screws are centered in the slot in the bracket when you tighten them.

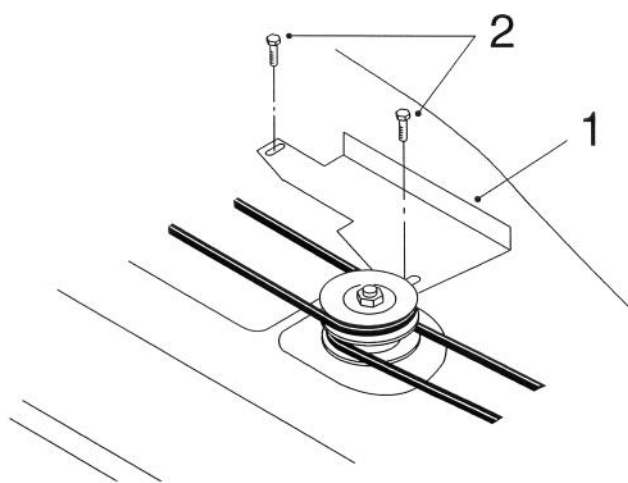

Figure 15

1. Belt-cover bracket
2. Thread-forming hex-head flange screw ($\frac{1}{4}$ " x $\frac{1}{2}$ ")

2. Mount the mower belt cover (Fig. 16) loosely on the outside of the mower belt-cover bracket using four $\frac{1}{4}$ " x $\frac{1}{2}$ " thread-forming hex-head flange screws. Do not tighten the screws because an adjustment is made in the next step.

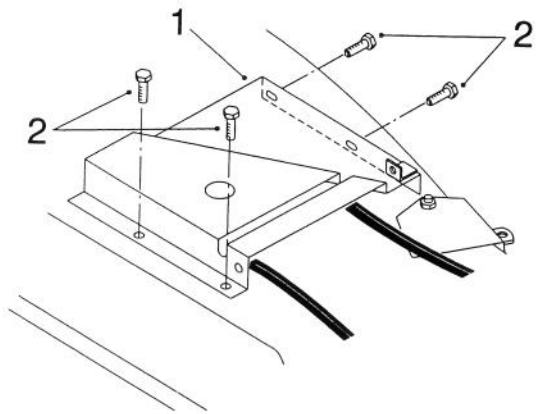

Figure 16

1. Mower belt cover
2. Thread forming hex-head flange screw ($\frac{1}{4}$ " x $\frac{1}{2}$ ")

3. Raise the mower to its highest position to make sure the bottom of the rider's running board fits into the slot in the mower belt cover (Fig. 17). Tighten the belt-cover screws.

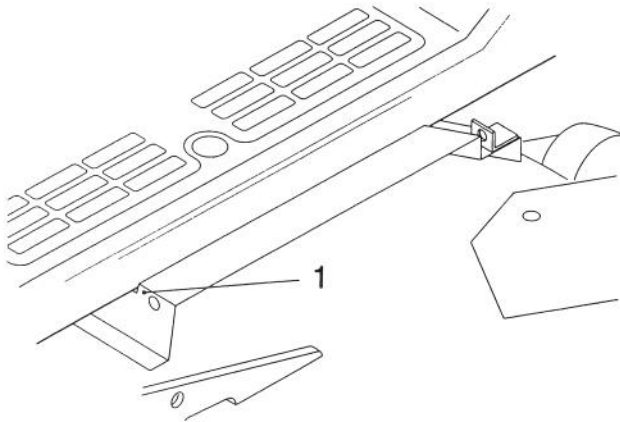

Figure 17

1. Running board fits into the rider belt cover slot.

4. Install the blower belt cover.

- a. Insert a $\frac{1}{4}$ " x $1\frac{1}{2}$ " hex-head bolt through the right-hand side of the blower cover. Thread a regular nut onto the bolt about $\frac{3}{8}$ " (1 cm) from

the end. Push the bolt through the hinge clip hole and install the nylon lock nut so one thread protrudes through the nut (Fig. 18). Then tighten the regular nut against the clip.

- b. Mount the left-hand side of the blower belt cover to the mower belt cover using a $\frac{1}{4}$ " x $\frac{5}{8}$ " bolt and $\frac{1}{4}$ " nylon lock nut (Fig. 18). Tighten the lock nut until you feel a slight drag on the cover when you rotate it.

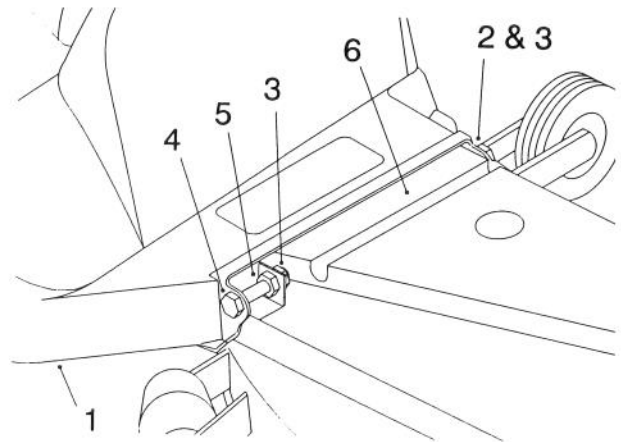

Figure 18

1. Blower belt cover
2. $\frac{1}{4}$ " x $\frac{5}{8}$ " bolt
3. $\frac{1}{4}$ " nylon lock nut
4. $\frac{1}{4}$ " x $1\frac{1}{2}$ " bolt
5. $\frac{1}{4}$ " regular nut
6. Mower belt cover

Install the Bagger Assembly

1. Remove the rear hitch from the rider if it has one.
 - Pull the hairpin cotter from the keeper pins on the latches of the rider frame.
 - Remove the keeper pins from the latches on the rider frame, then turn the latches up.
2. Find the pilot pin on the back end of the rider (in the center on the inside of the rider frame) and slide the hole in the center of the quick-attach bracket onto the pin (Fig 19).
 - Pull back on the quick-attach bracket until the bottom ends slide into the notches on the side of the rider frame (Fig. 19).
 - Lock it in position by pulling the latches down

(Fig. 20). Install the keeper pins and hairpin cotters.

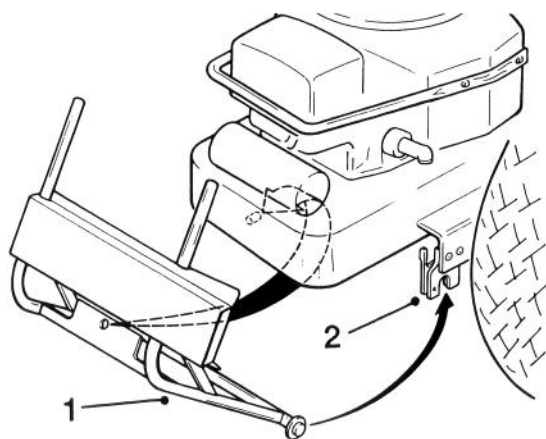

Figure 19

1. Quick-attach bracket 2. Attachment latches

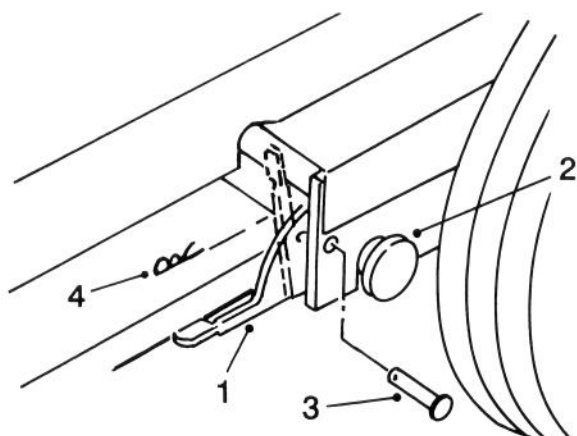

Figure 20

1. Latch 3. Keeper pin
2. Quick-attach bracket 4. Hairpin cotter

3. Tilt the rider seat forward. Slide the bagger top on to the quick-attach bracket (Fig. 21).
4. Slide the bag frame hook onto the retaining bracket (Fig. 22).
5. Close the bagger top and push down on both bag retainer handles until they lock on the bag frame.

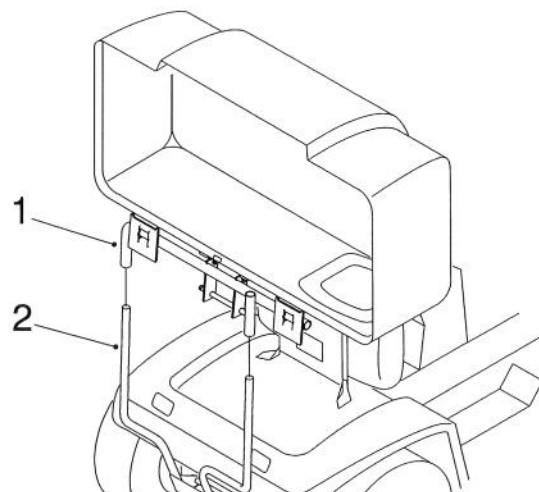

Figure 21

1. Bagger top 2. Quick-attach bracket

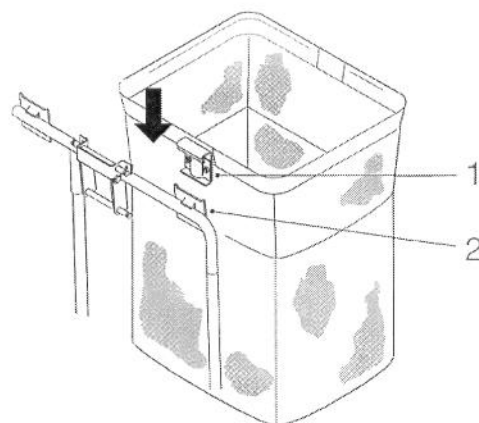

Figure 22

1. Bag frame hook 2. Retaining bracket

Mount The Discharge Tube

1. Insert the upper end of the discharge tube into the bagger top. Slide the lower end of the discharge tube over the blower discharge opening (Fig. 23).
2. Hook the rubber latch onto the knob (Fig. 23).

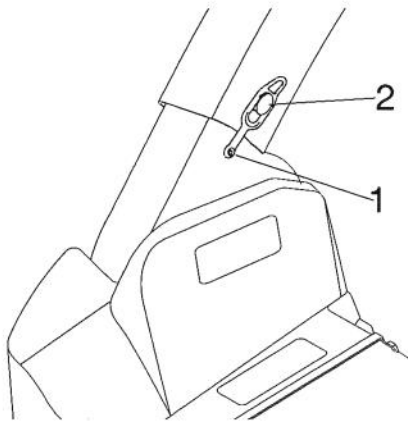

Figure 23

1. Rubber latch

2. Knob

Operation

⚠ CAUTION

To Avoid Personal Injury:

- Become familiar with all operating instructions and safety suggestions in the operator's manuals for your tractor and mower before operating this equipment.
- **Never** do maintenance or repairs while the engine is running.
- **Never** remove the discharge tube, bagger top or grass bags while the engine is running.
- Shut off the engine before unclogging the discharge tube.
- **Never** operate the mower with the bagger removed and the grass deflector off. Always replace the grass deflector and belt cover, if operating without the bagger, to avoid personal injury.

⚠ DANGER

Serious Injury Can Result Unless Front Weights Are Attached!

The Z118 or 600-Series ZRT Rider require that front weights be installed on the rider before attaching the bagger. The rider and bagger must never be operated without front weights installed.

OPERATING TIPS

1. **Size.** Remember that the rider is made longer and wider with this attachment, so be sure to avoid sharp turns in confined places.
2. **Trimming.** Trim with the left side of the mower. Trimming with the right side of the mower can damage the blower and discharge tube.
3. **Speed.** Generally you can operate the bagger at normal mowing speed. Because of the extra power required to drive the blower, sometimes it may be necessary to reduce the rider's ground speed to keep the engine running smoothly at maximum rpm. When mowing uphill, reduce the rider's ground speed by at

least one gear. This will help avoid a large power drop and loss of blower efficiency. When practical, set up a mowing pattern that will permit as much downhill mowing as possible.

CAUTION

Quick stops or starts on hills can tip tractors!

Do not stop or start suddenly when going uphill or downhill. Avoid uphill starts. If the tractor is stopped going up a slope, turn the attachment off and back slowly down the slope, keeping the machine in gear. Do not stop or change gears (speed) on slopes.

4. **Grass Bags Full.** Lift the "full-bag" indicator rod periodically to check if the grass bags are becoming full. The left bag will normally fill first. Then, as the right bag fills, you will feel resistance when you lift the full-bag indicator rod. During operation, a small amount of grass clippings will be blown out the front of the mower. When this flow increases, it is also an indication that the grass bags are full.

IMPORTANT: If suction action or pick-up should stop during use, disengage the mower and shut off the engine. Check for full grass bags or a clogged discharge tube, mower or blower. Always empty bags when filled and after each use.

CAUTION

Rotating parts or debris from the blower or bagger can cause injury!

Never operate the bagger without the discharge tube and bags installed.

CAUTION

Grass stored in bags can cause fires!

Grass bags are not storage containers. Never leave fresh grass clippings or other organic matter in bags for any length of time. Under the right conditions, spontaneous combustion (a fire-generating process that occurs without an external source of ignition) can occur with this type of material.

Grass bags can weigh up to 90 lb. (41 kg) when full. Use care when removing or handling a filled grass bag.

5. **Emptying the Bags.** Raise the seat of the rider and release both bagger top latches. Raise the bagger top and gently compress debris into the bags. With both hands, lift up on one of the bags to release it from the frame hook. Dispose of debris and reinstall the bag. Repeat for the other bag.

Plastic liners may be inserted in grass bags for more convenient grass clipping disposal. If you use a plastic liner, remove the bag and tie the top of the liner. Pull the liner out of the bag or turn the bag upside down while holding the web handle on the bottom of the bag to allow the filled liner to slide out.

REMOVING THE BAGGER

WARNING

Operating Without The Grass Deflector Can Lead to Serious Injury!

Install the original grass deflector, belt, pulley and belt cover if you operate the mower without the bagger attachment.

Maintenance

1. **Inspect the bagger.** After the first 10 hours of operation, check that all parts of the bagger and all fasteners are tight and in good condition. Pay special attention to the condition of the discharge tube and top—replace these parts if they are cracked or broken.

IMPORTANT: Check grass bags often for wear and deterioration. Always replace damaged or torn bags with TORO bags.

2. **Washing.** After use, remove and wash the bagger top and discharge tube with a garden hose. Use a mild automotive detergent to remove stubborn dirt. After washing, let all parts dry thoroughly.

IMPORTANT: Remove bags and check the elbow and underside of the mower after use and clean as necessary. Matted grass in these areas can seriously affect cutting performance.

3. **Grass Bags.** Store bags in a way that will insure complete drying after use. Keeping grass bags dry will help prevent deterioration of bag material and add to the useful life of bags. Washing bags is not recommended.

4. **Blades.** Inspect blades at specified intervals, and whenever a blade strikes a foreign object. If blades are badly worn, install new blades.

5. **Storage.** Before storing the attachment, clean it thoroughly and let it dry. Store the bagger in a clean, dry place, out of direct sunlight. This will protect the plastic parts and extend the life of the bagger. Use a weatherproof cover if storing the equipment outside.

6. **Blower impeller and housing.** Check the impeller and blower housing frequently, especially in sandy areas. Replace all worn parts.

If a foreign object is hit or gets in the blower, stop the engine immediately and inspect for damage. Immediately repair all damage related to safety and mechanical operation.