



Manual Drag Mat Kit

Sand Pro®/Infield Pro® 3040 and 5040 Traction Unit with QAS Nail Drag

Model No. 130-7852

Installation Instructions

⚠ WARNING

CALIFORNIA Proposition 65 Warning

This product contains a chemical or chemicals known to the State of California to cause cancer, birth defects, or reproductive harm.

Loose Parts

Use the chart below to verify that all parts have been shipped.

Description	Qty.	Use
Cradle	1	Install the cradle.
Bolt (3/8 x 1-1/2 inches)	2	
Flange nut (3/8 inch)	2	
Drag mat	1	Install the drag mat to a machine with only the nail drag.
Mat bracket	2	
Chain (short)	1	
Chain sleeve (short)	1	
Chain (long)	1	
Chain sleeve (long)	1	
Screw (5/16 x 1 inch)	7	
Locknut (5/16 inch)	8	
Shackle	1	
Bolt (5/16 x 4-1/4 inches)	1	
Washer	2	
Spacer	2	
Drag mat	1	Install the drag mat to a machine with both the nail drag and the flex groomer kit.
Mat bracket	2	
Chain (short)	2	
Chain sleeve (short)	2	
Chain (long)	2	
Chain sleeve (long)	2	
Screw (5/16 x 1 inch)	10	
Locknut (5/16 inch)	10	
Washer	4	



Installing the Cradle

1. Remove and discard the nut and the bolt securing the lynch pin to the adapter assembly of the nail drag (Figure 1).

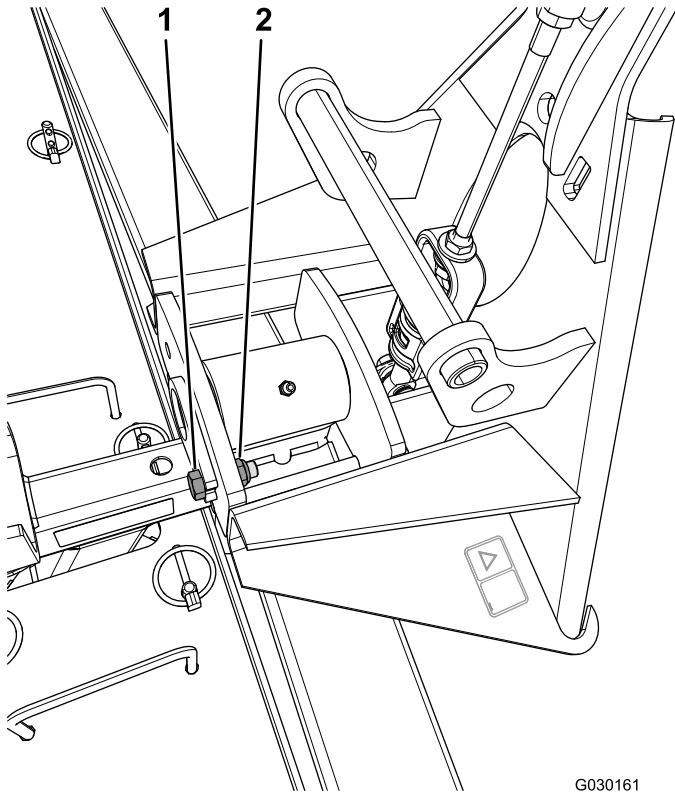

Figure 1

1. Bolt
2. Nut

2. Install the cradle onto the adapter assembly and secure it with 2 bolts ($\frac{3}{8}$ x 1-1/2 inches) and 2 flange nuts ($\frac{3}{8}$ inch) as shown in Figure 2.

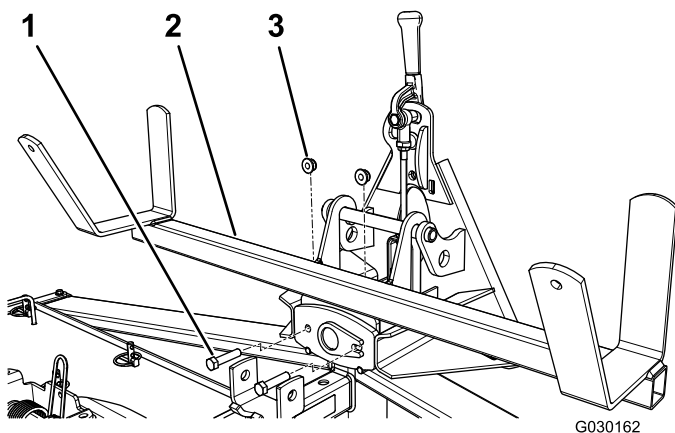

Figure 2

1. Bolt (2)— $\frac{3}{8}$ x 1-1/2 inches
2. Cradle
3. Flange nut (2)— $\frac{3}{8}$ inch

Installing the Drag Mat to a Machine with Only the Nail Drag

Assembling the Drag Mat

A machine that has the nail drag, but not the flex groomer kit, requires only 1 chain in the center of the drag mat (Figure 3).

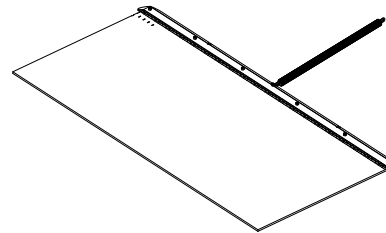

Figure 3
1 chain

1. Slide a chain sleeve over a chain.

Note: You can use either a long chain or a short chain. Use a long chain sleeve with a long chain and a short chain sleeve with a short chain.

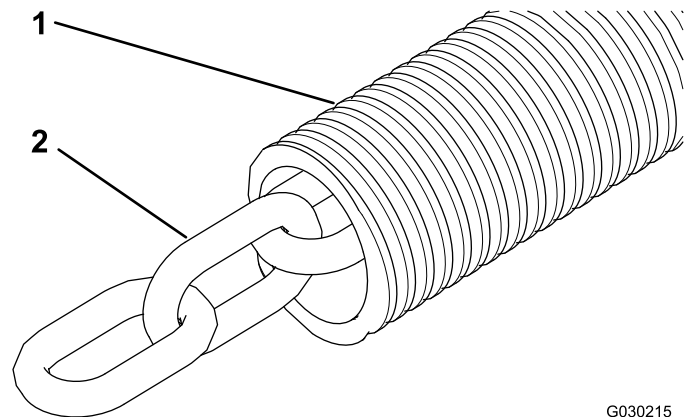

Figure 4

1. Chain sleeve
2. Chain

2. Loosely install the mat brackets to the edge of the drag mat with 6 screws ($\frac{5}{16}$ x 1 inch) and 6 locknuts ($\frac{5}{16}$ inch) as shown in Figure 5.

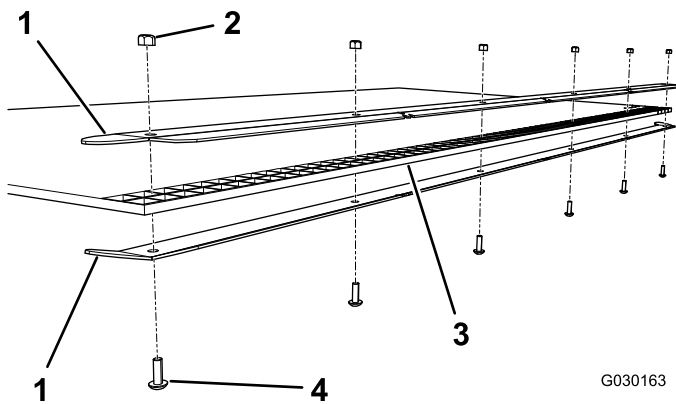

Figure 5

- | | |
|--------------------------|----------------------------|
| 1. Mat bracket | 3. Drag mat |
| 2. Locknut (6)—5/16 inch | 4. Screw (6)—5/16 x 1 inch |

3. Install the chain between the brackets on the drag mat with a screw (5/16 x 1 inch) and a locknut (5/16 inch) as shown in [Figure 6](#).

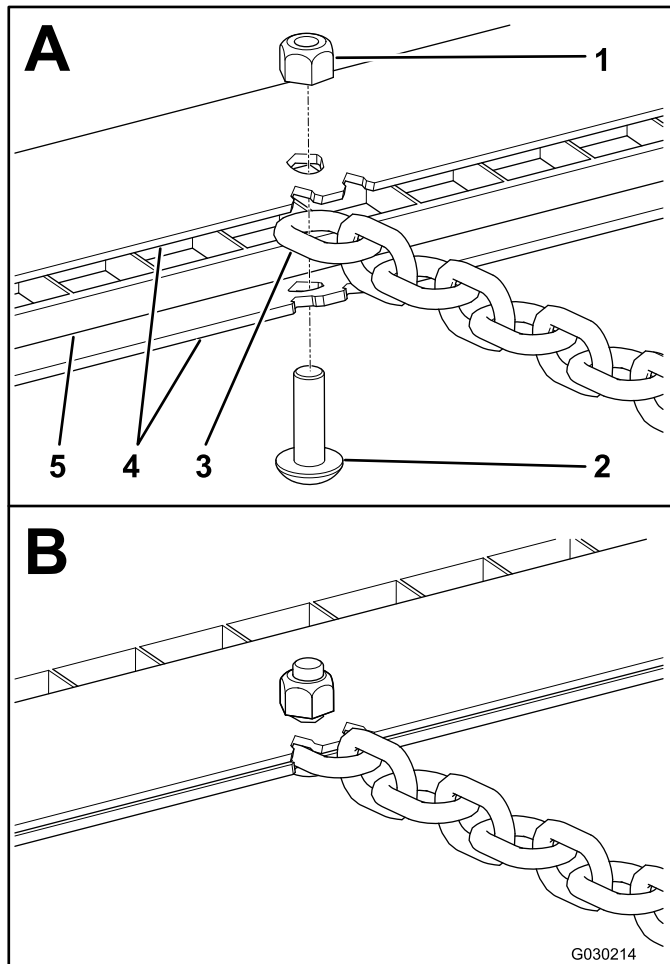

Figure 6

- | | |
|--------------------------|-----------------|
| 1. Locknut (5/16 inch) | 4. Mat brackets |
| 2. Screw (5/16 x 1 inch) | 5. Drag mat |
| 3. Chain | |

4. Tighten the fasteners.

Connecting the Chain to the Nail Drag

Attach the loose end of the chain to the bracket in the center of the nail drag with the shackle, the long bolt (5/16 x 4-1/4 inches), 2 washers, 2 spacers, and a locknut (5/16 inch); refer to [Figure 7](#).

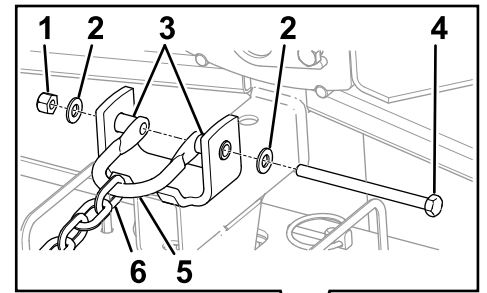

Figure 7

- | | |
|------------------------|-------------------------------|
| 1. Locknut (5/16 inch) | 4. Bolt (5/16 x 4-1/2 inches) |
| 2. Washer | 5. Shackle |
| 3. Spacers | 6. Chain |

Installing the Drag Mat to a Machine with Both the Nail Drag and the Flex Groomer Kit

Assembling the Drag Mat

A machine that has both the nail drag and the flex groomer kit requires 2 chains for the drag mat ([Figure 8](#)).

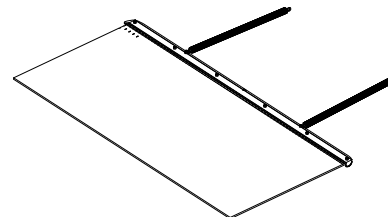

Figure 8
2 chains

1. Slide the chain sleeves over the chains ([Figure 4](#)).

Note: You can use either the long chains or the short chains. Use the long chain sleeves with the long chains and the short chain sleeves with the short chains.

2. Loosely install the mat brackets to the edge of the drag mat with 6 screws (5/16 x 1 inch) and 6 locknuts (5/16 inch) as shown in [Figure 5](#).
3. Install each chain between the brackets on the drag mat with a screw (5/16 x 1 inch) and a locknut (5/16 inch) as shown in [Figure 6](#).
4. Tighten the fasteners.

Connecting the Chains to the Flex Groomer Kit

Attach the loose end of each chain to a bracket on the flex groomer kit with a screw (5/16 x 1 inch), 2 washers, and a locknut (5/16 inch); refer to [Figure 9](#).

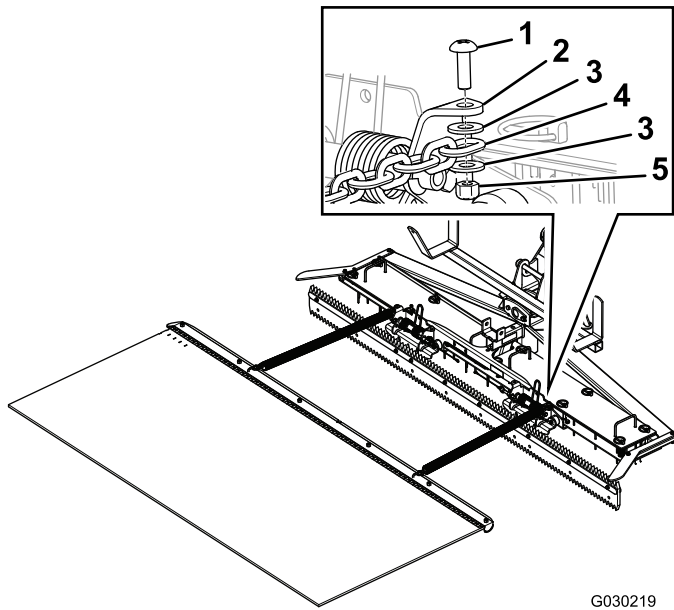

Figure 9

- | | |
|--------------------------|------------------------|
| 1. Screw (5/16 x 1 inch) | 4. Chain |
| 2. Bracket (on groomer) | 5. Locknut (5/16 inch) |
| 3. Washer | |

the wheels in reverse may catch the mat underneath them and damage the mat. Also, the nails from the nail drag may damage the mat.

Note: Use caution while operating the machine with the drag mat attached. Drive slowly. For maximum mat life, avoid areas and objects that can snag or interrupt the travel of the mat.

Note: Before you store or transport the machine, stow the drag mat in the cradle.

1. With the drag mat stowed in the cradle, drive the machine to an area that requires grooming.
2. Remove the drag mat from the cradle, and place it on the ground.
3. Pull the drag mat over the surface that requires grooming.
4. When you have finished or are ready to groom a different area, stow the drag mat in the cradle.

Cleaning the Drag Mat

Keep the drag mat clean. Excessive soil buildup increases the attachment weight and may affect the handling of the machine.

Operation

Stowing the Drag Mat

Whenever you are not using the drag mat, stow it in the cradle.

To stow the drag mat, roll it up and place it in the cradle.

Using the Drag Mat

Important: Do not drive the machine backward when the drag mat is connected and on the ground; otherwise,