



50mm or 2in Ball Hitch Receiver Kit

GreensPro™ 1240 Greens Roller

Model No. 44925

Model No. 44926

Installation Instructions

▲ WARNING

CALIFORNIA Proposition 65 Warning

This product contains a chemical or chemicals known to the State of California to cause cancer, birth defects, or reproductive harm.

Installing the Hitch

1. Remove the bolts, washers, and locknuts securing the existing hitch, and remove the hitch (Figure 1).

Note: Retain the hardware for installing the new hitch. If your machine has spacer washers (Figure 2), ensure that you retain those, and use them for installing the new hitch as well.

2. Align the holes in the new hitch with the holes in the hitch bracket of the machine.

Note: Use the holes in the hitch bracket to match the height of the tow vehicle hitch.

3. Secure the new hitch with the existing bolts, washers, and locknuts as shown.

Note: Torque the M12 (rear) bolt to 171 N-m (126 ft-lb).

Torque the M10 (front) bolt to 73 N-m (54 ft-lb).

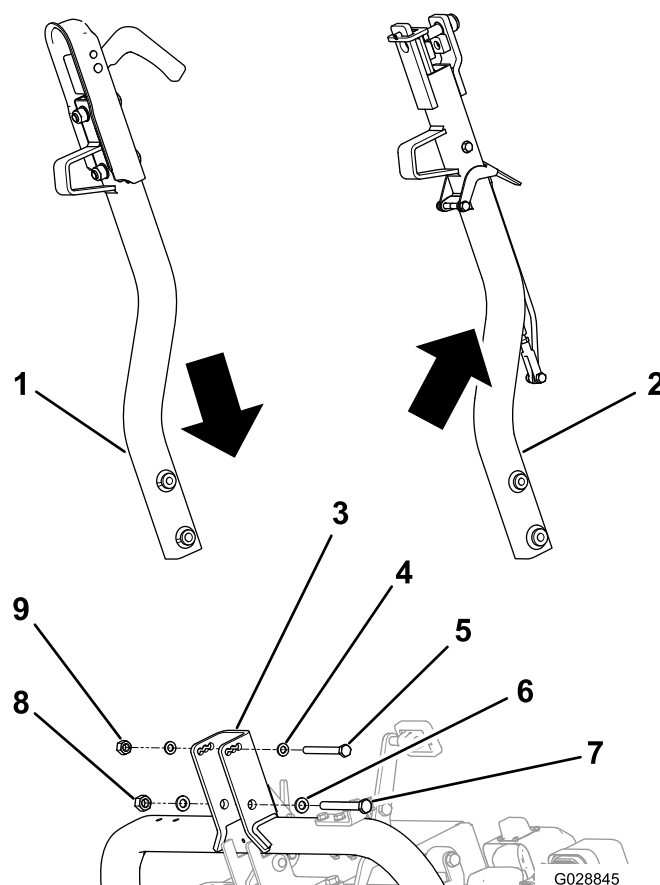

Figure 1

- | | |
|------------------|-----------------|
| 1. New hitch | 6. Washer (M12) |
| 2. Old hitch | 7. Bolt (M12) |
| 3. Hitch bracket | 8. Nut (M12) |
| 4. Washer (M10) | 9. Nut (M10) |
| 5. Bolt (M10) | |



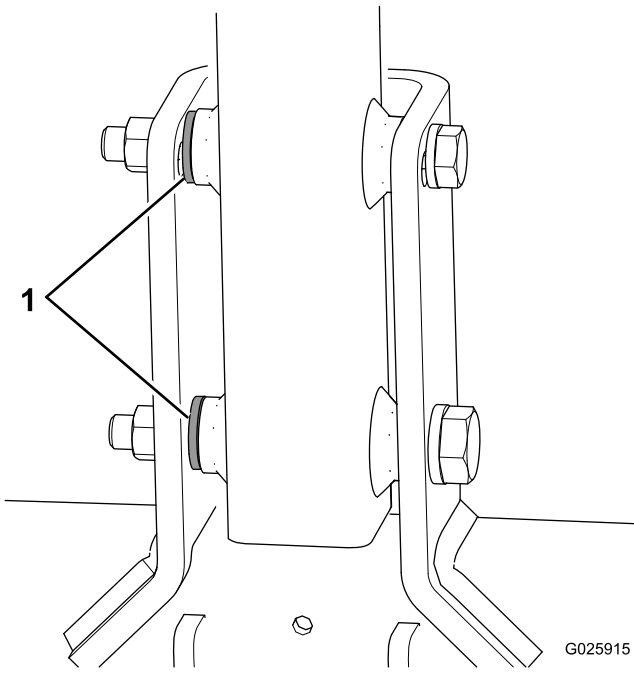

Figure 2

-
1. Spacer washers (use if present in original assembly)