



Cutter-Motor Drain-Line Kit for TM5490 or TM7490 Trailed Mower

Model No. 111-8083

Form No. 3394-515 Rev A

Installation Instructions

This kit is for TM5490 or TM7490 trailed mowers with serial number 310000001 and up. It reroutes the cutter-motor drain-line directly back to the tank to prepare for potential cutter motor replacements.

Before installing this kit, refer to your machine's *Operator's Manual* for safety instructions and the product overview.

Important: If after reading these instructions you are still unsure of how to install this kit, contact your Authorized Toro Dealer for help.

Installation

1

Installing the Front Tee Assembly

Parts needed for this procedure:

1	1/4-inch tee
1	1/4-inch to 3/8-inch adaptor
1	1/4-inch swivel tee
1	1/4-inch cross adaptor
4	Blanking caps
1	3/8-inch hose
1	Cable tie

Procedure

1. Lower the cutting units, stop the engine, remove the key, and ensure that there is no remaining pressure in the hydraulic circuit.
2. Assemble the front tee assemblies as shown in [Figure 1](#) or [Figure 2](#).

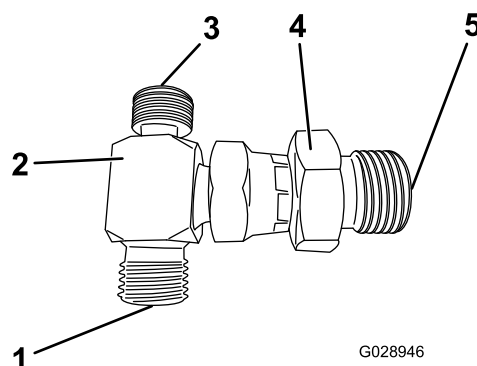

Figure 1
TM5490

- | | |
|-------------------------------------|---------------------------------|
| 1. To the front, left cutting unit | 4. 1/4-inch to 3/8-inch adaptor |
| 2. 1/4-inch tee | 5. To the 3/8-inch hose |
| 3. To the front, right cutting unit | |

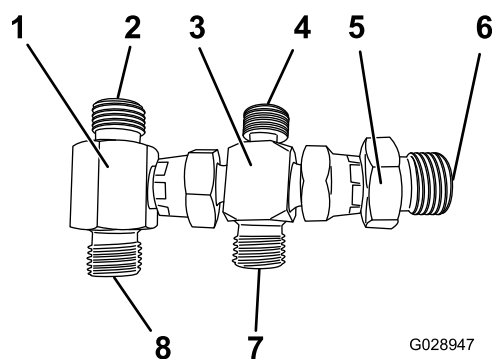

Figure 2
TM7490

- | | |
|--------------------------------------|-------------------------------------|
| 1. 1/4-inch swivel tee | 5. 1/4-inch to 3/8-inch adaptor |
| 2. To the front, right cutting unit | 6. To the 3/8-inch hose |
| 3. 1/4-inch cross adaptor | 7. To the left, center cutting unit |
| 4. To the right, center cutting unit | 8. To the front, left cutting unit |



3. Remove the return filter cap to let air in and then loosely attach it.
4. Note the location of the front-motor drain hoses attached to the manifold and remove them.
5. Insert blanking caps into the holes in the manifold ([Figure 3](#)).

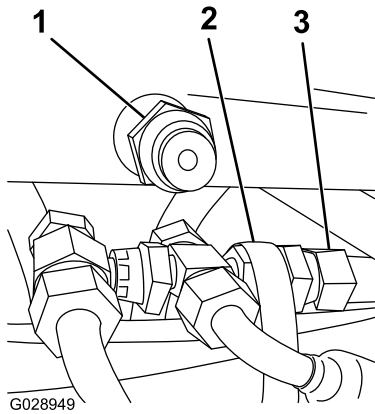

Figure 3

1. Blanking cap
2. Cable tie
3. 3/8-inch hose

6. Attach the 3/8-inch hose to the front tee assembly.
7. Route the hose under the oil tank, lay it on top of the existing hose bundle, and feed it out of the rear of the machine.
8. Attach the hoses removed in step 4 to the front tee assembly in the same locations they were arranged on the manifold ([Figure 1](#) or [Figure 2](#)).
9. Secure the front tee assembly to the hose bundle below it with a cable tie ([Figure 3](#)).
10. Tighten all of the fittings.

2

Installing the Rear Tee Assembly

Parts needed for this procedure:

1	3/8-inch to 1/4-inch swivel tee
1	3/8-inch adaptor
1	1/4-inch swivel tee
2	Blanking caps
1	1/4-inch hose
1	3/8-inch hose

Procedure

1. Assemble the rear tee assembly ([Figure 4](#)).

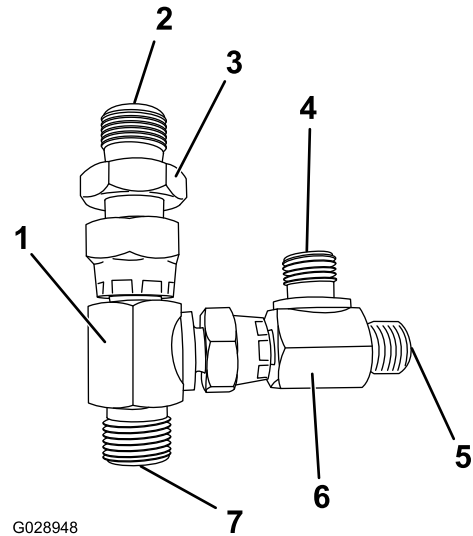

Figure 4

1. 3/8-inch to 1/4-inch swivel tee
2. To the oil tank
3. 3/8-inch adaptor
4. To the center, back cutting unit
5. To the rear, right cutting unit
6. 1/4-inch swivel tee
7. To the front tee

2. Remove the rear cover.
3. Remove the 2 motor drain hoses from the rear manifold.
4. Insert blanking caps into the holes in the manifold ([Figure 5](#)).

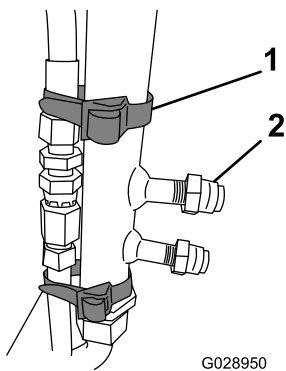

Figure 5

1. Cable tie
2. Blanking cap

5. Remove the 1/4-inch hose from the tee on the lift cylinder for the right, rear cutting-unit (Figure 6).

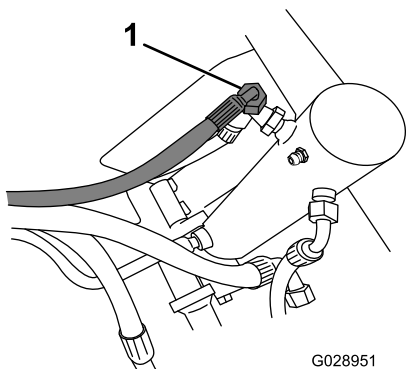

Figure 6

1. 1/4-inch hose

6. Attach the new 1/4-inch hose to the lift cylinder (Figure 6).
7. Loosen the cable ties and fitting on the center-back cutting-unit drain-hose.
8. Attach the 3/8-inch hose from the front tee assembly to the bottom of the rear tee assembly (Figure 4).
9. Attach the end of the 1/4-inch hose from the center, rear cutting-unit to the rear tee assembly (Figure 4).
10. Attach the end of the new 1/4-inch hose from the right, rear cutting-unit to the rear tee assembly (Figure 4).
11. Attach the straight end of the new 3/8-inch hose to the top of the rear tee assembly (Figure 4).
12. Tighten all the fittings and the previously loosened cable ties.

3

Installing the Filler Plate Assembly

Parts needed for this procedure:

1	Filler plate
1	3/8-inch bulkhead fitting
1	Cable tie

Procedure

1. Remove the old filler plate assembly from the top of the tank.
2. Remove the filler cap assembly from the old filler plate and install it on the new filler plate.

Note: For ease of installation, orient the filler plate so that the small hole is in the lower right corner (Figure 7).

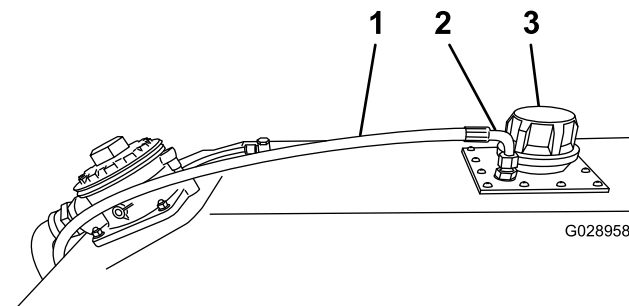

Figure 7

1. 3/8-inch hose
2. Bulkhead fitting
3. Filler cap

3. Insert the 3/8-inch bulkhead fitting into the filler plate with the long leg into the tank (Figure 7).
4. Attach the new filler plate assembly to the top of the oil tank using the hardware from the old filler plate.
- Note:** Ensure that the bulkhead fitting is on the right when viewed from the rear of the machine.
5. Route the 3/8-inch hose from the rear tee assembly up the right side of the return filter and connect it to the bulkhead fitting.
6. Secure the hose to the rear manifold near the return filter using a cable tie.

4

Completing the Installation

Parts needed for this procedure:

2	Cable tie
---	-----------

Procedure

1. Secure the rear tee assembly to the manifold using 2 cable ties ([Figure 5](#)).
2. Secure the 3/8-inch hose under the oil tank to the hose bundle with a cable tie.
3. Tighten the return filter cap.
4. Check for leaks and replace the rear cover.