



LEFT REAR GAGE WHEEL KIT

for 52" Mid-Size Mowers

PART NO. 98-0798

INSTALLATION INSTRUCTIONS

Loose Parts

**Note:** Use the chart below to identify parts used for assembly.

DESCRIPTION	QTY.	USE
Wheel bracket	1	Install left rear gage wheel
Gage wheel assembly	1	
Clevis pin 3/8 x 1" (25 mm)	1	
Hairpin cotter 1-5/8" (41 mm)	1	
Parts Manual	1	Save for ordering replacement parts

Install Bracket

1.

Remove mower, refer to: Operator's Manual for instructions.
2.

Measure over 3-3/8" (86 mm) from left rear mower bracket to locate wheel bracket (Fig. 1).
3.

Hold wheel bracket flat with top of mower and mark mounting location.
4.

Remove paint from the wheel bracket and mower areas that will be welded.
5.

Weld wheel bracket to the left rear of the mower (Fig. 1).

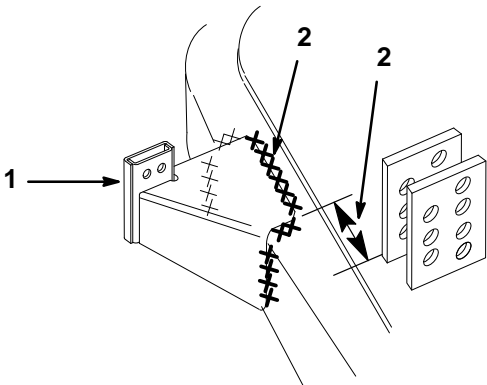

m-3231

Figure 1

1.

Wheel bracket
2.

3-3/8" (86 mm)
3.

Weld here X

## Install Gage Wheel

1. Slide gage wheel assembly into wheel bracket (Fig. 2).
2. Select proper hole location for cut height and secure with 3/8 x 1" (26 mm) clevis pin and 1-5/8" (41 mm) hairpin cotter (Fig. 2).

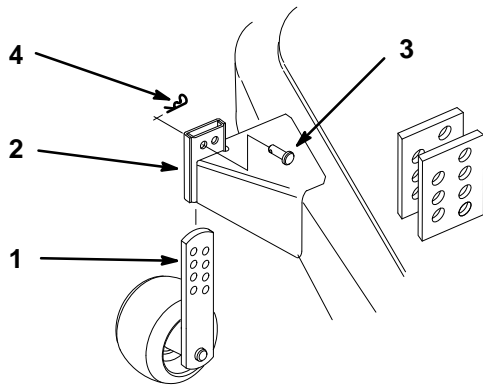

m-3232

**Figure 2**

- |                                |                                  |
|--------------------------------|----------------------------------|
| 1. Gage wheel assembly         | 4. Hairpin cotter 1-5/8" (41 mm) |
| 2. Bracket                     |                                  |
| 3. Clevis pin 3/8 x 1" (26 mm) |                                  |

## Adjusting Gage Wheels

The gage wheels must be adjusted in the proper hole location for each height-of-cut position.

1. After adjusting height-of-cut of the mower, adjust gage wheels.
2. Remove hairpin cotter and clevis pin to change hole location (Fig. 3).
3. Select a hole position so the gage wheel is 3/8" (9.5 mm) off the ground for the height-of-cut to be used (Fig. 3).
4. Insert clevis pin and secure with hairpin cotter.
5. Repeat adjustment on other gage wheels.

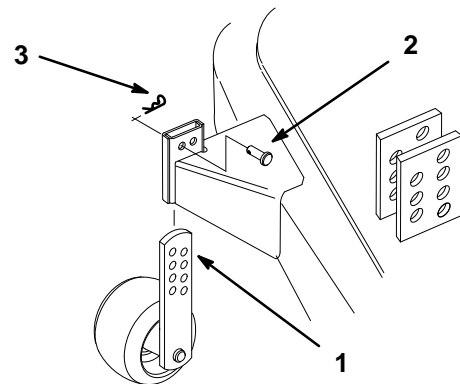

m-3232

**Figure 3**

- |               |                    |
|---------------|--------------------|
| 1. Wheel      | 3. Hair pin Cotter |
| 2. Clevis pin |                    |