



# Canopy Completion Kit

Groundsmaster® 4300-D or Reelmaster® 5410/5510/5610 Traction Unit with ROPS

Model No. 130-5895

## Installation Instructions

### ⚠ WARNING

#### CALIFORNIA Proposition 65 Warning

This product contains a chemical or chemicals known to the State of California to cause cancer, birth defects, or reproductive harm.

## Loose Parts

Use the chart below to verify that all parts have been shipped.

Description	Qty.	Use
Rear bracket	1	Install the rear bracket.
Front bracket	2	Install the front brackets.
Carriage bolt	2	
Flange nut	2	
Grommet	4	Install the canopy.
Flange-head bolt	4	
Washer	8	
Flange nut	4	

## Media and Additional Parts

Description	Qty.	Use
Installation instructions	1	Read the instructions before installing the kit.
Parts catalog	1	Use the catalog to reference part numbers.

## Installing the Rear Bracket

1. Park the machine on a level surface.
2. Stop the engine, engage the parking brake, and remove the key from the ignition switch.
3. Loosen the existing 3 flange nuts secured to the 3 carriage bolts on the canopy frame (Figure 1).

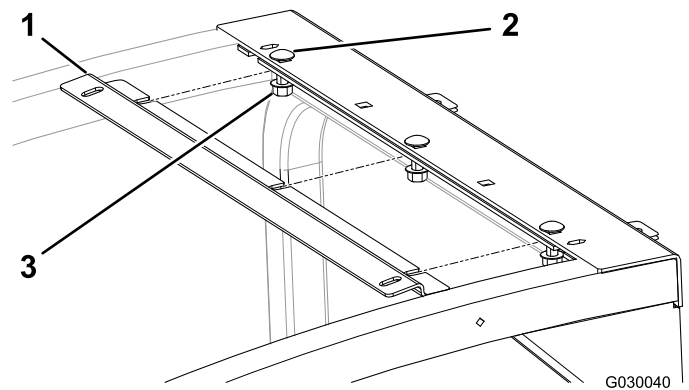
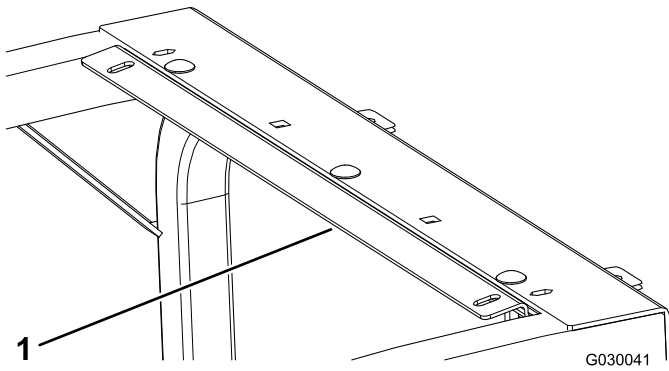

Figure 1

1. Rear bracket
2. Existing carriage bolt (3)
3. Existing flange nut (3)



- Position the rear bracket so that the 3 existing carriage bolts fit into the 3 slots in the bracket ([Figure 2](#)).



**Figure 2**

- Rear bracket

- Tighten the flange nuts to secure the bracket.

## Installing the Front Brackets

- Position a front bracket as shown in [Figure 3](#).

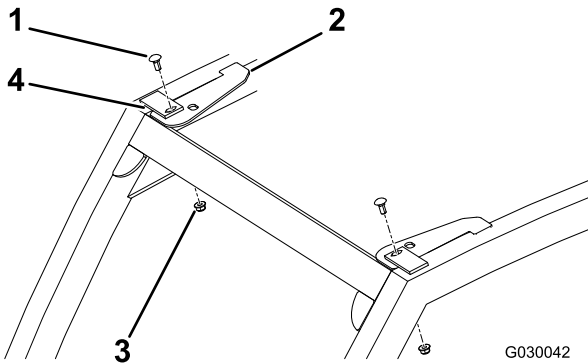

**Figure 3**

- |                      |                   |
|----------------------|-------------------|
| 1. Carriage bolt (2) | 3. Flange nut (2) |
| 2. Front bracket (2) | 4. Mounting tab   |

- Secure the bracket with a carriage bolt and a flange nut ([Figure 3](#)).
- Repeat the procedure for the other front bracket.

## Installing the Canopy

- Install a grommet into each of the 4 bolt holes in the canopy ([Figure 4](#)).

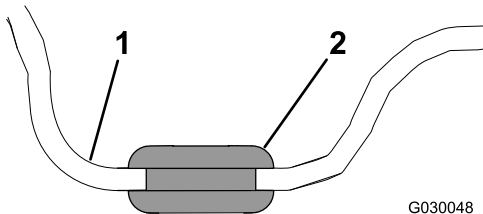

**Figure 4**

- |           |            |
|-----------|------------|
| 1. Canopy | 2. Grommet |
|-----------|------------|

- Position the canopy as shown in [Figure 5](#).

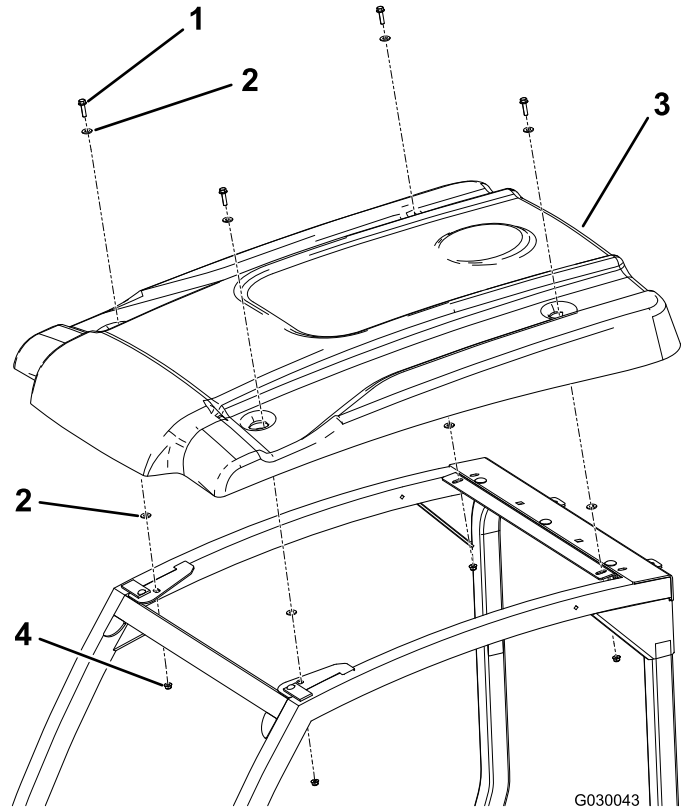

**Figure 5**

- |                         |                   |
|-------------------------|-------------------|
| 1. Flange-head bolt (4) | 3. Canopy         |
| 2. Washer (8)           | 4. Flange nut (4) |

- Secure the canopy with 4 flange-head bolts, 8 washers, and 4 flange nuts ([Figure 6](#)).

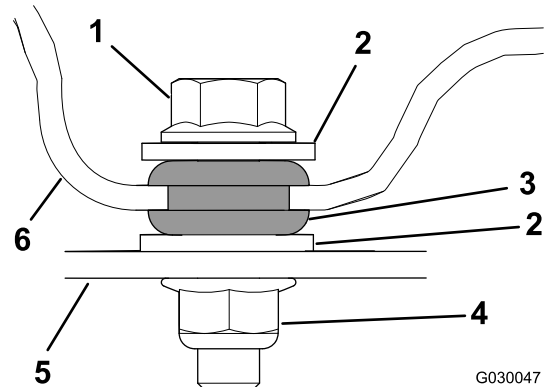

**Figure 6**

- |                     |               |
|---------------------|---------------|
| 1. Flange-head bolt | 4. Flange nut |
| 2. Washer           | 5. Bracket    |
| 3. Grommet          | 6. Canopy     |