



PART NO. 92-5423

**INSTALLATION  
INSTRUCTIONS**
**RECYCLER® KIT  
FOR 32" PROLINE CUTTING DECK**

**NOTE:** Make sure engine is shut off and wire is removed from spark plug. Remove cutting deck and all bagging attachments from unit as instructed in operator's manual.

**REMOVE OLD BLADE**

1. Grasp end of blade using a rag or thickly padded glove. Remove locknut, anti-scalp cup and blade from spindle shaft (Fig. 1).

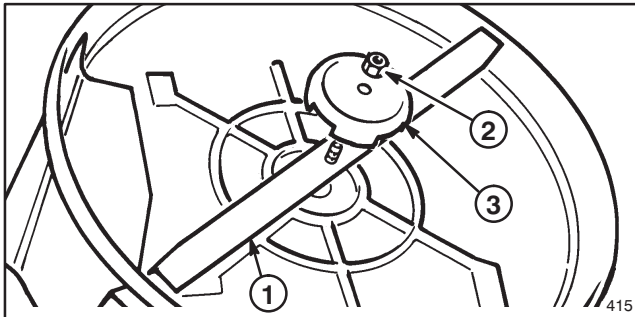
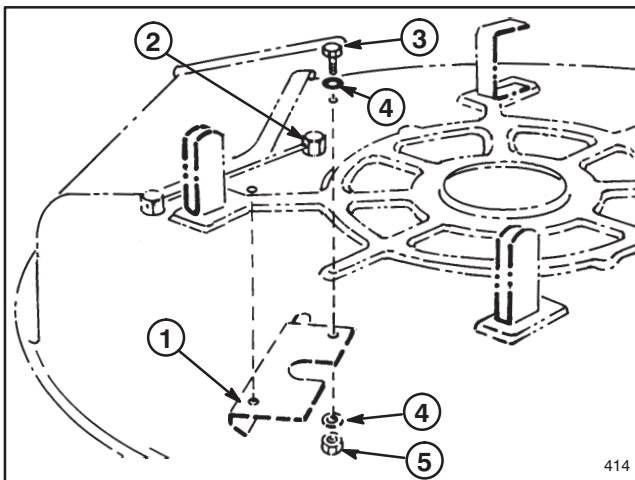

**Figure 1**

1. Blade 2. Locknut 3. Anti-scalp cup

**NOTE:** Since blade fasteners are tightened at the factory, it may be difficult to remove them. If the blade nut cannot be removed, contact an Authorized TORO Service Dealer for assistance.

**REMOVE DECK BAFFLE**

1. Remove (2) capscrews, washers and locknuts securing baffle to underside of mower housing (Fig. 2).

**Figure 2**

1. Deck baffle 4. Flatwasher  
2. Deflector nut 5. Locknut  
3. Capscrew

2. Remove baffle; retain for future use if Recycler® Kit is removed. DO NOT REMOVE DEFLECTOR NUT FROM MOWER HOUSING.

**MARK AND DRILL HOLES**

Two of the four sets of kicker holes are already in the mower deck (Fig. 3).

Holes for the rear kickers will need to be marked and drilled (Fig. 3). Use the kickers as templates for marking holes. All of the kickers are identical so it does not matter which one is used as a template.

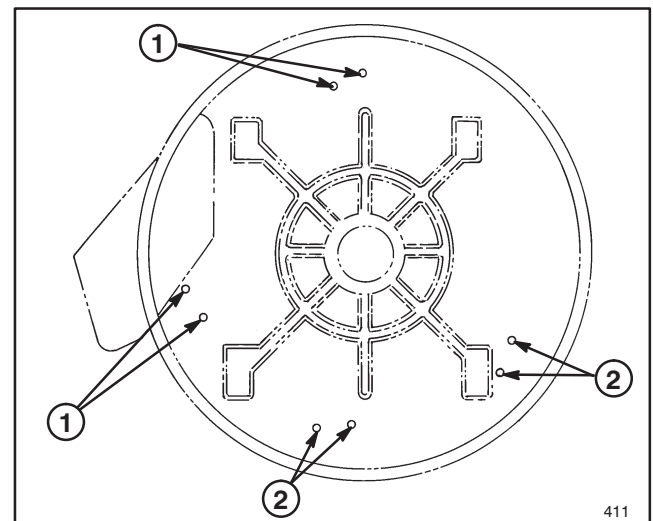
**Figure 3**

1. Holes already in mower deck  
2. Holes to be drilled in mower deck

Make sure underside of mower deck is clean before marking holes or installing kickers. If the underside of the deck is dirty, it will be difficult to see punch marks. When marking holes, hold kicker firmly against mower deck, and use a center punch to mark hole locations.

1. Position first rear kicker on underside of mower deck so flat edge is aligned with embossed surface of deck and bent edge is firmly against mower deck wall as shown in Figure 4.

2. Mark hole locations with punch and remove kicker.

3. Position a kicker in second rear kicker position so point of kicker aligns with embossed surface of mower deck and bent edge is firmly against mower deck wall as shown in Figure 4.

4. Mark hole locations with punch and remove kicker.

**IMPORTANT: DO NOT DRILL THROUGH HOLES IN KICKERS AS KICKER DAMAGE MAY OCCUR.**

5. Using a sharp drill bit, drill 11/32" (.343) dia. holes in deck. Drill must be sharp to prevent it from walking.

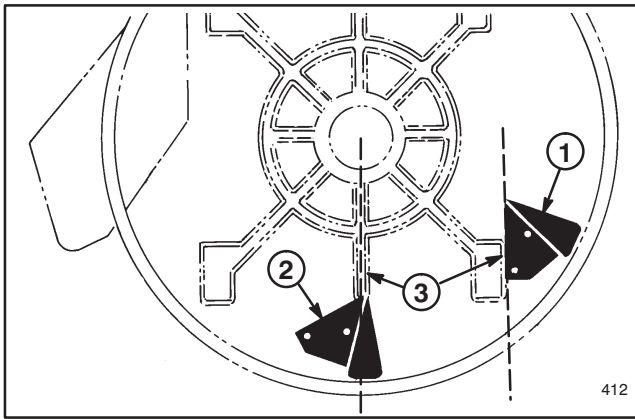

**Figure 4**

1. First rear kicker
2. Second rear kicker
3. Embossed deck surface

## INSTALL KICKERS

The four steel kickers are identical. All of the kicker mounting capscrews are the same length. When installing kickers, insert capscrews from the underside of the deck.

1. Begin by installing the kicker near the discharge area. This kicker location uses an existing pair of holes. The capscrew securing the deck baffle was removed from one of the holes.
2. Position the kicker as shown in Figure 5, aligning holes in kicker with holes in deck.

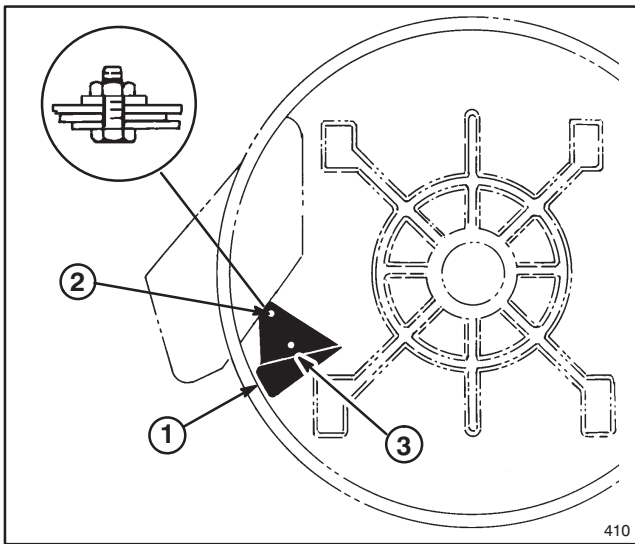

**Figure 5**

1. Kicker
2. Outer Capscrew, washer & locknut
3. Inner Capscrew & locknut

3. Using inner set of holes in kicker and deck, secure kicker to deck with a capscrew and locknut.
4. Using outer set of holes in kicker and deck, loosely secure kicker to deck with a capscrew, washer and locknut.

**Note:** Outer capscrew, washer and locknut are also used to secure discharge cover to deck. Refer to Install Discharge Cover, page 3.

5. Align remaining three kickers with holes in deck and secure in place with capscrews and locknuts (Fig. 6).

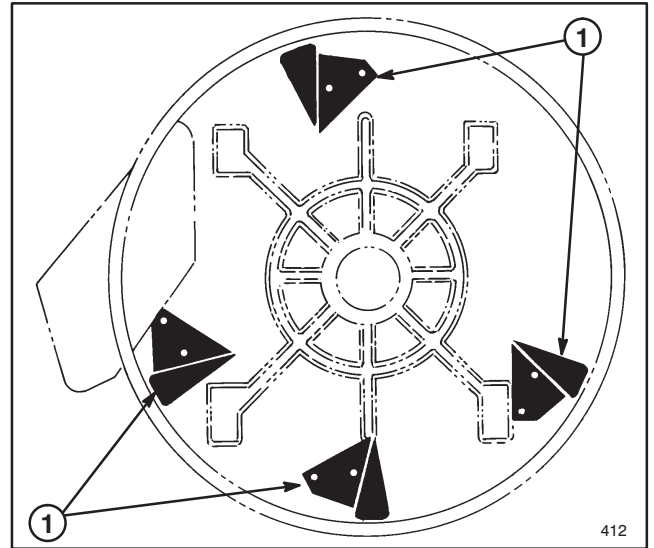

**Figure 6**

1. Kickers

## INSTALL DECK RING

The four deck ring pieces are identical. When installing deck ring, begin with the rim hole in the center of the discharge area and continue installing pieces in a counterclockwise direction around rim of deck. Make sure all capscrew heads are positioned downward.

1. Align holes in first two deck ring pieces with rim hole in center of discharge area (Fig. 7). Secure ring pieces to deck with capscrew and locknut.
2. Continue securing deck ring pieces to deck in a counterclockwise direction using remaining (7) capscrews and locknuts (Fig. 7).

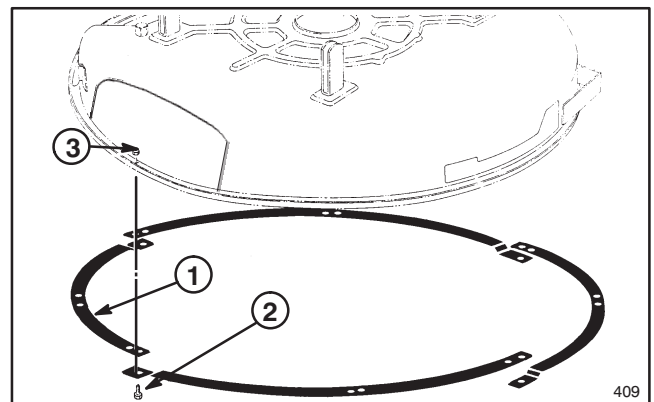

**Figure 7**

1. Deck ring
2. Capscrew
3. Locknut

## INSTALL BLADE AND SPACER

In certain tough conditions, the installation of the Recycler® Kit on the ProLine 32" wide area mower model 30133 may result in the blade contacting the kickers. A thick stiffener/spacer (Part No. 82-4770) is furnished in kit to lower the blade assembly (Fig. 8).

1. Install new blade stiffener/spacer before reinstalling the blade, anti-scalp cup and locknut (Fig. 8). Tighten locknut to 85–110 ft–lbs.

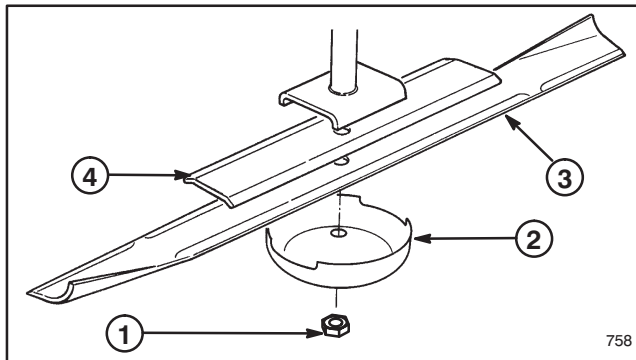

Figure 8

- |                   |                     |
|-------------------|---------------------|
| 1. Locknut        | 3. Blade            |
| 2. Anti-scalp cup | 4. Stiffener/spacer |

## INSTALL DISCHARGE COVER

1. Lift grass deflector and slide discharge cover under tab on top of deck and into front hinge (Fig. 9).

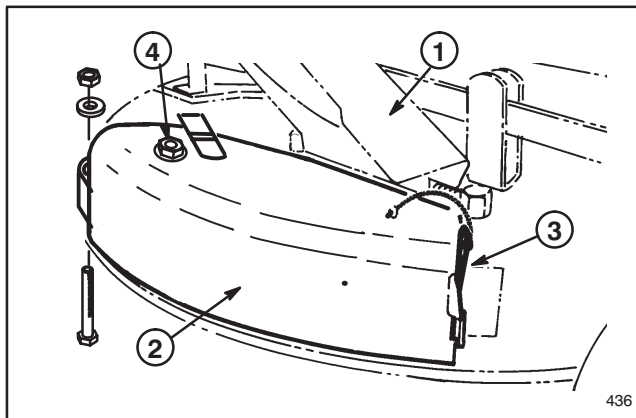

Figure 9

- |                    |                       |
|--------------------|-----------------------|
| 1. Grass deflector | 3. Hinge pin          |
| 2. Discharge cover | 4. Locknut and washer |

2. Slide hinge pin through hinge (Fig. 9).
3. Secure cover to top of deck with locknut and washer previously installed with kicker (Fig.9).
4. Secure cover to rim of deck with a longer capscrew, washer and locknut.

## INSTALL DECAL

1. Thoroughly clean left side of deck with a soap and water solution.

**NOTE:** Deck must be dry before installing decal.

2. Install decal (Fig. 10).

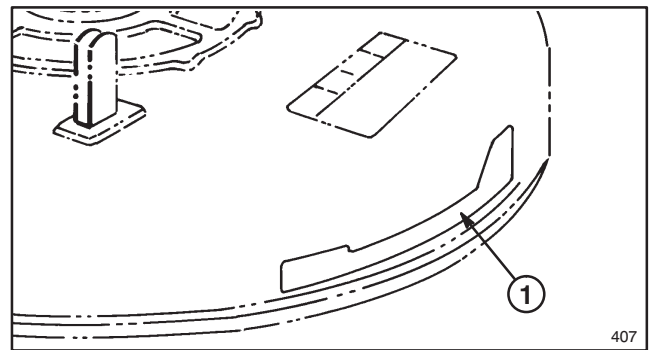

Figure 10

1. Decal

## TO SIDE DISCHARGE OR USE BAGGING ATTACHMENT

1. Raise grass deflector (Fig. 9).
2. Remove the hinge pin securing front discharge cover to mower housing (Fig. 9).
3. Remove capscrews, washers and locknuts securing top and rear of discharge cover to mower housing.

## NEVER REMOVE GRASS DEFLECTOR FROM MOWER HOUSING.

**IMPORTANT:** If complete kit is removed, reinstall deck baffle (Fig. 2). Also, reinstall top capscrew used to secure kicker to deck.



## DANGER

### POTENTIAL HAZARD

- Without the grass deflector, discharge cover or complete grass catcher assembly mounted in place, you and others are exposed to blade contact and thrown debris.

### WHAT CAN HAPPEN

- Contact with rotating mower blade(s) and thrown debris will cause injury or death.

### HOW TO AVOID THE HAZARD

- NEVER remove the grass deflector from the mower because the grass deflector routes material down toward the turf. If the grass deflector is ever damaged, replace it immediately.
- Never put your hands or feet under the mower.
- Never try to clear discharge area or mower blades unless you move the blade control to "DISENGAGED" and rotate the ignition key to "OFF." Also remove the key and pull the wire off the spark plug.

## OPERATING TIPS

**1. MOW WHEN GRASS IS DRY**—Mow either in the late morning to avoid the dew, which causes grass clumping or in late afternoon to avoid the damage that can be caused by direct sunlight on the sensitive, freshly mowed grass.

**2. SELECT THE PROPER HEIGHT—OF—CUT SETTING TO SUIT CONDITIONS** — Remove approximately one inch or no more than 1/3 of the grass blade when cutting. In exceptionally lush and dense grass you may have to raise your height—of—cut setting another notch.

**3. MOWING IN EXTREME CONDITIONS** — Air is required to cut and recut grass clippings in mower housing, so do not set height—of—cut too low or totally surround housing by uncut grass. Always try to have one side of the mower housing free from uncut grass, allowing air to be drawn into housing. When making an initial cut thru center of uncut area, operate machine slower and back up if mower starts to clog.

**4. MOW AT PROPER INTERVALS** — Under most normal conditions you'll need to mow approximately every 4–5 days. But remember, grass grows at different rates at different times. This means that in order to maintain the same height—of—cut, which is a good

practice, you'll need to cut more frequently in early spring; as the grass growth rate slows in mid summer, cut only every 8–10 days. If you are unable to mow for an extended period due to weather conditions or other reasons, mow first with the height—of—cut at a high level; then mow again 2–3 days later with a lower height setting.

**5. ALWAYS MOW WITH SHARP BLADES** — A sharp blade cuts cleanly and without tearing or shredding the grass blades like a dull blade. Tearing and shredding causes the grass to turn brown at the edges which impairs growth and increases susceptibility to diseases.

**6. STOPPING** — If forward motion has to be stopped while cutting, a clump of grass clippings may be deposited on lawn. Follow this procedure for stopping while cutting:

**A.** With deck engaged, move onto a previously cut area.

**B.** Raise deck slightly, while driving forward.

**C.** Shift to neutral, move throttle control lever to SLOW position and rotate ignition key to OFF.

**7. AFTER OPERATING** — To assure optimum performance, clean underside of mower housing, especially around inserts (kickers) after each use. If residue is allowed to build up in mower housing and on inserts, cutting performance will decrease.