



PROLINE
32" BAGGER ADAPTOR KIT

PART NO. 93-4372

**INSTALLATION
INSTRUCTIONS**

This adaptor kit contains parts to space the bagger frame out 1-9/16 in. and forward 1/4 in. for tire clearance. It is used when mounting bagger frame to large tire traction units.

Note: When mounting adaptors pay close attention to the 1/4 in. forward hole spacing so proper position is achieved and no bending of the bagger frame is required.

Loose Parts

Note: Use the chart below to verify all parts have been shipped.

DESCRIPTION	QTY.	USE
Exhaust Elbow Clamp	1 1	Mount to muffler
Adaptor-Front Adaptor-Rear Bracket Bolt - 3/8-16 x 3/4 Lock Nut - 3/8-16 Bolt - 1/2-13 x 1 Lock Nut - 1/2-13 Washer - 1/2 (if required)	1 1 1 2 3 2 2 2	Mount bagger frame to traction frame

Install Exhaust Elbow

IMPORTANT: To protect bag from engine exhaust, all mowers with mufflers mounted on right side of engine must have exhaust elbow installed.

WARNING

POTENTIAL HAZARD

- Muffler heats up as engine operates.

WHAT CAN HAPPEN

- Hot muffler can cause serious burns.

HOW TO AVOID THE HAZARD

- Be sure exhaust system is cool before installing exhaust elbow.

1. Position clamp over slotted section of the exhaust elbow (Fig. 1).
2. With exhaust elbow outlet directed toward the front of the machine, slide over the muffler exhaust outlet tube (Fig. 1).

IMPORTANT: Do not direct exhaust elbow up or at some other component.

3. Tighten clamp securely.

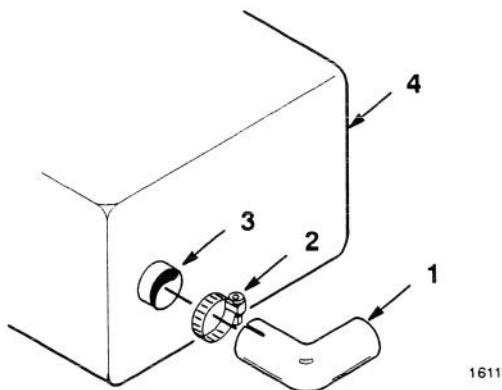

Figure 1

- | | |
|------------------|-------------------|
| 1. Exhaust elbow | 3. Exhaust outlet |
| 2. Clamp | 4. Muffler |

Check Bagger Frame Angle

Note: Older bagger frames may require the rear bagger frame flange to be cut off at an angle, to provide belt clearance (Fig. 2).

1. If required, cut off the front top corner of the rear frame flange at the same angle as the rear adaptor.

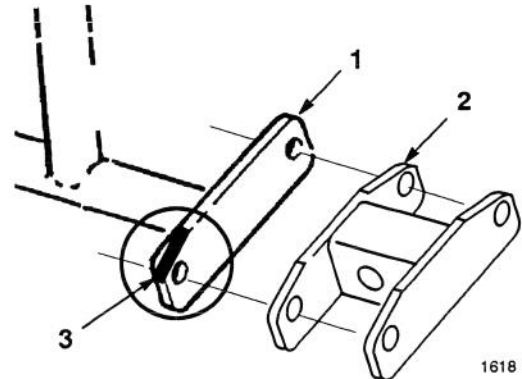

Figure 2

- | | |
|----------------------|---------------------|
| 1. Rear frame flange | 3. Cut off at angle |
| 2. Rear adaptor | |

Mount Front Adaptor

1. Remove (2) front bolts at right carrier frame mount.
2. Hold front adaptor against carrier frame as shown in (Fig. 3).

Note: Pay close attention to the 1/4 in. forward hole spacing so proper position is achieved.

3. Place (2) 1/2-16 x 1 in. bolts between flanges and through outside flange of front adaptor (Fig. 3).

- Secure front adaptor to traction drive frame with 1/2-16 x 1-1/4 in. bolts through from inside traction frame and 1/2 in. lock nuts (Fig. 3).

Note: If 1/2-16 x 1-3/4 in. bolts are with bagger, cut off to 1-1/4 in. or use washers to space longer bolts away from inside of traction frame to provide clearance for outer bolts.

IMPORTANT: Inner bolt threads must not contact outer bolts and bend outer flange.

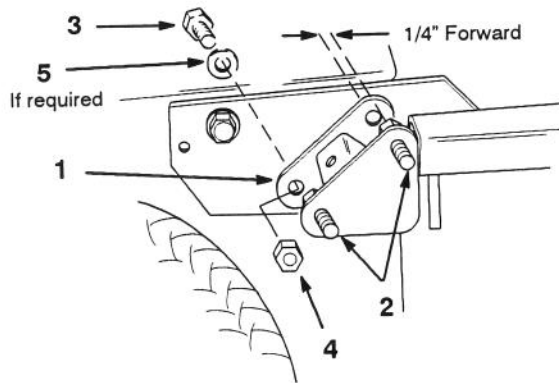

Figure 3

- | | |
|----------------------------|---------------------------------|
| 1. Front adaptor | 4. Flange nut-1/2 in. |
| 2. Bolt-1/2-16 x 1 in. | 5. Washer-1/2 in. (if required) |
| 3. Bolt-1/2-16 x 1-1/4 in. | |

Mount Rear Adaptor

- Remove lower right rear bracket support/belt guide hardware (Fig. 4). Save (2) lock nuts and (1) bolt for use later.
- Position rear adaptor against traction drive frame so outer flange is 1/4 in. forward, as shown in (Fig. 4). Use previously removed lock nuts and (2) 3/8 x 1-1/4 in. bolts furnished with bagger to secure to traction drive frame. Place bolts through inside flange then into traction drive frame.

Note: Pay close attention to the 1/4 in. forward hole spacing so proper position is achieved.

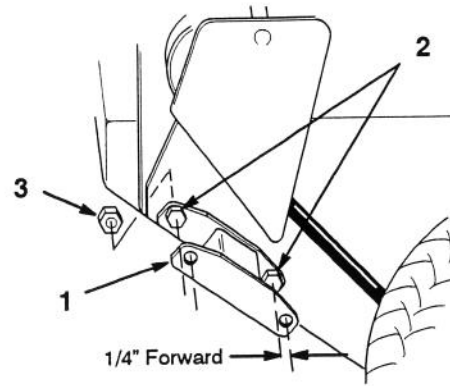

Figure 4

- | | |
|-----------------|-------------|
| 1. Rear adaptor | 3. Lock nut |
| 2. Bolt | |

Mount Bracket

- Remove lock nut securing right idler plate pivot. If necessary remove bolt and install so threads point outward (Fig. 5).
- Slide bracket over bolt, with legs pointing down, and secure with previously removed lock nut (Fig. 5).

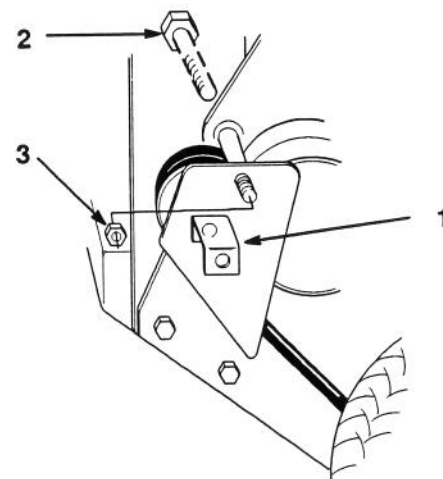
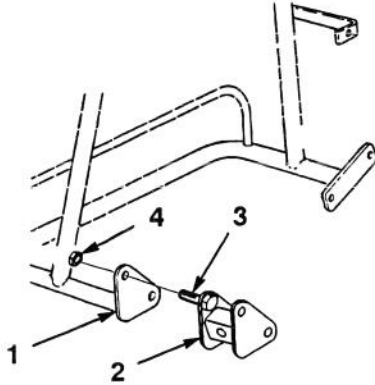

Figure 5

- | | |
|------------|-------------|
| 1. Bracket | 3. Lock nut |
| 2. Bolt | |

Mount Bagger Frame

1. Hold bagger frame against adaptors. Insert bolts through front bagger frame flange, from outside. Secure with lock nuts (Fig. 6).



1612

Figure 6

- | | |
|-----------------------|--------------------------------|
| 1. Front frame flange | 3. Bolt (previously installed) |
| 2. Front adaptor | 4. Lock nut |

2. Align rear bagger frame flange with rear adaptor. Insert bolts through rear bagger flange from outside and secure with lock nuts (Fig. 7).
3. Secure bagger rear stand off bracket to bracket with bolt, washer and lock nut (Fig. 7).

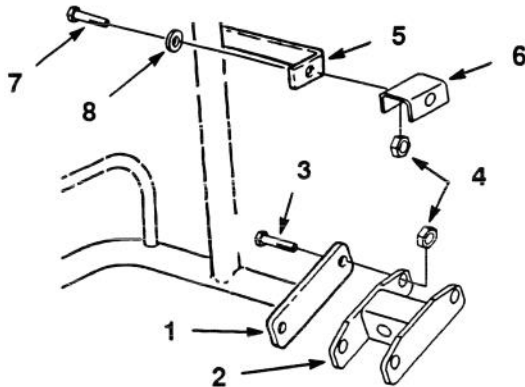

1613

Figure 7

- | | |
|----------------------------|--|
| 1. Rear frame flange | 6. Bracket |
| 2. Rear adaptor | 7. Bolt 3/8 x 1 (removed from idler support) |
| 3. Bolt 3/8 x 1 (from kit) | 8. Washer |
| 4. Lock nut | |
| 5. Rear stand off | |