

TORO®

Helping you put quality into play.™

PART NO. 93-3741

INSTALLATION INSTRUCTIONS

MID MOUNT KIT WORKMAN 3000 SERIES

This kit is required to mount 1/3 Platform Lift, Model 07344 in mid position on vehicle frame.

1. Remove any accessories mounted to top of frame such as full beds, 2/3 beds, top dressers, etc.

Note: Lift may be installed on top of H.D. Hitch Frame Tubes. If lift is to be mounted on top of H.D. Hitch Frame Tubes proceed to step 14.

2. Remove the flange screw and locknut, shown in figure 1, securing engine frame to left side of vehicle frame.

3. Install a new 1/2-13 x 3-1/2" lg. capscrew thru engine frame and vehicle frame. Insert a lift mounting bracket onto capscrew and loosely secure with locknut removed. Bracket to be positioned as shown in figure 2.

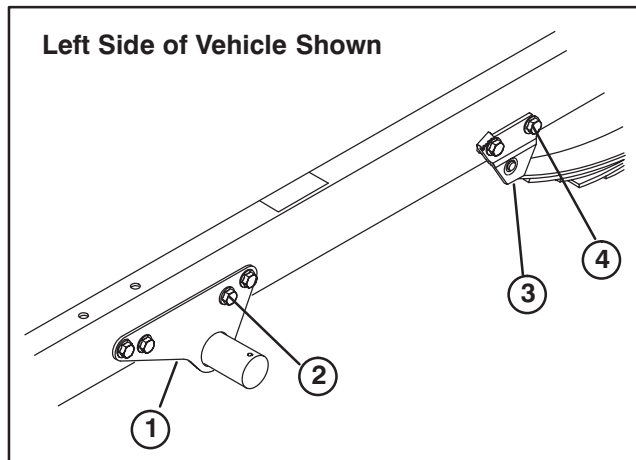

Figure 1

1. Engine frame
2. Remove this flange screw & nut
3. Spring mount
4. Remove this flange screw & nut

4. Remove the rear flange screw and locknut securing leaf spring mount to left side of vehicle frame (Fig. 1).

5. Install a new 1/2-13 x 3-1/2" lg. capscrew thru leaf spring mount and vehicle frame. Insert a lift mounting bracket onto capscrew and loosely secure to engine frame and vehicle frame with locknut removed. Bracket to be positioned as shown in figure 2.

Note: Lift mounting bracket tubes have two different size mounting holes. Make sure brackets with larger holes are used with larger mounting screws.

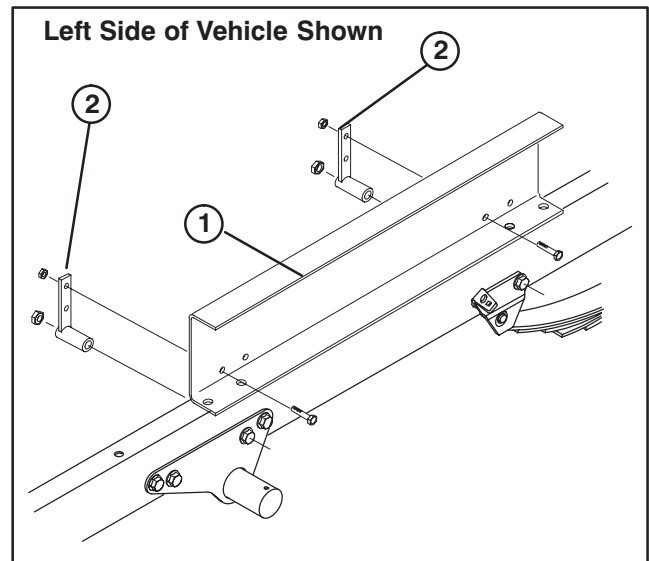

Figure 2

1. Lift
2. Lift mounting brackets

6. Remove the flange screw and locknut, shown in figure 3, securing engine frame to right side of vehicle frame.

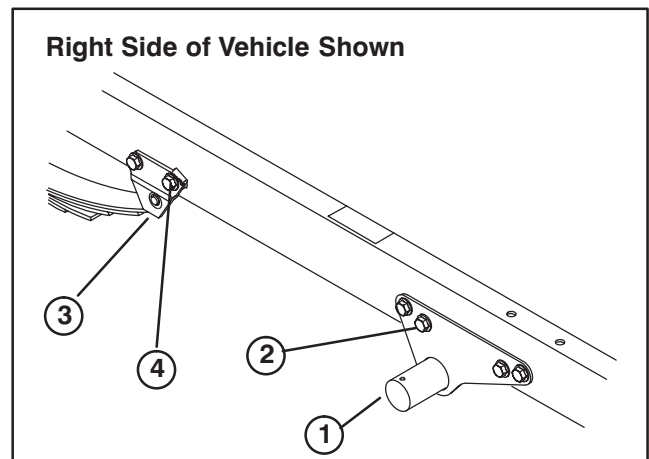

Figure 3

1. Engine frame
2. Remove this flange screw & nut
3. Spring mount
4. Remove this flange screw & nut

7. Insert a lift mounting bracket onto flange screw and loosely secure to engine frame and vehicle frame with locknut removed. Bracket to be positioned as shown in figure 4.

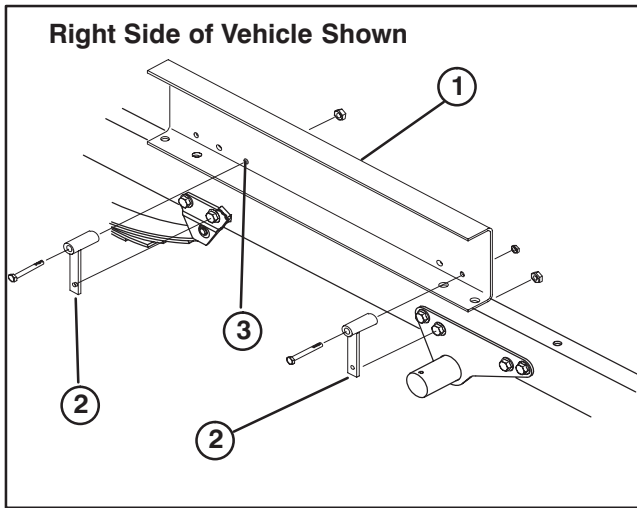

Figure 4

1. Lift
2. Lift mounting brackets
3. Drill .375" dia. hole here

8. Remove the front flange screw and locknut securing leaf spring mount to right side of vehicle frame (Fig. 3).

9. Insert a lift mounting bracket onto flange screw and loosely secure to leaf spring mount and vehicle frame with locknut removed. Bracket to be positioned as shown in figure 4.

Note: To prevent lift scissor arms from expanding, pick up the platform lift from the bottom when positioning on frame.

10. Position lift onto frame aligning mounting holes with holes in mounting bracket.

11. Secure lift mounting brackets to left side of lift with (2) 5/16–18 x 1" lg. flange head capscrews and flangenuts (Fig. 2).

12. Position tube of right rear lift mounting bracket against side of lift. Using mounting bracket tube as a template, locate, mark and drill a .375" dia. hole thru side of lift

13. Secure lift mounting brackets to right side of lift with (2) 5/16–18 x 2–3/4" lg. flange head capscrews and flangenuts (Fig. 4). Tighten all fasteners.

To mount lift in mid position on top of H.D. Hitch Tubes, use the following steps.

14. Using dimensions shown in figure 5, locate, mark and drill (2) .375 (3/8)" dia. holes, thru both walls, of each H.D. Hitch Frame Tube.

Note: To ease hole drilling in hitch tubes, remove capscrews and nuts securing front hitch brackets to vehicle frame channels, pivot hitch upward and drill holes from inside of each tube.

Important: Do not drill any holes in vehicle frame channels.

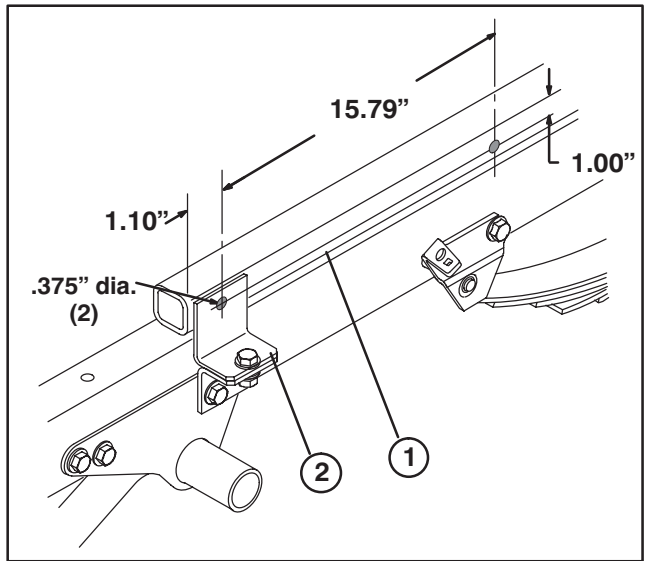

Figure 5

1. H.D. Hitch frame tube
2. Hitch bracket

15. Secure lift mounting brackets to lift with (4) 5/16–18 x 1" lg. flange head capscrews and flangenuts. Position brackets as shown in figure 6.

Note: To prevent lift scissor arms from expanding, pick up the platform lift from the bottom when positioning on frame.

16. Position lift onto frame aligning mounting bracket holes with holes in hitch tubes

17. Secure lift mounting brackets to H.D. Hitch Tubes with (4) 5/16–18 x 2–3/4" lg. flange head capscrews and flangenuts.

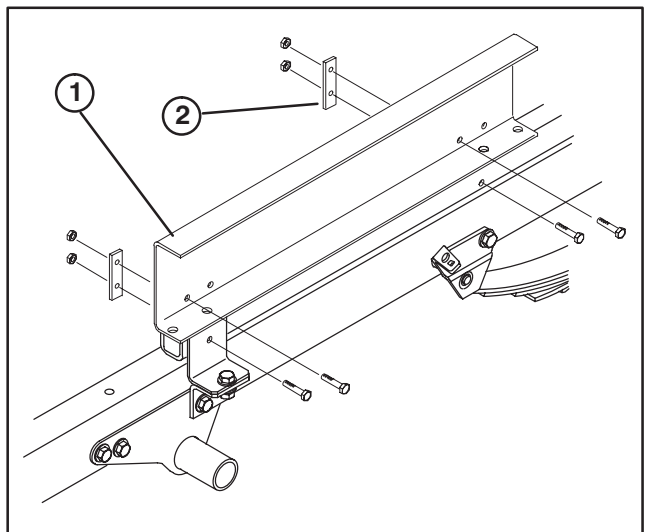

Figure 6

1. Lift
2. Lift mounting brackets