

TORO®

PART NO. 92-9739

**INSTALLATION
INSTRUCTIONS****FUEL FILTER KIT****Reelmaster 335D / 3500D & Groundsmaster 455D****CAUTION**

Before servicing or making adjustments to the machine, lower cutting units, stop engine and remove key from the switch.

1. Remove (4) washer head screws securing cover to front of control console (Fig. 1).

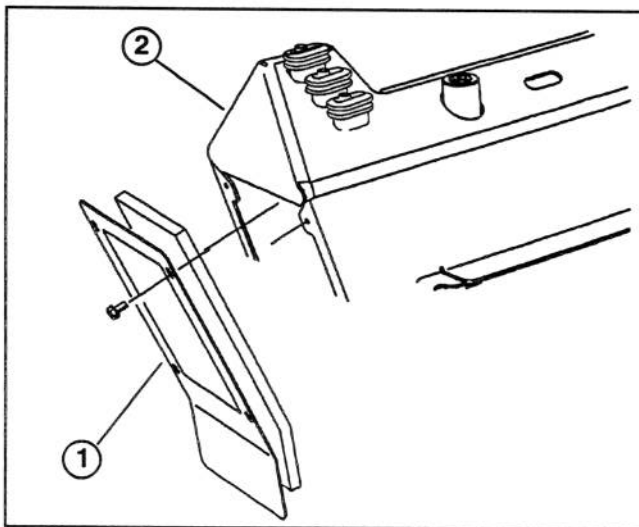
**Figure 1**

1. Cover
2. Control Console

2. Using dimensions shown in figure 2, locate, mark and drill a .719" dia. hole in front of control console (Fig. 2).

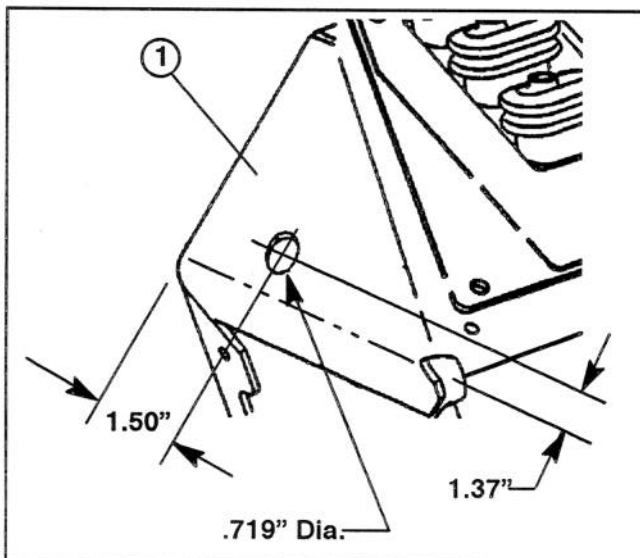
**Figure 2**

1. Front of Control Console

3. Affix decal (water in fuel) around drilled hole in console (Fig. 3).

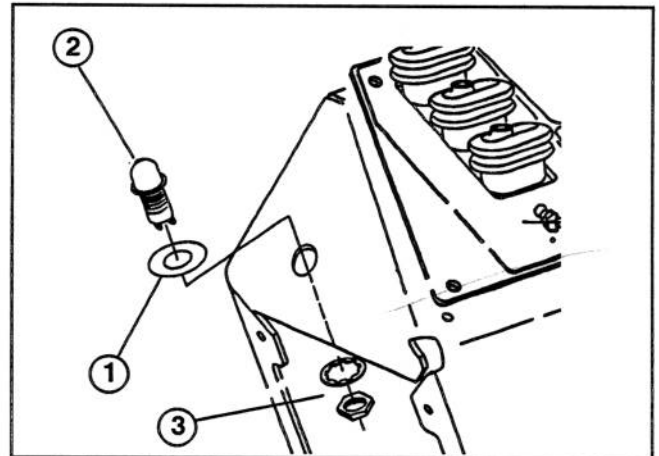
**Figure 3**

1. Decal
2. Warning Light
3. Internal Tooth washer & Nut

4. Insert warning light into drilled hole and secure to console with internal tooth washer and nut (Fig. 3).

5. Place a clean container under fuel filter.

6. Loosen bolts securing fuel line fittings to each side of fuel filter and remove fittings from filter (Fig. 4).

7. Remove (2) capscrews, lockwashers, flatwashers and spacers securing fuel filter to fuel tank plate (Fig. 4). Remove fuel filter.

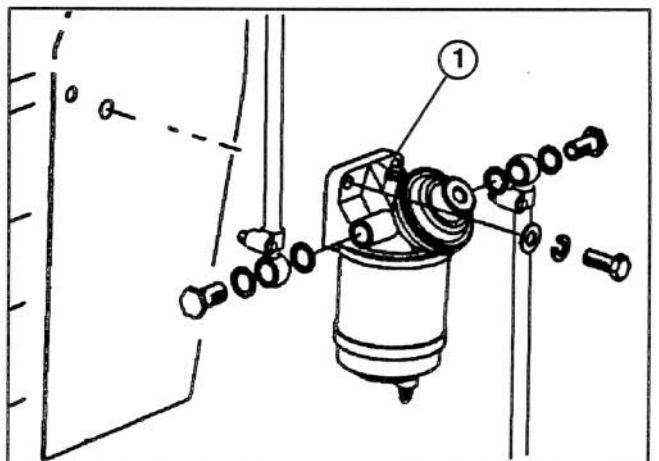
**Figure 4**

1. Fuel Filter

8. Mount new fuel filter to fuel tank plate with (2) capscrews, lockwashers and flatwashers previously removed (Fig. 5). Make sure fuel filter is positioned so water sensor connection is toward front of machine (Fig. 5). To reposition sensor, loosen filter screw on top of filter and rotate bottom filter bowl/sensor to desired position.

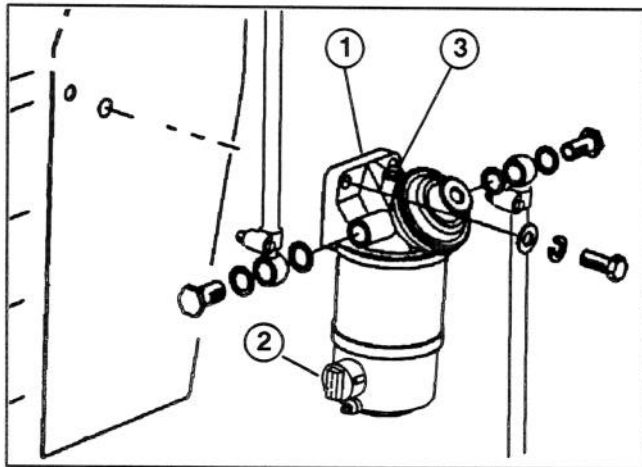

Figure 5

- 1. Fuel Filter
- 2. Water Sensor Connection
- 3. Filter Screw

9. On wire harness supplied with kit, locate end with (2) female receptacles. Plug these onto warning light terminals.

10. Route opposite end of harness rearward, behind lower ports of lift valve, along existing harness to new fuel filter water sensor (Fig. 6). Plug three prong connector into connector on water sensor.

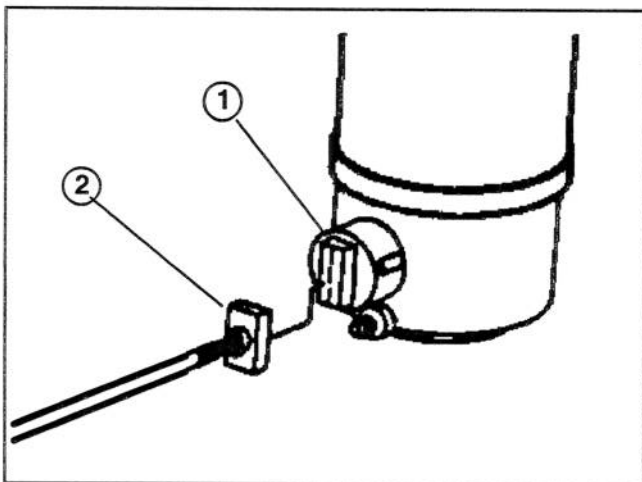

Figure 6

- 1. Water Sensor
- 2. Three Prong Connector

11. Route wire with 5 mm ring terminal to stop valve assembly on top of fuel injection pump. Lift wiring boot off stop valve and remove nut and washer securing existing pink wire to valve.

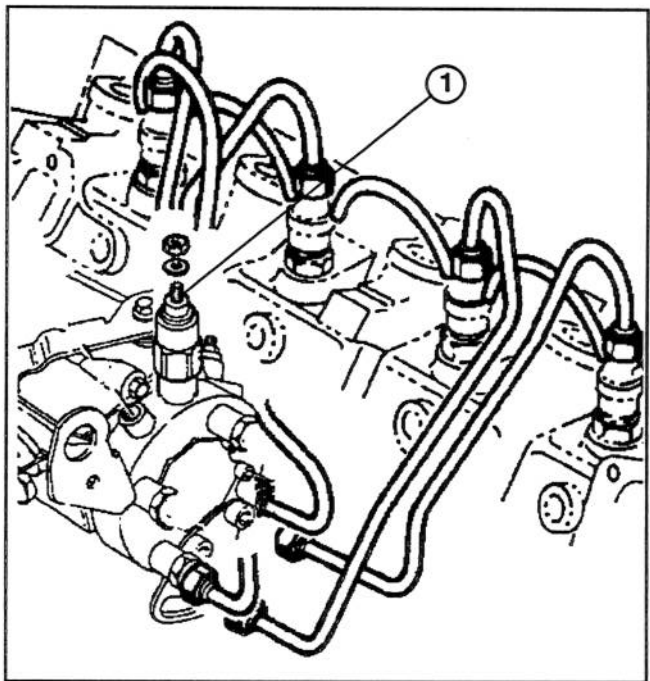

Figure 7

- 1. Stop Valve

12. Insert 5 mm ring terminal thru boot and onto stop valve. Secure both wires to valve with nut previously removed. Slide boot over connection.

13. Route remaining black (ground) wire with 5/16 ring terminal toward battery.

14. Remove washer head capscrew and external tooth lockwasher securing battery base support to frame, as shown in figure 8.

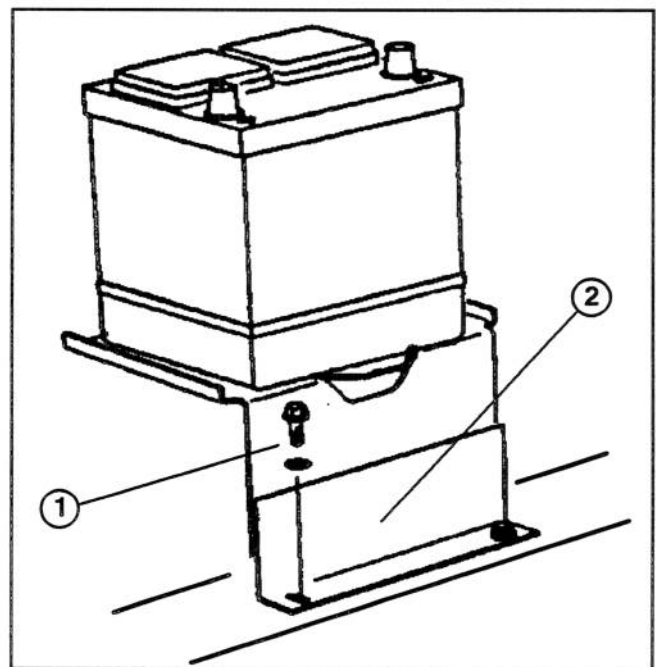

Figure 8

- 1. Washer Head Capscrew & External Tooth Lockwasher
- 2. Battery Base Support

15. Secure 5/16 ring terminal to battery base support with washer head capscrew and external tooth lockwasher previously removed. This is a ground connection so make sure it is a good connection.

Priming Fuel System

1. Insert a 3/16" hose over bleed screw and run other end into a container to catch fuel.
2. Loosen fuel filter / water separator bleed screw a few turns. Pump priming plunger until a steady stream of fuel comes out of hole in bleed screw. When fuel stops foaming, tighten the bleed screw during the downstroke of the priming plunger. Wipe up any spilled fuel.
3. Pump priming plunger until resistance is felt. Try to start engine. If engine does not start repeat step 3.

Note: It may be necessary to bleed the air out of the fuel line between the fuel filter / water separator and the injection pump. To do this, loosen the fitting on the injection pump and repeat bleeding procedure.

Draining Fuel Filter / Water Separator

Drain water or other contaminants from fuel filter / water separator daily.

1. Place a clean container under fuel filter.
2. Loosen drain screw on bottom of fuel filter and press primer plunger until only fuel is evident draining into container.
3. Tighten drain screw.

Changing Fuel Filter

Replace fuel filter if fuel flow becomes restricted, after every 400 hours of operation or annually, whichever comes first.

1. Unscrew bottom filter cap from filter assembly. Remove cap, gaskets, o-ring and filter from assembly. Note position of gaskets and o-ring when disassembling from filter.
2. Install new filter, gaskets, o-ring with filter assembly cap.
3. Prime fuel system, refer to Priming Fuel System.