



Controller Kit for High Lift Collection

Groundsmaster® 360 4-Wheel Drive Multi-Purpose Machine

Model No. 30897

Installation Instructions

Loose Parts

Use the chart below to verify that all parts have been shipped.

Procedure	Description	Qty.	Use
1	No parts required	–	Disconnect the battery.
2	No parts required	–	Prepare the machine.
3	Controller bracket Controller Wiring harness connector Carriage bolt Flange nut Nut Bolt	1 1 1 2 2 4 4	Install the control bracket.

1

Disconnecting the Battery

No Parts Required

Procedure

1. Park the machine on a level surface, and lower the mower deck and any attachments to the ground.
2. Stop the engine, wait for all moving parts to stop, engage the parking brake, and remove the key from the ignition switch.
3. Disconnect the negative (–) battery cable from the battery.

⚠ WARNING

Wear safety goggles and rubber gloves when working with batteries. Since the gases are explosive, keep open flames and electrical sparks away from batteries. Do not smoke near the battery.

2

Preparing the Machine

No Parts Required

Procedure

1. Tilt the steering tower forward.
2. Move the seat latch (located on the left-hand side of the seat) rearward to unlatch the seat, then pull forward on the top of the seat until the seat tilts forward and contacts the steering wheel ([Figure 1](#)).

Note: Ensure that the seat prop locks the seat plate securely in place.



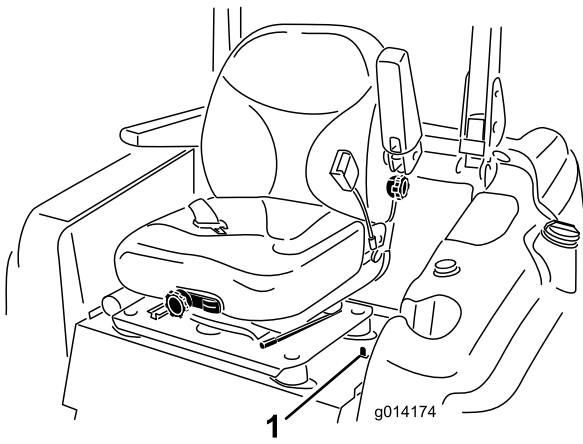

Figure 1

1. Seat latch

3. Remove the bolts that secure the console panel and remove the panel.

3

Installing the Controller Bracket

Parts needed for this procedure:

1	Controller bracket
1	Controller
1	Wiring harness connector
2	Carriage bolt
2	Flange nut
4	Nut
4	Bolt

Procedure

1. Mount the controller bracket to the frame using 2 carriage bolts and 2 flange nuts ([Figure 2](#)).

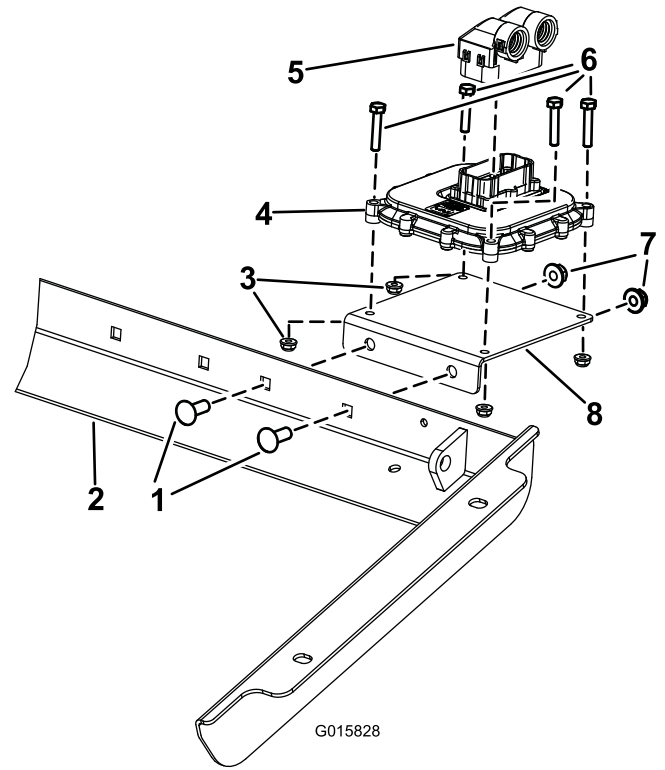

Figure 2

- | | |
|-------------------|-----------------------------|
| 1. Carriage bolts | 5. Wiring harness connector |
| 2. Vehicle frame | 6. Bolts |
| 3. Nuts (4) | 7. Flange nuts |
| 4. Controller | 8. Controller bracket |
2. Secure the controller to the controller bracket using 4 bolts and 4 nuts as shown in [Figure 2](#).
 3. Insert and secure the wiring harness connector into the controller as shown in [Figure 2](#).