



Arm Pin Kit

Groundsmaster® 3400 4-Wheel Drive Traction Unit
With Serial Number up to 315000001

Model No. 111-8010

Installation Instructions

Installation

Loose Parts

Use the chart below to verify that all parts have been shipped.

Description	Qty.	Use
Wear plate	2	Install the lift kit.
Arm pin	2	
Carriage bolt	4	
Hex nut (M10)	4	
Hex nut (M24)	2	
Washer (M24)	2	



Before installing the kit, read and understand the safety precautions in the GM3400 *Operator Manual*. If you have any doubts on the installation procedure, consult your local authorised dealer.

1. Position the machine on a level surface, lower the cutting deck, engage the parking break, ensure that the traction pedal is in the Neutral position and the PTO lever in the OFF position, stop the engine, and remove the key from the switch.

Note: Ensure there is no residual pressure in the hydraulic circuit

2. Remove the cutting deck from the lift arms. Refer to the *Operator's Manual*.
3. Start the machine, raise the lift arms until they are in the stored position, and latch them in place.
4. Loosen front wheel nuts.
5. Using appropriate lifting equipment, lift the front of the machine and place on 2 axle stands.

Note: Ensure that they are appropriately positioned so that the machine is stable to work around.

6. Remove both of the front wheels.

Note: Using the appropriate lifting equipment, place the front of the machine on to two axle stands and ensure that they are appropriately positioned so that the machine is stable to work around.

7. Remove the existing lift arm pivot pin on both lift arms.
8. Install the wear plate on to the outside face of the existing front lift bracket using the carriage bolts and M10 nut (Figure 1).

Note: Wait to install the top M10 nut until the new arm pin is installed.

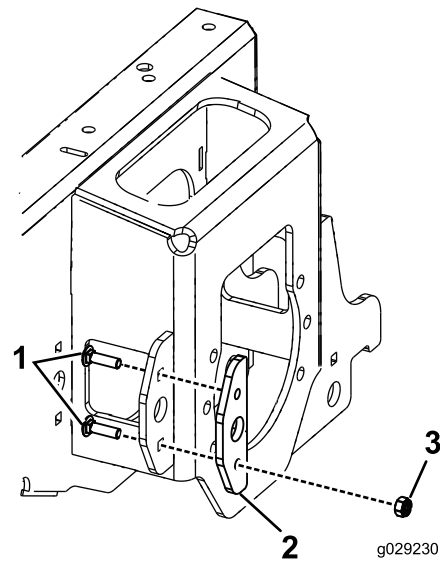

Figure 1

- | | |
|------------------|------------|
| 1. Carriage bolt | 3. M10 nut |
| 2. Wear plate | |

9. Install the arm pin from the outside of the machine through the wear plate and through the lift arm pivot bush (Figure 2).

Note: To help fit the new pin, add a small amount of grease to the shaft.

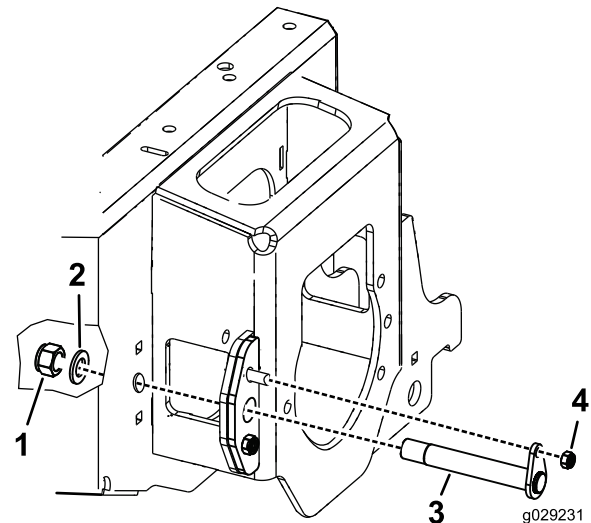

Figure 2

- | | |
|---------------|------------|
| 1. M24 nut | 3. Arm pin |
| 2. M24 washer | 4. M10 nut |

10. Secure the pin to the inside of the chassis using the M24 nut and washer (Figure 2).
11. Repeat these steps for the second lift arm pin.
12. Install the front 2 wheels back onto the machine and remove the axle stands.
13. Install the cutting deck back onto the machine following the instructions found in the *Operator's Manual*.