



## Blade Kit

Model 02601/02605 HoverPro 450/550 Machine

Model No. 111-6800

Model No. 111-6801

Form No. 3395-693 Rev A

### Installation Instructions

# Installation

## Loose Parts

Use the chart below to verify that all parts have been shipped.

Procedure	Description	Qty.	Use
<b>1</b>	Up stop bracket	1	Install the up stop bracket.
	Insert (M4)	2	
	Screw (M4)	2	
<b>2</b>	Blade bolt	1	Install the blade.
	Blade	1	

**Important:** This kit is intended for use on HoverPro models 02601 and 02605 only.



## Installing the Up-Stop Bracket

### Parts needed for this procedure:

1	Up stop bracket
2	Insert (M4)
2	Screw (M4)

### Procedure

1. Turn the fuel switch to the Off position.
2. Disconnect the wire from the spark plug
3. Tilt the machine on its left side to gain access under the deck.
4. Gently tap the inserts (M4) into the 2 holes in the deck as shown in [Figure 1](#).

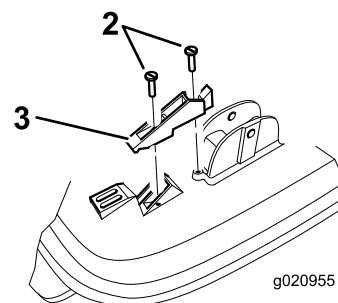
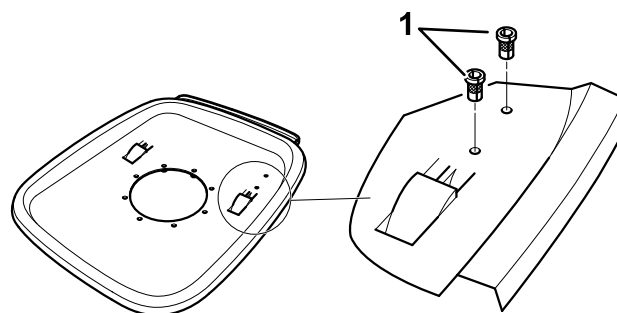

**Figure 1**

1. Inserts (M4)
  2. Screws (M4)
  3. Up stop bracket
5. Position the up-stop bracket on the top of the deck as shown in [Figure 1](#) and secure it in place with 2 screws (M4).



# 2

## Installing the Blade

### Parts needed for this procedure:

1	Blade bolt
1	Blade

### Procedure

#### **⚠ WARNING**

The blade is sharp; contacting the blade can result in serious personal injury.

- Disconnect the wire from the spark plug.
- Wear gloves when handling the blade.

1. Remove the bolt, retaining bolt, and spacers to gain access to the blade carrier assembly.
2. Retain the spacers, and discard the blade carrier assembly and the bolt.
3. Install the blade using the supplied blade bolt and the retained spacers and retaining bolt as shown in [Figure 2](#). Refer to the *Operator's Manual* for height adjustment procedure.

**Important:** Position the curved ends of the blade to point away from the machine so the words "Grass Side" are on the bottom of the blade when cutting.

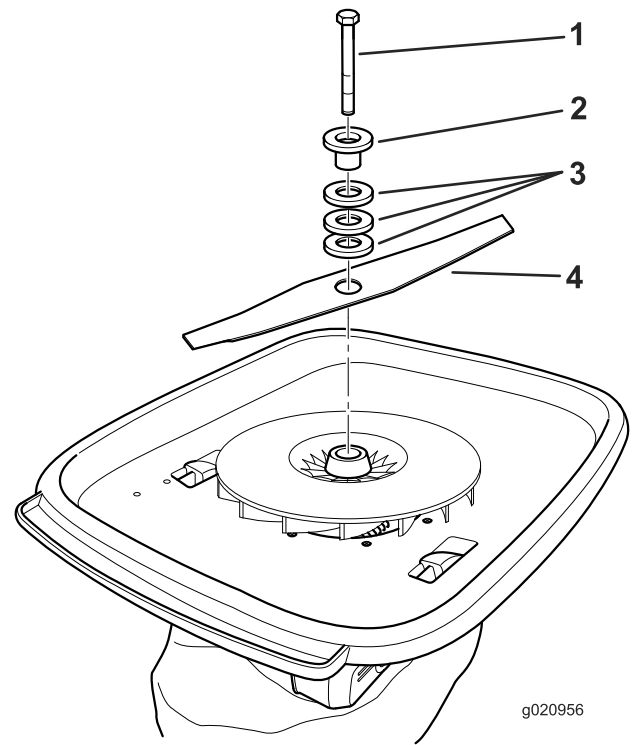

**Figure 2**

- |                            |                     |
|----------------------------|---------------------|
| 1. Blade bolt              | 3. Existing spacers |
| 2. Existing retaining bolt | 4. Blade            |

4. Tighten the blade bolt to 25 N-m (18 ft-lb).