



# **RECYCLER<sup>®</sup> KIT for 38" MOWERS**

**MODEL NO. 79170**
**INSTALLATION  
INSTRUCTIONS**

## **Loose Parts**

DESCRIPTION	QTY.	USE
Bolt 1/4–20 x 3/4 in.	2	Install rear baffle.
Nut Lock 1/4–20	2	
Baffle – Rear	1	
Bolt 3/8–16 x 7/8 in.	2	Install front baffle.
Nut Lock 3/8–16	2	
Carriage Bolt 5/16–18	1	
Nut Lock 5/16–18 x 3/4 in.	1	
Baffle – Front	1	
Screw #8 x 5/8 in.	8	Install kicker plates.
Kicker Plate	4	
Blade – 38" Recycler	2	Install blades.
Blade Stiffener	2	
Bolt 1/4–20 x 23/4 in.	2	Install discharge cover.
Nut Lock 1/4–20	2	
Discharge Cover	1	
Decal – 38" Recycler	1	Left side of mower deck.
Decal – Domestic (Text and Graphics)	1	
Decal – International (Graphics only)	1	

## Installing Baffles

### CAUTION

#### POTENTIAL HAZARD

- Edges of mower blades are sharp.

#### WHAT CAN HAPPEN

- Sharp edges of mower blades can cut you during this kit installation.

#### HOW TO AVOID THE HAZARD

- Use suitable covering over cutting edges of blade to prevent bodily harm.

Remove mower from tractor as outlined in tractor operator's manual.

Turn mower upside down.

1. Center rear weldment as shown in (Fig. 1). Install rear baffle to deck using two  $\frac{1}{4}$ "-20 x  $\frac{3}{4}$ " bolts and  $\frac{1}{4}$ -20 lock nuts.

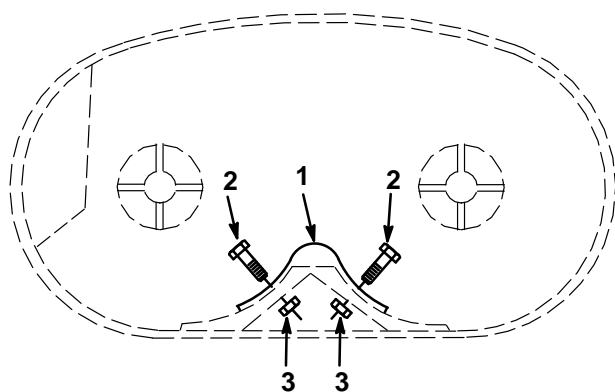

Figure 1

1. Rear baffle
2.  $\frac{1}{4}$ -20 x  $\frac{3}{4}$  Bolt
3.  $\frac{1}{4}$ -20 Lock nut

2. Position front baffle on deck and align holes. Secure baffle using two  $\frac{3}{8}$ "-16 x  $\frac{7}{8}$ " bolts and  $\frac{3}{8}$ -16 lock nuts.

Secure side of front baffle with  $\frac{5}{16}$ -18 x  $\frac{3}{4}$ " carriage bolt and  $\frac{5}{16}$ -18 lock nut. Nuts must be on outside of deck (Fig. 2).

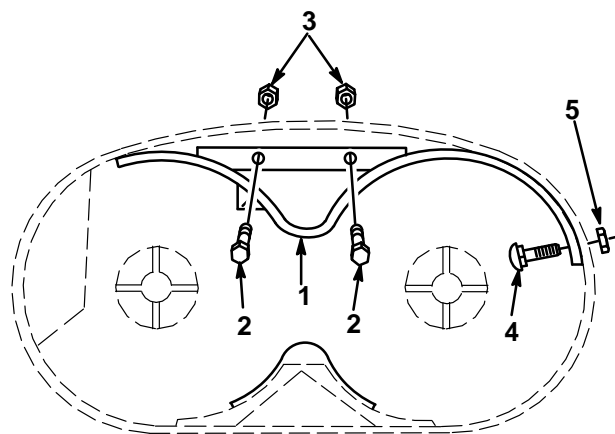

Figure 2

1. Front baffle
2.  $\frac{3}{8}$ -16 x  $\frac{7}{8}$ " Bolt
3.  $\frac{3}{8}$ -16 Lock nut
4.  $\frac{5}{16}$ -18 Carriage bolt
5.  $\frac{5}{16}$ -18 Lock nut

## Installing Kicker Plates

1. Install kicker plates with holes toward top of deck using #8 x  $\frac{5}{8}$ " screws (Fig. 3). Screws are installed from top of deck. Long slope on kickers must be positioned in a clockwise direction as viewed in Figure 3.

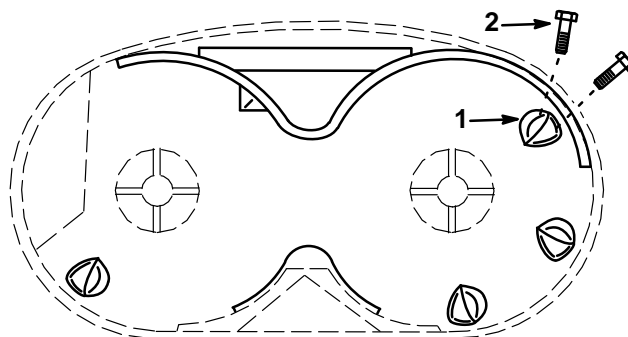

Figure 3

1. Kicker plate
2. #8 x  $\frac{5}{8}$ " Screw

## Installing Blades

1. Remove standard side discharge blades from mower.
2. Install Recycler blades, blade retainer, curved washer (cupped side toward blade), and the blade bolt (Fig. 4).

**IMPORTANT: The curved part of the blade must be pointing toward the inside of the mower to assure proper cutting.**

3. Tighten the blade bolt to 45–60 ft–lb (61–81 Nm).
4. Check that blades clear baffles and bolt heads, if necessary loosen bolts on spindle and reposition spindle so that blades clear bolts.

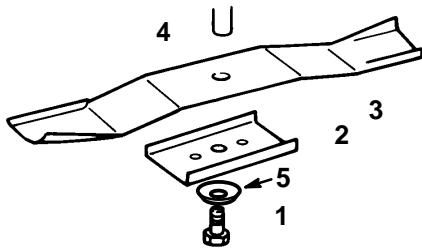

Figure 4

- |             |                  |
|-------------|------------------|
| 1. Bolt     | 4. Spindle       |
| 2. Retainer | 5. Curved washer |
| 3. Blade    |                  |

Install Recycler® Mower and (1) safety decals on left side of mower (Fig. 5). Select proper one for country.

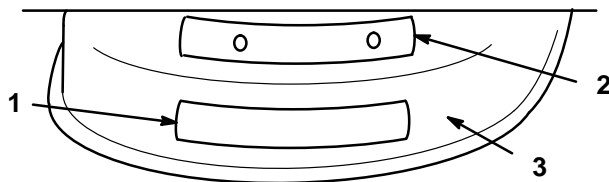

Figure 5

- |                                     |                       |
|-------------------------------------|-----------------------|
| 1. Recycler decal                   | 3. Left side of mower |
| 2. Safety decal (select proper one) |                       |

## Installing the Discharge Cover

1. Lift the grass deflector and slide the tabs on top of the discharge cover under the grass deflector retaining rod. Rotate the discharge cover down over the opening, and onto the lower lip of the mower (Fig. 6).
2. Secure the discharge cover to the lower lip of the mower with 1/4–20 x 2 3/4" bolts and 1/4–20 nuts (Fig. 6).

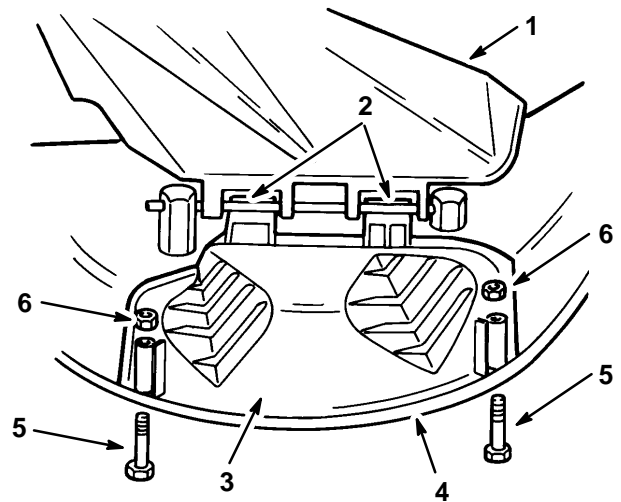

Figure 6

- |                    |                         |
|--------------------|-------------------------|
| 1. Grass deflector | 4. Lower lip            |
| 2. Tabs under rod  | 5. 1/4–20 x 2 3/4" Bolt |
| 3. Discharge cover | 6. 1/4–20 Nut           |

3. To convert back to a side discharge mower, remove the discharge cover and lower the grass deflector over the discharge opening.

Install mower as outlined in tractor operator's manual.

