



Adjustment Knob Kit

Part No. 76-1960

Form No. 3318-736

Installation Instructions



Caution



Before servicing or making adjustments to the machine, stop the engine and remove the key from the switch

1. Unscrew the knob completely from the suspension (Fig. 1).
2. Invert the suspension and remove the spring hanger by sliding it towards the extension springs (Fig. 1).
3. Replace with the new spring hanger.
4. Place the spacer as shown in figure and screw the knob into place. Expose enough threads to allow the installation of the locknut.
5. Apply thread sealant and attach the nut.
6. Grip the tension adjust shaft with a vice grips and tighten the nut with a wrench so that 1 or 2 threads are showing at the end of the shaft.

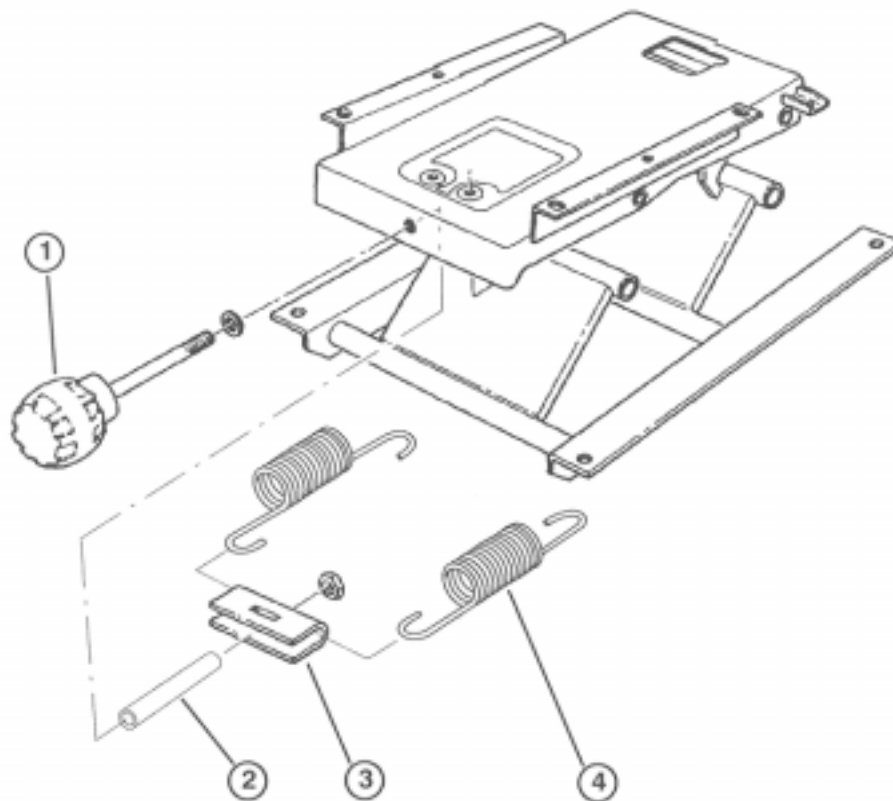

Figure 1

- | | | | |
|---------|-----------|------------------|---------------------|
| 1. Knob | 2. Spacer | 3. Spring hanger | 4. Extension spring |
|---------|-----------|------------------|---------------------|