



# Basket Support Kit

Greensmaster® 3300/3320/3400/3420 TriFlex® Traction Unit

Model No. 132-6961

## Installation Instructions

### ⚠ WARNING

#### CALIFORNIA Proposition 65 Warning

This product contains a chemical or chemicals known to the State of California to cause cancer, birth defects, or reproductive harm.

## Installation

### Loose Parts

Use the chart below to verify that all parts have been shipped.

Description	Qty.	Use
No parts required	—	Remove the old pop rivets and basket support.
Basket support	1	Install the basket support kit.
Pop rivet	18	

### Removing the Old Pop Rivets and Basket Support

Before installing the new basket support kit, cut out the old pop rivets and remove the old basket support.

### Installing the Basket Support Kit

1. Align the basket support with the existing holes in the basket ([Figure 1](#)).

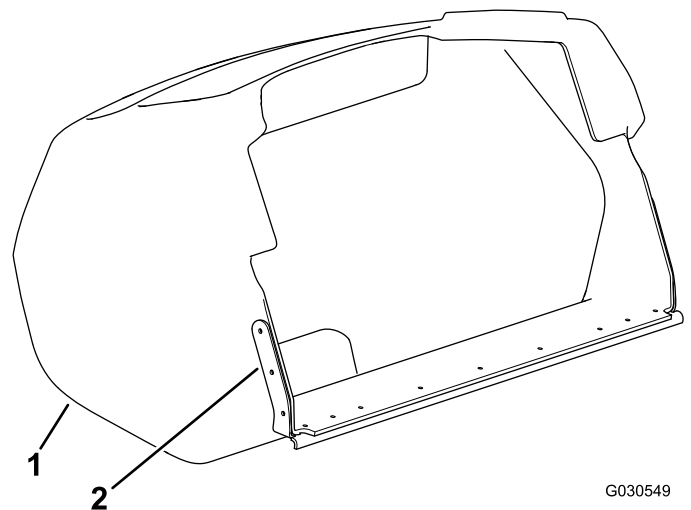

G030549

**Figure 1**

1. Basket
2. Basket support



2. Using the basket support as a template, mark 3 holes on each side of the basket (Figure 1).
3. Using a 5/32" drill bit, drill out the 3 marked holes on each side of the basket (Figure 2).

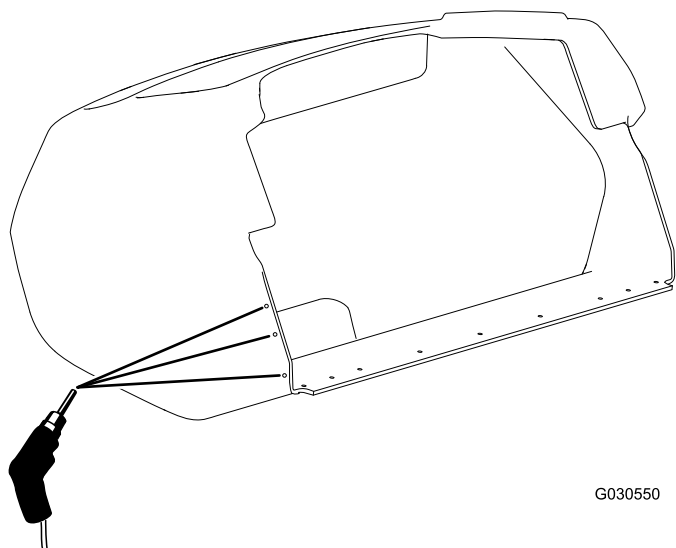

G030550

**Figure 2**  
Left side holes shown

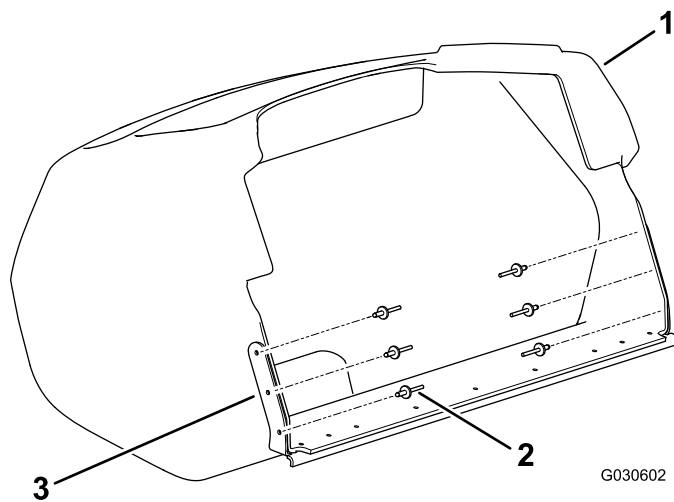

G030602

**Figure 4**

1. Basket
2. Pop rivet
3. Basket support

4. Align the basket support with the holes in the basket.
5. Install the pop rivets into the basket support (Figure 3 and Figure 4).

**Important:** Ensure that the flange of each pop rivet is inserted against the inner, plastic wall of the basket, and not against the metal basket support.

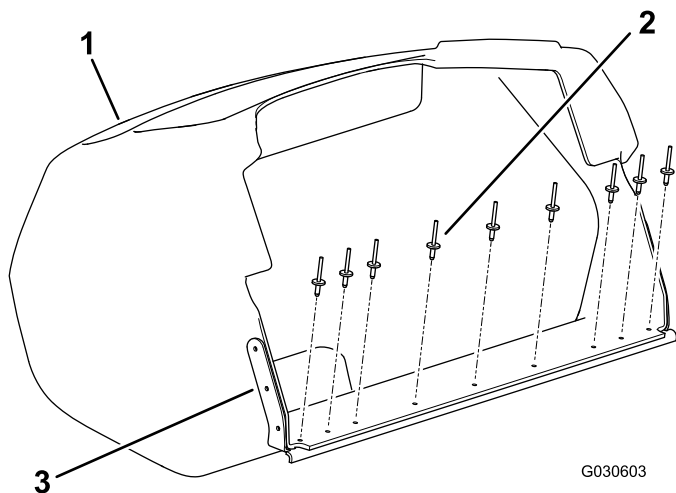

G030603

**Figure 3**

1. Basket
2. Pop rivet
3. Basket support