

# Zero-Turn Commercial Riding Mower

## Addendum

**Note:** This procedure is only for machines with a suspension system.

### **⚠ WARNING**

The springs are compressed by the shipping straps. When the straps are cut, the seat will raise up quickly by approximately 8.9 cm (3-1/2 inches).

## Removing the Shipping Straps

**Note:** Ensure the straps are removed before operating the machine.

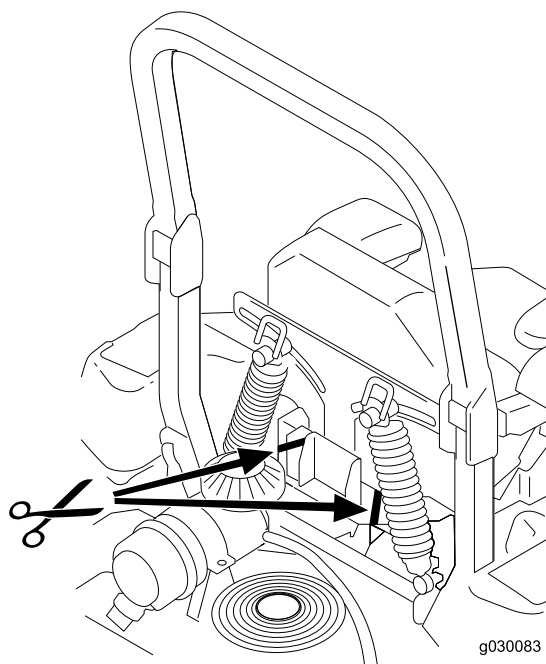

**Figure 1**



