



# ZapAlert Ground Stake Relocation Kit

## 2024 and 4045 Directional Drill

Model No. 131-9018

Model No. 131-9019

### Installation Instructions

#### ⚠ WARNING

##### CALIFORNIA Proposition 65 Warning

This product contains a chemical or chemicals known to the State of California to cause cancer, birth defects, or reproductive harm.

### Loose Parts

Use the chart below to verify that all parts have been shipped.

Description	Qty.	Use
2024 Directional Drill bracket	1	Install the brackets.
4045 Directional Drill bracket	1	
Grommets	2	
Bolts (M12)	2	
Locknuts (M12)	2	
Junction block	1	
Bolts (M5)	2	
Nuts (M5)	2	
Strike alert cable	1	Route the cables.
Negative battery cable	1	
Stake	1	
Bolt (M6)	1	
Flange nut (3/8 inch)	1	
No parts required	—	Test the zap-alert system.

## Relocating the Zap-Alert Assembly

### Removing the Existing Cable and Bracket

Park the machine on a level surface and turn the engine off.

Remove the zap-alert cable and bracket ([Figure 1](#)).

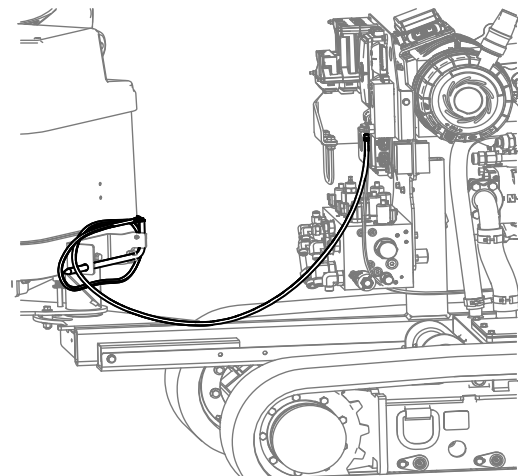

g030740

Figure 1



# Installing the Brackets

## Installing the Brackets for the 2024 Directional Drill

1. Install the grommets onto the bracket (Box A of [Figure 2](#)).

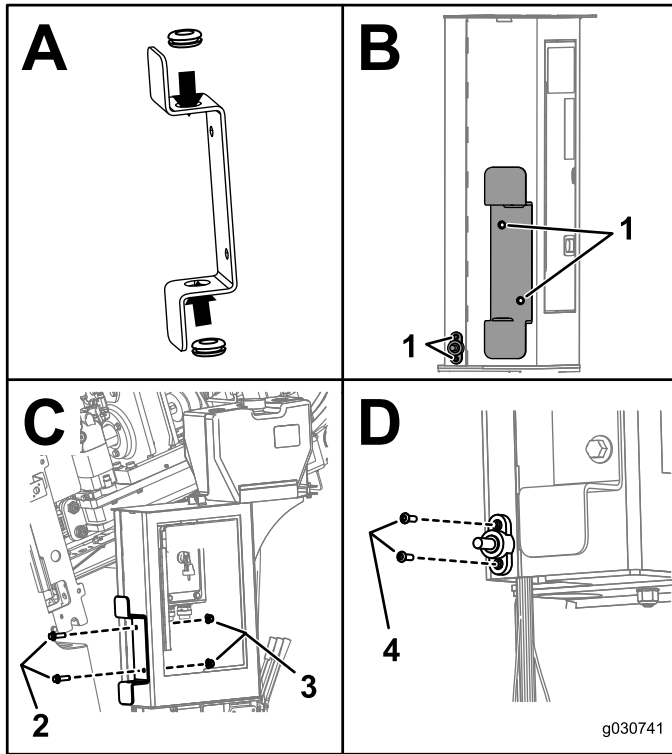
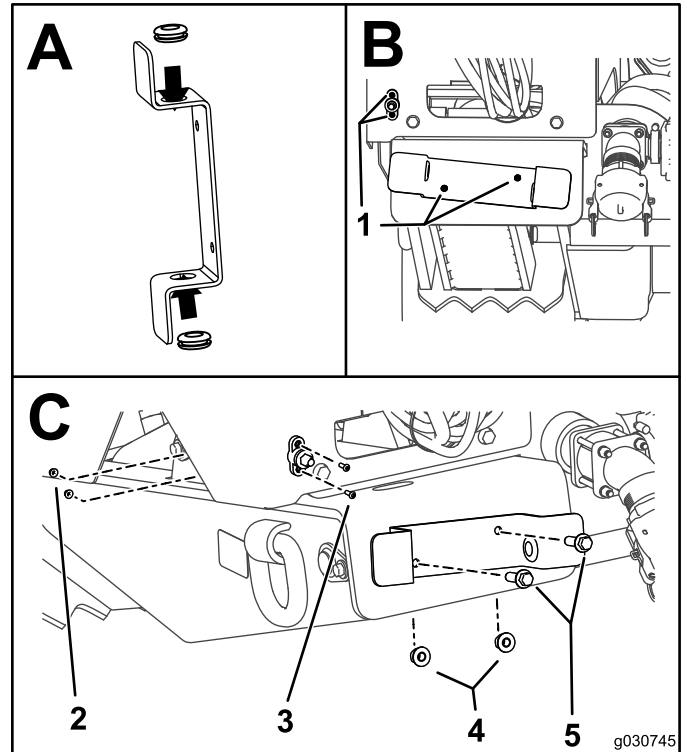

**Figure 2**  
2024 Directional Drill

1. Drill holes here
  2. Bolts (M12)
  3. Locknuts (M12)
  4. Bolts (M5)
- 
2. Using the bracket and junction block as a guide, mark and drill 4 holes as shown in Box B of [Figure 2](#).
  3. Secure the brackets using 2 Bolts (M12) and 2 locknuts (M12) as shown in Box C of [Figure 2](#).
  4. Torque the bolts to 80 to 100 N-m (59 to 73 ft-lb).
  5. Secure the junction block using 2 Bolts (M5) and 2 nuts (M5) as shown in Box D of [Figure 2](#).
  6. Torque the bolts to 791 to 971 N-cm (70 to 86 in-lb).

## Installing the Brackets for the 4045 Directional Drill

1. Install the grommets onto the bracket (Box A of [Figure 3](#)).



**Figure 3**  
4045 Directional Drill

1. Drill holes here
  2. Nuts (M5)
  3. Bolts (M5)
  4. Nuts (M12)
  5. Bolts (M12)
- 
2. Using the bracket and junction block as a guide, mark and drill 4 holes as shown in Box B of [Figure 3](#).
  3. Secure the brackets using 2 Bolts (M12) and 2 locknuts (M12) as shown in Box C of [Figure 3](#).
  4. Torque the bolts to 80 to 100 N-m (59 to 73 ft-lb).
  5. Secure the junction block using 2 Bolts (M5) and 2 nuts (M5) as shown in Box D of [Figure 3](#).
  6. Torque the bolts to 791 to 971 N-cm (70 to 86 in-lb).

# Routing the Cables

## Routing the Cables for the 2024 Directional Drill

1. Connect the stake to the negative battery cable using 1 bolt (M6) as shown in [Figure 4](#).

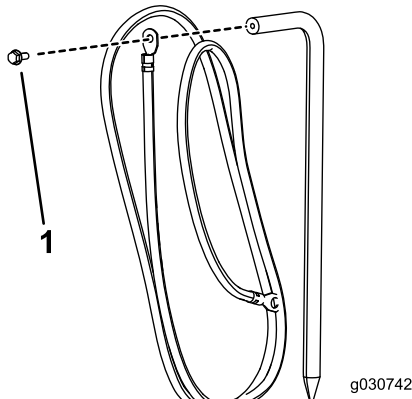

**Figure 4**

1. Bolt (M6)

2. Place the stake in the bracket and wrap the negative-battery cable around the bracket as shown in [Figure 5](#).

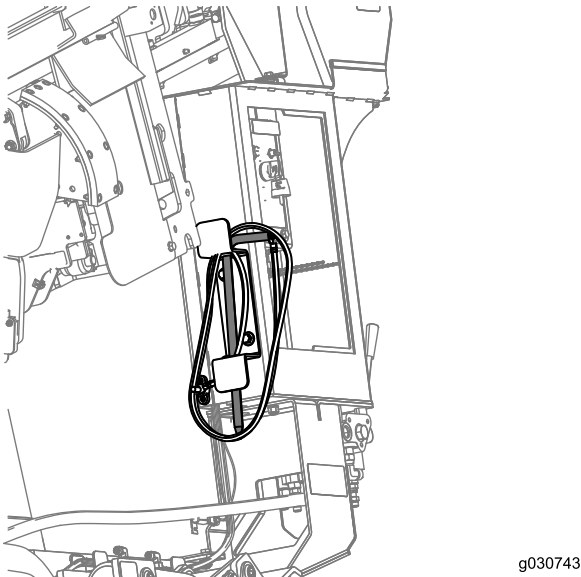

**Figure 5**

2024 Directional Drill

3. Connect the strike-alert cable to the junction block using 1 (3/8 inch) flange nut as shown in Box A of [Figure 6](#).

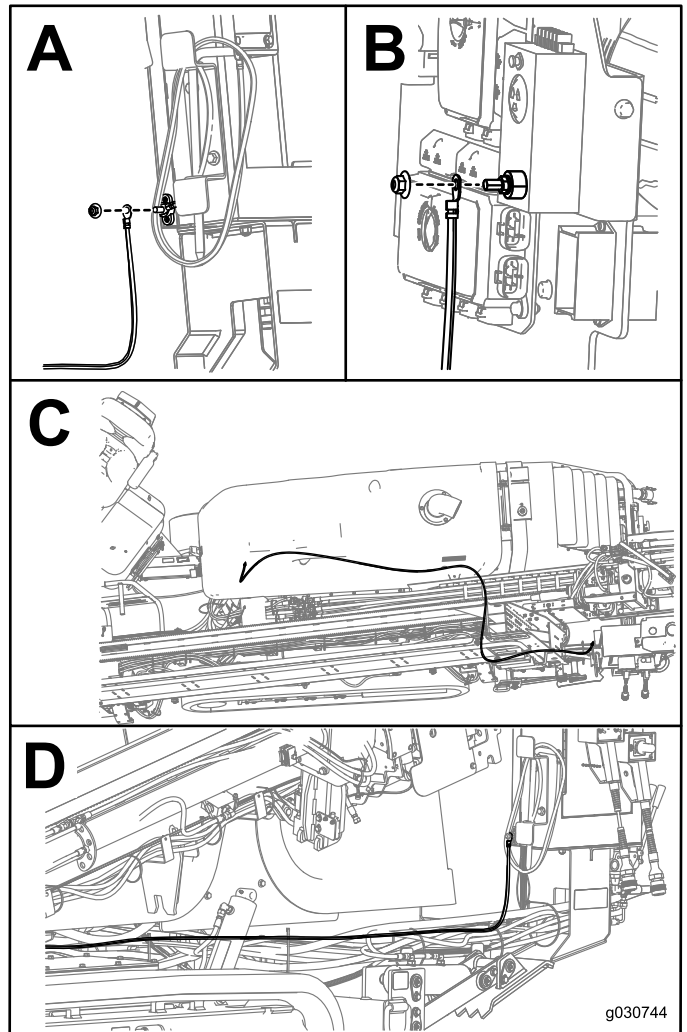

**Figure 6**

2024 Directional Drill

4. Route the strike-alert cable as shown in Box C and Box D of [Figure 6](#).
5. Connect the strike-alert cable to the machine using 1 flange nut (3/8 inch) as shown in Box B of [Figure 6](#).

## Routing the Cables for the 4045 Directional Drill

1. Connect the stake to the negative-battery cable using 1 bolt (M6) as shown in [Figure 4](#).
2. Place the stake in the bracket and wrap the negative-battery cable around the bracket as shown in [Figure 7](#).

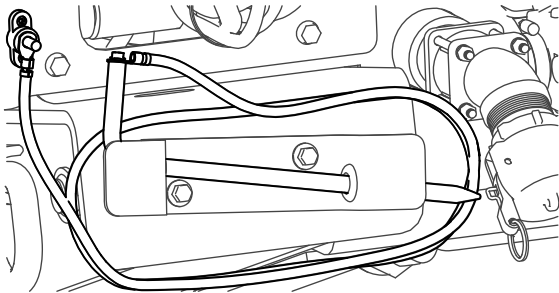

**Figure 7**  
4045 Directional Drill

- 
3. Connect the strike-alert cable to the junction block using 1 (3/8 inch) flange nut as shown in Box A of [Figure 8](#).

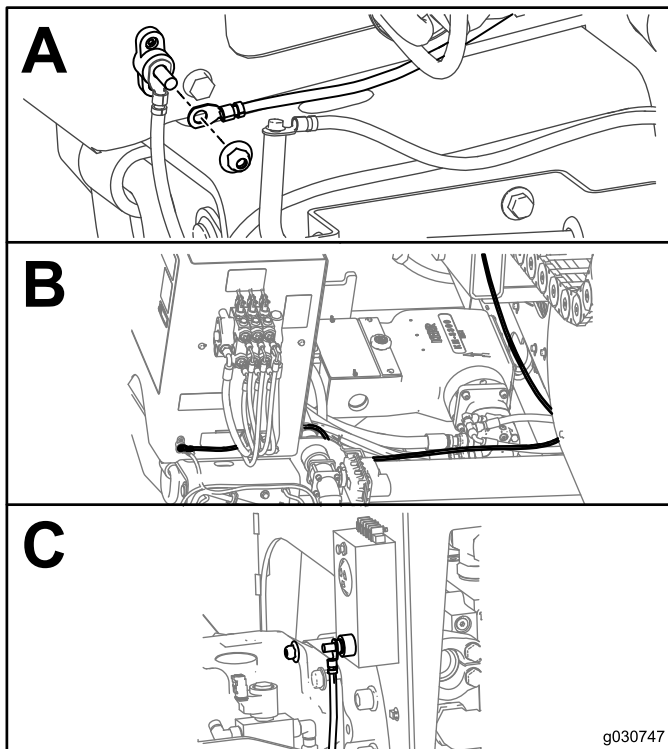

**Figure 8**  
4045 Directional Drill

- 
4. Route the strike-alert cable as shown in Box B of [Figure 8](#).
  5. Connect the strike-alert cable to the machine using 1 flange nut (3/8 inch) as shown in Box C of [Figure 8](#).

## Testing the Zap-Alert System

Test the zap-alert system; refer to your machine *Operator's Manual*.