

# SPECIFICATIONS

PART NUMBER:	380-0008	REV.:	B				
ECM NUMBER:	5093560	SHEET:	1 of 2				
ENGINEER:	Orion Goe	DATE:	07-03-2014				
PRODUCT:	Breakout, Parts, T5		SAP DESCRIPTION:	Breakout, Parts, T5			
WEIGHT:	0.02 lbs	FINISH:	N/A	ORIGINATING LOCATION:	RIVERSIDE	SIMILAR TO:	N/A
TOLERANCE: All dims in inches	±.010	SCALE:	N/A	CONTROLLED SOURCE:	XXX (If YES, see information at bottom of sheet)		

**SPECIFICATIONS:**

For Web publication only.

CONTROLLED SOURCE INFORMATION <input type="checkbox"/>	ALTERNATE or SUGGESTED SOURCE INFORMATION <input checked="" type="checkbox"/>
VENDOR: ADDRESS: CITY/STATE/ZIP: PHONE NUMBER: MFG PART No.: CONTACT:	VENDOR: ADDRESS: CITY/STATE/ZIP: PHONE NUMBER: MFG PART No.: CONTACT:

SEE REVISION SHEET FOR DESCRIPTION OF CHANGE





**Count on it.**

**Parts Catalog**

**T5 Series Sprinklers**

Model No. T5 Series Sprinkler



# Ordering Replacement Parts

To order replacement parts, please supply the part number, the quantity, and the description of each part desired.

## Understanding Reference Numbers

Each identified part in an illustration has a reference number. The reference number for a part also appears in the parts list, along with other information about the part.

This catalog uses two special reference number formats, one to indicate parts in a service assembly and another to indicate the quantity of a given part in an illustration.

## Service Assembly Reference Numbers

Parts in service assemblies have reference numbers in the form a:b. The a represents the reference number of the entire service assembly and the b represents a sequential number unique to each part within the service assembly.

For example, a wheel assembly might be identified by reference number 6, the tire by 6:1, the valve by 6:2, and the wheel by 6:3. When you order the assembly identified by reference number 6, you receive all parts identified by reference numbers 6:1, 6:2, and 6:3. However, you may also order any part individually. Reference numbers of this type appear in illustration and in parts lists.

## Reference Numbers Indicating Quantity

In an illustration, if a reference number indicates more than one part, the reference number has the form nX y. The n represents the quantity of the part, the X is the multiplication symbol, and the y represents the reference number.

For example, in an illustration, the reference number 2X 37 means that two of the parts identified by reference number 37 are indicated.

# List of Abbreviations

**AR:** as required

**ASM:** assembly

**BBC:** blade brake control

**BHTF:** button head thread forming

**CARR:** carriage

**CCW:** counter clockwise

**CW:** clockwise

**DEG:** degrees

**DPA:** Dual Point Adjustment

**ECM:** electronic control module

**EXT:** external

**FH:** flat head

**GA:** gauge

**HD:** heavy-duty

**HF:** hex flange

**HH:** hex head

**HHF:** hex head flange

**HHFTF:** hex head flange thread forming

**HJ:** hex jam

**HLH:** hex lag head

**HOC:** height-of-cut

**HP:** high pressure

**HSBH:** hex socket button head

**HSFH:** hex socket flat head

**HSH:** hex socket head

**HWH:** hex washer head

**HWHTF:** hex washer head thread forming

**HYD:** hydraulic

**LH:** left hand

**LP:** low pressure

**LPG:** Liquefied Petroleum Gas

**NI:** nylon insert

**NPTF:** national pipe thread fine

**PFH:** phillips flat head

**PPH:** phillips pan head

**PPHTF:** phillips pan head thread forming

**PRH:** phillips round head

**PTH:** phillips truss head

**PTO:** power-take-off

**RH:** right hand

**ROPS:** roll-over protection system

**RRB:** rear roller brush

**SFH:** slotted fillister head

**SHH:** slotted hex head

**SHWH:** slotted hex washer head

**SPH:** slotted pan head

**SQH:** square head

**SRH:** slotted round head

**STD:** standard

**TAP:** self tapping

**TTH:** torx truss head

# Contents

T5 Shrub .....	4
T5 and T5 RapidSet, Lawn .....	6
T5, High-Pop .....	8

# T5 Shrub

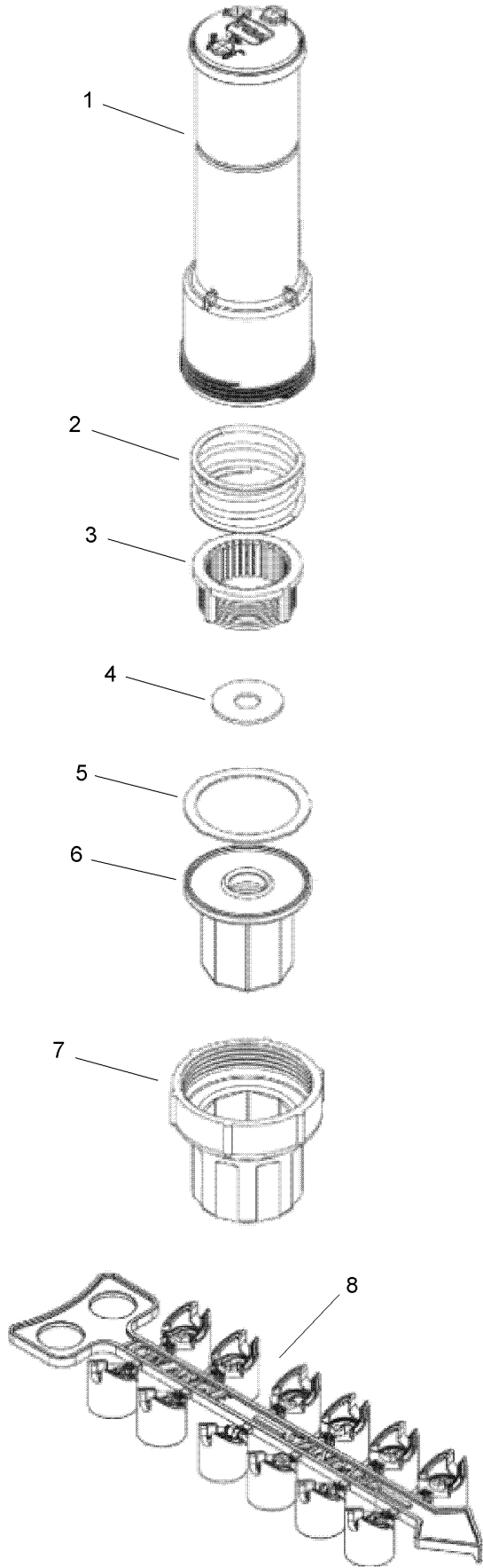
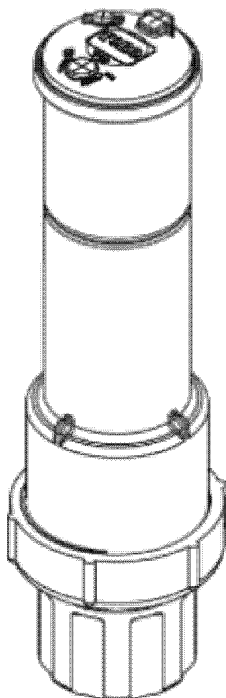

## T5 Shrub (continued)

<i>Ref.</i>	<i>Part Number</i>	<i>Qty.</i>	<i>Description</i>	<i>Ref.</i>	<i>Part Number</i>	<i>Qty.</i>	<i>Description</i>
1		1	Shrub Body Assembly (Order Finished Good T5S) ▲	5	9-5211	1	Seal
				6	102-0577	1	Threaded Insert, 3/4" & 1/2", Com
2	102-0579	1	Check, Spring	7	89-8305	1	Base, Shrub
3	102-0575	1	Screen	8	102-6499	1	Nozzle Tree
4	89-7561	1	Seal, Check, Com		102-7194		Adjustment Tool ●■

● SERVICE ITEMS  
▲ Not serviced separately

■ Not illustrated

# T5 and T5 RapidSet, Lawn

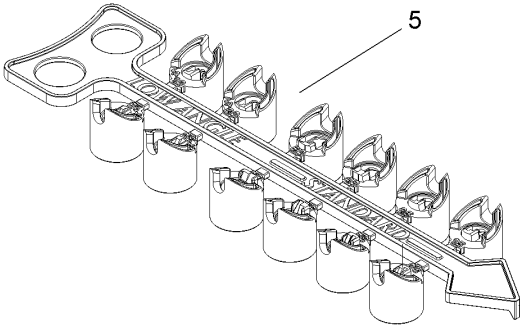
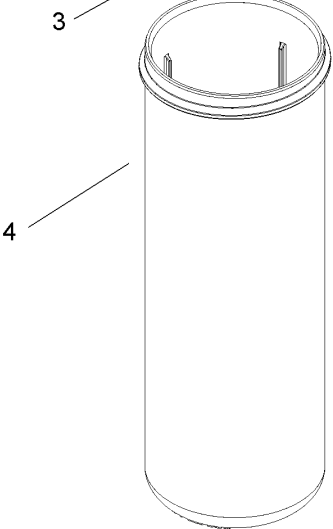
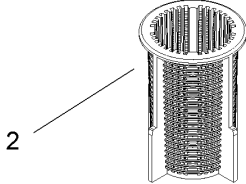
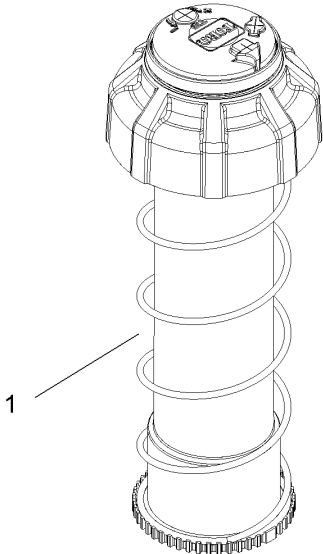
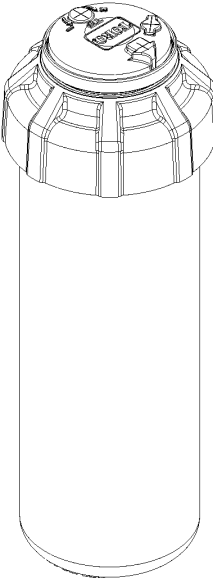

## T5 and T5 RapidSet, Lawn (continued)

<i>Ref.</i>	<i>Part Number</i>	<i>Qty.</i>	<i>Description</i>	<i>Ref.</i>	<i>Part Number</i>	<i>Qty.</i>	<i>Description</i>
1		1	Riser Assembly (Order Finished Good T5P Or T5-Rs [rapidset]) ▲	4	102-6349	1	Body
2	102-6358	1	Screen	5	102-6499	1	Nozzle Tree
3	89-7561	1	Check Seal (Optional, Not Included With The Riser Assembly)		102-7194		Adjustment Tool ●■

● SERVICE ITEMS  
▲ Not serviced separately

■ Not illustrated

# T5, High-Pop

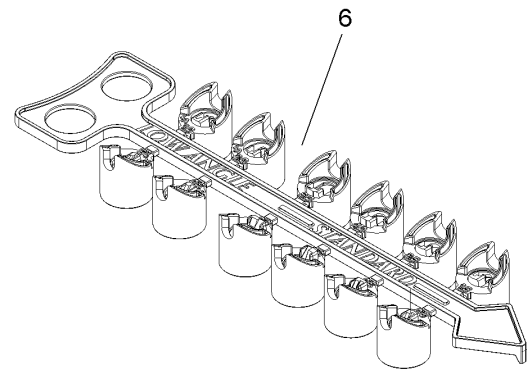
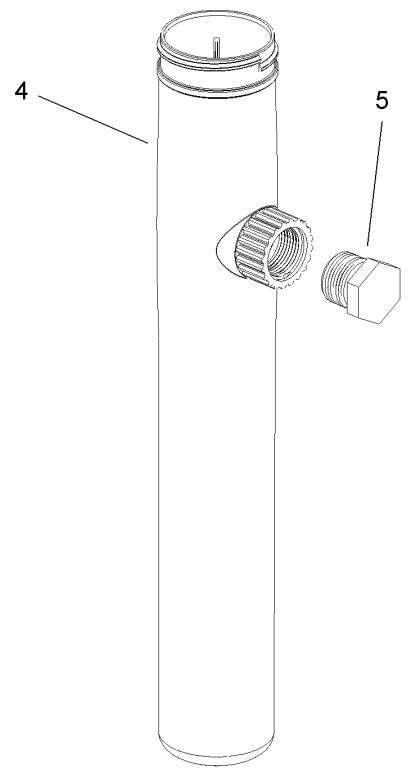
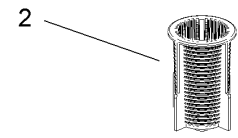
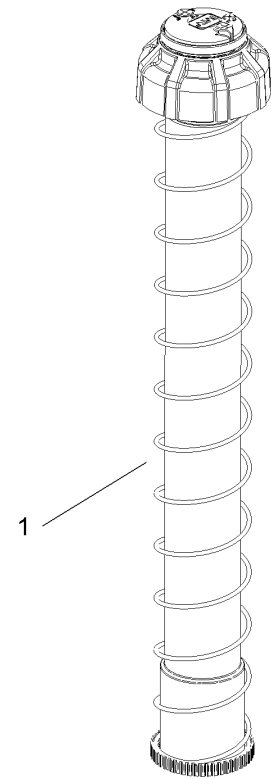
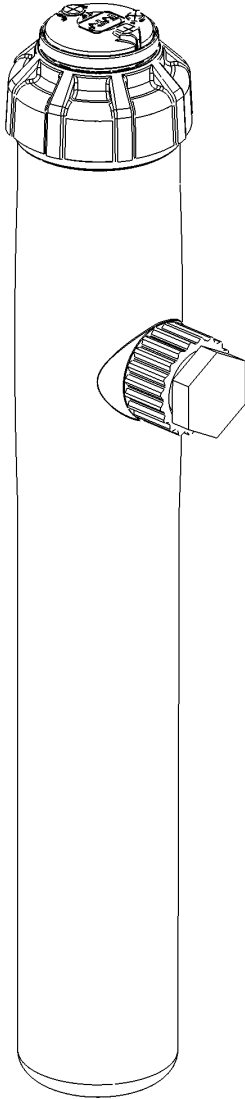

## T5, High-Pop (continued)

<i>Ref.</i>	<i>Part Number</i>	<i>Qty.</i>	<i>Description</i>	<i>Ref.</i>	<i>Part Number</i>	<i>Qty.</i>	<i>Description</i>
1		1	Riser Assembly (Order Finished Good T5HP)▲	4	102-6501	1	Body
2	102-6358	1	Screen	5	363-3779	1	Plug, 3/4" Npt Male
3	89-7561	1	Check Seal (Optional, Not Included With The Riser Assembly)	6	102-6499	1	Nozzle Tree
					102-7194		Adjustment Tool ●■

● SERVICE ITEMS  
▲ Not serviced separately

■ Not illustrated

**Notes:**

**Notes:**



**Count on it.**