

# Arctic Cat® Prowler

## Installation Instructions - Accessory Kit

### Front Brushguard Bumper Kit

(p/n 0436-992)

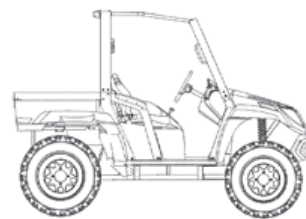

■ **NOTE:** Read these installation instructions thoroughly before beginning the installation process. Retain these Installation Instructions for future reference.

**Application:** All Prowler Models

**Kit includes:**

p/n	QTY	DESCRIPTION
0541-559	1	Brushguard Bumper
0541-417	2	Pin (J-Shaped)*
0423-615	2	Spring *
0423-614	2	E-Clip*
8432-802	2	Nyloc Nut (8 mm)*
0423-073	2	Flat Washer (1.38 OD x 0.413 ID)*
0423-505	2	Shoulder Screw
0453-421	1	Instructions

\*Included in Hardware Kit (p/n 0436-950)

**Fig. 1**

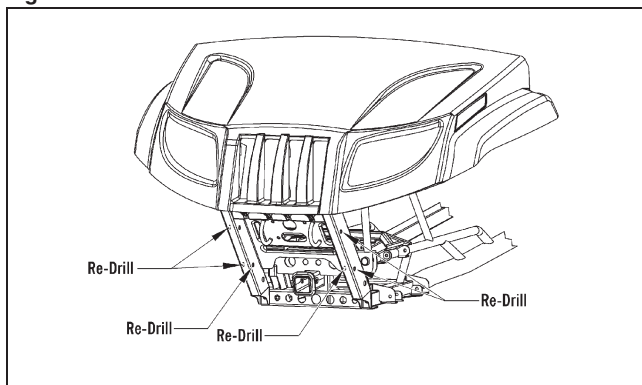

0742-702

■ **NOTE:** To install the brush guard on certain Prowlers equipped with stock bumpers, it is necessary to enlarge the bumper mounting holes. See steps 1 and 2; otherwise skip to step 3.

- Using a 13 mm and a 10 mm wrench, remove the four cap screws securing the existing front bumper. Remove the bumper and discard the existing hardware.
- Enlarge the four outside and two lower inside mounting holes in the bumper mounting tubes using a 15 mm (19/32 in.) drill bit See Fig. 1.
- Position the new Brushguard Bumper onto the front of the vehicle. From the outside, insert the two Shoulder Screws (A) through the lower mounting holes in the bumper bracket. Place a Flat Washer (B) onto each shoulder screw; then secure with Nyloc Nut (C). See Fig. 2 for identification and location of parts.

■ **NOTE:** There may be extra hardware included in this kit. Only the 1.38 in. x 0.413 in. flat washers are to be used. Discard extra washers.

**Fig. 2**

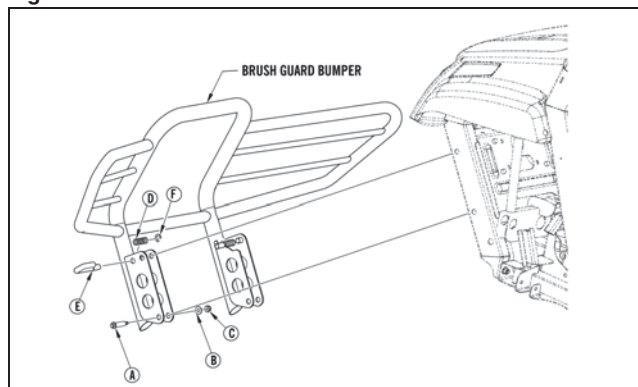

0742-701

■ **NOTE:** Do not over-tighten. The bumper will need to move freely in order to rotate the bumper downward to gain access to the hood.

- Position the bumper at a downward angle; then insert Spring (D) centered in the mounting bracket; then align the spring with the upper mounting lower holes in the brackets.
- From the outside, insert Pin (E) through the bracket mounting and into the spring. While carefully pulling backward on the spring to compress it, install E-Clip (F) into the groove at the end of the pin to secure the pin.

### CAUTION

**Be sure to wear safety glasses when compressing the spring and installing the E-Clip.**

- Pull outward on the pin and move it forward to the unlocked position.
- Repeat steps 4-6 for the opposite side.
- Raise the bumper into position; then pull outward on the pin and rotate the pin backward and lock the J-end into the locked position.