



MODEL NO. 59279

INSTALLATION INSTRUCTIONS

18" RECYCLER® MOWER BAGGING KIT

Since this instruction sheet covers only a minimal amount of information necessary to maintain and operate your mower, we suggest that you keep this material with your Operator's Manual so that both may be referred to for instructions concerning safe operation and proper maintenance procedures.



IMPORTANT

Your Recycler® mower has been updated to permit bagging. Make sure that your dealer is aware of this whenever parts are ordered or servicing is required.



SAFETY DECALS AND INSTRUCTIONS

Safety decals and instructions are easily visible to the operator and are located near any area of potential danger. Replace any decal that is lost or damaged.



DANGER

- THROWN OBJECTS OR BLADE CONTACT CAN SERIOUSLY INJURE IF DOOR IS NOT CLOSED.
- OPERATE ONLY IF DOOR IS CLOSED OR ATTACHMENT IS LOCKED IN PLACE.
- CLEAR DISCHARGE WITH ENGINE STOPPED BY MOVING DOOR HANDLE BACK AND FORTH.

88-3360

ON TOP OF DISCHARGE TUNNEL
(Part No. 88-3360)



ON SIDE OF DISCHARGE TUNNEL
(Part No. 39-5770)



CAUTION

THIS MOWER IS EQUIPPED WITH TORO RECYCLER BAGGING KIT MODEL NO. 59279. CONSULT RECYCLER BAGGING KIT PARTS LIST WHEN REPLACING ANY PARTS. FAILURE TO USE CORRECT PARTS MAY RESULT IN PERSONAL INJURY.

88-9300

ON REAR OF MOWER DECK
(Part No. 88-9300)



WARNING

- ROTATING BLADE OR THROWN OBJECTS CAN SERIOUSLY INJURE.
- DO NOT OPERATE WITHOUT PLUG IN PLACE OR OTHER ATTACHMENTS LOCKED IN PLACE.

88-6930

ON DISCHARGE TUNNEL PLUG
(Part No. 88-6930)

BAGGING KIT CONTENTS

PART NUMBER	PART DESCRIPTION	QUANTITY
88-1120	Discharge Plug Assembly	1
49-8030	Discharge Tunnel – Inner	1
88-3350	Discharge Tunnel – Outer	1
88-1090	Spring – Door R.H.	1
88-1100	Spring – Door L.H.	1
33-0412	Door – Discharge	1
33-0450	Spring – Latch	1
88-1800	Latch – Door	1
33-0441	Cover – Door	1
32144-32	Screw – Thread-forming	2
32144-112	Screw – Thread-forming	1
88-3360	Decal – Danger	1
39-5770	Decal – Danger	1
88-6930	Decal – Warning	1
88-9300	Decal – Caution	1
88-6500	Grass Bag Assembly	1
3316-423	Installation Instructions	1

ASSEMBLY INSTRUCTIONS

INSTALL DISCHARGE TUNNEL

Note: Determine left and right sides of mower by standing behind handles.

1. Remove spark plug wire from spark plug.
2. Remove and save the (7) bolts securing the Recycler® mower cover-deflector assembly to the deck (Fig. 1). Save the assembly for possible future reinstallation.

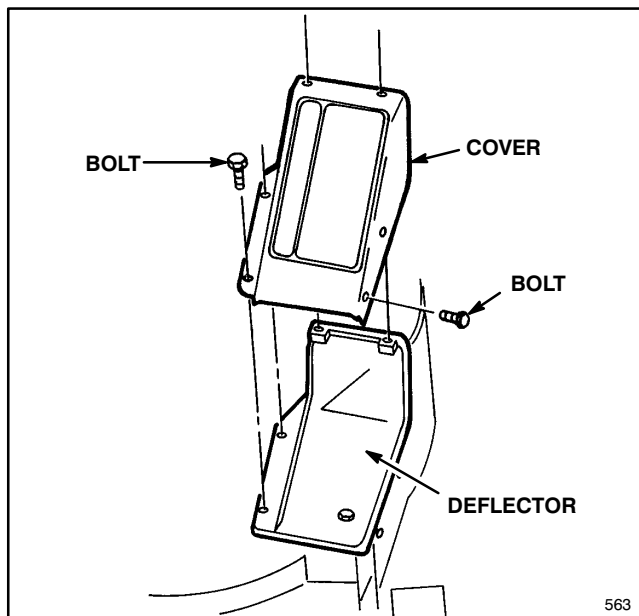

Figure 1

3. Position discharge tunnel and door assembly on deck. Align holes in discharge tunnel with holes in deck (Fig. 2).

4. Secure the new discharge tunnel to deck using (6) bolts removed from the cover-deflector assembly (Fig. 2). A socket set extension may be necessary to secure the front-left bolt (Fig. 3).

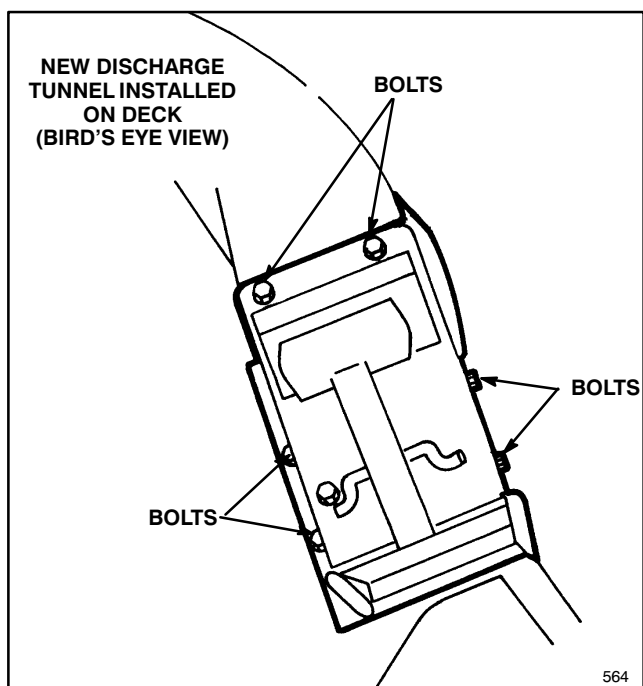

Figure 2

ASSEMBLY INSTRUCTIONS

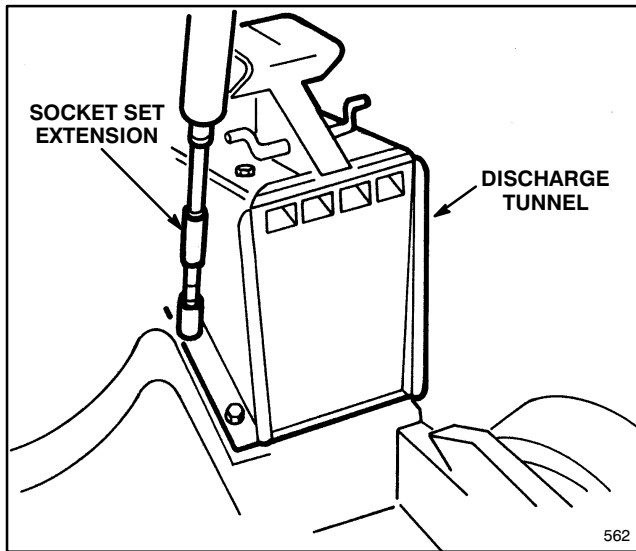

Figure 3

5. Open and close discharge door to ensure that it is moving freely. Make sure discharge tunnel door closes securely when handle is released.

OPERATING INSTRUCTIONS

USING GRASS BAG

1. Stop the engine and wait for all moving parts to stop.
2. Ensure discharge door handle is fully forward (Fig. 4).
3. **INSTALLING BAG** (Fig. 4)—Set rear of bag frame onto lower handle crossbar. Hold front of bag frame and bag door together. Then place opening in bag door against rear of discharge tunnel and slide bag door down.

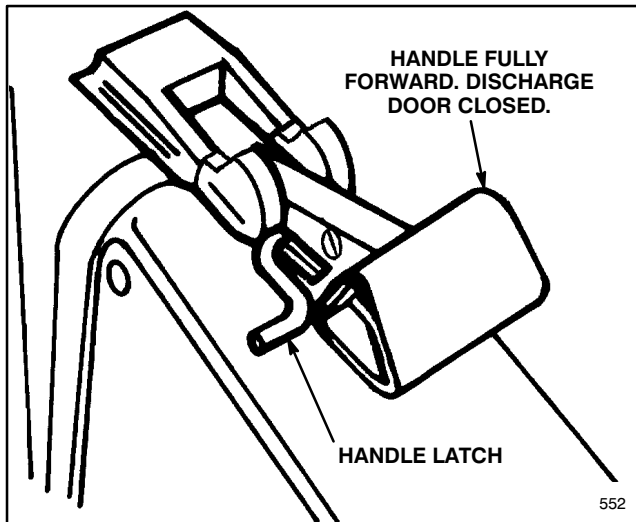

Figure 4

4. Pull discharge door handle backward until handle latch locks in bag notch (Fig. 5). Discharge door in mower housing is now open.
5. **EMPTYING BAG**—Release control bar and wait for blade to stop. Lift up handle latch (Fig. 4) until it clears the bag notch and move handle forward.

Grasp handle at front and rear of bag and lift bag off mower. Gradually tip bag forward to empty clippings.

6. To reinstall bag, repeats steps 3 and 4.

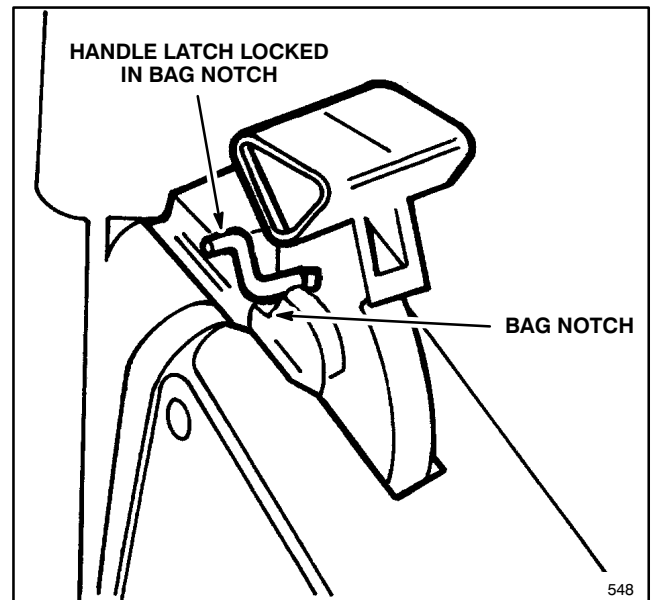

Figure 5

DANGER

- Grass clippings and other objects can be thrown from an open discharge tunnel.
- Objects thrown with enough force could cause serious personal injury or death to operator or bystander.
- Never open door on discharge tunnel when engine is running unless the grass bag, discharge tunnel plug or optional side discharge attachment is securely installed.

OPERATING INSTRUCTIONS



DANGER

- A worn grass bag could allow small stones and other similar debris to be thrown in operator's or bystanders direction.
- Thrown objects can cause serious personal injury or death to operator or bystanders.
- Check the grass bag frequently. If it is damaged, install a new genuine TORO replacement bag that has this or a similar warning.



DANGER

- Thrown objects may result if discharge door does not close completely.
- Thrown objects can cause serious personal injury or death.
- If discharge door cannot be closed because grass clippings clog discharge area, stop engine and gently move discharge door handle back and forth until door can be closed completely. If door still cannot be closed, remove obstruction with a stick, not your hand.

USING DISCHARGE TUNNEL PLUG

1. Make sure engine is turned off. Open the discharge door by moving handle rearward. Hold the discharge door handle to prevent the spring-loaded door from closing while inserting the plug.
2. A rotating motion is required to insert the plug into the discharge tunnel. Begin by rotating the plug slightly to the left to insert it into the tunnel. As you slide the plug further into the tunnel, rotate the plug to the right (Fig. 6).

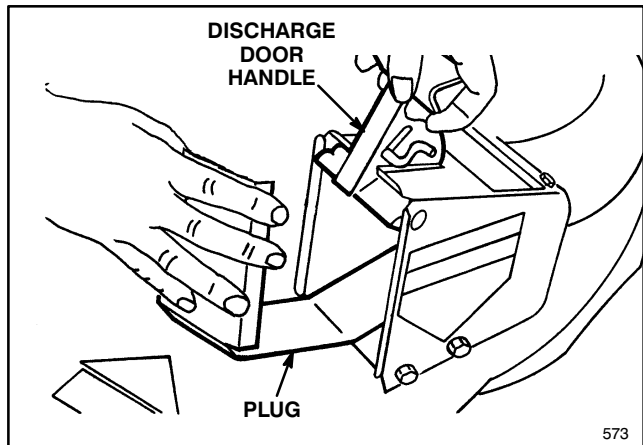

Figure 6

3. Push the plug all the way in until it fits securely into the tunnel (Fig. 7). Release discharge door handle to secure plug in tunnel.
4. To remove the plug, move the discharge door handle rearward. Rotate the plug to the left while pulling it up and out of the discharge tunnel.

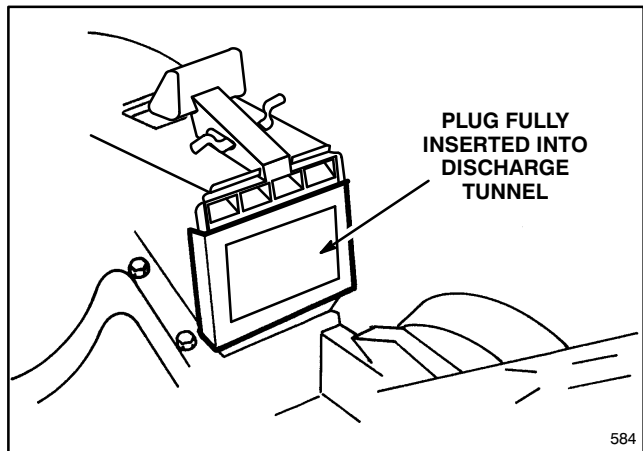

Figure 7

MAINTENANCE

CLEANING MOWER HOUSING, DISCHARGE TUNNEL AND PLUG

To ensure best performance, the discharge tunnel plug must be cleaned after each use. When grass is thick and lush, clippings may collect on and around the plug; this may make plug removal difficult. After each use, remove plug from discharge tunnel and clean off all debris.

Always be sure that discharge tunnel door closes securely when handle is released. If debris prevents discharge door from closing securely, clean inside of discharge tunnel and door thoroughly.

1. Stop engine and pull wire off spark plug.
2. Tip mower on side. For mowers with a Tecumseh engine, tip mower on left side (spark plug side down). When tipping all other mowers on side, keep carburetor side up. Avoid rotating blade because starting problems may result.
3. Remove dirt and grass clippings that stick to housing with a hardwood scraper. Avoid burrs and sharp edges.
4. Turn mower upright.
5. Remove debris from inside of discharge tunnel.
6. Clean discharge tunnel plug.