



Wheel Horse®
**50" Mid-Mount
Blade**

for
Garden Tractors
Model No. 79351- 7900001 & Up

Operator's Manual

IMPORTANT: Read this manual carefully. It contains information about your safety and the safety of others. Also become familiar with the controls and their proper use before you operate the product.

Introduction

We want you to be completely satisfied with your new product, so feel free to contact your local Authorized Service Dealer for help with service, genuine replacement parts, or other information you may require.

Whenever you contact your Authorized Service Dealer or the factory, always know the model and serial numbers of your product. These numbers will help the Service Dealer or Service Representative provide exact information about your specific product. You will find the model and serial number plate located in a unique place on the product as shown below.

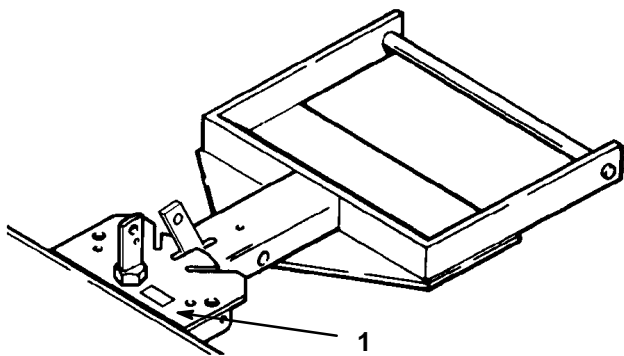

m-2799

1. Model and Serial Number Plate

For your convenience, write the product model and serial numbers in the space below.

Model No: _____
Serial No. _____

The warning system in this manual identifies potential hazards and has special safety messages that help you and others avoid personal injury, even death. DANGER, WARNING and CAUTION are signal words used to identify the level of hazard. However, regardless of the hazard, be extremely careful.

DANGER signals an extreme hazard that will cause serious injury or death if the recommended precautions are not followed.

WARNING signals a hazard that may cause serious injury or death if the recommended precautions are not followed.

CAUTION signals a hazard that may cause minor or moderate injury if the recommended precautions are not followed.

Two other words are also used to highlight information. “Important” calls attention to special mechanical information and “Note” emphasizes general information worthy of special attention.

The left and right side of the machine is determined by sitting on the seat in the normal operator’s position.

Contents

	Page		Page
Assembly	2	Operation	7
Loose Parts	2	Attachment Lift Lever	7
Assemble Blade	3	Attachment Power Lift	8
Install Rear Hitch	4	Adjusting Dial-A-Height	8
Install Blade to Tractor	5	Adjusting Blade Index	8
Removing the Blade	6	Tips For Using Blade	8
		Maintenance	9
		Lubrication	9
		Storage	9

Assembly

Loose Parts

Note: Use the chart below to identify parts for assembly.

DESCRIPTION	QTY.	USE
Blade	1	Assemble blade to quadrant
Quadrant	1	
Carriage bolt 3/8–16 x 1" (25 mm)	6	
Locknut 3/8"	6	
Handle	1	Assemble handle to frame
Washer 3/4" (19 mm)	2	
Cotter pin 1-1/4" (32 mm)	1	
Latch link	1	
Bolt 3/8–16 x 1-1/4" (32 mm)	1	
Bolt 3/8–16 x 1" (25 mm)	1	
Locknut 3/8"	2	
Jam nut 3/8"	1	
Spring	1	
Latching plate	1	Assemble mounting plate
Latch lever	2	
Carriage bolt 3/8–16 x 1" (25 mm)	2	
Washer 3/8"	2	
Lock nut 3/8"	2	
Clevis pin	2	
Cotter pin 3/4" (19 mm)	2	
Latch plate assembly	1	Install mounting plate to tractor
Link bracket-right	1	
Link bracket-left	1	
Angle spacer (if required)	1	
Carriage bolt 3/8–16 x 3-1/2" (8.3 cm)	4	
Lock nut 3/8"	4	
Lift link	1	Install lift lever to tractor
Hairpin cotter	2	

Assemble Blade

1. Assemble the blade to the quadrant with (6) 3/8-16 x 1" (25 mm) carriage bolts and (6) 3/8" locknuts (Fig. 1).

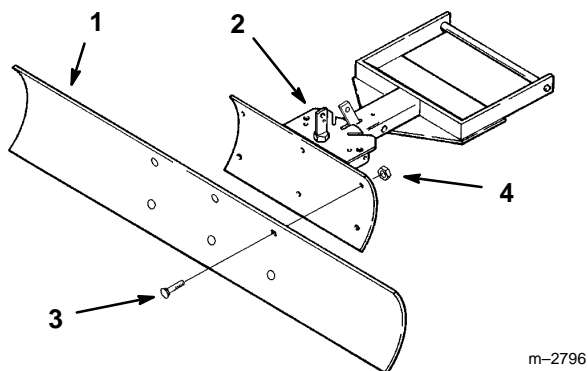

Figure 1

- | | |
|-------------|-----------------------------|
| 1. Blade | 3. Bolt 3/8-16 x 1" (25 mm) |
| 2. Quadrant | 4. Lock nut 3/8" |

2. Slide a 3/4" (19 mm) washer onto handle rod (Fig. 2). Then slide handle into frame cross hole and secure with second 3/4" (19 mm) washer and 1-1/4" (32 mm) cotter pin (Fig. 2).
3. Secure latch link to latch lever with 3/8-16 x 1" (25 mm) bolt and 3/8" locknut (Fig. 2).

Note: Latch lever and latch joint must move freely, do not overtighten locknut.

4. Secure latch link to handle lever with 3/8-16 x 1-1/4" (32 mm) bolt, 3/8" locknut (Fig. 2).

Note: Lever and handle joint must move freely, do not overtighten locknut.

5. Thread 3/8" jam nut onto end of 3/8-16 x 1-1/4" (32 mm) bolt (Fig. 2).

6. Hook spring in small hole of pivot bolt tang and stretch to space between locknut and jam nut (Fig. 2).

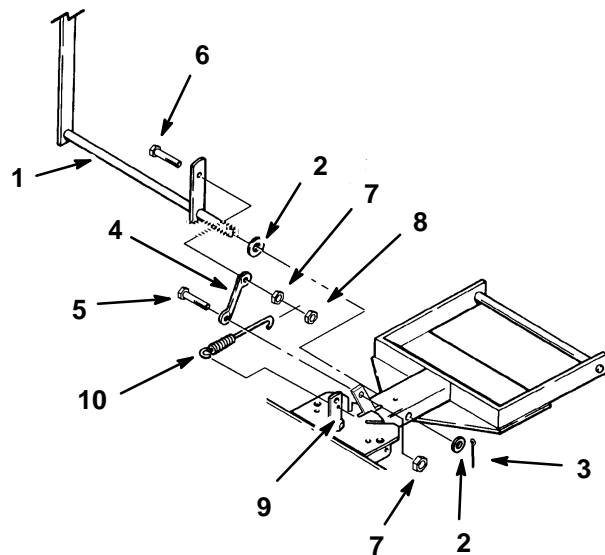

Figure 2

- | | |
|------------------------------|---------------------------------|
| 1. Handle | 6. Bolt 3/8-16 x 1-1/4" (32 mm) |
| 2. Washer 3/4" (19 mm) | 7. Locknut 3/8" |
| 3. Cotter pin 1-1/4" (32 mm) | 8. Jam nut 3/8" |
| 4. Latch link | 9. Small hole |
| 5. Bolt 3/8-16 x 1" (25 mm) | 10. Spring |

Install Rear Hitch

1. Install latch levers to mounting plate with 3/8–16 x 1" (25 mm) carriage bolts, 3/8" washers and 3/8" locknuts (Fig. 3).

Note: Tighten nuts so latch levers move, but hold in position for ease of tiller mounting to tractor.

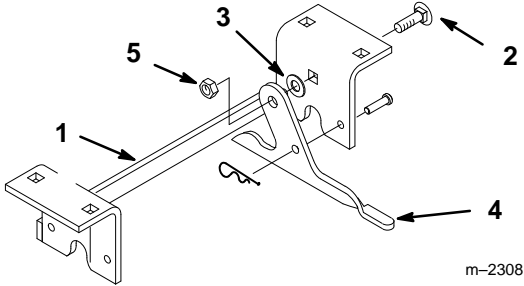

Figure 3

- | | |
|--------------------------------------|-----------------|
| 1. Mounting plate | 3. Washer 3/8" |
| 2. Carriage bolt 3/8–16 x 1" (25 mm) | 4. Latch lever |
| | 5. Locknut 3/8" |

2. Center hitch on axle housing and install with (4) 3/8–16 x 3-3/4" (8.3 cm) carriage bolts, left side angle plate (with hole rearward), right side strap and 3/8" locknut as shown (Fig. 4).

Note: On hydrostatic models with oil filter facing rear locate hitch 3-1/4" (8.3 cm) from right side of center housing.

Note: To tighten hitch mounting, install angle spacers, positioned along top and rear of axle, on 8-speed gear drive and hydrostatic models with oil filter on right side.

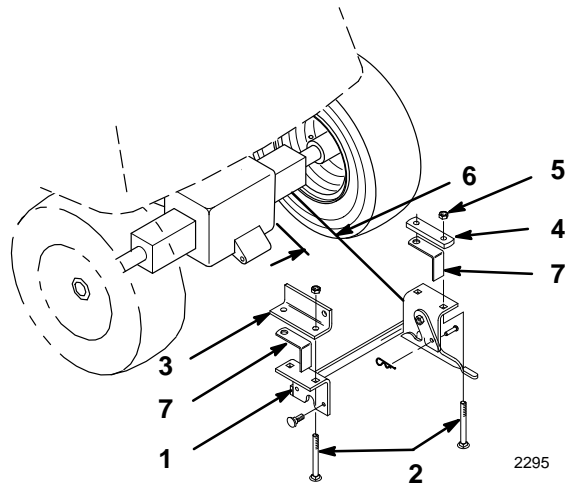
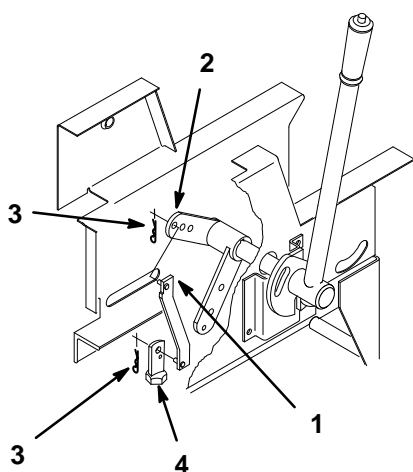

Figure 4

- | | |
|---|-----------------------------|
| 1. Mounting plate | 4. Strap-right side |
| 2. Carriage bolt 3/8–16 x 3-3/4" (8.3 cm) | 5. Locknut 3/8" |
| 3. Angle plate-left side | 6. 3-1/4" (8.3 cm) location |
| | 7. Angle spacer-if required |

Install Blade to Tractor

1. Park the machine on a level surface, disengage the power take off (PTO), set the parking brake, and turn the ignition key to "OFF" to stop the engine. Remove the key.
2. Turn the Dial-a-Height knob counterclockwise, all the way and lower the attachment lift lever to the mounting position; refer to Lowering Attachment.
3. Attach lift link, with notch up and toward the front of the tractor, in the end hole of attachment lift. Secure with hairpin cotter (Fig. 5).



m-2798

Figure 5

- | | |
|--|-------------------|
| 1. Lift link—notch up and toward front | 3. Hairpin cotter |
| 2. End hole of attachment lift | 4. Pivot pin |

4. Raise attachment lift lever to the transport position; refer to Raising Attachment.
5. Slide blade under tractor from the rightside.
6. Lift latch levers and install mounting rod. Center rod between hitch latches (Fig. 6).
7. Secure latch levers closed with clevis pins and hairpin cotters (Fig. 6).

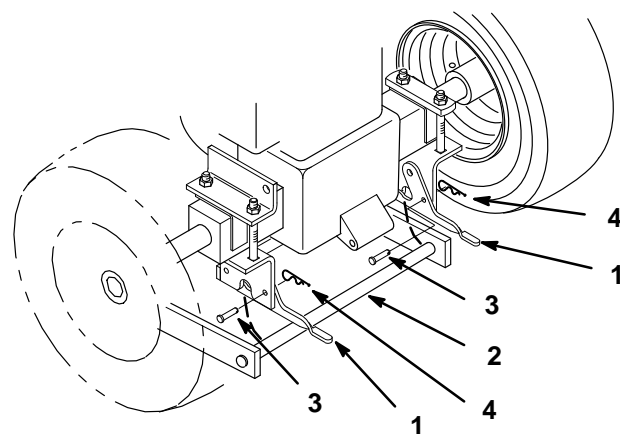

m-2800

Figure 6

- | | |
|-----------------|-------------------|
| 1. Latch lever | 3. Clevis pin |
| 2. Mounting rod | 4. Hairpin cotter |

8. Turn the Dial-A-Height knob counterclockwise, all the way and lower the attachment lift lever to the mounting position; refer to Lowering Attachment.
9. Secure lower end of lift link to pivot pin in quadrant with hairpin cotter (Fig. 5).

Removing the Blade

Note: Save all hardware, washers and hairpin cotters for re-use when installing blade.

1. Park the machine on a level surface, disengage the power take off (PTO), set the parking brake, and turn the ignition key to "OFF" to stop the engine. Remove the key.
2. Turn the Dial-A-Height knob counterclockwise, all the way and lower the attachment lift lever to the mounting position; refer to Lowering Attachment.
3. Remove hairpin cotter and lower end of lift link from pivot pin in quadrant (Fig. 8).
4. Raise attachment lift lever to the transport position; refer to Raising Attachment.
5. Remove hairpin cotters and clevis pins securing latch levers closed (Fig. 7).
6. Open rear hitch latch levers and remove mounting rod (Fig. 7).
7. Slide blade out from right side of tractor.

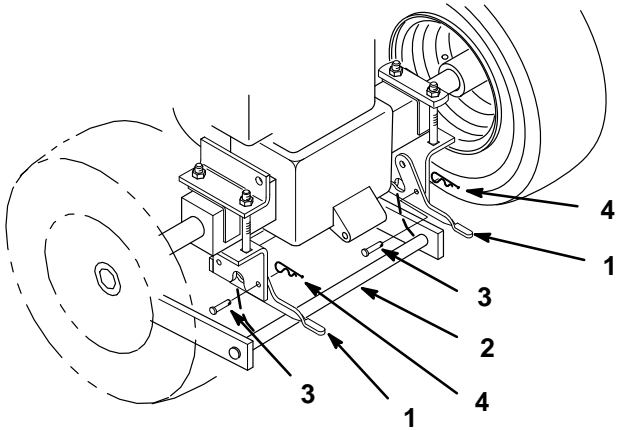

m-2800

Figure 7

- | | |
|-----------------|-------------------|
| 1. Latch lever | 3. Clevis pin |
| 2. Mounting rod | 4. Hairpin cotter |

8. Lower the attachment lift lever to the mounting position and remove hairpin cotter and lift link from attachment lift (Fig. 8).

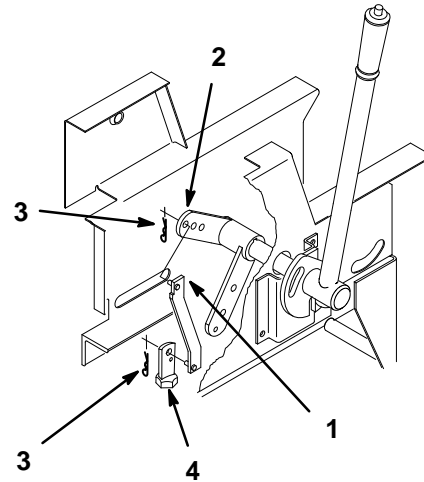

m-2798

Figure 8

- | | |
|--------------------------------|-------------------|
| 1. Lift link | 3. Hairpin cotter |
| 2. End hole of attachment lift | 4. Pivot pin |

Note: Save all hardware, washers and hairpin cotters for reuse when installing tiller.

Operation

DANGER

POTENTIAL HAZARD

- Hitting fixed objects can cause the tractor to stop abruptly.

WHAT CAN HAPPEN

- Stopping abruptly can cause loss of control, equipment damage and personal injury.

HOW TO AVOID THE HAZARD

- Travel at a safe, slow speed.
- Check area to be plowed and mark all fixed objects so they can be avoided.

Attachment Lift Lever

The attachment lift lever (Fig. 9) is used to raise and lower various attachments.

Raising Attachments

1. Depress the clutch and/or brake pedal(s) to stop the machine.
2. Pull attachment lift lever rearward until latch locks. In this position the lift will hold the attachment in the up, or raised position.

Lowering Attachments

1. Depress the clutch and/or brake pedal(s) to stop the machine.
2. Pull attachment lift lever rearward, to release lift pressure, and push the button on top to release the latch. Move lift lever forward to lower attachment.

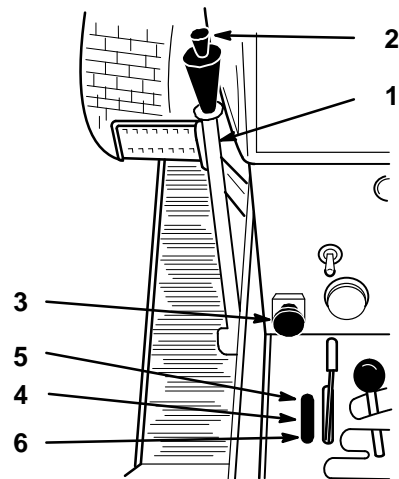

2321

Figure 9

- | | |
|------------------|----------------------|
| 1. Lift lever | 4. Indicator |
| 2. Button | 5. High |
| 3. Dial-A-Height | 6. Mounting position |

Attachment Power Lift

The attachment power lift (optional on some models) (Fig. 10) is used to raise and lower attachments.

Raising Attachments

1. Start the engine.
2. Move the lift lever in the “UP” direction to raise the attachment lift (Fig. 10). This will lift and hold the attachment in the up, or raised position.

Lowering Attachments

1. Start the engine.
2. Move the lift lever in the “DOWN” direction to lower the attachment lift (Fig. 10). This will lower the attachment lift.

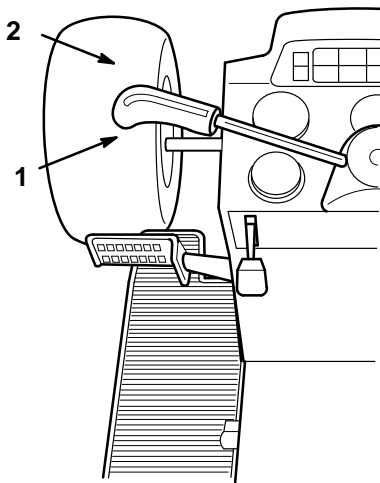

2317

Figure 10

1. Lift lever UP
 2. Lift lever DOWN
-

Adjusting Dial-A-Height

The Dial-A-Height control (Figs. 9) is used to limit the downward travel of the attachment, on gear drive tractors only. The Dial-A-Height knob is rotated to change the location of this stop, up or down.

1. Raise the attachment lift lever: Refer to Raising Attachments. In the raised position the Dial-A-Height knob (Fig. 9) can be rotated to change the stop location. Turn clockwise to raise and counterclockwise to lower the height of the attachment.
2. The Dial-A-Height indicator (Fig. 9) will show the change, high to low, in attachment lift height as adjustment is made.

Adjusting Blade Index

The blade can be indexed side to side, in 3 positions left, center and right.

The direction is controlled by slots in the quadrant.

To change position pull the handle, on the right side of frame, rearward. Then swing blade to desired position and release handle to lock in quadrant.

Tips For Using Blade

Indexing blade to the side allows easier discharge of material on either side.

Generally, moved dirt by making one pass down the center and then plowing to either side on successive passes.

If tractor loses traction when using blade, wheel weights and tire chains may be available from your dealer.

Maintenance

CAUTION

POTENTIAL HAZARD

- If you leave the key in the ignition switch, someone could start the engine.

WHAT CAN HAPPEN

- Accidental starting of the engine could seriously injure you or other bystanders.

HOW TO AVOID THE HAZARD

- Remove the key from the ignition switch and pull the wire off the spark plug before you do any maintenance. Also push the wire aside so it does not accidentally contact the spark plug.

Lubrication

Lightly oil all bare metal surfaces and linkage pivot points to prevent rust.

Oil Type: SAE 10W or 10W30.

Storage

1. Before long term storage wash the machine with mild detergent and water to remove dirt and grime from the entire machine.
2. Check and tighten all bolts, nuts, and screws. Repair or replace any part that is damaged or defective.
3. Paint all scratched or bare metal surfaces. Paint is available from your Authorized Service Dealer.
4. Store the machine in a clean, dry garage or storage area. Cover the machine to protect it and keep it clean.

